



FCP-H

Mobile Hot Island Display



ADVANTAGES

- All metal construction for durability
- Magnetized stainless canopy for signage
- Plug and play installation
- Casters for ease of movement
- McCue Bumper for overall protection
- Hatco components for reliable temperature performance
- 7" Deep well construction - allows for double stacking



KEY POINTS

- Available in (2) Lengths 4' and 6'
- Available in stainless or black powder coat
- Shelf Package Option
- Certified ETL (NSF4) and (UL97)



FCP-H

ADDITIONAL PRODUCT INFORMATION

Scan or click on QR code:

- In-store photos
- Technical documents



LENGTHS

48"W x 58"H: FCP-4-1-HW-NS-H-31829

72"W x 58"H: FCP-6-1-HW-NS-H-31820

FEATURES

- Heavy gauge metal construction for durability
- Magnetized stainless steel top
- McCue black bumper for overall protection
- 7" Deep well that allows for double stacking of product during high traffic day parts to drive sales
- Well construction provides reliable and more consistent temperature performance
- Master control switch to allow control settings to remain unchanged and ease of on/off for employees
- Deck heat and overhead heat for reliable and more consistent temperature performance
- On heavy duty casters for ease of movement
- Plug and play installation

OPTIONS

- Stainless or black powder coated
- Lower shelf option

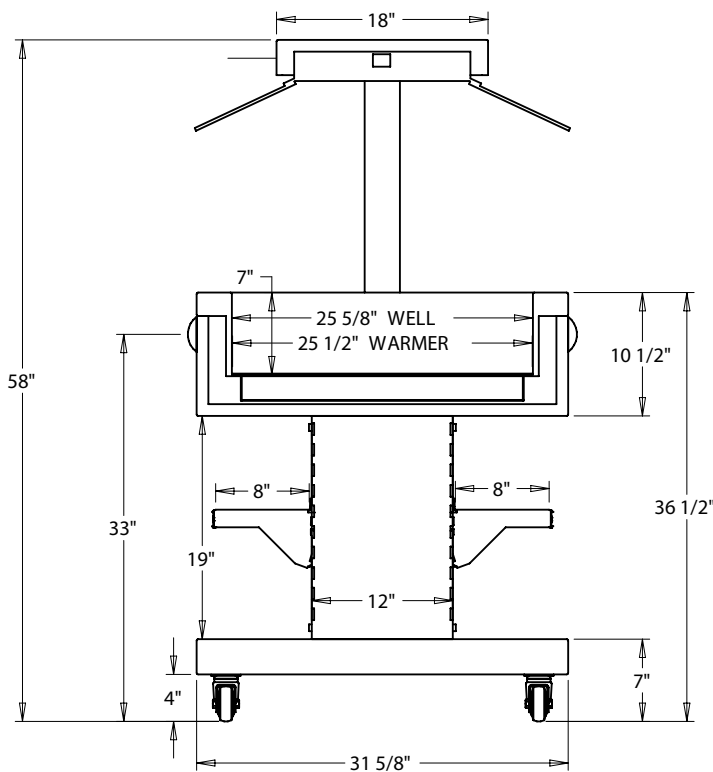

See manufacturer's website for further information

NOTE: These merchandisers are designed for use in stores when temperature and humidity do not exceed 75F and 55% R.H. We reserve the right to change or revise specifications and product design in connection with any feature of our products. Such changes do not entitle the buyer to corresponding changes, improvements, additions, or replacements for equipment previously sold or shipped.



HUSSMANN®

Hussmann Corporation
12999 St. Charles Rock Rd.
Bridgeton, MO 63044-2483
Ph: 800.592.2060

www.hussmann.com