

HUSSmann®

Specialty

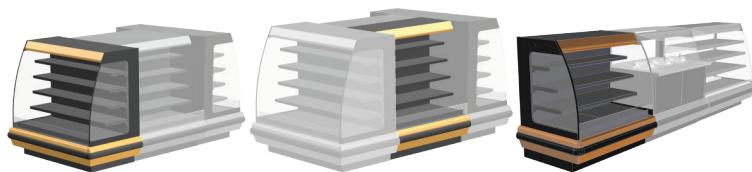

"Island"
via **E** and **C** Modules

"In-Line" and "Stand Alone"
via **I** Modules

Isla Family

IM-RF

Refrigerated Multi-Deck Merchandiser
for Floral Applications

www.hussmann.com

Husmann Isla Refrigerated Multi-Deck Merchandiser for Floral Applications

IM-R-F - Standard Canopy IM-R-FNC- Narrow Canopy

Heights: 50" (04); 58" (05)

Types: End (E); Center (C); In-Line (I)

Lengths: **E:** 5'

C: 4', 5', 6', 8', 10', 12'

I: 4', 5', 6', 8', 10', 12'



4" Step with floral vases



Floral vase inserts

Merchandising Solutions

Use floral solutions to meet your merchandising needs



Modular adjustable shelves



IM-04-RF-NC
Refrigerated Self-Service Floral with narrow canopy

IM-04-RF
Refrigerated Self-Service Floral Module

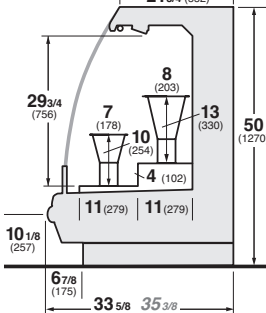
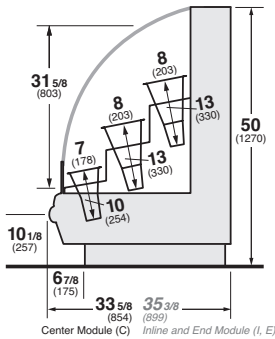

IM-05-RF-NC
Refrigerated Self-Service Floral with narrow canopy

IM-05-RF
Refrigerated Self-Service Floral Module

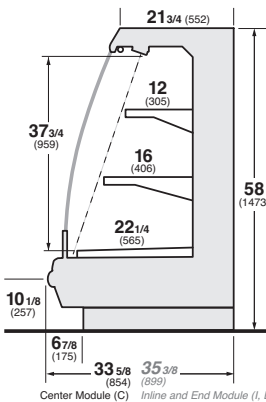
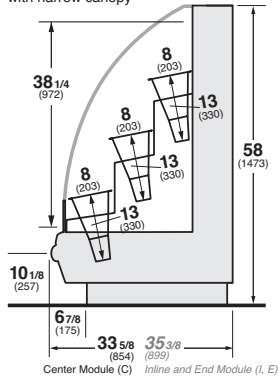

IM-CS-R Center Module / **IM-IS-R** In-Line Module

IM-04-E5-R, IM-05-E5-R End Module

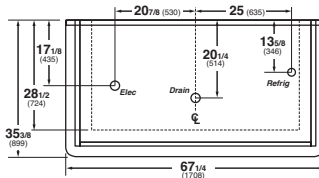
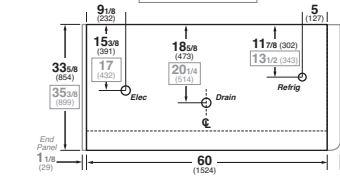

Features.

- Painted exterior panel
- Black interior
- Modular coil system – 5 year warranty
- Energy efficient fans
- EcoShine II Plus LED canopy lights† (not available with narrow canopy)
- Solar digital thermometer
- Please reference color chart for choice of standard Husmann paint and finish options

Options.

- Modular adjustable glass or black shelves (18", 24", 30", 48", 60" lengths)
- 4" step for use with floral vases
- Floral vases 8" diameter X 13" tall and/or 7" diameter X 10" tall
- EcoShine II Plus LED shelf lights†
- Liquid line hand valve
- Thermostat
- Solid ends
- View ends
- End panel, flush (inline)
- End panel with wrap around bumper (inline)
- Solid transition panel (between dissimilar temp modules)
- Counter transition panel (partial end panel – when adjacent to floral prep counter modules)
- Finished exterior back cover (inline)
- Painted, stainless steel
- Special interior and exterior finishes* (consult your Husmann sales representative)

Additional Information.

- Matching companion case lines: **ISLA Family**
Hot Self-Service Food Counter: **IM-FH**
Hot Self-Service Multi-Deck: **IM-H**
Refrigerated Self-Service Food Counter: **IM-FR**
Self-Contained Refrigerated Self-Service Multi-Deck: **IM-S**
Soup Self-Service Food Counter: **IM-FS**
Refrigerated/Dry Self-Service Bakery: **IM-BV**
Self-Service Frozen: **SFG/SFNG**



Husmann refrigerated merchandisers configured for sale for use in the United States meet or surpass the requirements of the DOE 2017 energy efficiency standards.

* Some optional features may need to be certified by UL, NSF, and/or other 3rd party certification agencies. Contact Husmann for verification or questions for availability.

a Based on SCE test report 9/1997.

Only lighting configurations that are compliant with the U.S. Dept. of Energy (DOE) 2017 regulation are available for sale for use in the U.S.A.

NOTE: These merchandisers are designed for use in stores when temperature and humidity do not exceed 75°F and 55% R.H. We reserve the right to change or revise specifications and product design in connection with any feature of our products. Such changes do not entitle the buyer to corresponding changes, improvements, additions, or replacements for equipment previously sold or shipped.

For additional resources, contact your representative or visit www.husmann.com.



Note.

Use Husmann's technical data sheets to get precise dimensions for all store layout purposes.

Intertek

Intertek

HUSMANN®

Husmann Specialty

13770 Ramona Avenue
Chino, California 91710-5423
Ph: 800.395.9229

www.husmann.com