

**HUSSMANN®**

---

Specialty



DELIGHT C-Series

# Pastry and Bagel Wall Case

Dry, 2 Bagel Bin levels, Self-Service Bakery Display

---

[www.hussmann.com](http://www.hussmann.com)

# Dry, 2 Bagel Bin levels, Self-Service Bakery Display

## Pastry & Bagel Wall Case

### Matching Product Platform

Multiple bakery application solutions with matching contours that is Case is ETL certified to safety (UL-65) and sanitation (NSF-2) standards



### Functional Design

Trash, tissue, bag and box designed into front package ledge, LED lighted shelves

### Merchandising Flexibility

Open shelving for packaged products and enclosed shelving for unwrapped products



### Shopper Friendly Hinge Design

- Easy to open, low effort, self closing mechanism
- Minimized hardware profile unobstructs and maximizes product views
- Tight, no gap fit minimizes infiltration
- Improved reliability reduces maintenance costs

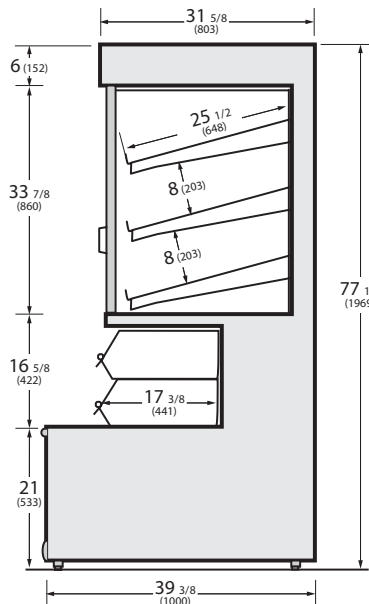

### Lengths.

48" (DZP-C-48-77-W)

57" (DZP-C-48-77-W)

75" (DZP-C-48-77-W)

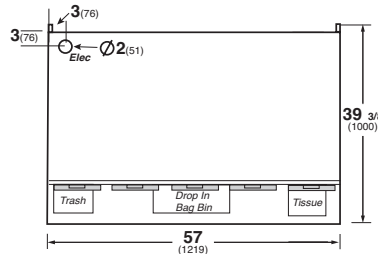

### Features.

- Tray support shelving system
- Three adjustable lighted levels of shelving - Adjustable in 1" increments
- 2 levels of acrylic bagel bins
- Two (59"/48" unit) or three (75" unit) 3/16" tempered glass front swinging doors with spring loaded self closing hinges
- Package ledge includes two (2) tissue cubbies, trash container and cubbie for boxes
- Mirror back, mirror angled canopy
- Mirror end panels
- 1" & 3" bumper
- Insect deterrent fan assembly
- Junction box for field wiring
- Please reference color chart for choice of standard Hussmann paint and finish options ([www.hussmann.com](http://www.hussmann.com))

### Options.

- 10' cord & plug
- Color bumper options (McCue)
- Special interior and exterior finishes\* (consult your Hussmann sales representative)

### C-Series companion cases.

- Pastry Wall Case
- Artisan Bread Wall Case

### Electrical Specifications:

Width	Volts	Phase	Hertz	Amps	Opt. Fan
48"	120	1	60	1.31	+0.35
57"	120	1	60	1.31	+0.35
57"	120	1	60	2.50	+0.35

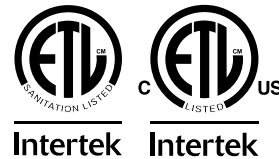

\* Some optional features may be certified by UL, NSF, and/or other 3rd party certification agencies. Contact Hussmann for verification or requests for such certification.

NOTE: These merchandisers are designed for use in stores when temperature and humidity do not exceed 75°F and 55% R.H. We reserve the right to change or revise specifications and product design in connection with any feature of our products. Such changes do not entitle the buyer to corresponding changes, improvements, additions, or replacements for equipment previously sold or shipped.

For additional resources, contact your representative or visit [www.hussmann.com](http://www.hussmann.com).

**HUSSMANN®**

### Hussmann Corporation

13770 Ramona Avenue  
Chino, California 91710-5423  
800.385.9229

[www.hussmann.com](http://www.hussmann.com)