

**HUSSMANN®**

---

Specialty



---

*Q-Series Family*

**Q3-DV**

Multi-Deck Service Merchandiser  
with Vertical Glass for Deli Applications

---

[www.hussmann.com](http://www.hussmann.com)

# Hussmann Q-Series Multi-Deck Service Merchandiser with Vertical Glass for Deli Applications

## Q3-DV



**Stunning Product Visibility**  
Increase sales with all glass merchandising display that ensures stunning product visibility

**Designed to Maximize Creative Merchandising**  
Vertical glass cube design allows for interchangeable merchandising solutions:

- Single Shelf Display
- Two Shelf Display
- Bulk Display
- Step Display
- Accessories

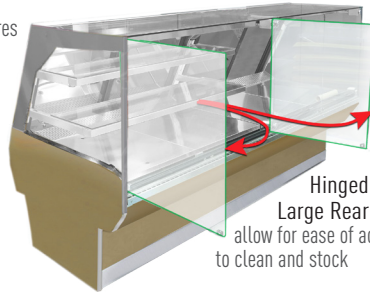

**Reduce Maintenance**  
with elimination of lift-up glass hardware

**Hinged French Doors and Large Rear Sliding Doors**  
allow for ease of access to clean and stock

**Increase Sales with FocalPoint™ (Patent Pending)**  
New adjustable multi-directional LED canopy light

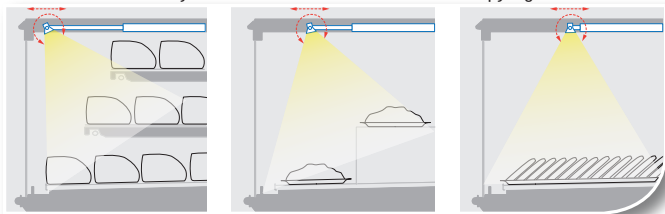

Standard Lighting

NEW FocalPoint™ LED Lighting

Provides the most effective way to highlight product facings across interchangeable merchandising



**Remote: 4' (Q3-DV-4R), 6' (Q3-DV-6R), 8' (Q3-DV-8R), 12' (Q3-DV-12R)**

### Q3-DV Multi-Deck Service Deli Case

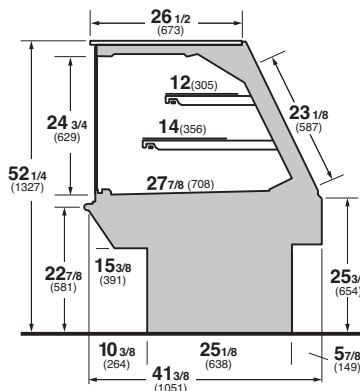

### Q3-DV, BV

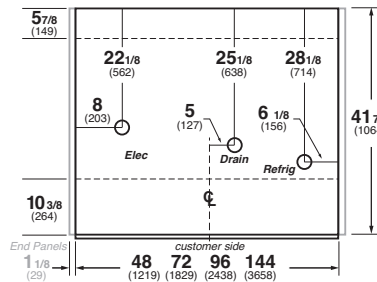

## Features.

- Front hinged french tempered glass doors
- 3/8" tempered glass top
- Clear glass rear sliding doors
- NEW FocalPoint™ adjustable LED canopy light (*Patent Pending*)
- Stainless steel interior
- Heated air sweep
- Painted lower front panel
- Black thermoplastic front ledge
- Black vinyl cart bumper
- Modular coil system (5-year warranty)
- Coil corrosion protective coating (deli)
- Energy efficient fan motors
- Thermostat and suction stop solenoid
- Please reference color chart for choice of standard Hussmann paint and finish options ([www.hussmann.com](http://www.hussmann.com))

## Options.

- 12" and 14" lighted glass or stainless mezzanine shelves
- LED lighting for shelves and ledge lights†
- Additional LED canopy light in rear top of case
- Mirrored rear sliding doors
- Adjustable heights for Q-Series families
- View or solid ends
- Mirror finish stainless steel inside end panels
- Dedicated scale outlet and Cat 5 scale connections
- Thermoplastic wrapping board
- 15 amp GFCI duplex outlets
- Liquid line shut-off hand valve
- Special interior and exterior finishes\* (consult your Hussmann sales representative)

## Additional information.

- Matching companion case lines: **Q-Series Family**
- Multi-Deck Service Bakery Vertical Glass: **Q3-BV**
  - Single-Deck Service Deli Straight Glass: **Q1-DS**
  - Service Hot Curved Glass: **QHC**
  - Service Meat or Seafood Curved Glass: **Q1-MC or Q1-FC**
  - Single-Deck Self-Service: **Q1-SS**
  - Multi-Deck Service Deli Curved Glass: **Q3-DC**
  - Multi-Deck Service Bakery Curved Glass: **Q3-BC**
  - Multi-Deck Self-Service: **Q3-SS or Q4-SS**
  - Multi-Deck Self-Service Front with Service Prep Top: **Q3-SP**

**DOE 2017 Energy Efficiency Compliant**

Hussmann refrigerated merchandisers configured for sale for use in the United States meet or surpass the requirements of the DOE 2017 energy efficiency standards.

\* Some optional features may need to be certified by UL, NSF, and/or other 3rd party certification agencies. Contact Hussmann for verification or questions for availability.

† Only lighting configurations that are compliant with the U.S. Dept. of Energy (DOE) 2017 regulation are available for sale for use in the U.S.A.

NOTE: These merchandisers are designed for use in stores when temperature and humidity do not exceed 75°F and 55% R.H. We reserve the right to change or revise specifications and product design in connection with any feature of our products. Such changes do not entitle the buyer to corresponding changes, improvements, additions, or replacements for equipment previously sold or shipped.

For additional resources, contact your representative or visit [www.hussmann.com](http://www.hussmann.com).



Note.

Use Hussmann's technical data sheets to get precise dimensions for all store layout purposes.

**Intertek Intertek**

**HUSSMANN®**

Hussmann Corporation  
13770 Ramona Avenue  
Chino, California 91710  
Ph: 800.395.9229

[www.hussmann.com](http://www.hussmann.com)