

**HUSSMANN®**

---

Specialty



*Q-Series Family*

**Q3-MV-EP**  
**Q3-F V-EP**

Q-Series Multi-Deck Merchandiser  
with Vertical Glass for Meat or Seafood (non-ice) Applications

*Enhanced Performance with **OptiCool™** Technology*

---

[www.hussmann.com](http://www.hussmann.com)

# Hussmann Q-Series Multi-Deck Merchandiser with Vertical Glass for Meat or Seafood (non-ice) Applications

## Q3-MV-EP, Q3-FV-EP



### EXTENDED Bloom

For optimum performance, reference the merchandising requirements †

#### Enhanced performance with OptiCool™ Technology

- Reduces dehydration by 60%‡
- Increases humidity by 12%‡
- Reduces temperature variance‡

#### Reduced System

##### Complexity & Costs

- Simple installation
- All DX refrigeration at +28° F evap ‡
- No glycol pump station required

##### Merchandising Flexibility

Adjustable deep deck with slanted spiral coil



#### Stunning Product Visibility

Increase sales with all glass merchandising display that ensures stunning product visibility

#### Merchandising Flexibility

Easy in and out shelf provides a quick addition to add packout for specials or seasonal products.

#### Increase Sales with FocalPoint™ (Patent Pending)

##### New adjustable multi-directional LED canopy light

- EcoShine II Plus LEDs (Standard)
- 85+ CRI for bringing out natural colors (especially meat, deli and seafood)
- Increased reliability with industry leading IP67 certification

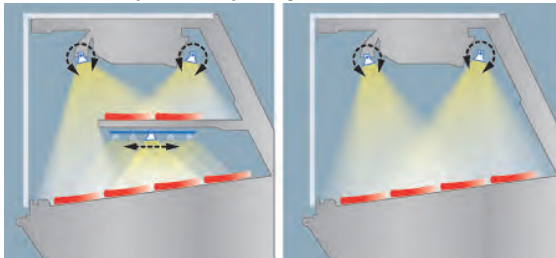

Provides the most effective way to highlight product facings across interchangeable merchandising

#### Remote Lengths: 4', 6', 8', and 12'

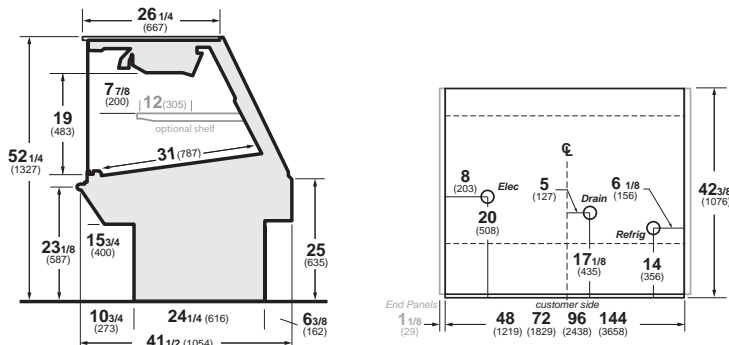

#### Features.

- Front hinged french tempered glass doors
- 3/8" tempered glass top
- Clear glass rear sliding doors
- Gravity/conduction coil (Meat/Fish: non-ice application)
- Focal Point EcoShine II 1067 rated LED lights
- Front glass air sweep
- Stainless steel interior
- Stainless steel rear exterior panels
- Adjustable deck for flexible merchandising
- Painted front panels
- Black vinyl cart bumper
- Dual digital thermostat and suction stop solenoid to maintain optimal temps for shelf life
- Please reference color chart for choice of standard Hussmann paint and finish options ([www.hussmann.com](http://www.hussmann.com))

#### Options.

- Automatic or manual water flush (reduces the need for manual case cleaning)
- Mirrored rear sliding doors
- Adjustable heights for Q-Series families
- View or solid ends
- 12" stainless steel removable 'Easy Shelf'
- Mirror finish stainless steel inside end panels
- Dedicated scale outlet and Cat 5 scale connections
- Thermoplastic wrapping board
- 15 amp GFCI duplex outlets
- Liquid line shut-off hand valve
- Special interior and exterior finishes\* (consult your Hussmann sales representative)

#### Additional Information.

- Q-Series Entire Family: Q-Series Family

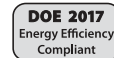

Hussmann refrigerated merchandisers configured for sale for use in the United States meet or surpass the requirements of the DOE 2017 energy efficiency standards.

† Performance results based on equivalent standard Hussmann models without optional shelving

Some optional features may need to be certified by UL, NSF, and/or other 3rd party certification agencies. Contact Hussmann for verification or questions for availability.

NOTE: These merchandisers are designed for use in stores when temperature and humidity do not exceed 75°F and 55% R.H. We reserve the right to change or revise specifications and product design in connection with any feature of our products. Such changes do not entitle the buyer to corresponding changes, improvements, additions, or replacements for equipment previously sold or shipped.

For additional resources, contact your representative or visit [www.hussmann.com](http://www.hussmann.com).



Note. Use Hussmann's technical data sheets to get precise dimensions for all store layout purposes.

# HUSSMANN®

Hussmann Specialty  
13770 Ramona Avenue  
Chino, California 91710-5423  
Ph: 1-800.395.9229

[www.hussmann.com](http://www.hussmann.com)