



Q-Series Family

Q4-DV

High Volume Multi-Deck Service Merchandiser
with Vertical Glass for Deli Applications

Husmann Q-Series High Volume Multi-Deck Service Merchandiser with Vertical Glass for Deli Applications

Q4-DV

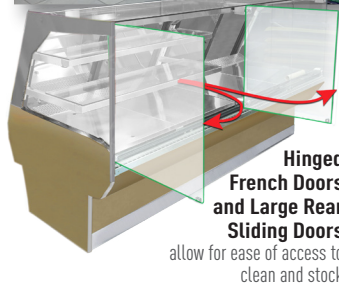

Stunning Product Visibility

Increase sales with all glass merchandising display that ensures stunning product visibility

Reduce Maintenance
with elimination of lift-up glass hardware

Designed to Maximize Creative Merchandising

Vertical glass cube design allows for interchangeable merchandising solutions:

- Single Shelf Display
- Two or Three Shelf Display
- Bulk Display
- Step Display
- Accessories

Increase Sales with FocalPoint™ (Patent Pending)

New adjustable multi-directional LED canopy light

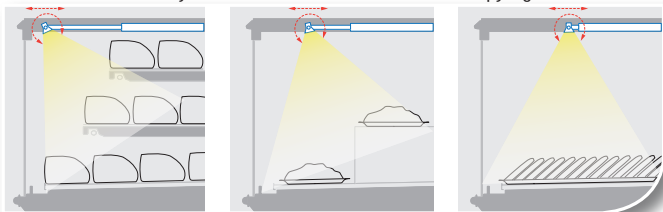

Standard Lighting

NEW FocalPoint™ LED Lighting



Provides the most effective way to highlight product facings across interchangeable merchandising

Remote: 4' (Q4-DV-4R), 8' (Q4-DV-8R), 12' (Q4-DV-12R)

Q4-DV Multi-Deck Service Deli Case

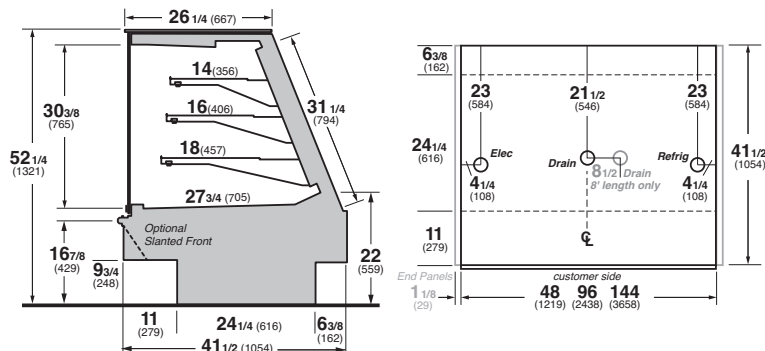

Features.

- Front hinged french tempered glass doors
- 3/8" tempered glass top
- Clear glass rear sliding doors
- NEW FocalPoint™ adjustable LED canopy light (*Patent Pending*)
- Stainless interior
- Heated air sweep
- Painted flat lower front panel
- Black thermoplastic front ledge
- Black vinyl cart bumper
- Modular coil system (5-year warranty)
- Energy efficient fan motors
- Thermostat and suction stop solenoid
- Please reference color chart for choice of standard Husmann paint and finish options (www.husmann.com)

Options.

- 14", 16" and 18" lighted glass or stainless steel mezzanine shelves
- LED lighting for shelves and ledge lights
- Additional LED canopy light in rear top of case
- Mirrored rear sliding doors
- Painted slanted lower front panel
- Adjustable base heights for Q-Series families
- View or solid ends
- Mirror finish stainless steel inside end panels
- Dedicated scale outlet and Cat 5 scale connections
- Thermoplastic wrapping board with adjustable height brackets
- 15 amp GFCI duplex outlets
- Liquid line shut-off hand valve
- Special interior and exterior finishes* (consult your Husmann sales representative)

Additional information.

Matching companion case lines: Q-Series Family
- Self-Service: Q3.5-SS



Husmann refrigerated merchandisers configured for sale for use in the United States meet or surpass the requirements of the DOE 2017 energy efficiency standards.

* Some optional features may be certified by UL, NSF, and/or other 3rd party certification agencies. Contact Husmann for verification or requests for such certification.

NOTE: These merchandisers are designed for use in stores when temperature and humidity do not exceed 75°F and 55% R.H. We reserve the right to change or revise specifications and product design in connection with any feature of our products. Such changes do not entitle the buyer to corresponding changes, improvements, additions, or replacements for equipment previously sold or shipped.

For additional resources, contact your representative or visit www.husmann.com.



Note.
Use Husmann's technical data sheets to get precise dimensions for all store layout purposes.

Intertek Intertek

HUSMANN®

Husmann Specialty
13770 Ramona Avenue
Chino, California 91710-5423
Ph: 1-800.395.9229

www.husmann.com