

HUSSmann®

Specialty



R3 Family

R3M, CR3M
R3F, CR3F

3 Zone - High Volume Service Meat/Seafood Top,
Multi-Deck, Self-Service Front Merchandiser
with Refrigerated or Dry Rear Storage - Curved or Straight Glass

www.hussmann.com

Hussmann R3 Family - High Volume Service Meat/Seafood Top, Multi-Deck, Self-Service Front Merchandiser with Refrigerated or Dry Rear Storage- Curved or Straight Glass

R3M, CR3M, R3F, CR3F



Product Integrity

All metal construction, 5 year warranty coils, and quality materials assure a long product life cycle.



Versatility

This 3 Zone Merchandiser sets the pace for its segment. It allows for self-service, service, and extra storage all in a small footprint. Having a full range of configurations atop a high-capacity self-service case, the R3 Family redefine what a merchandiser should be.



Clear View

Heated air sweep eliminates glass sweating maintaining a clear, unobstructed view to product.

Remote Lengths:

4', 5', 6', 8', 10', and 12'

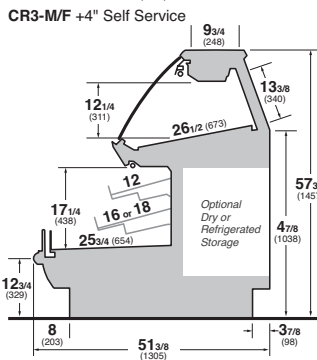
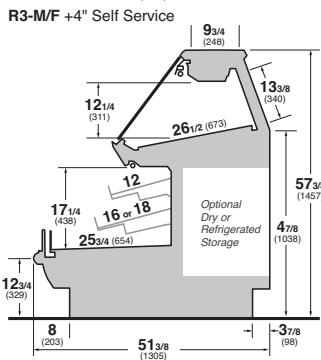
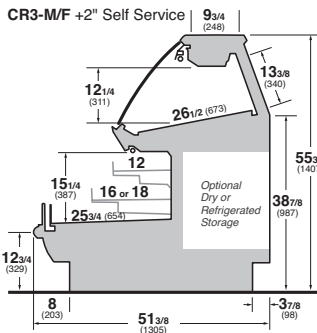
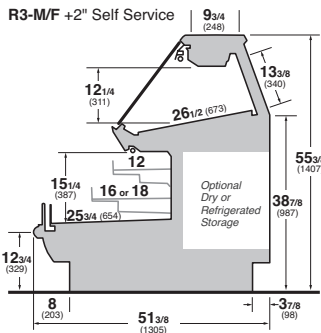
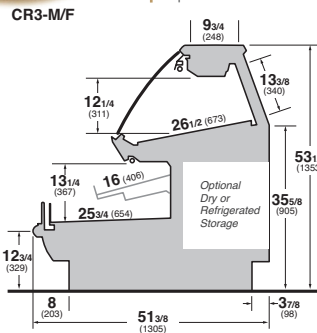
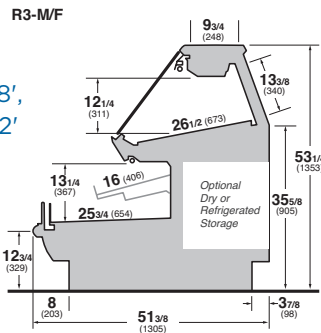

Optional Lobster Tank
Marineland-sourced component for R3F.

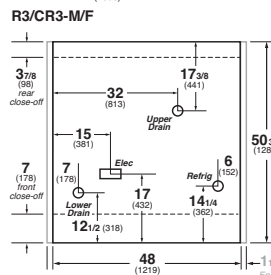

Features.

- Non-glare lift up glass (standard R3, optional for CR3)
- Heated air sweep (service)
- Adjustable legs
- Black interior (self-service)
- Stainless steel interior (service)
- Snap-on, stainless steel lower rear panel
- Thermostat/suction stop solenoid (service)
- EPR - refrigerated self-service
- Digital thermometers in each refrigerated section
- LED shelf and canopy lighting †
- Energy efficient fans
- 15 amp scale outlet
- RJ45 communication outlet
- Dry rear storage
- GFCI outlet
- Please reference color chart for choice of standard Hussmann paint and finish options (www.hussmann.com)

Options.

- Easily movable 14" or 16" shelves; angle adjustable from 0° to 15° with recessed plugs (self-service)
- Coil corrosion protective coating (service section)
- Refrigerated rear storage with additional coil, thermostat and liquid line solenoid
- No rear storage
- Stainless steel or white interior (self-service)
- Thermoplastic wrapping boards
- Scale shelf extension
- +2 or +4 -Increased self-service capacity (2" or 4" plus heights") (4" allows 2nd row of 8", 10", 12", 14" or 16" shelf)
- Solid or view end panels
- Paper cutter
- PTM - shelf and/or low front
- Additional GFCI outlet
- Mirrored rear doors
- Lobster tank for R3 (Marineland)
- Stainless steel top in lieu of glass
- Custom lengths and options*
- Special exterior finishes* (consult your Hussmann sales representative)

Additional Information.

- Matching family members: R3 Family or CR3 Family
- Hot Service with Self-Service Front: R3H or CR3H
- Service Bakery with Self-Service Front: R3B or CR3B
- High Volume Wide or Narrow Service Bakery with Self-Service Front: R3HV-WB or R3HV-NB or CR3HV-WB or CR3HV-NB
- Service Prep Top with Self-Service Front: R3P or CR3P
- High Volume Service Meat/Seafood with Self-Service Front with Gravity Coil: R3HV-M, R3HV-F or CR3HV-M, CR3HV-F
- Service Deli with Self-Service Front: R3D or CR3D
- High Volume Wide or Narrow Service Deli with Self-Service Front: R3HV-WD or R3HV-ND or CR3HV-WD or CR3HV-ND



Hussmann refrigerated merchandisers configured for sale for use in the United States meet or surpass the requirements of the DOE 2017 energy efficiency standards.

* Some optional features may need to be certified by UL, NSF, and/or other 3rd party certification agencies. Contact Hussmann for verification or questions for availability.

† Only lighting configurations that are compliant with the U.S. Dept. of Energy (DOE) 2017 regulation are available for sale for use in the U.S.A.

NOTE: These merchandisers are designed for use in stores when temperature and humidity do not exceed 75°F and 55% R.H. We reserve the right to change or revise specifications and product design in connection with any feature of our products. Such changes do not entitle the buyer to corresponding changes, improvements, additions, or replacements for equipment previously sold or shipped.

For additional resources, contact your representative or visit www.hussmann.com.



Intertek **Intertek**

Note.

Use Hussmann's technical data sheets to get precise dimensions for all store layout purposes.

HUSSMANN®

Hussmann Specialty
13770 Ramona Avenue
Chino, California 91710-5423
Ph: 800.395.9229

www.hussmann.com