

## FHM, FHMG, FHMS, FHMSG MHF, MHFG, MHFH & MHFGH

# Joint Kit

### PARTS LIST

| Item | Quantity                |                             | Description                           |
|------|-------------------------|-----------------------------|---------------------------------------|
|      | MHF, MHFH<br>FHM & FHMS | MHFG, MHFGH<br>FHMG & FHMSG |                                       |
| 1.   | 2                       | 2                           | 1/2 x 1/2 x 120-in. Gasket            |
| 2.   | 1                       | 1                           | Front Panel Joint Trim                |
| 3.   | 1                       | 1                           | Rubrail Joint Trim                    |
| 4.   | 1                       | 1                           | Fascia Joint Trim                     |
| 5.   | 1*                      | 1*                          | Ambient Plenum Joint Trim             |
| 6.   | 6                       | 6                           | 3/8-16 x 1 1/4 Cap Screw              |
| 7.   | 12                      | 12                          | 3/8 Flat Washer                       |
| 8.   | 6                       | 6                           | 3/8-16 Hex Nut                        |
| 9.   | 10                      | 8                           | #8 x 1/2 Truss Head Sheet Metal Screw |
| 10.  | —                       | 1                           | #10-24 x 2 1/4 Machine Screw          |
| 11.  | —                       | 1                           | #10-24 Wing Nut                       |
| 12.  | 1                       | 1                           | Butyl Tape (1/16 x 2 x 49-in.)        |
| 13.  | 1**                     | 1**                         | Light Channel Retainer                |

\* Supplied with FHM, FHMS, FHMG & FHMSG models only.

\*\* Supplied with MHF, MHFH, MHFG & MHFGH models only.

## Installation Instructions

**STEP 1.** Apply the Gasket (1) around the perimeter of the merchandiser as shown and as follows:

- a. Apply the gasket to metal surfaces only.
- b. Recess the gasket approximately 1/8-inch in from the exterior surfaces.
- c. Avoid splicing the gasket on horizontal runs.
- d. Do not stretch gasket around corners.
- e. Remove the paper backing after gasket is applied.

**STEP 2.** After the first merchandiser has been leveled in its permanent location, move the joining merchandiser firmly against the first to compress the gasket for a good seal.

**STEP 3.** Fasten the two merchandisers together through their end frame joining holes with Cap Screws (6), Flat Washers (7), and Hex Nuts (8).

**CAUTION: DO NOT USE THE CAP SCREWS  
TO PULL THE MERCHANDISERS TOGETHER.  
DAMAGE TO THE MERCHANDISER AND  
END FRAME DISTORTION  
CAN RESULT.**

**STEP 4.** Install the Front Panel Joint Trim (2) centered over the merchandiser joint and fasten using Screws (9).

**STEP 5.** Install Rubrail Joint Trim (3) as follows:

Merchandisers Without Glass Fronts

Place rubrail joint trim centered over merchandiser joint. Drill pilot holes into rubrail and fasten trim with Screws (9).

Merchandisers With Glass Fronts

Place rubrail joint trim centered over merchandiser joint. Insert Screw (10) through hole in trim and fasten in place with Wing Nut (11).

- STEP 6.** Sealing the joint seams; see Detail A. Apply the Butyl Tape (12) over the end frame joint as follows:
- Remove the tape's paper backing as it is applied.
  - Press the tape (Mylar side up) firmly onto the end frames especially in the center where the merchandisers join.
  - Run the tape continuously the full width of the end frames including the saddle and 3 inches up at the front and rear.
  - DO NOT apply the tape over the removable front shelf supports.
- STEP 7.** Install the Fascia Joint Trim (4) centered over the fascia joint and fasten with Screws (9).
- STEP 8. FHM, FHMG, FHMS & FHMSG Models Only**—Install the Ambient Plenum Joint Trim (5) centered over the joint of those merchandisers with an ambient plenum and fasten with Screws (9).
- STEP 9. MHF, MHFH, MHFG & MHFGH Only**—Remove the screw near the end of each of the joining light channels. Position the Light Channel Retainer (13) so that it straddles the two channels as shown (Detail B). Secure with the screws previously removed.

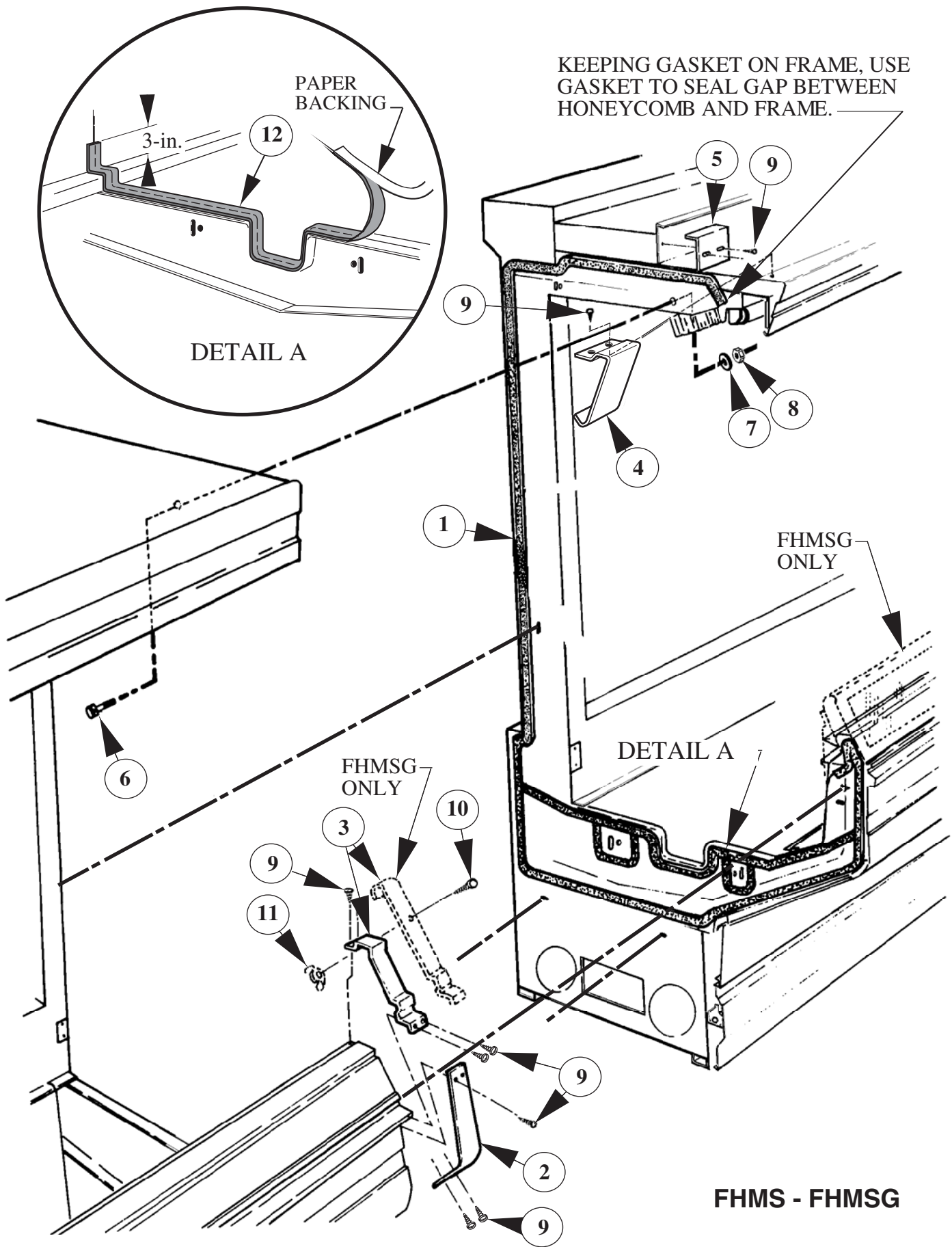

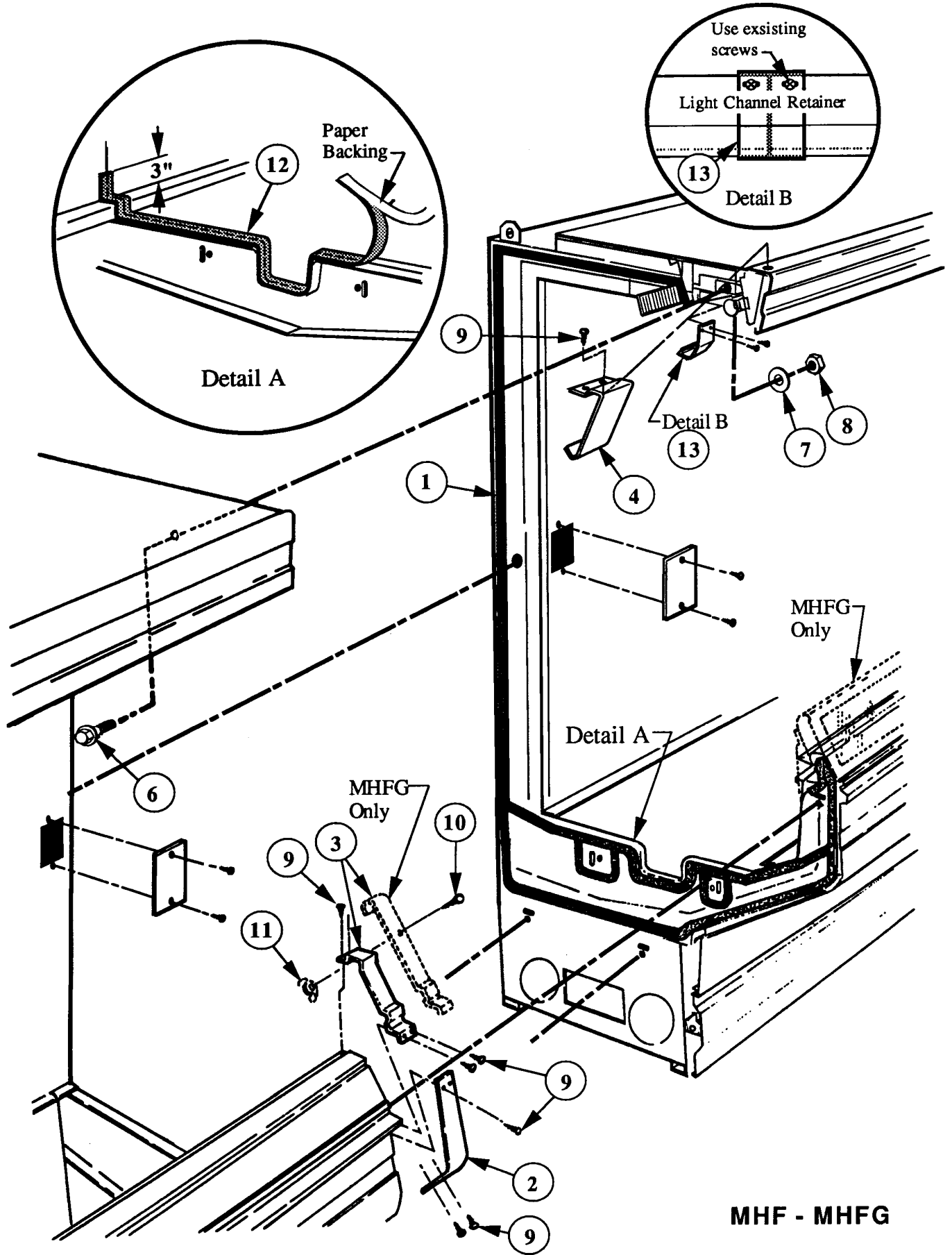

MHF - MHFG

