

**PARTS LIST**

Item	Quantity	Description
1.	1	Retainer, Top Left
2.	6	Screw, #8 x 1/2
3.	1	Acrylic Partition
4.	1	Retainer, Top Right
5.	10	Machine Screw, 1/4-20 x 1/2
6.	20	Flat Washer 1/4
7.	10	Hex Nut, Locking 1/4-20
8.	1	Retainer, Bottom Left
9.	1	Retainer, Bottom Right
10.	1	Retainer, Top Front Left
11.	1	Retainer, Top Front Right
12.	1	Retainer, Closeoff



**NOTES:** Acrylic partitions are most often used in a line-up to separate cases with different refrigeration defrost cycles, and are installed as cases are joined. Joining instructions are provided separately.

Be sure merchandisers have been leveled according to the installation instructions. Carefully unpack and inspect the acrylic partition and components to ensure there is no breakage or damage.

- 1** Remove items from case as shown in Figure 1.
  - A. Remove bumpers, rails, packing materials, and splashguards from the case.
  - B. Remove shelves (if installed).
  - C. Remove display racks and pans from end to be joined.
  - D. Remove back panels by lifting up and out near the bottom. No tools are necessary.

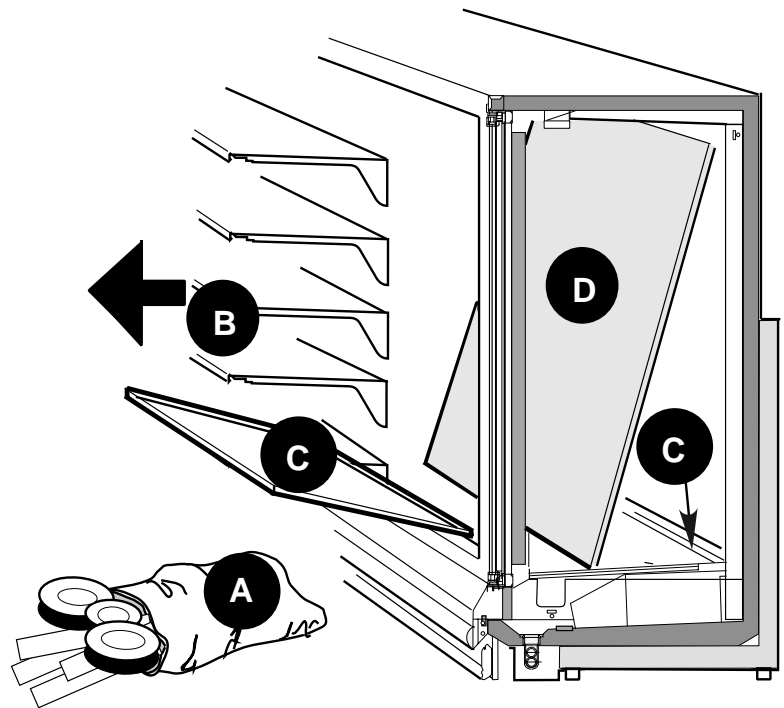

**Figure 1. Remove Parts**

**2** Position the **Top Left Retainer — 1** against the edge of the interior top panel of left case as shown in Figure 2. Fasten with **Screws — 2**.

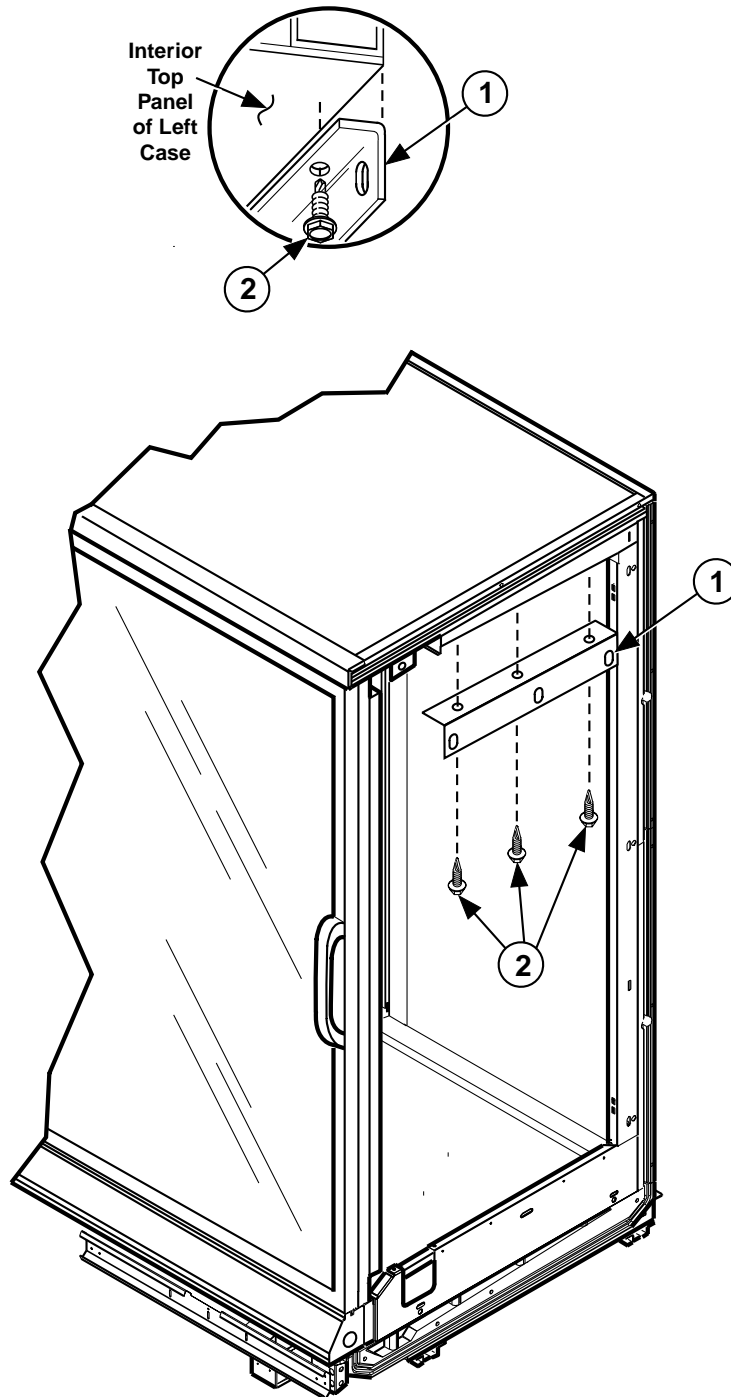

Note: A factory-installed acrylic partition may have a retainer attached to the back end frame and partition. It is not used in field installations.

**Figure 2. Install Top Retainer**

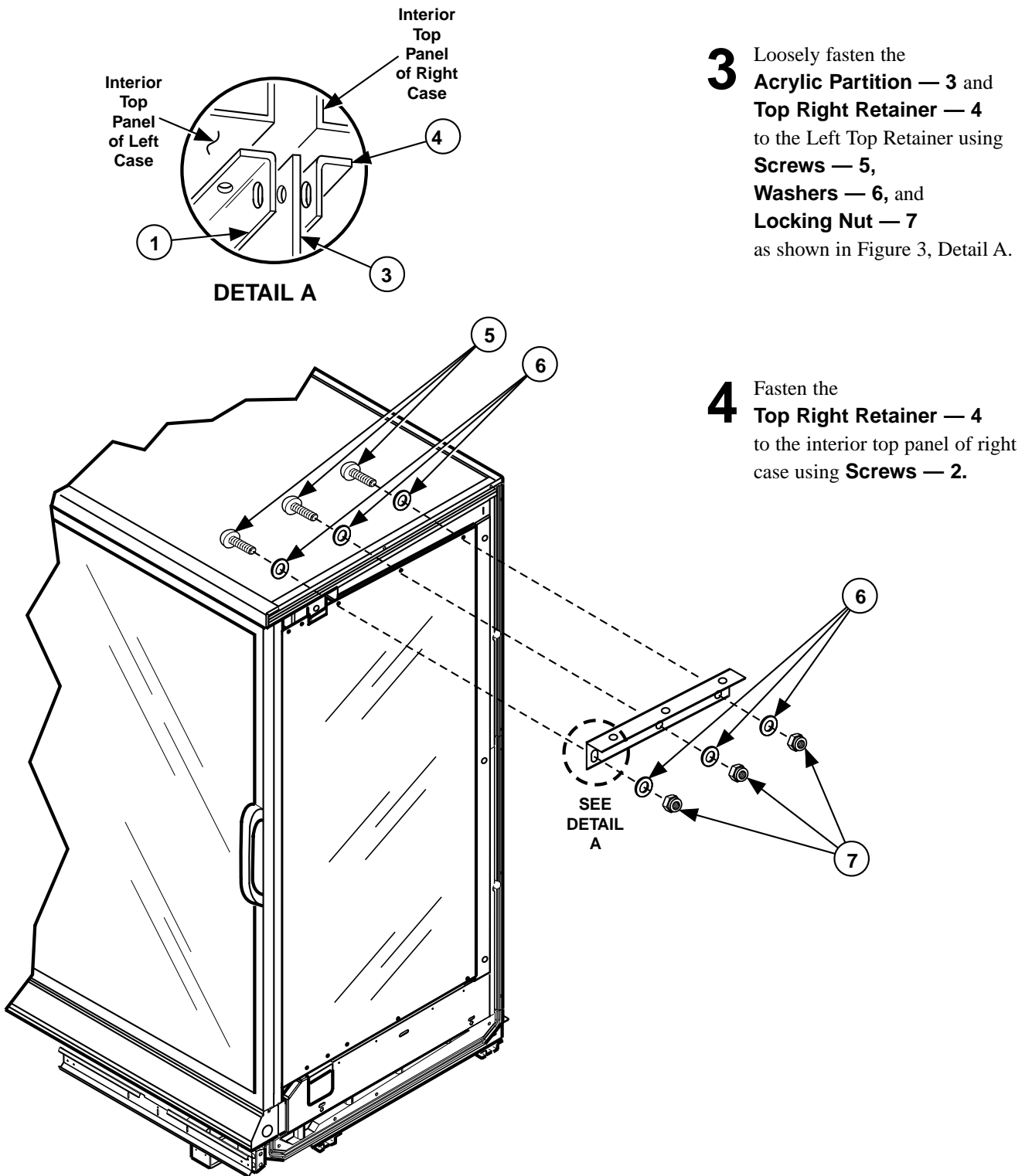
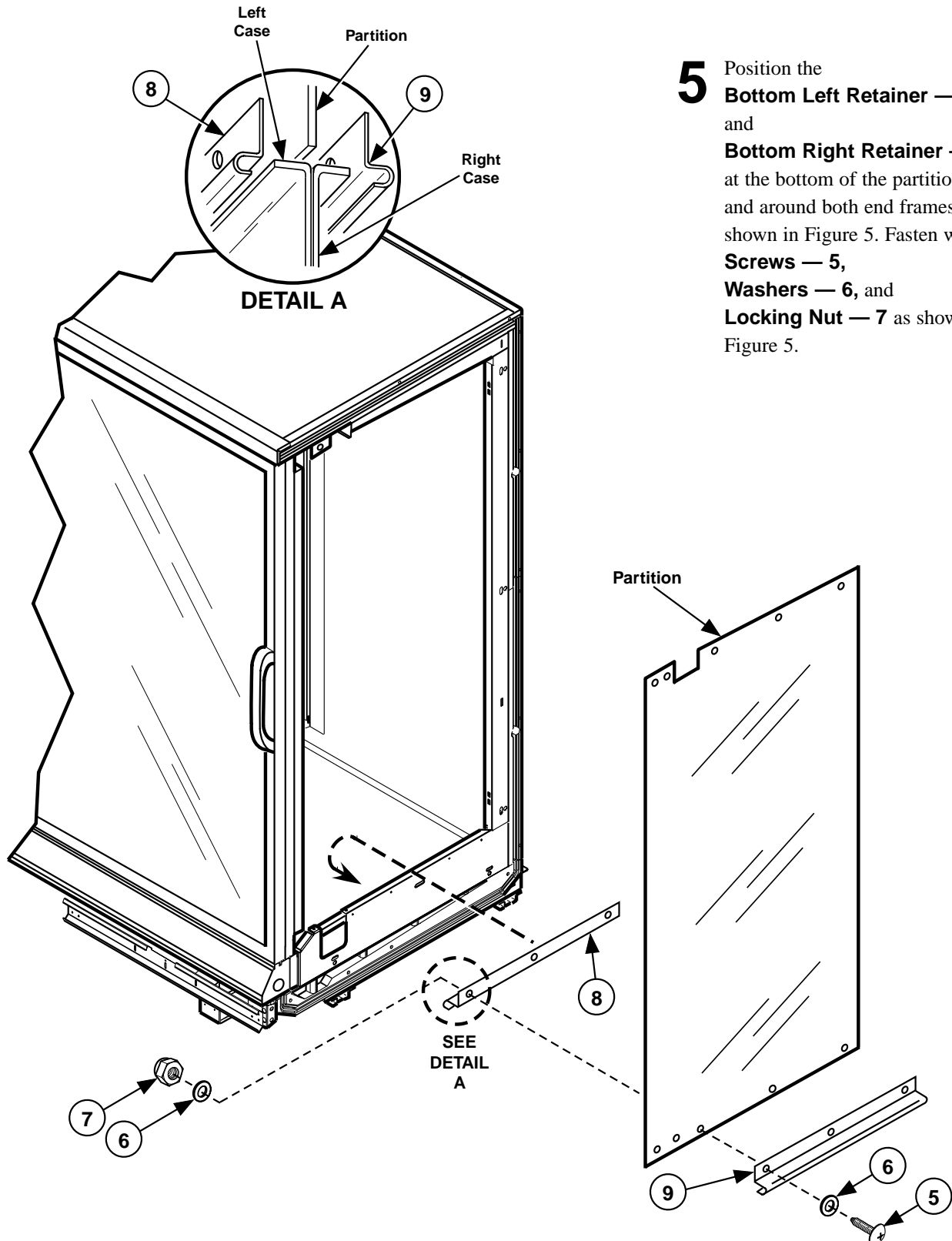

Figure 3. Install Partition



**5** Position the **Bottom Left Retainer — 8** and **Bottom Right Retainer — 9** at the bottom of the partition and around both end frames as shown in Figure 5. Fasten with **Screws — 5**, **Washers — 6**, and **Locking Nut — 7** as shown in Figure 5.

**Figure 4. Install Bottom Brackets**

- 6** Position the **Top Front Left Retainer — 10** and **Top Front Right Retainer — 11** at the top of the partition as shown in Figure 5. Fasten with **Screws — 5**, **Washers — 6**, and **Locking Nut — 7**.

Fasten the top of the retainer with the cap screw used to join the cases.

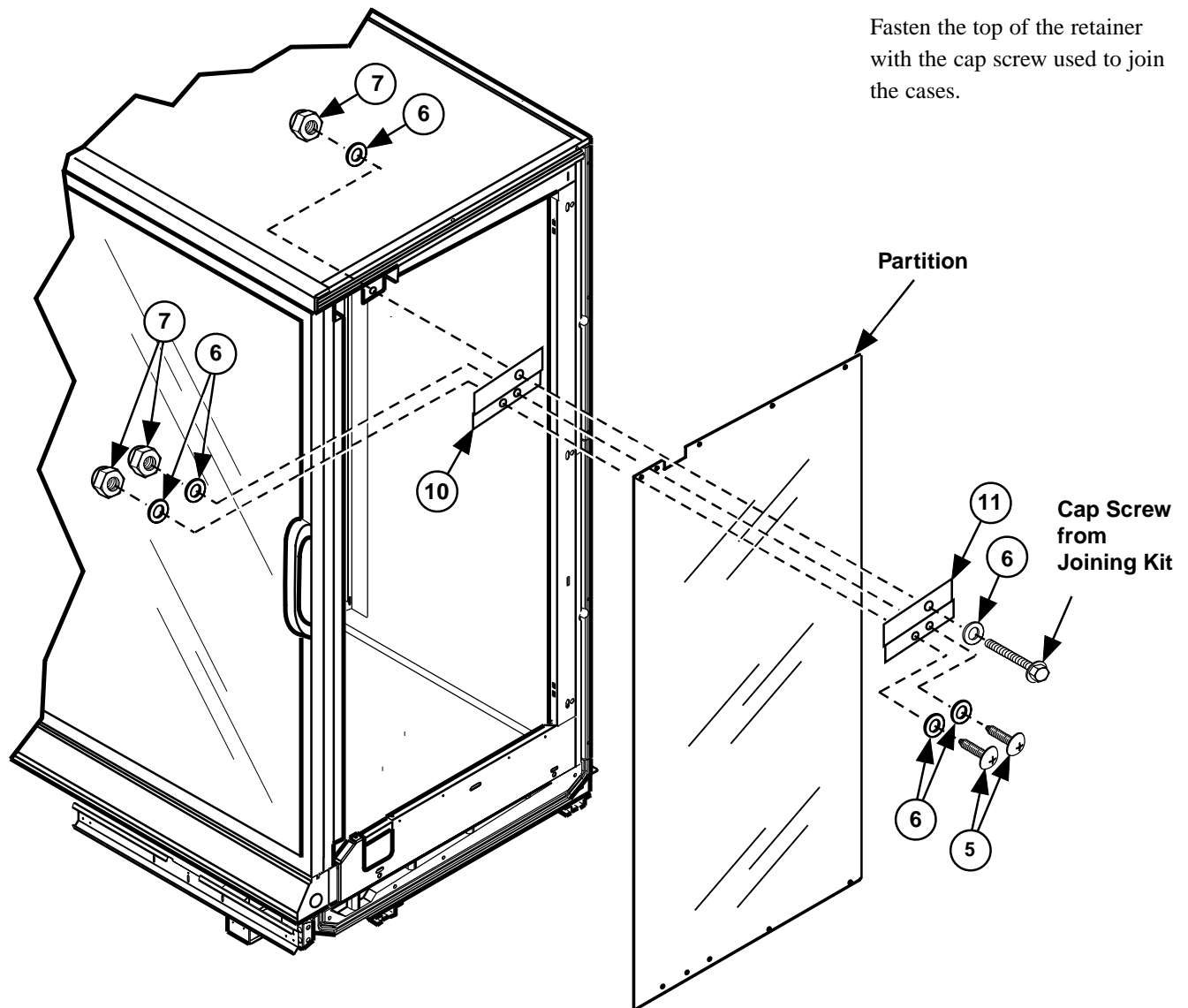
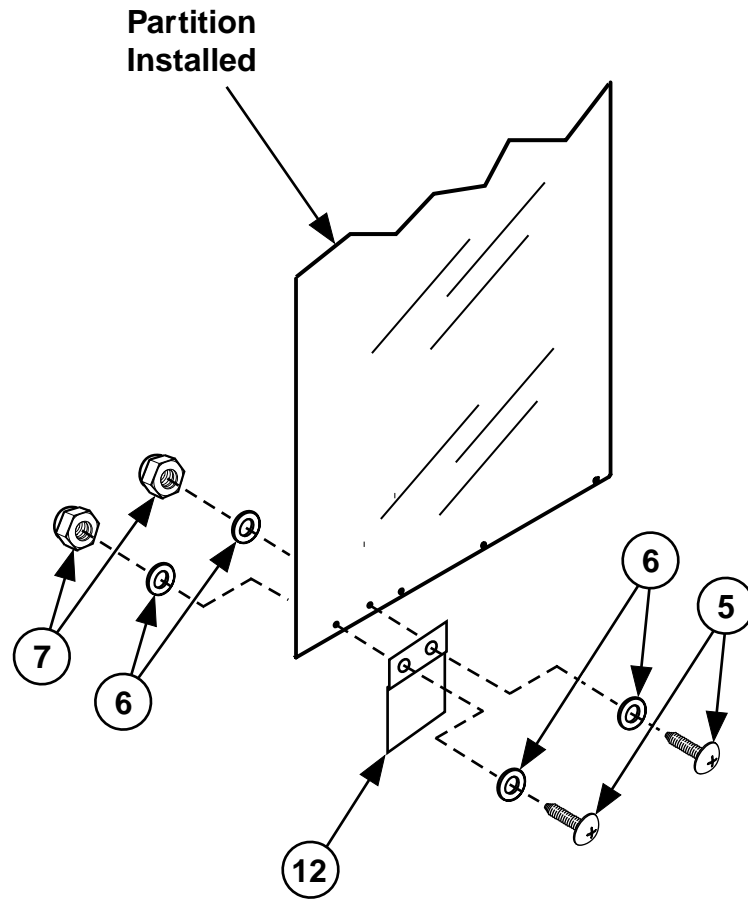

Figure 5. Install Top Front Retainers

**7** Position the **Closeoff Retainer — 12** at the bottom of the partition as shown in Figure 6. Fasten with **Screws — 5**, **Washers — 6**, and **Locking Nut — 7**.



**Figure 6. Install Closeoff Retainer**

Return to the joining instruction for fastener tightening sequence, joint molding installation and other steps necessary to complete lineup.