

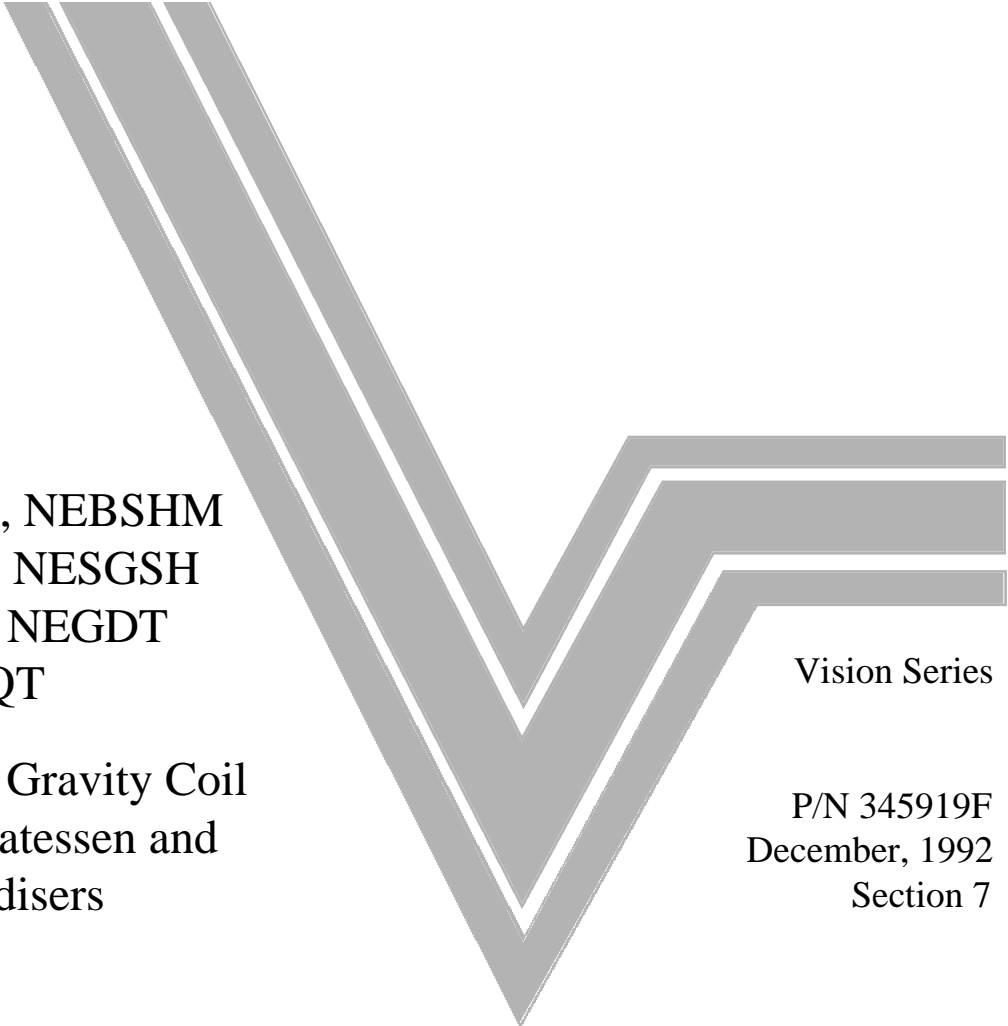

HUSSMANN®

Joint Assembly Instruction



NEBDH, NEBSH, NEBSHM
NESDH, NESSH, NESGSH
NEGDF, NEGSF, NEGDT
NEGDH & NEGQT

Curved Glass and Gravity Coil
Fresh Meat, Delicatessen and
Seafood Merchandisers

Vision Series

P/N 345919F
December, 1992
Section 7

JOINT ASSEMBLY

PARTS LIST

Item	Quantity							Description
	NEGDT & NEGDH	NEGSF	NEGDF	NEGQT	NEBSH, NESSH & NESGSH	NEBDH & NESDH	NEBSHM	
1.	2	2	2	2	2	2	2	Gasket 1/2 x 1 x 120
2.	-	2	2	-	-	-	-	Wiper Gasket
3.	-	1	1	-	-	-	-	Insulation Tape
4.	-	1	1	-	-	-	-	Silicone Sealer, 10 oz. Tube
5.	1	1	1	1	1	1	1	Joining Bracket Bolt
6.	2	2	2	2	2	2	2	Flat Washer
7.	1	1	1	1	1	1	1	Lock Washer
8.	1	1	1	1	1	1	1	Hex Nut
9.	4	4	4	4	4	4	5	Bolt 3/8-16 x 1 1/4
10.	4	4	4	4	4	4	5	Lockwasher 3/8 Split
11.	8	8	8	8	8	8	10	Flat Washer 3/8
12.	4	4	4	4	4	4	5	Hex Nut 3/8-16
13.	1	1	1	1	1	1	1	Butyl Tape 2 x 49
14.	1	1	1	1	1	1	1	Silicone Sealer, Cartridge
15.	-	-	-	-	1	1	-	Mounting Nut Plate
16.	-	-	-	-	1	1	-	Spanner Bar Joint
17.	-	-	-	-	1	1	-	Truss Head Machine Screw 5/16-18 x 3/4
18.	-	-	-	-	-	1	-	Top Joint Trim (Spanner Bar Bracket)
19.	-	-	-	-	-	2	-	Hex Head Sheet Metal Screw #8 x 1/2
20.	-	-	-	-	-	2	-	Oval Head Sheet Metal Screw #8 x 3/4
21.	-	-	-	-	4	-	-	Bolt 1/4-20 x 1/2
22.	-	-	-	-	1	1	-	Spanner Bar Gasket
23.	1	1	1	1	1	1	1	Door Track Joint Trim
24.	1	1	1	1	1	1	1	Rear Panel Joint Trim
25.	8	10	10	10	12	14	12	Truss Head Sheet Metal Screw #8 x 1/2
26.	-	1	1	-	-	-	-	Front Exterior Joint Trim
27.	-	-	-	-	1	1	-	Return Grill Joint Trim
28.	-	-	-	-	1	1	1	Light Reflector Trim
29.	-	-	-	-	2	2	2	Pop Rivet 1/8
30.	1	-	1	-	-	1	-	Top Rear Joint Trim
31.	-	1	-	-	1	-	1	Top Joint Trim
32.	-	1	1	-	-	-	-	Interior Joint Cover
33.	-	-	-	1	-	-	-	Glass Joint Trim
34.	-	-	-	1	-	-	-	Trim Joint

Important

Husmann's Vision Merchandisers feature *trimless joints*.

Proper use of Joining Brackets and strict adherence to these Instructions are required to achieve a quality installation.

NOTES:

Be sure Merchandisers have been leveled according to the installation instructions under *Leveling*.

Be sure the nut retainers used by the factory to install shipping braces have been removed.

STEP 1. Apply

Gasket - 1

around the perimeter of one of the merchandisers being joined. If they have different front heights, apply to merchandiser with lower front height.

- A. Recess gasket approximately $\frac{1}{8}$ inch in from exterior surfaces.
- B. Do not splice gasket on horizontal surfaces.
- C. Do not stretch gasket, especially around corners.
- D. Remove paper backing after gasket is applied.

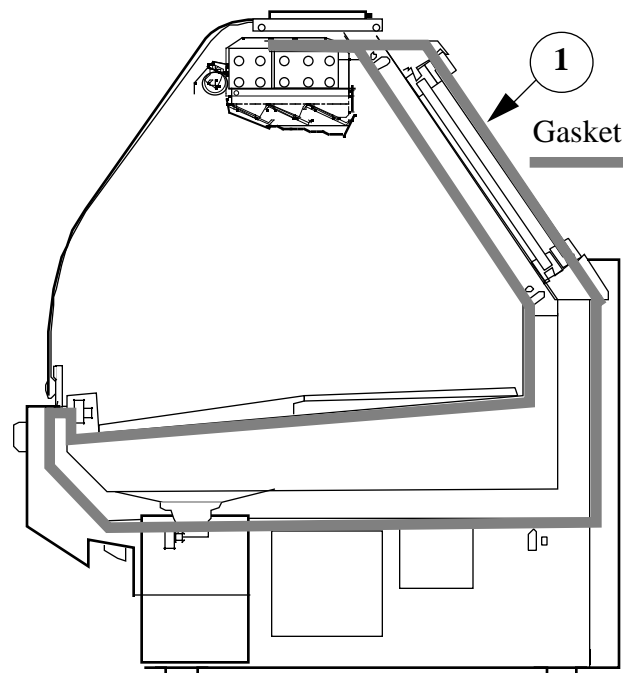

Figure 1. Installing Gasket

STEP 2. The complete lineup must be leveled to the highest point of the floor. After the first merchandiser has been set, slide the second up to it until the end frames touch.

Set a long level (4 foot or more) on the top rail of the merchandisers at the joint. Shim the free merchandiser so the edges of the merchandisers are flush and level.

Also check each joint area to be sure that the panels of adjoining merchandisers are flush to each other.

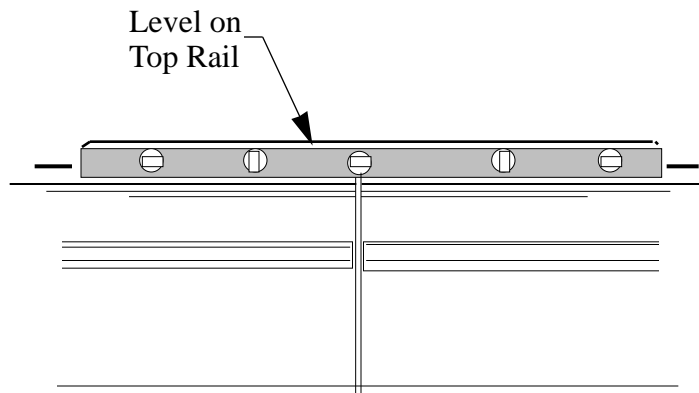

Figure 2. Leveling and Shimming Merchandiser

FIXED GLASS MODELS ONLY

STEP 3. Special sealing instructions for NEGDF and NEGSF Only.

A. Position

Wiper Gaskets - **2**
one on each merchandiser.

Be sure the gaskets are positioned exactly as shown. The gaskets should extend from the bottom of the top curve down to the top of the merchandiser's interior.

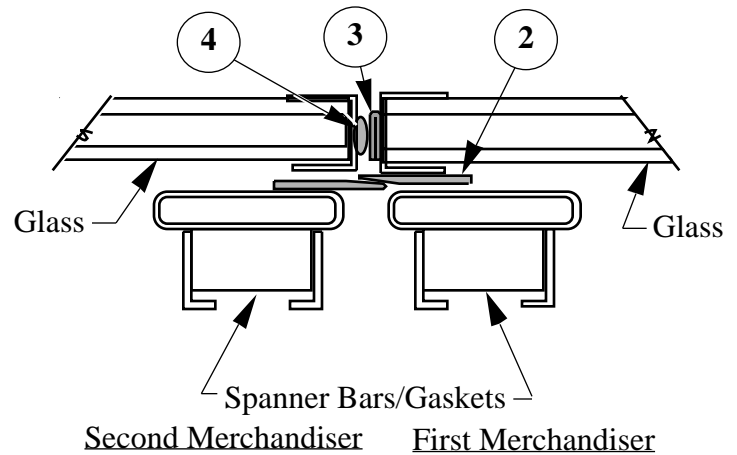

B. Apply

Insulation Tape - **3**
to one merchandiser. Tape should be folded once and positioned to extend from the bottom of the top curve down two inches below end of glass.

C. Apply $\frac{1}{2}$ inch bead of

Silicone - **4**
 on top of Insulation Tape and in shaded area shown.

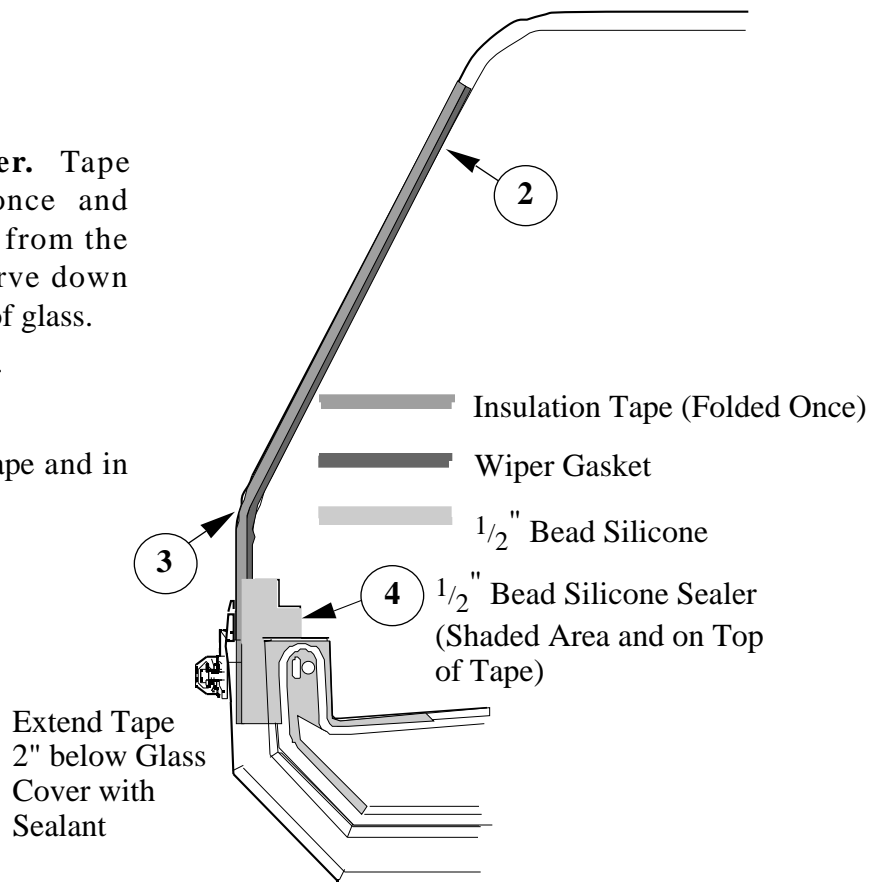

Figure 3. Special Sealing Instructions for Fixed Glass Models Only

Important

Hussmann's Vision Merchandisers feature trimless joints.

Proper use of Joining Brackets and strict adherence to these Instructions are required to achieve a quality installation.

STEP 4.

A. Assemble

Joining Bracket Bolt - 5

Flat Washers - 6

Lock Washer - 7

Hex Nut - 8

in joining brackets at the lower front and upper rear of the merchandisers.

B. While applying force to the base end of the free merchandiser tighten the front **Joining Bracket Bolt #1** until the front gap is closed.

It is critical that the merchandisers are drawn together with Bolt #1 while applying force at the free end until the gap between the panels is closed. Failure to follow this procedure may result in gaps or permanent damage to the merchandiser.

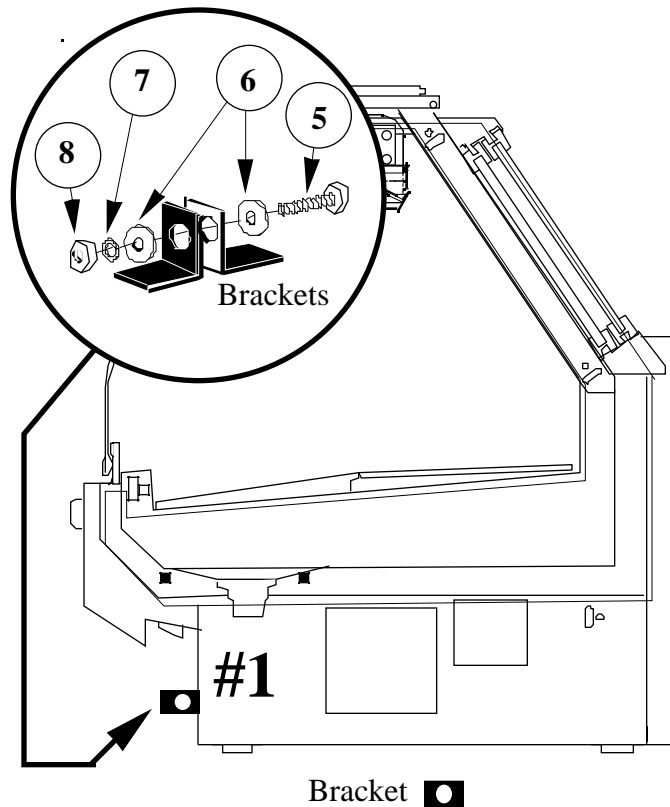

Figure 4. Torquing Joining Bracket Bolts

STEP 5. Remove access covers and front shelf supports for joining holes.

Install

interior frame Bolts - **9**

Lock Washers - **10**

Flat Washers - **11**

Hex Nuts - **12**.

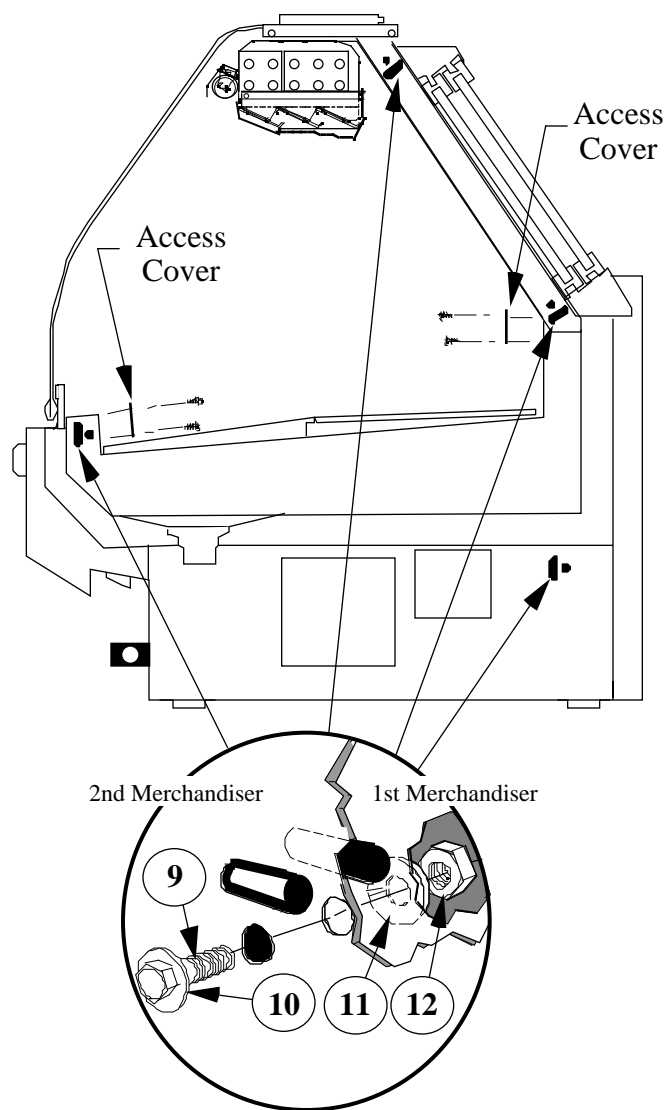

Figure 5. Installing Interior Frame Bolts

NOTE: Remove Joining Brackets before attempting to install splashguards.

6 JOINT ASSEMBLY

STEP 6. After setting line up, install bumpers.

- A. *STARTING FROM LEFT END OF LINEUP*, insert 2 foot starter bumper into front bumper end cap.
- B. Install full length bumper to overlap merchandiser joint. Slide toward left, closing all gaps. Repeat for rest of lineup.
- C. Before installing the last bumper, measure the distance between end cap and the already installed bumper. Add $\frac{5}{8}$ inch and mark.
- D. Use a miter box and fine-toothed saw to cut last full-length bumper.
- E. Install cut end of bumper under bumper end cap, then snap remaining end in place.

NOTE: SEE LAST PAGE FOR FRONT PANEL ADJUSTMENT.

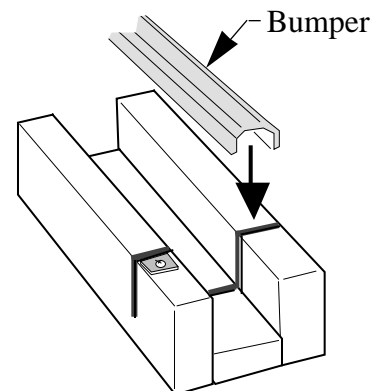
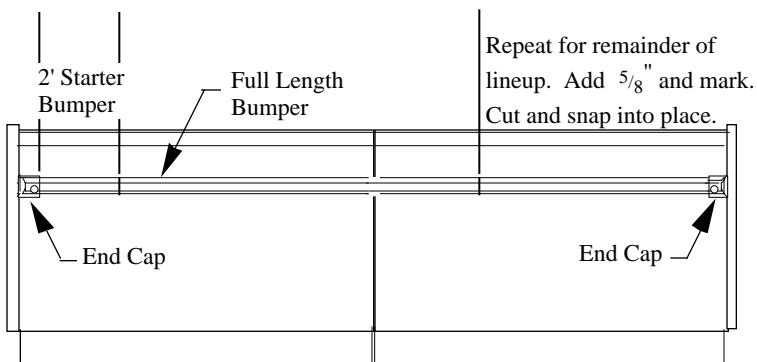
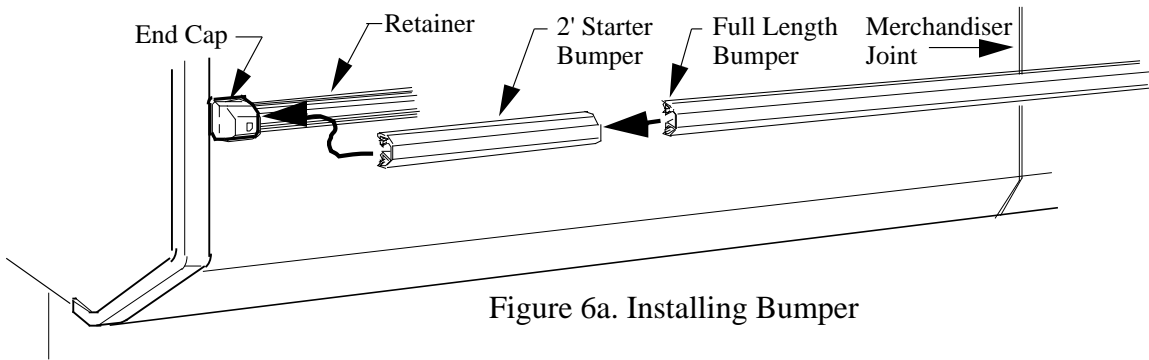

**STEP 7. Apply
Butyl Tape - 13.**

After all the merchandisers have been joined, press Butyl Tape over the end frame joint:

- A. Remove tape's paper backing as it is applied.
- B. Press tape (Mylar side up) firmly onto the end frames, especially in the center where the merchandisers join.
- C. Run the tape continuously the full width of the end frames.
- D. Apply a smooth, continuous bead of
Silicone - 14
to seal the joint interior seam of rear mullion and back.

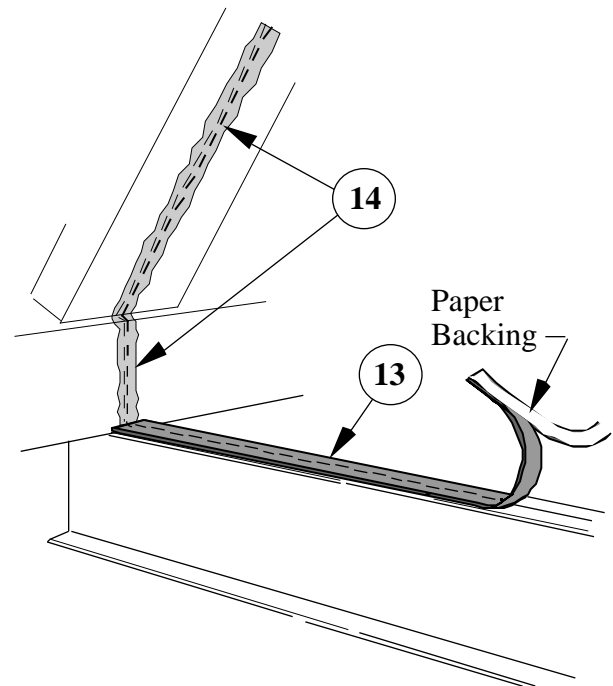

Figure 7. Sealing End Frame Joint

8 JOINT ASSEMBLY

HINGED GLASS MODELS ONLY

(Does NOT apply to NEGDH or NEBSHM models)

STEP 8. Lift the front glass of the merchandisers.

Insert

Mounting Nut Plate - **15**
beneath grill of merchandisers
at the joint.

Fasten the bottom of
Spanner Bar Joint - **16**
to Nut Plate using
Screw - **17**.

On Double Curved Glass
Models Only.

Install

Center the Top Joint Trim
(Spanner Bar Bracket) - **18**
Screws - **19**

Drill shallow holes using trim as
a template, then fasten the trim
centered over the joint.

Fasten top of Spanner Bar to
bracket located on trim using
Screws - **20**.

On Single Curved Glass Models
Only.

Fasten top of spanner bar to
under side of merchandisers'
front glass hinges using
Bolts - **21**.

On Both Models

Press fit

Spanner Bar Gasket - **22**
over the top of the Spanner Bar.

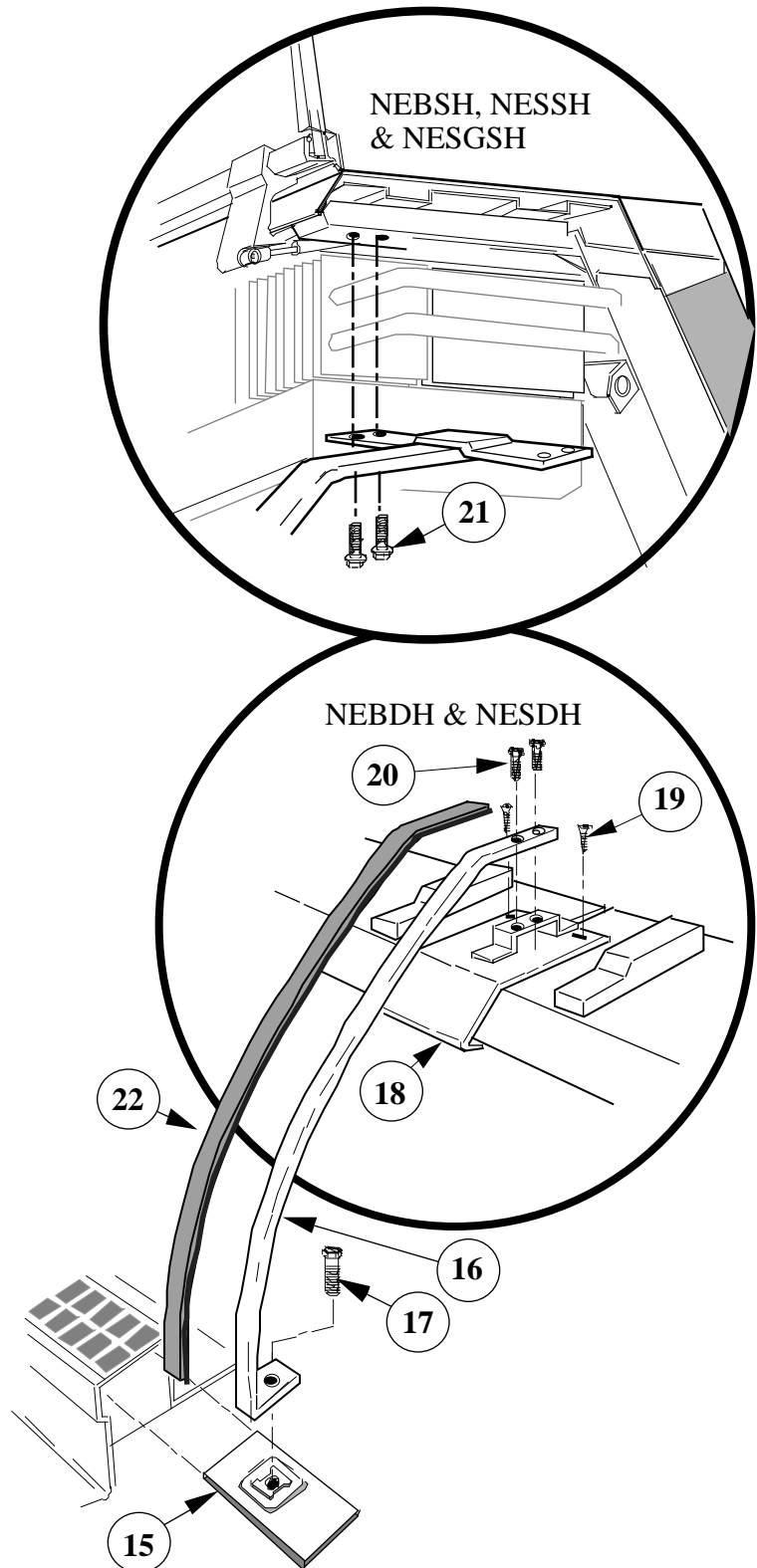

Figure 8. Installing Spanner Bar
(All hinged glass models except NEGDH)

STEP 9. Slip

Door Track Joint Trim - **23**
in place under the lip of the rear
door frame track and **before** the
Rear Panel Joint Trim is
installed.

**See parts list and illustrations
for trim application.**

Drill shallow holes using trim as
a template, then fasten the trim
centered over the joint.

Install

- A. Rear Panel Joint Trim - **24**
Screws - **25**
- B. Front Exterior Joint Trim - **26**
Screws - **25**
- C. Return Grill Joint Trim - **27**
Screws - **25**
- D. Light Reflector Trim - **28**
Pop Rivets - **29**
- E. Top Rear Joint Trim - **30**
Screws - **25**
(On NEGDH models, trim fits
under gasketing.)
- F. Top Joint Trim - **31**
Screws - **25**
- G. Interior Joint Cover - **32**
Screws - **25**.
- H. Glass Joint Trim - **33**
Screws - **25**.
- I. Trim Joint - **34**
Screws - **25**.

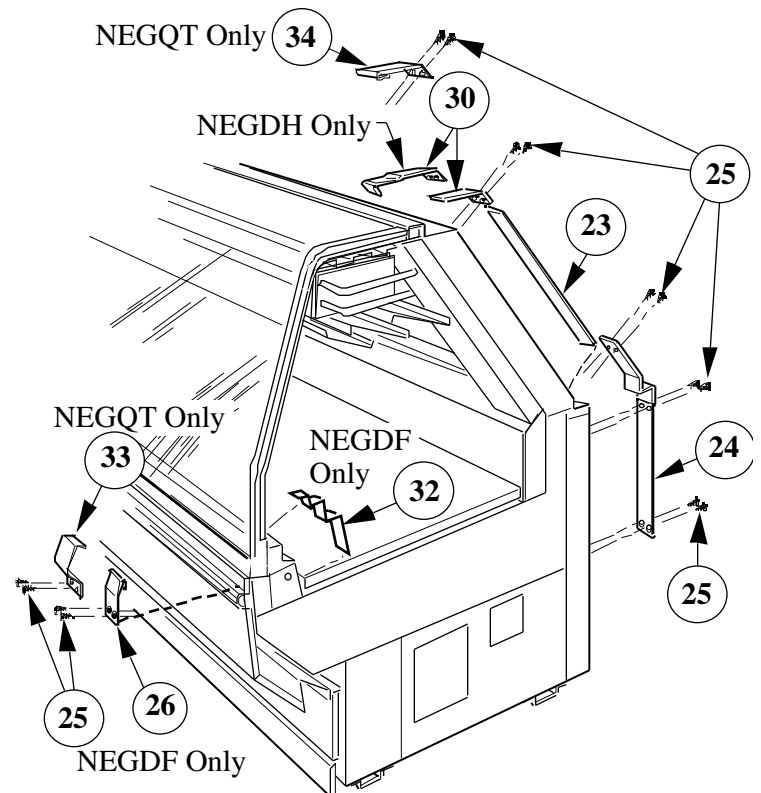
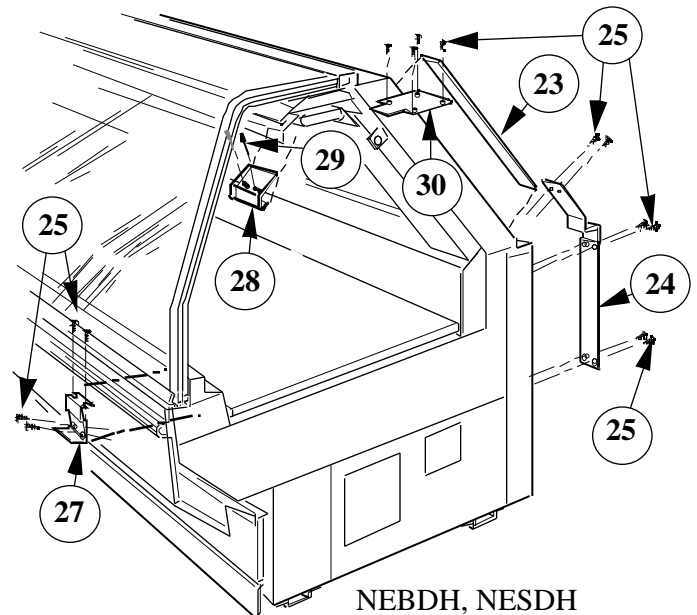

NEGDF, NEGDT, NEGDH, NEGQT
Figure 9a. Installing Trim Double
Curved Glass Merchandisers

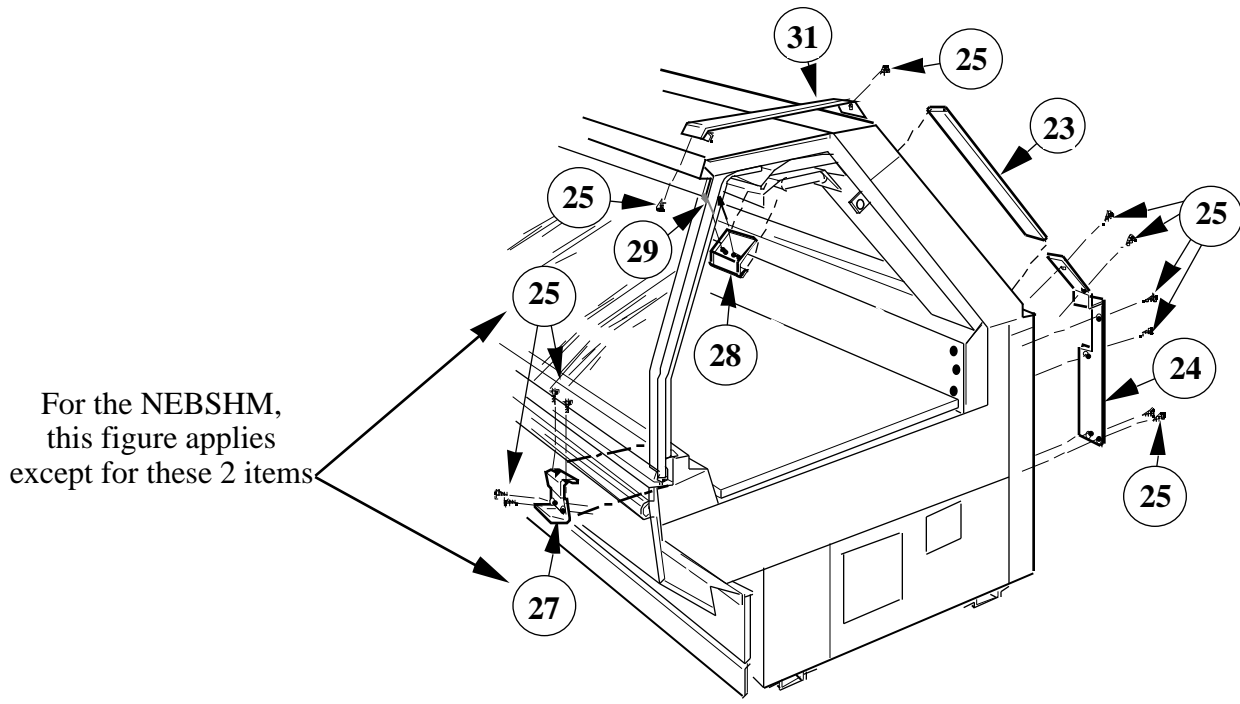

NEBSH, NEBSHM, NESSH, NESGSH

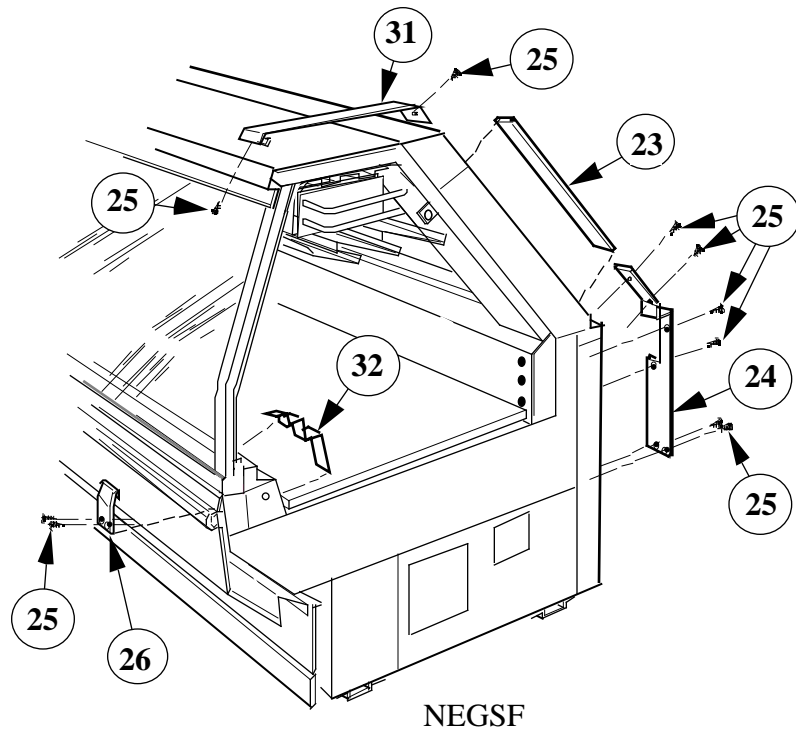

NEGSF

Figure 9b. Installing Trim Single Curved
Glass Merchandisers

FRONT PANEL ADJUSTMENT

If front panels are not flush after setting lineup, follow these steps:

STEP 1. Remove and set aside:
 front bumper
 bumper retainer
 upper front panel.

STEP 2. Locate and loosen adjusting bolts.

STEP 3. Adjust front panel in or out as needed. Maximum adjustment is $\frac{1}{8}$ inch.

STEP 4. Tighten bolts when front panel is in position.

STEP 5. Replace
 upper front panel
 bumper retainer
 front bumper.

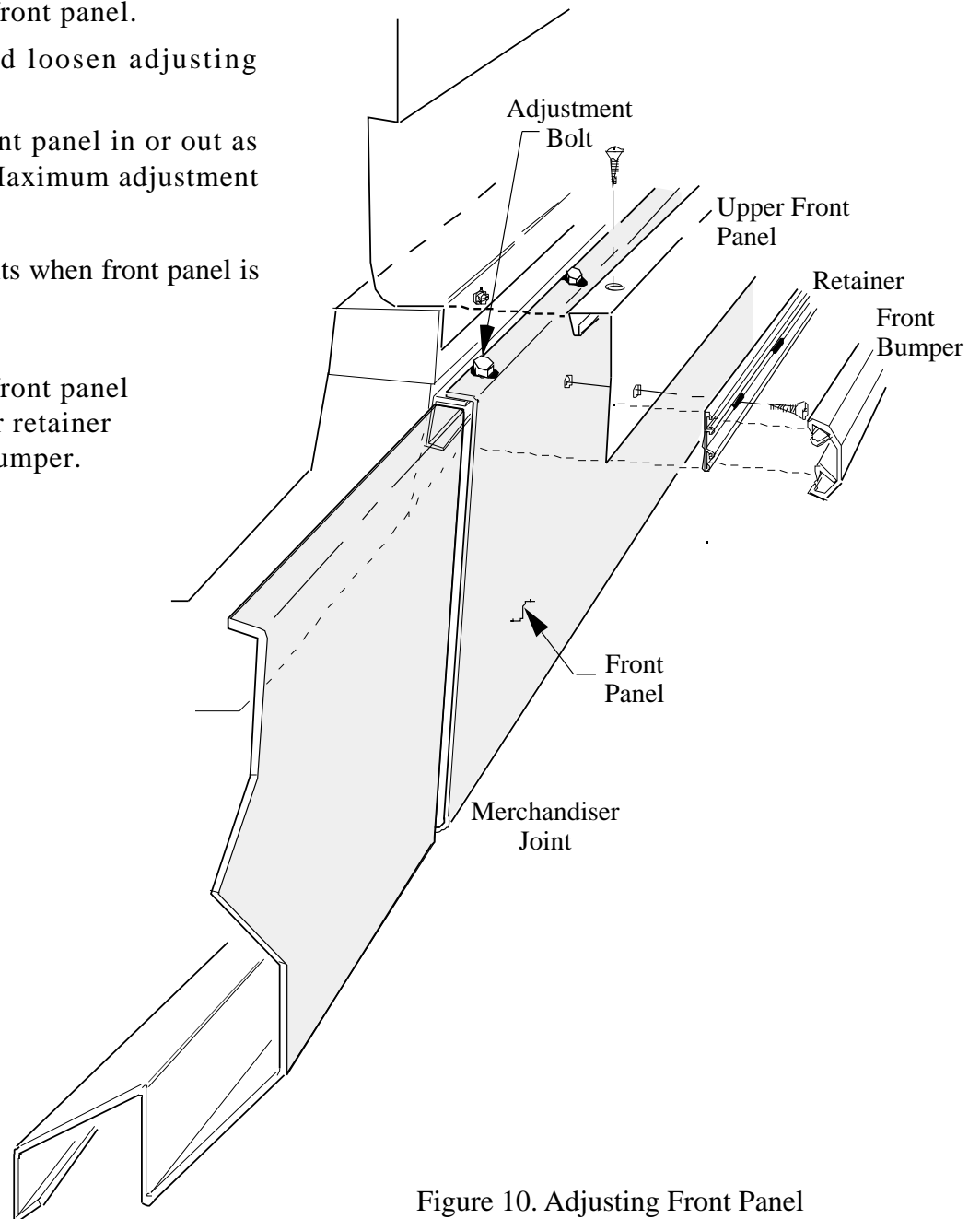

Figure 10. Adjusting Front Panel