

HUSSMANN® IMPACT™

Multideck Merchandiser Joint Kit Instruction

PARTS LIST

Item	18 in. Front	22 in. Front	26 in. Front	Description
1.	1	1	1	Gasket 1/2 x 1/2 x 60
2.	1	1	1	Gasket 1/2 x 1 5/8 x 120
3.	4	5	5	Cap Screw 5/16-18 x 1 1/4
4.	4	5	5	Flat Washer 5/16
5.	4	5	5	Lock Washer 5/16
6.	1	2	2	Hex Nut 5/16-18
7.	1	1	1	Threaded Rod 1/2-16 x 12
8.	2	2	2	Flat Washer 1/2
9.	2	2	2	Hex Nut 1/2-16
10.	1	1	1	Butyl Tape
11.	1	1	1	Splashguard Joint Support
12.	4	4	4	Hex Head Sheetmetal Screw #8 x 1/2

Note: Nut retainers are factory installed in the left end, and alignment pins are factory installed in the right end of each merchandiser.

NOTE: Be sure Merchandisers have been leveled according to the installation instructions. Be sure factory-installed nut retainers and alignment pins are in place.

1 Remove shelves (if installed), display racks, pans, front shelf supports and front air grilles from the right end.

Remove the rear panels from the right end:

A. Remove the lower back panel first by lifting up from its bottom edge and out. Do not use sharp tools.

B. Lift the upper back panel up and out.

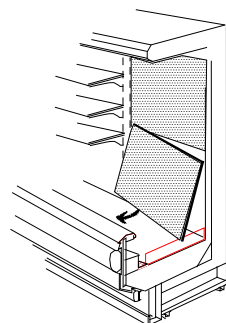

Removing Back Panels

2 Apply **Gasket – 1** in the horizontal recess across the bottom and up front to **cover slots**, including glass front. Apply **Gasket – 2** to **cover foam-to-metal gap** at rear and across top as shown. Lap gaskets at lower corners. Check that there are no gaps between gasket and merchandiser.

- Do not stretch gasket, especially around corners.
- Do not butt gaskets; always overlap joints.
- Remove paper backing after gasket is applied.

3 Move second Merchandiser against first, mating alignment pins with corresponding holes.

4 Fasten fronts together using **Cap Screw – 3**, **Flat Washers – 4**, **Lock Washers – 5**, and **Nut – 6**. Tighten only until front panels touch. Do not tighten fully.

5 Use **Cap Screws – 3** with **Flat Washers – 4** and **Lock Washers – 5** to draw merchandisers together at rear. Start at the bottom, below the coil baffle, then middle, then top; tighten until gaskets are compressed.

6 Draw canopies together using **Rod – 7** through top shoe, and **Washers – 8**, and **Nuts – 9** on each end of rod. Stop when canopies touch.

7 Apply **Butyl Tape – 10** across bottom joint, extending up at back and front. Use field-supplied silicone in any gap between front support brackets.

Splashguard brackets MUST BE INSTALLED BEFORE PIPING CASE.

S	1/2 in. Gasket
T	
E	
P	1 5/8 in. Gasket
2	
S	Butyl Tape
T	
E	
P	Silicone (field supplied)
7	

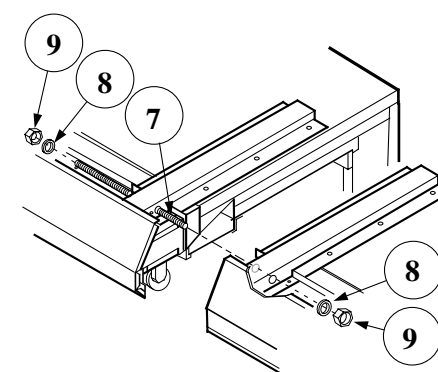
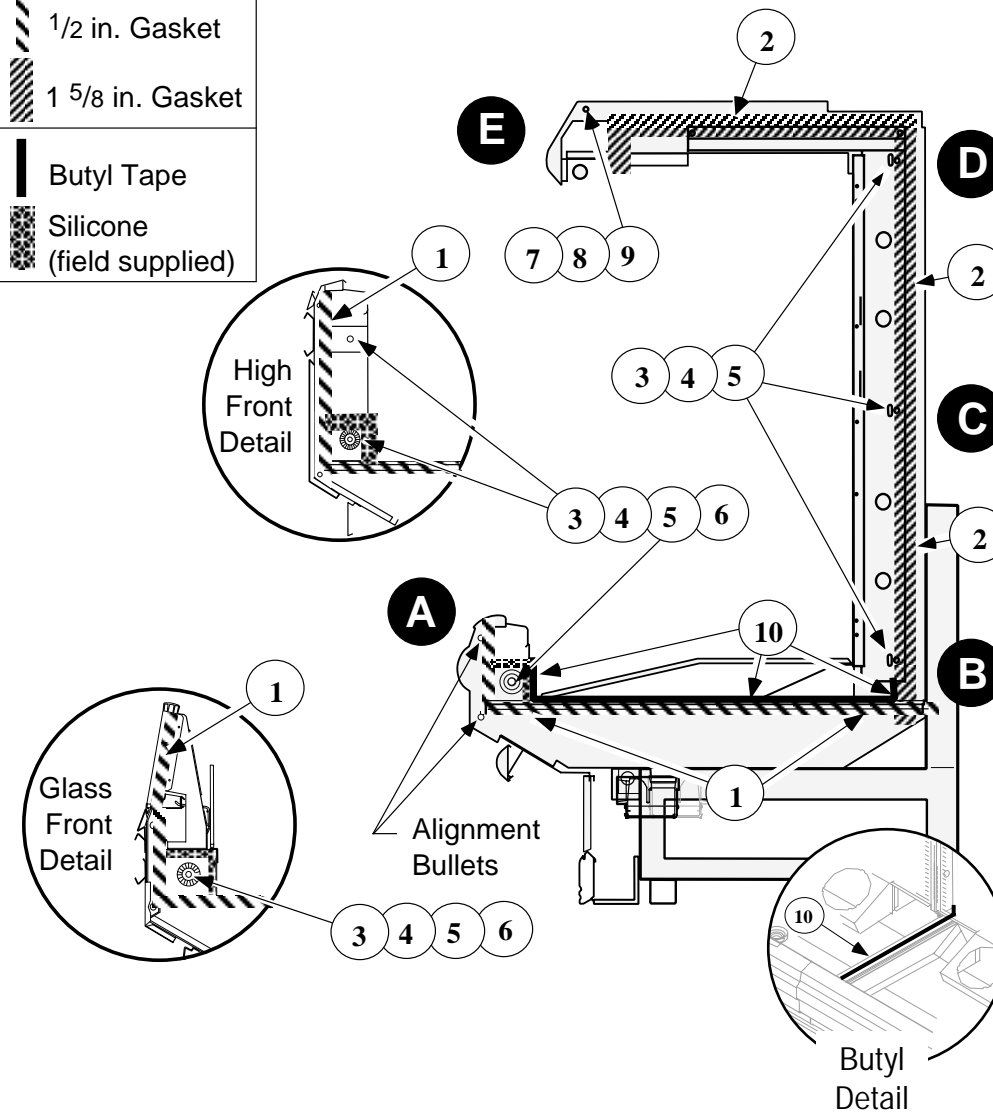

Connecting Canopies

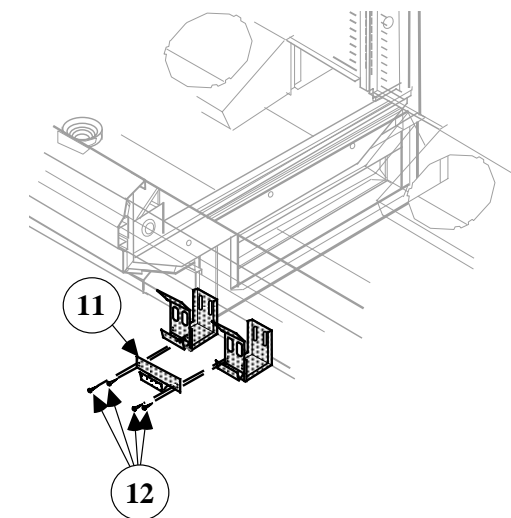

Installing Splashguard Joint Support

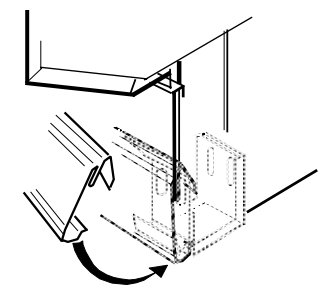

Installing Splashguard

8 Refer to I/O manual to install splashguard brackets.

Install **Splashguard Joint Support – 11** using **Screws – 12**. Install splashguards and lower front panels according to I/O manual.

9 Refer to Poster 389043 or I/O manual or to remove and install top rail and bumpers.

Install upper bumper starter and bumper trim butted up to **left end**. Push into place. Slide internal bumper trim under right end of upper bumper starter. Install full length bumpers and trim flush with starter and offset across joints, making sure no gaps exist between sections. Push into place.

Install lower bumper starter butted up to **left end**. Push into place. Add full length bumpers flush with starter and offset across joints, making sure no gaps exist between sections. Push into place.

Install top rail starter butted up to **left end**; push front down over color panel until snap, then push rear over light channel until snap. Add full length top rail flush with starter and offset across joint.

REFRIGERATE CASE LINEUP AND LAST SECTIONS FOR AT LEAST 6 HOURS.

Before installing last sections, tap the right end of top rail and bumpers to close any gaps. Measure between **right end** and installed rail or bumper. Use a miter box and fine-toothed saw to cut last bumpers to length.

Before installing last section of upper bumper, install internal trim flush to right end, then install cut bumper.