

HUSSMANN® IMPACT

For Medium Temperature Merchandisers

D5ELE/D5EE END CASES TO D5 PARENT CASE JOINING INSTRUCTION

PARTS LIST

Item	Quantity		Description
	19" Front	23" Front	
1.	1	1	Gasket $\frac{1}{2}$ x $\frac{1}{2}$ x 60
2.	1	1	Gasket $\frac{1}{2}$ x $1\frac{5}{8}$ x 120
3.	4	4	Joining Brackets
4.	12	12	Hex Washer Head SM Screw $\frac{3}{4}$ 10 -16
5.	2	4	Cap Screw $\frac{5}{16}$ -18 x 4
6.	2	4	Flat Washer $\frac{5}{16}$
7.	8	8	Cap Screw $\frac{1}{4}$ - 20 x 1
8.	8	8	Flat Washer $\frac{1}{4}$
9.	2	2	Cap Screw $\frac{5}{16}$ - 18 x $2\frac{1}{2}$
10.	4	4	Flat Washer $\frac{5}{16}$
11.	2	2	Lock Washer $\frac{5}{16}$
12.	2	2	Hex Nut $\frac{5}{16}$ - 18
13.	2	2	Threaded Rod $\frac{1}{2}$ -13 x 15
14.	4	4	Flat Washer $\frac{1}{2}$
15.	4	4	Hex Nut $\frac{1}{2}$ -13
16.	1	1	Butyl Tape
17.	2	2	Splashguard Joint Support
18.	8	8	Hex Head Sheet metal Screw #8 x $\frac{1}{2}$



Note: Nut retainers are factory installed in the left end, and alignment pins are factory installed in the right end of each merchandiser.

Be sure Merchandisers have been leveled according to the installation instructions. Carefully unpack and inspect the Joint Kit making sure there is no breakage or damage.

1 REMOVING SHIPPING BRACES .

Remove **Bolts, Washers** and **Nuts** from **Shipping Braces**. Then remove the shipping brace **Brackets**. See **Figure 1** and **Detail A**.

After removing the braces and brackets, make sure to **replace the screws that hold the top panels in place**.

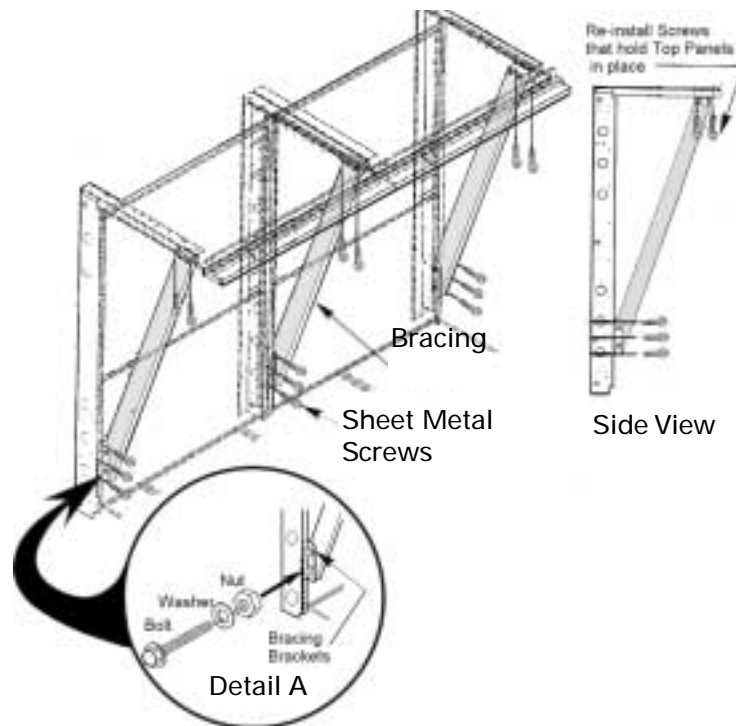

Fig. 1. Removing Shipping Braces

2 REMOVING CASE COMPONENTS.

Remove shelves (if they are installed), display racks, pans, front shelf supports and front air grilles from the right end.

Remove the rear panels at the RIGHT end:

Remove the lower back panel first by lifting up from its bottom edge and out. Do not use sharp tools.

Remove the rear panels at the RIGHT end:
Lift the upper back panel up and out.
See **Figure 2.**

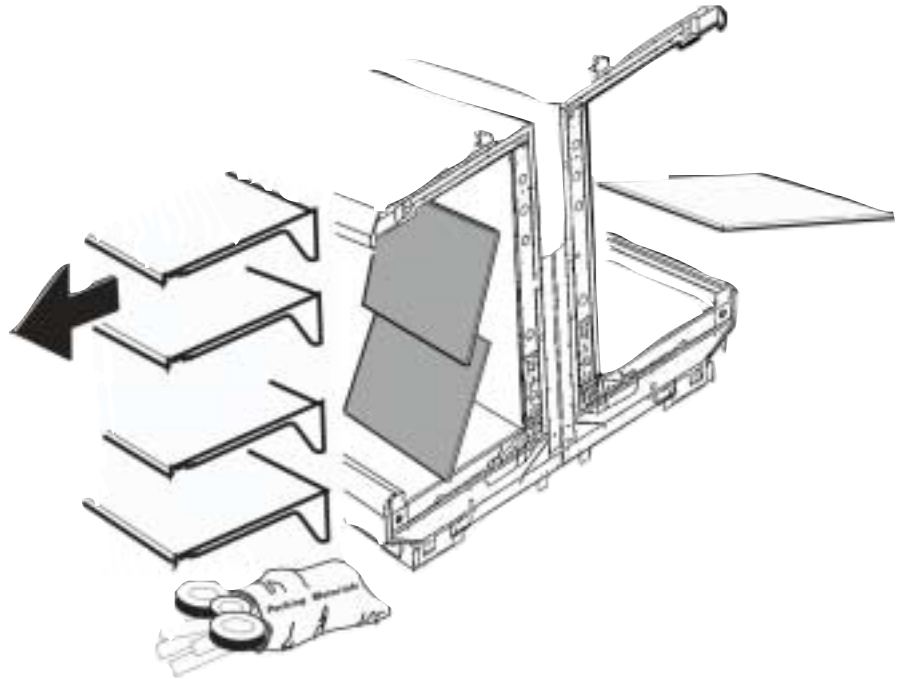

Fig. 2. Removing Components from Case

3 Check that the Nut Retainers are in place in the bottom of the merchandiser at locations shown in Figure 3.

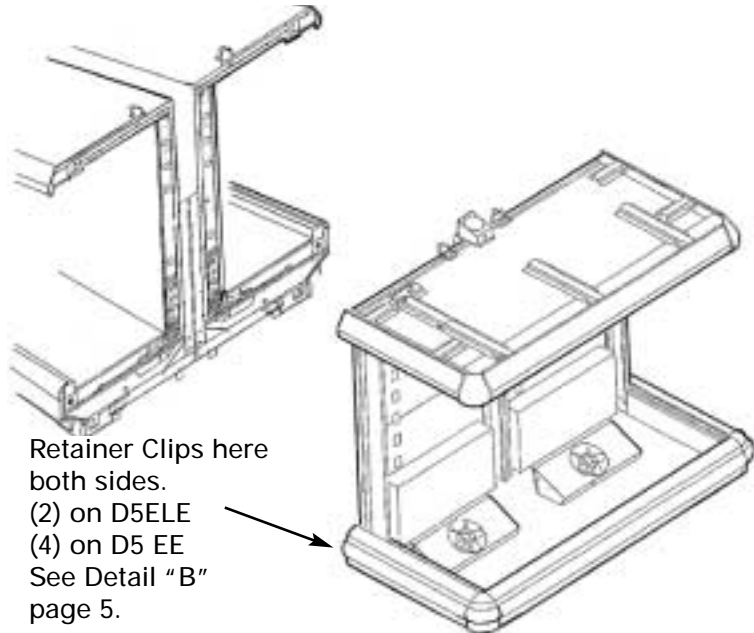

Fig. 3. Locating Nut Retainers

- 4** Apply **Gasket - 1** in the horizontal recess across the bottom and up front to cover slots. Apply **Gasket - 2** to cover foam-to-metal gap at rear and across top as shown. Lap gaskets at lower corners. Check that there are no gaps between gasket and merchandiser.

Do not stretch gasket, especially around corners.

Do not butt gaskets; always overlap joints.

Remove paper backing after gasket is applied.

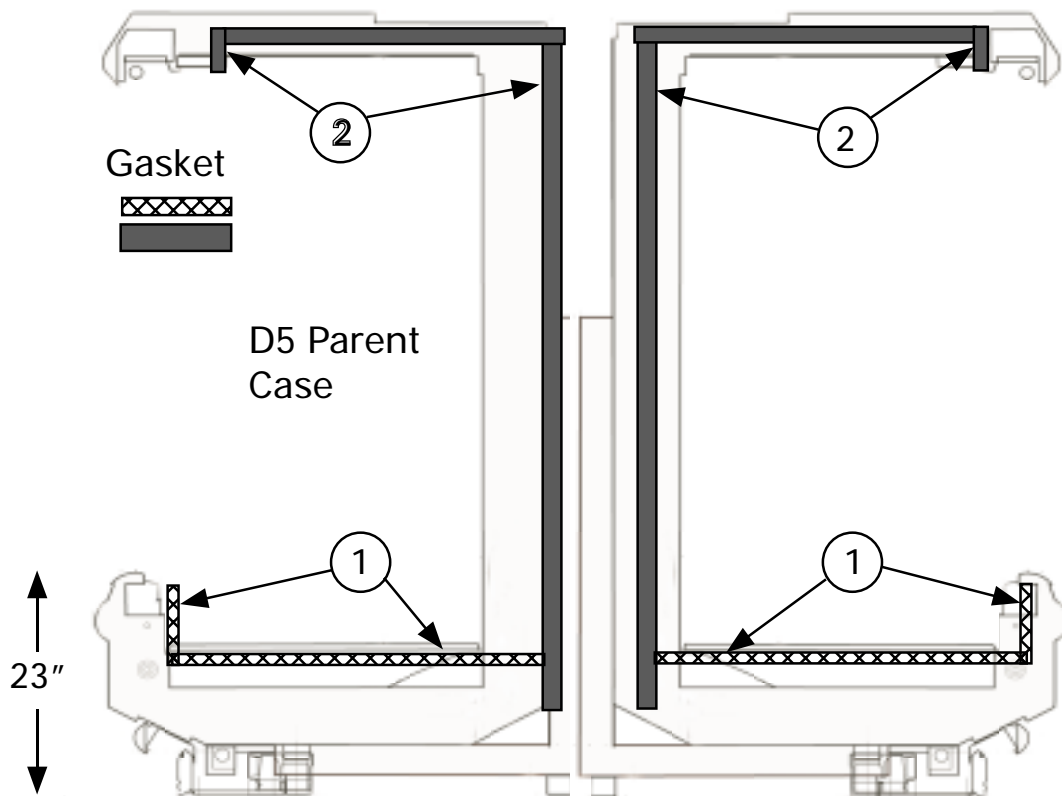
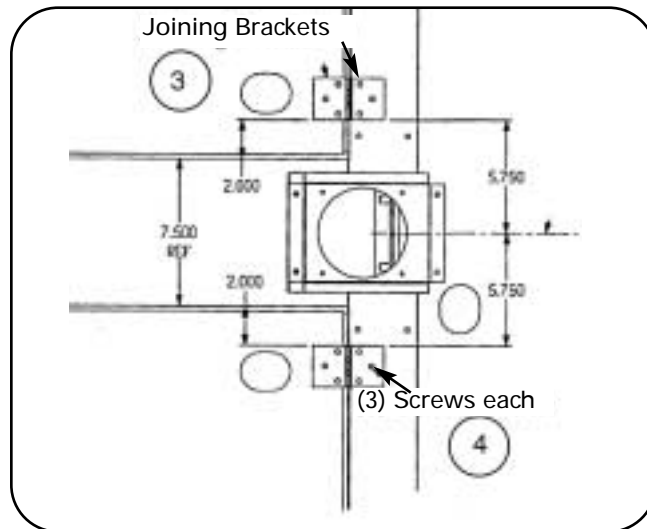

Fig. 4. Installing Gasket

5 Move second merchandiser against first, mating alignment pins with corresponding holes

NOTE: WHEN BOLTING THE CASES TOGETHER, BE SURE TO FOLLOW THE SEQUENCE SHOWN BELOW IN FIGURE 5 AND ON PAGE 5.

6 Install (4) Joining Brackets - 3, using Screws - 4 as shown in Figure 5 below.



Top View

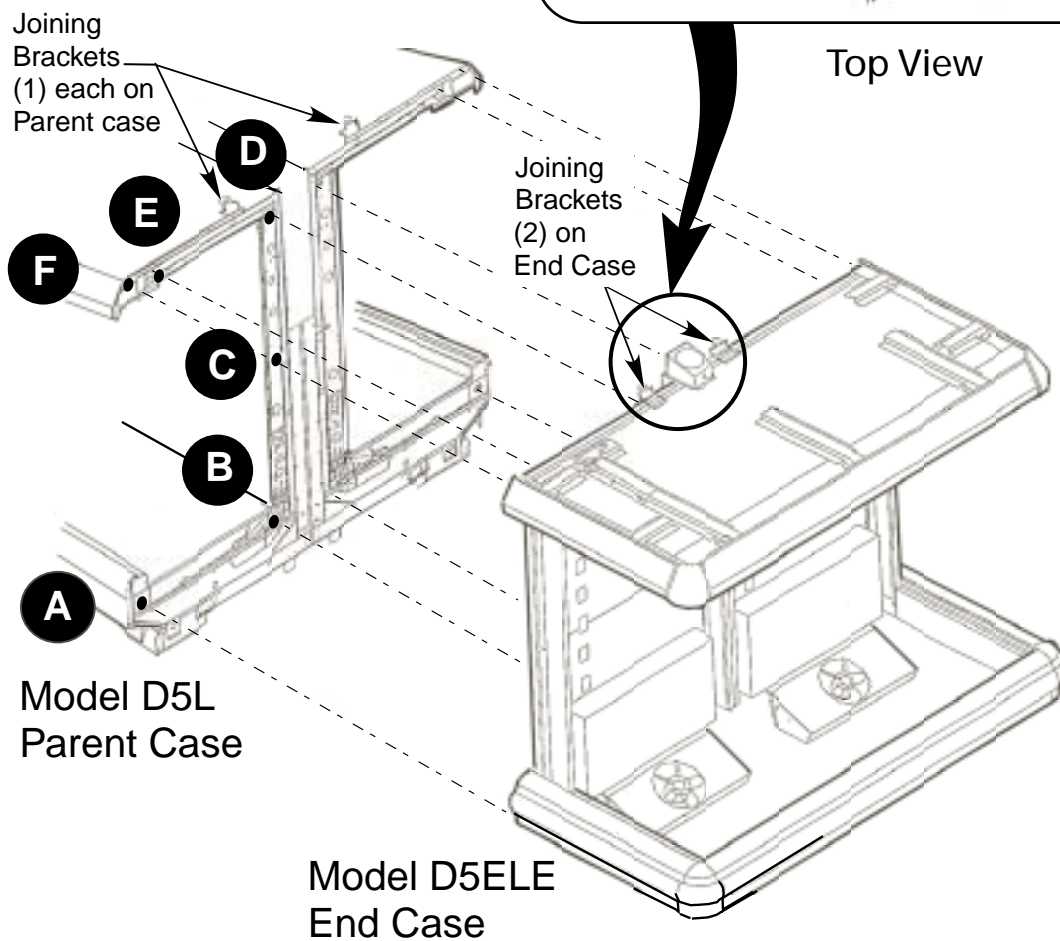

Fig. 5. Sequence of bolting cases together

6 Fasten fronts together using **Cap Screw – 5** and **Flat Washers – 6**. Tighten only until front panels touch. Do not tighten fully. See **Detail B**.

7 Use **Cap Screws – 7** with **Flat Washers – 8** to draw merchandisers together at rear. Start at the bottom, below the coil baffle, then middle, then top; tighten until gaskets are compressed. See **Detail C**.

8 Use **Cap Screws – 9** with **Flat Washers – 10**, **Lock Washers – 11** and **Hex Nut – 12** to join and bolt merchand-

isers together at rear top. See **Detail D**.

9 Draw canopies together using **Rod – 13** through top shoe, and **Washers – 14**, and **Nuts – 15** on each end of rod. Stop when canopies touch. See **Detail E**.

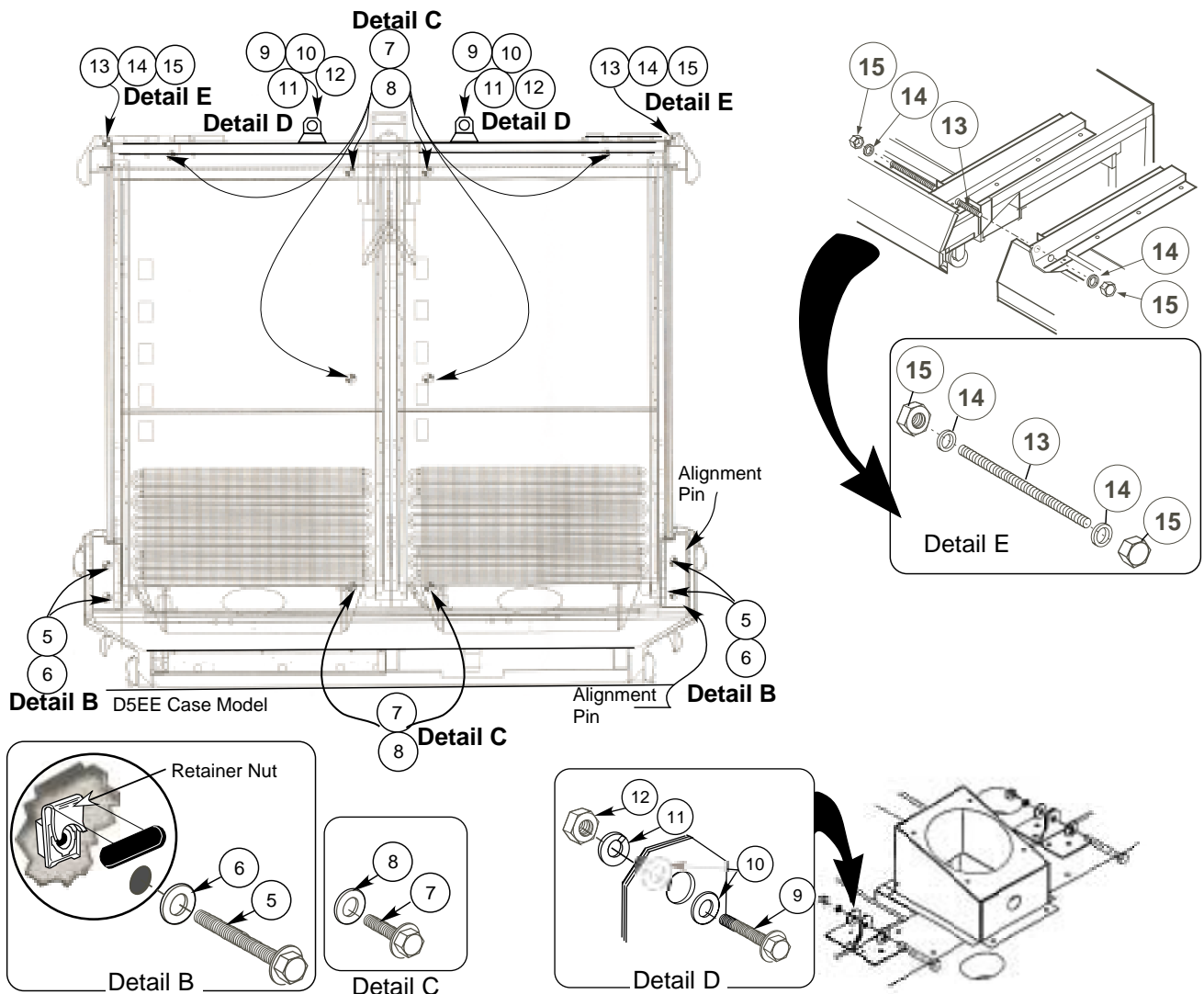

Fig. 6. Bolting Cases Together

10 Apply **Butyl Tape – 16** across bottom joint, extending up at back and front. Use field-supplied silicone in any gap between front support brackets. **See Figure 7.**

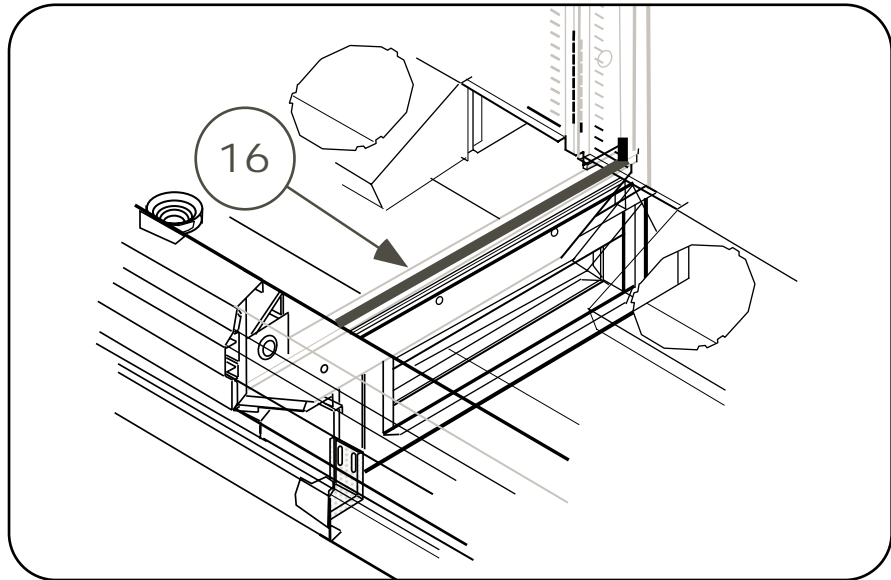

Fig. 7. Applying the Butyl Tape

11 Refer to I/O manual to install splashguard brackets.

Install **Splashguard Joint Support – 17** using **Screws – 18**. **See Figure 8.**

12 Install splashguards and lower front panels according to I/O manual. **See Figure 9.**

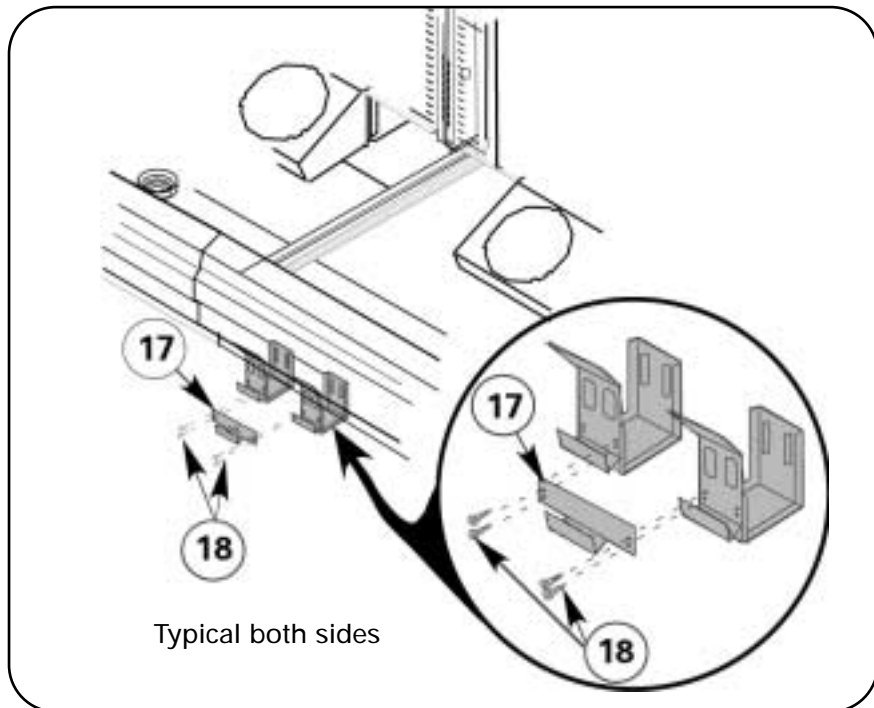

Fig. 8. Installing Splashguard Retainers

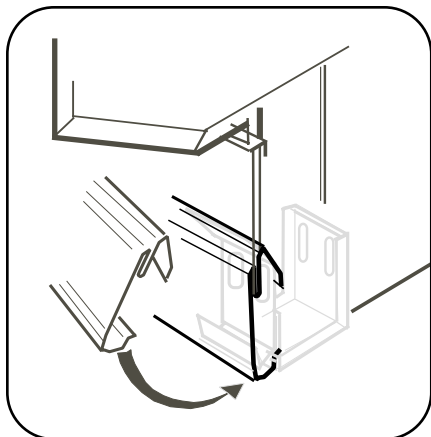

Fig. 9. Installing Splashguards

13 Refer to Poster 389043 or I/O manual or to remove and install top rail and bumpers.

Install upper bumper and bumper trim on end of case both sides. Push into place. Slide internal bumper trim under end of upper bumper. Install full length bumpers and trim flush and offset across joints, making sure no gaps exist between sections. Push into place.

Install lower bumper on end case both sides. Push into place. Add full length bumpers flush with bumper and offset across joints, making sure no gaps exist between sections. Push into place.

Install top rail on end case both sides; push front down over color panel until snap, then push rear over light channel until snap. Add full length top rail flush and offset across joint.

REFRIGERATE CASE LINEUP AND LAST SECTIONS FOR AT LEAST 6 HOURS.

Before installing last sections, tap the right end of top rail and bumpers to close any gaps. Measure between *right* end and installed rail or bumper. Use a miter box and fine-toothed saw to cut last bumpers to length.

Before installing last section of upper bumper, install internal trim flush to right end, then install cut bumper.



Fig. 10. Installing Bumpers and Top Rails

