

# HUSSMANN® IMPACT

Shop Around Medium Temperature Convertible Merchandisers

CW2-GE/CW2-XGE  
CW2U-GE/CW2U-XGE  
CW2EGE/CW2EXGE  
Joint Kit Instruction

## PARTS LIST

Item No.	Quantity	Description
1.	2	Gasket $\frac{1}{2} \times \frac{1}{2} \times 180$ in.
2.	1	Donut Gasket
3.	8	Nut Retainer $\frac{5}{16}$ -18
4.	8	Cap Screw $\frac{5}{16}$ -18 x $\frac{3}{4}$
5.	2	Cap Screw $\frac{5}{16}$ - 18 x $1\frac{1}{4}$
6.	2	Lock Washer Split Steel $\frac{5}{16}$
7.	2	Flat Washer $\frac{5}{16}$
8.	2	Hex Nut $\frac{5}{16}$ - 18
9.	2	Joint Base Plate (end case only)
10.	12	Thread Cutting Flange Screw (end case only)

**Splashguard Brackets  
MUST BE INSTALLED  
BEFORE PIPING CASE.**

**NOTE:** Be sure merchandisers have been leveled according to the installation instructions. Carefully unpack and inspect the CW2 Joint Kit, making sure there is no breakage or damage. Be sure factory installed alignment pins are in place.

**NOTE:** Apply gasketing to one case only.

- Apply **Gaskets – 1 and 2** as shown in Figure 1.
  - Remove paper backing as gasket is applied.
  - Apply two rows of **Gasket 1** to the center flue foam area only.
  - Lap gaskets at lower corners.
  - Check that there are no gaps between gasket and merchandiser.
  - Do not stretch gasket, especially around corners.
  - Do not butt gaskets; always overlap joints.

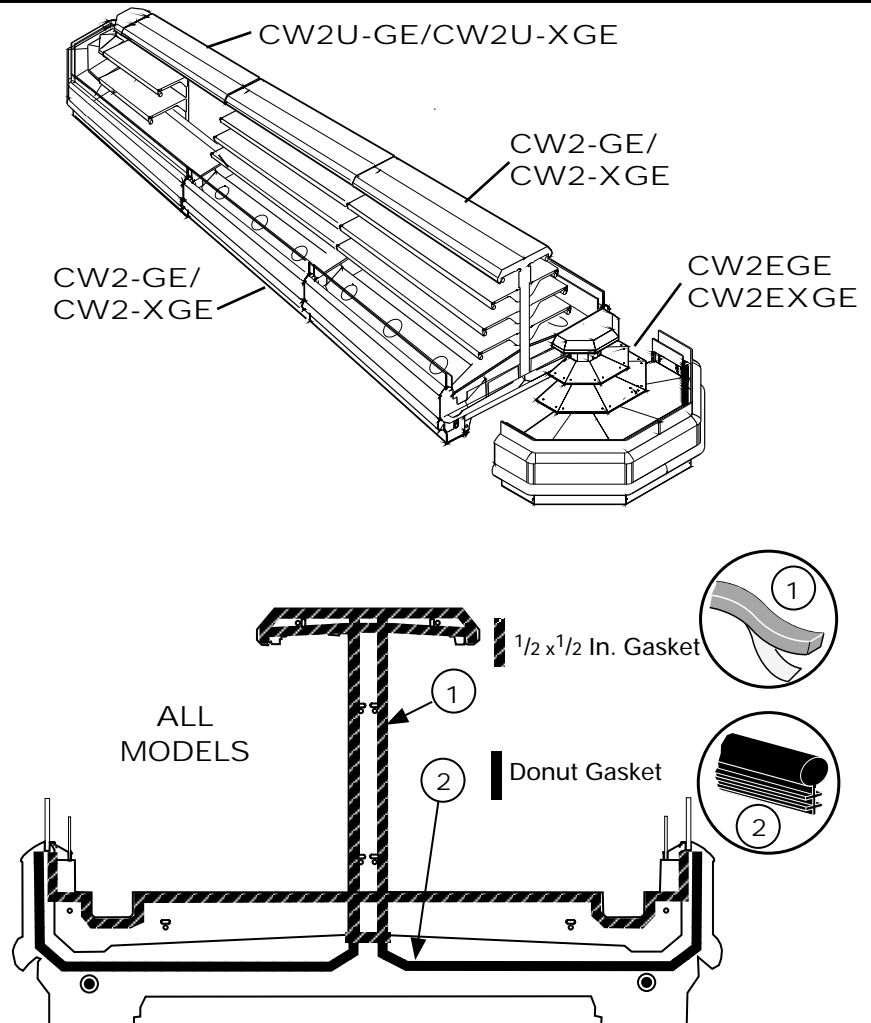

**Figure 1. Installing Gaskets**

- 2** A. Remove shelves (if installed).  
B. Remove honeycomb at end to be joined.  
C. Lower light channels. See Detail A.  
D. Remove display racks and pans.  
E. Remove wire rack support.  
F. Lift out interior back panel.  
G. Remove front grille assembly. See Details B and C.

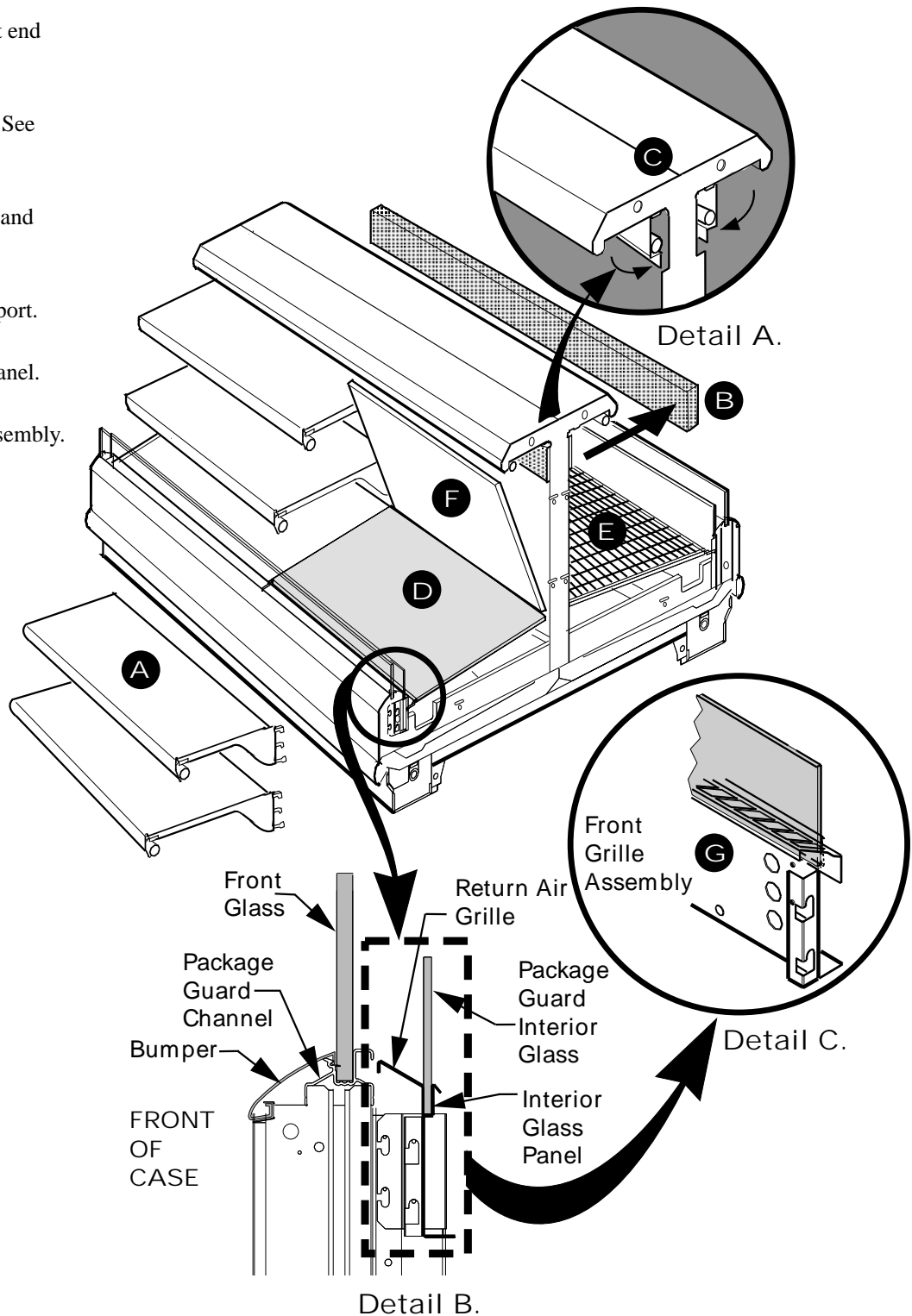

**Figure 2. Removing Parts**

- 3** Move the first two cases to be joined together and into position against each other matching Alignment Pins with the corresponding holes.



**CAUTION**

Cases should be pushed tightly together guided by alignment pins. **DO NOT** pull together by bolts.

- 4** Install **Nut Retainer – 3** and  $\frac{3}{4}$  in. **Cap Screw – 4** at locations shown in Figure 3.  
**Do not tighten fully.**

**BE SURE TO FOLLOW BOLTING SEQUENCE CORRECTLY.**

- 5** Install  $1\frac{1}{4}$  in. **Cap Screw – 5**, **Lock Washer – 6**, **Flat washer – 7** and **Hex Nut – 8**.

Start at the bottom locations. Tighten the joints in the order shown, **W** first, then at the center uprights **X**, then canopies **Y**, and then **Z**.

See drawing and Details D and E for installation sequence and locations.

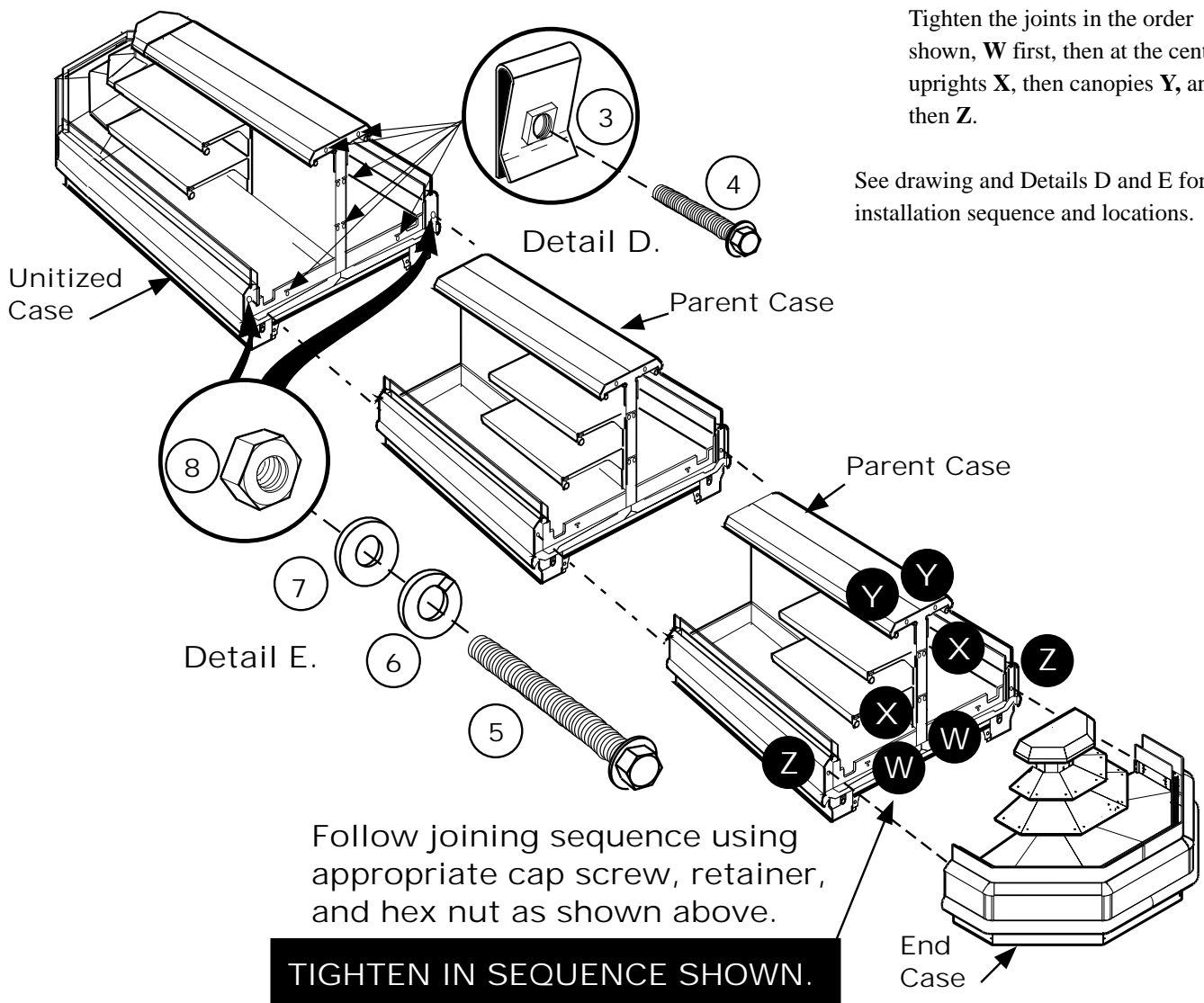

Follow joining sequence using appropriate cap screw, retainer, and hex nut as shown above.

**TIGHTEN IN SEQUENCE SHOWN.**

**Figure 3. Installing Retainer Clips, Fasteners and Joining Bolts**

**FOR END CASE ONLY:**

- 6** Attach **Joint Base Plate – 9** to the legs on *both sides* of the end case joint using **Screws – 10**. See Figure 4 and Detail F.

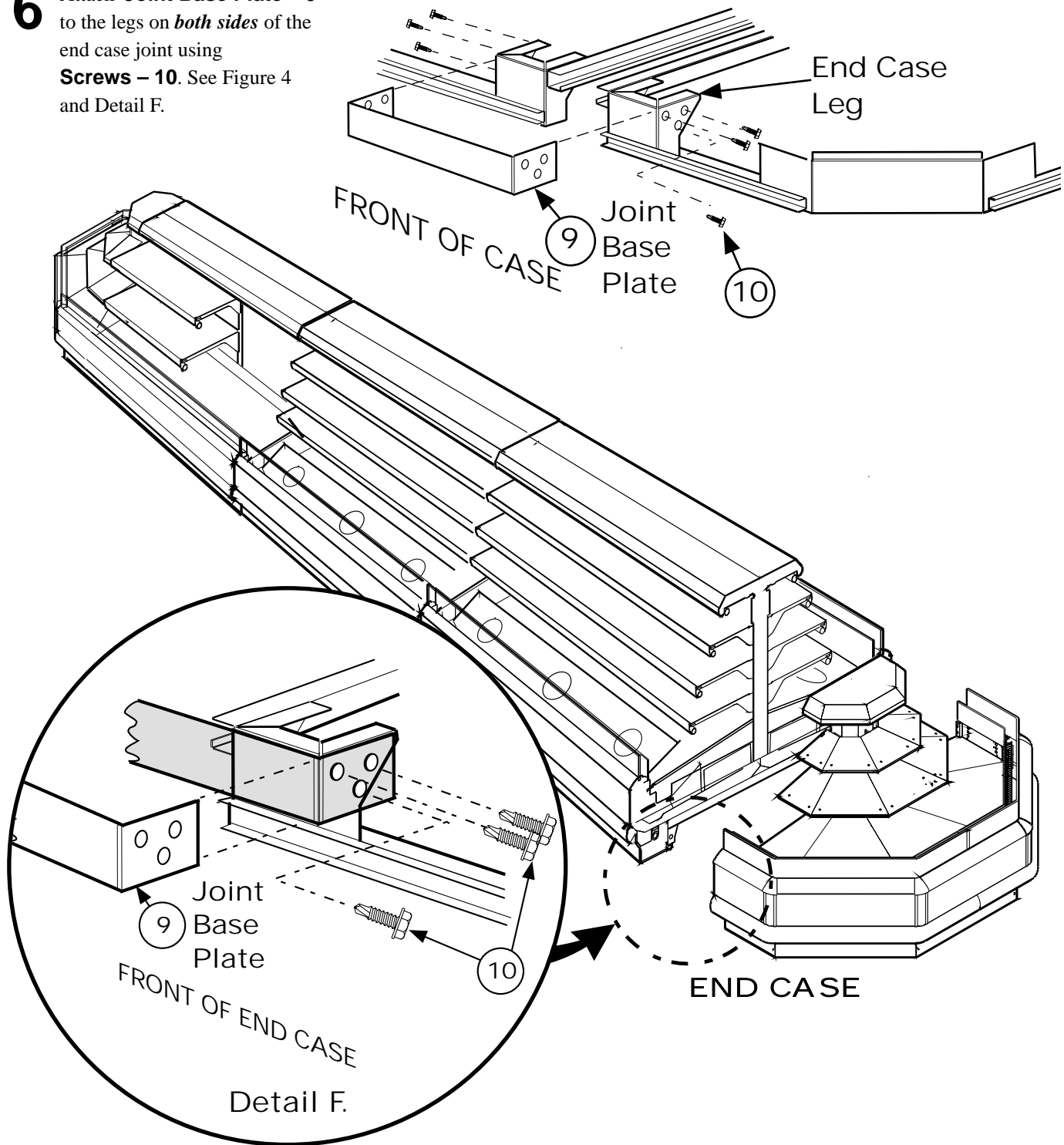

**Figure 4. Attaching Joint Plates to End Case**

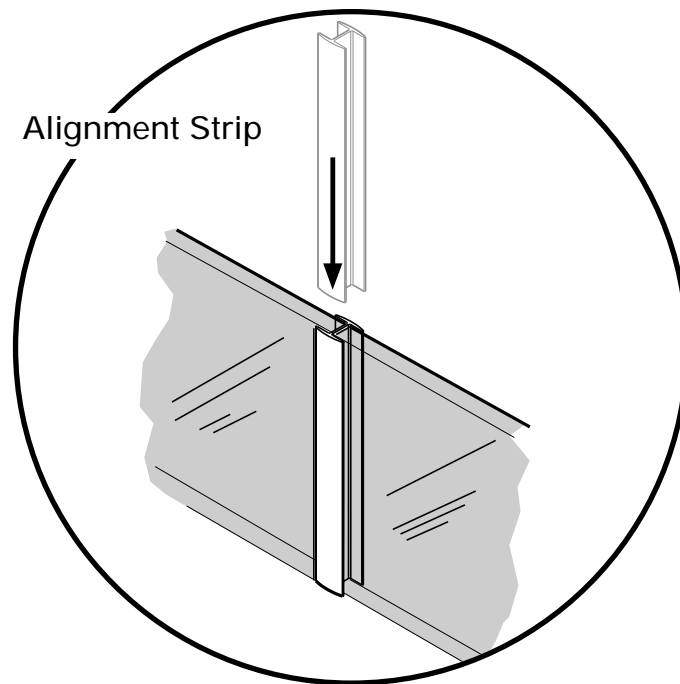

**Figure 5. Inserting the Alignment Strips**

- 7** Slide the alignment strips between front glass sections at each joint. See Figure 5.

- 8** Refer to the installation instructions to install the splashguard brackets.