

HUSSMANN® IMPACT

Fresh Meat, Deli and Fish Merchandiser

Service Merchandisers
Joining Instruction

PARTS LIST

Item No.	Quantity	Description
1.	1	Gasket $\frac{1}{2} \times 1\frac{5}{8} \times 180$
2.	1	Gasket $\frac{1}{2} \times \frac{1}{2} \times 120$
3.	1	Silicone
4.	1	Top Gasket Pad
5.	1	Front Gasket Pad
6.	1	Lighting Rail Joining Bracket
7.	1	Joining Plate
8.	4	Truss Head S METAL Screw 8 -18 x $\frac{3}{8}$
9.	1	Cap Screw $\frac{5}{16}$ -18 x $\frac{3}{4}$
10.	2	Flat Washer $\frac{5}{16}$
11.	1	Lock Washer $\frac{5}{16}$
12.	1	Hex Nut $\frac{5}{16}$ - 18
13.	4	Spacer
14.	2	Cap Screw $\frac{5}{16}$ - 18 x $3\frac{1}{2}$
15.	4	Flat Washer $\frac{5}{16}$
16.	2	Lock Washer $\frac{5}{16}$
17.	2	Hex Nut $\frac{5}{16}$ - 18
18.	1	Cap Screw $\frac{5}{16}$ - 18 x 3
19.	2	Flat Washer $\frac{5}{16}$
20.	1	Lock Washer $\frac{5}{16}$
21.	1	Hex Nut $\frac{5}{16}$ - 18
22.	1	Bottom Joint Cover
23.	1	Splashguard Joint Support
24.	4	Hex Head Sheet metal Screw #8 x $\frac{1}{2}$

Front
Rear
Top



Level cases are critical for joining and glass alignment!

NOTE: Be sure merchandisers have been leveled according to the installation instructions. Carefully unpack and inspect the Joining Kit, making sure there is no breakage or damage.

CAUTION
DO NOT remove riders until case is in its final position.

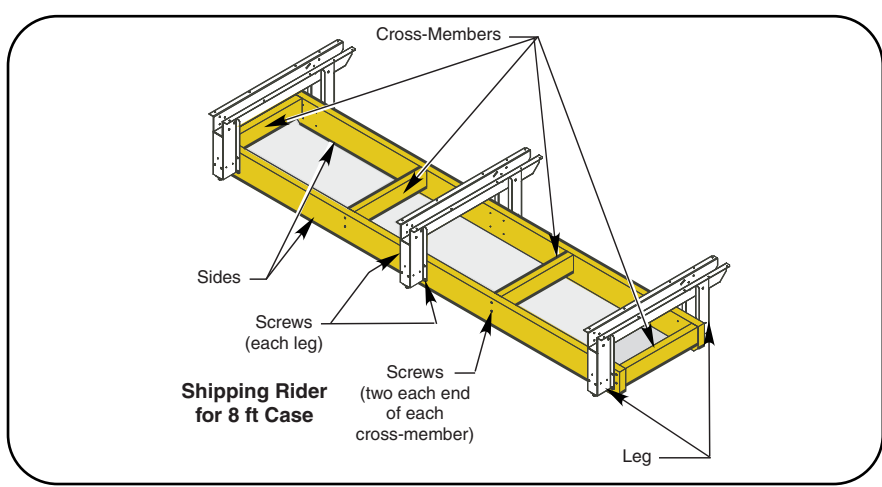

1 Remove items below:

- A. Shelves if installed,
- B. Display Pans,
- C. Rear Pan Bracket,
- D. Rear Panel and Discharge Grille
- E. Front Return Air Grille from case.

See Figure 1.

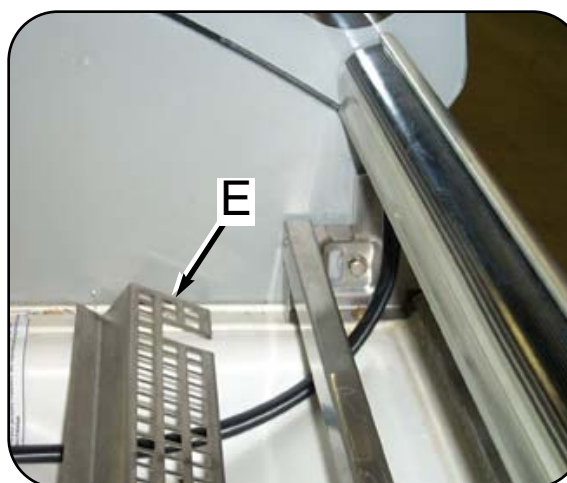
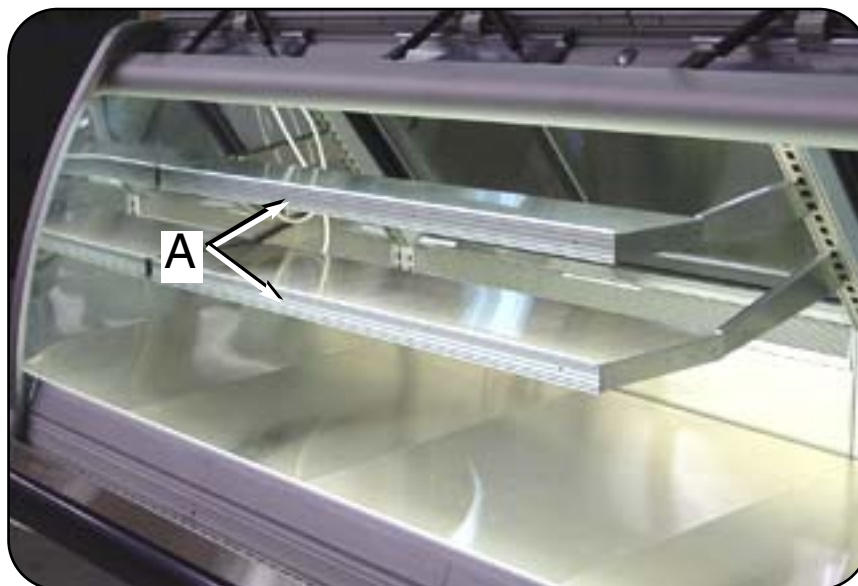

Figure 1. Removing items from case

GASKETING AND SEALING PROCEDURE

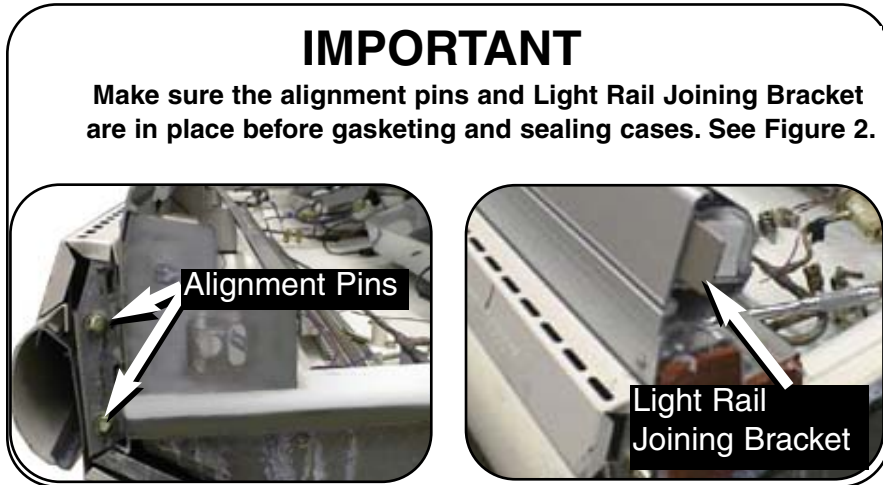

Figure 2. Checking Alignment Pin and Light Rail Joining Bracket

2 Apply 1 5/8 in. (321 mm) Gasket (Item – 1) to rear foam panel of both cases as shown. Check to be sure that there are no gaps between gasket and merchandiser.

Note: THIS IS THE ONLY GASKET THAT IS APPLIED TO BOTH CASES. THE FOLLOWING STEPS MUST BE DONE TO ONE CASE ONLY.

See Figure 3. Detail A and B.

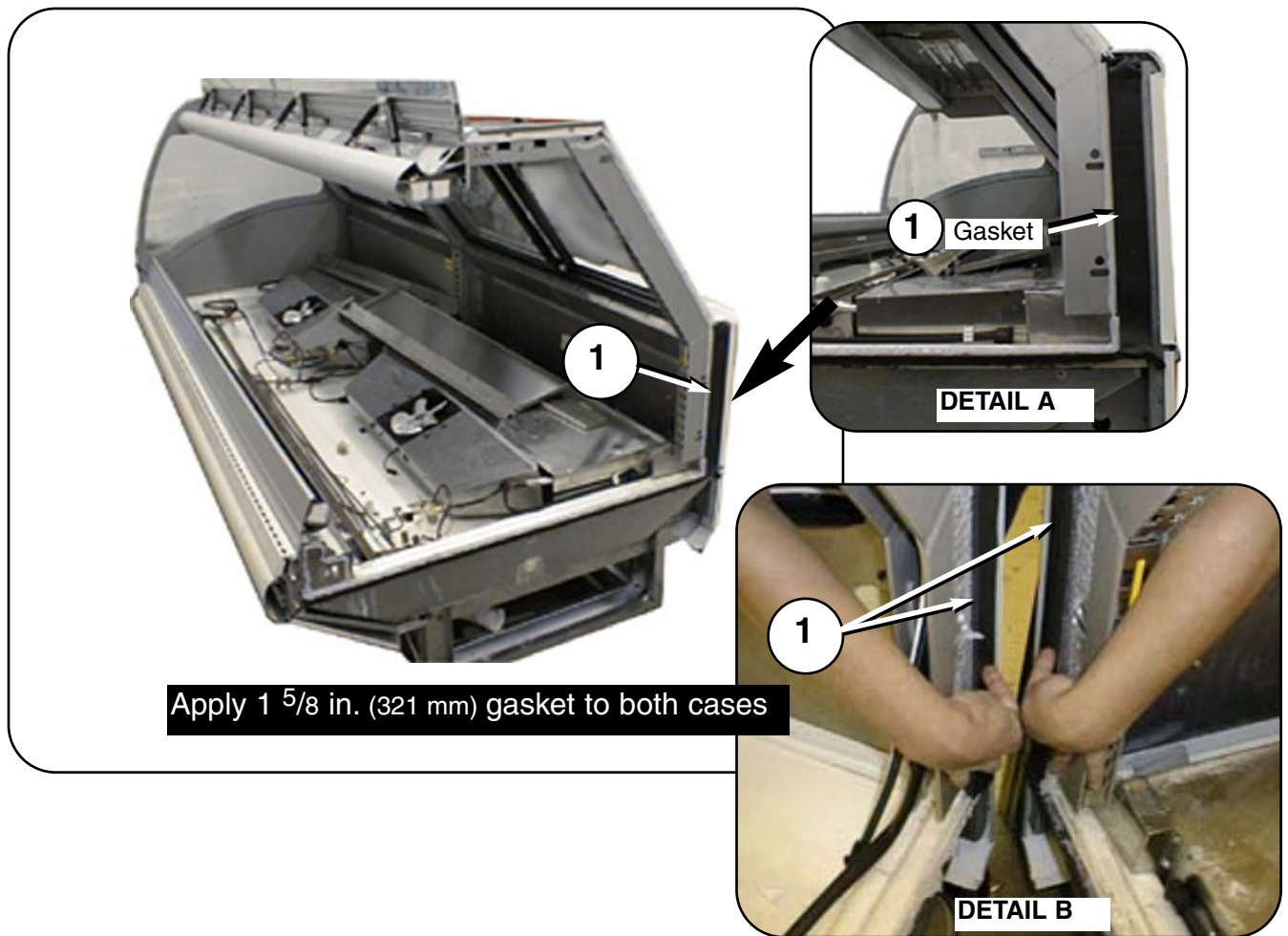
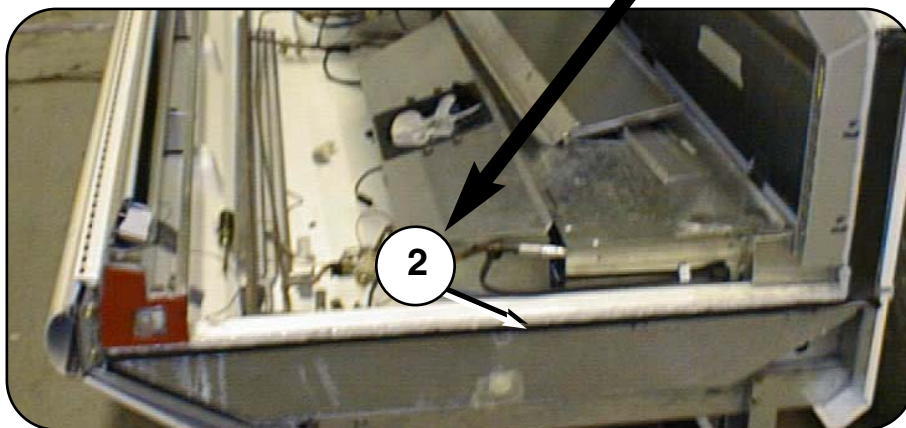
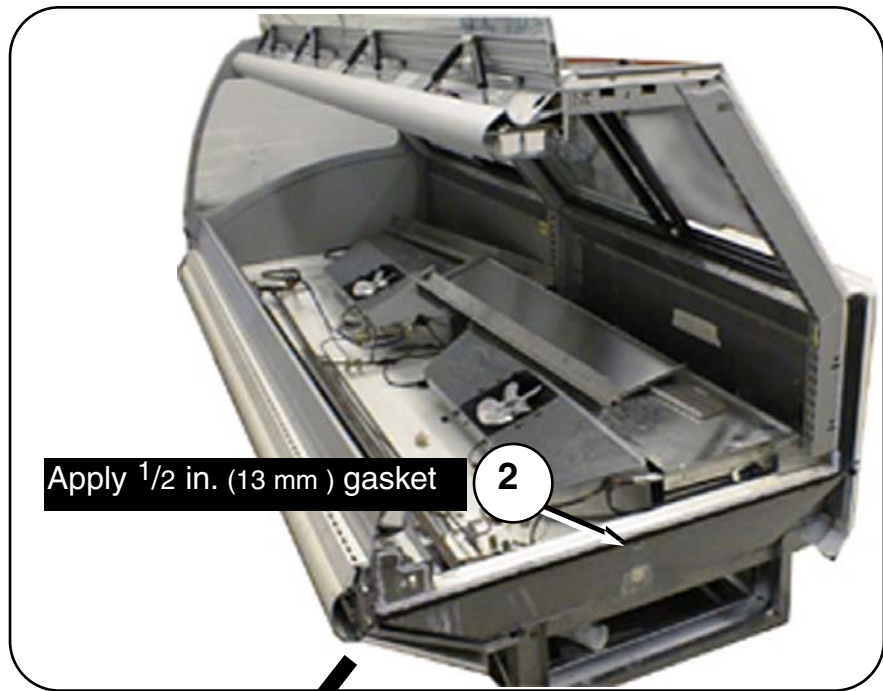

Figure 3. Applying 1 5/8 in. Gasket to the Merchandiser

3 Apply 1/2 in. (13 mm) **Gasket** (Item – 2) to the horizontal recess across the bottom.

- Do not stretch gasket, especially around corners.
- Do not butt gaskets; always overlap them as shown.
- Remove paper backing after gasket has been applied.

See Figure 4, Detail C.



DETAIL C

Figure 4. Applying 1/2 in. Gasket

4 Before joining, make sure to lay a 1/2 inch bead of clear **Silicone (Item – 3)** along the entire perimeter of the case as shown in **Figure 5**.

5 In addition, apply silicone around the perimeter of the front joining hole and over the top of the frame. See **Figure 5, Details D and E**.

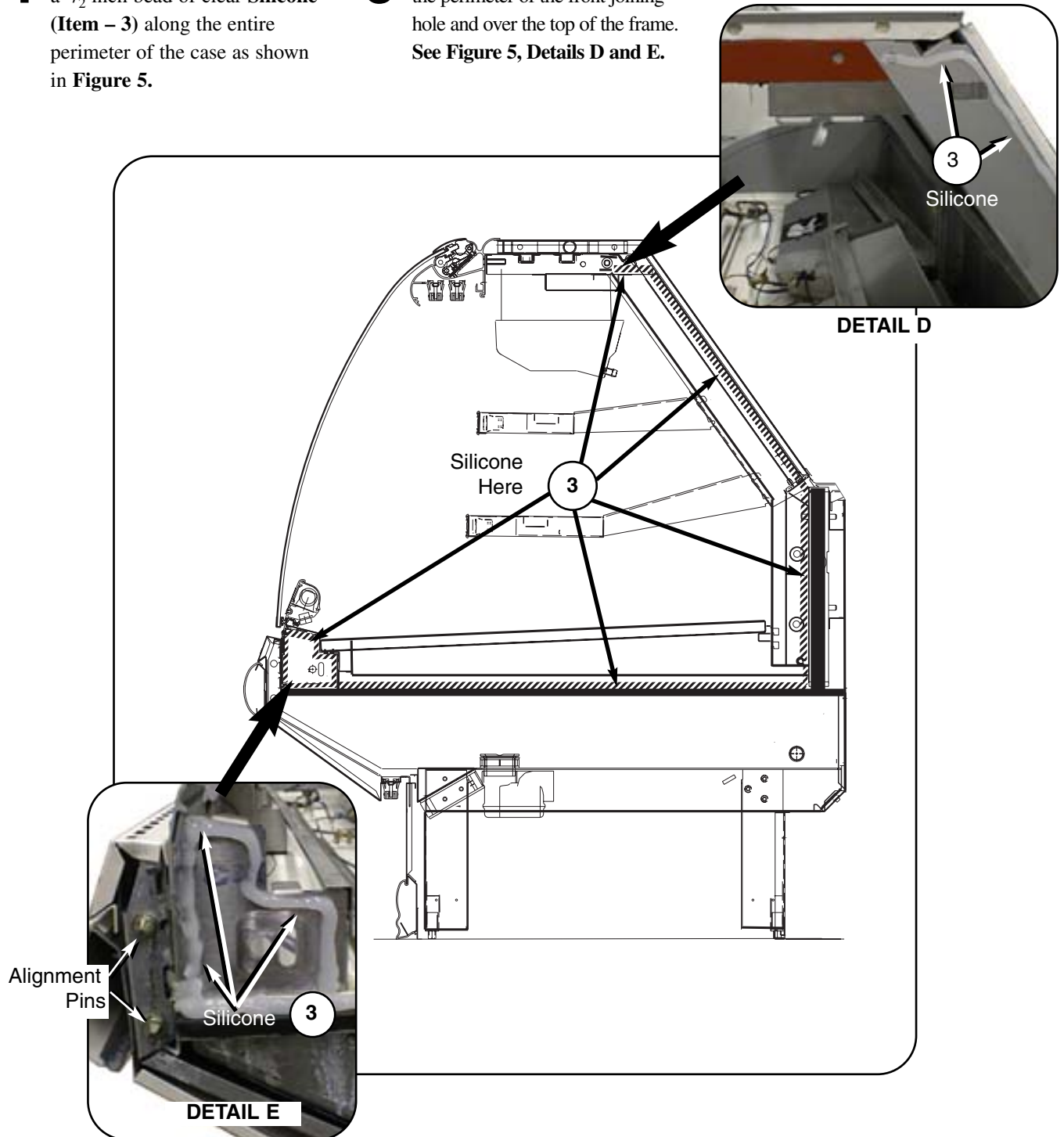

Figure 5. Applying Silicone

6 Install the **Top Gasket Pad**,
(Item – 4).

See Figure 6, Detail F.

7 Install the **Front Gasket Pad**,
(Item – 5).

See Figure 6, Detail G.

8 Apply **Silicone** onto the **Top**
Gasket Pad (Item – 4) and the
Front Gasket Pad (Item – 5).

See Details H - a and H - b.

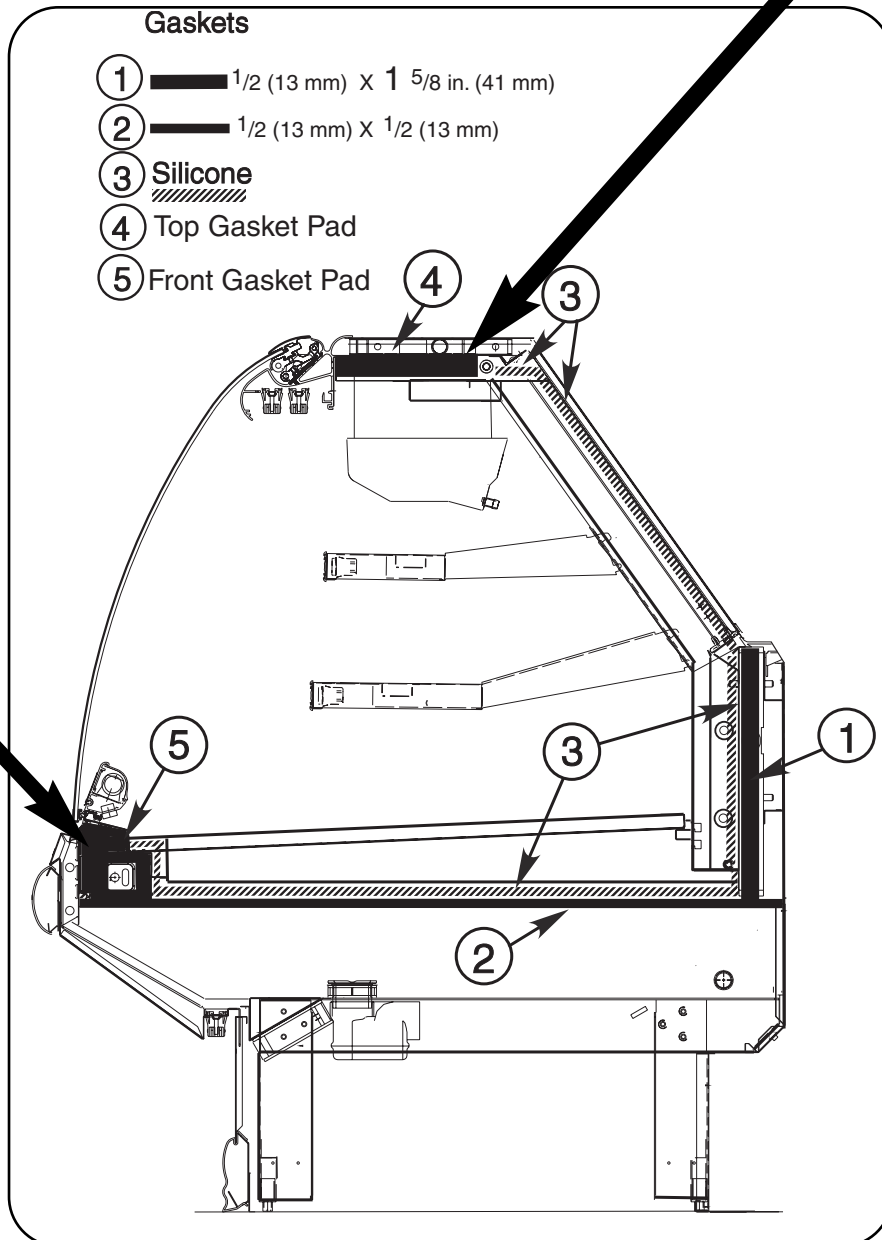
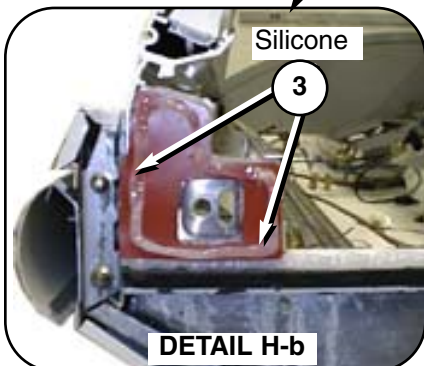
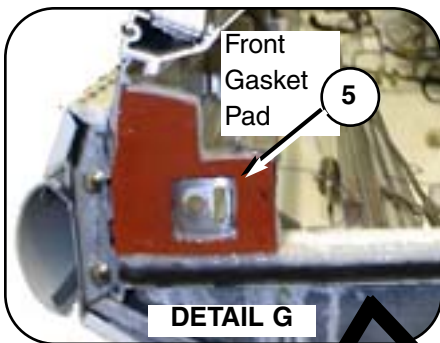
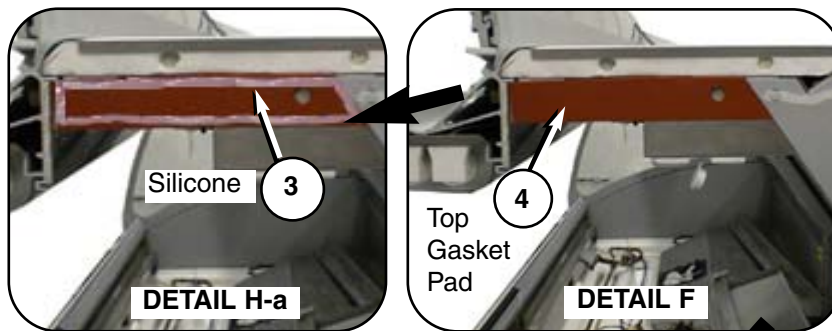

Figure 6. Applying Top and Front Gasket Pads

9 Move the second merchandiser into position against the first. Match the alignment pins with the corresponding holes. See **Figure 7, Detail I.**

10 The complete lineup must be leveled to the highest point of the floor. After the first merchandiser has been set, position the second so the end frames touch.

A. Set a long level (4 foot or more) on the upper front panel of the merchandisers. Adjust case height by rotating the Adjustable Leg Leveler until the merchandisers are flush and level. See **Figure 7.**

B. Check each joint area to be sure that the panels of adjoining merchandisers are flush to each other.

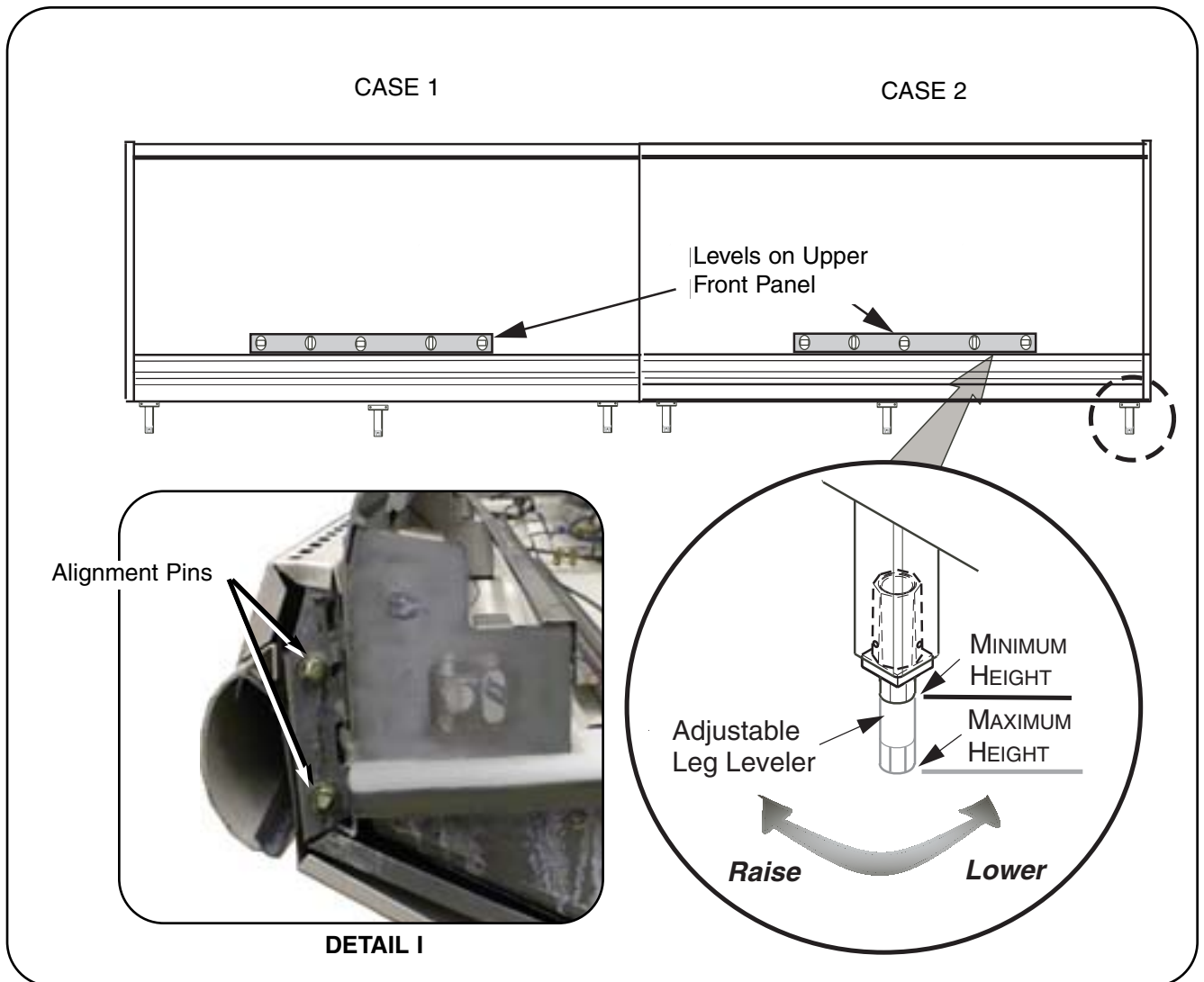

Figure 7. Leveling Merchandisers

11 Slide the **Lighting Rail Joining Bracket (Item – 6)** across both light channel extrusions to align the light rails. See **Figure 8**.

12 Align the top extrusion and insert **Joining Plate (Item – 7)**.

Use **#8 Screws — 8** to fasten the plate using the pre-drilled pilot holes as shown in **Figures 9 and 10**.

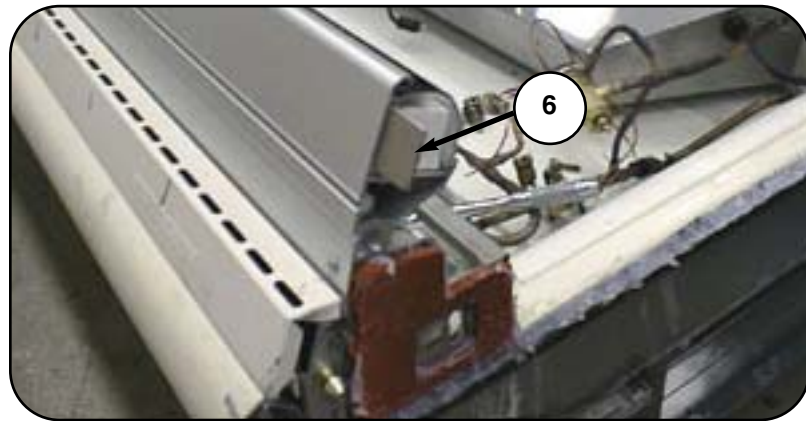

Figure 8. Front Lighting Rail Joining Plate

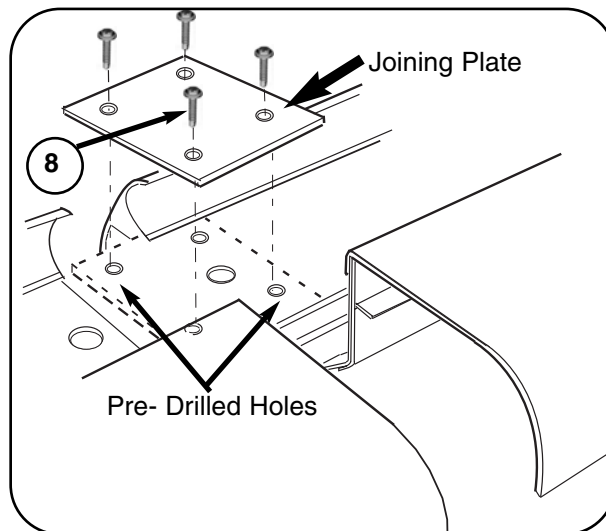

Figure 9. Installing Joining Plate

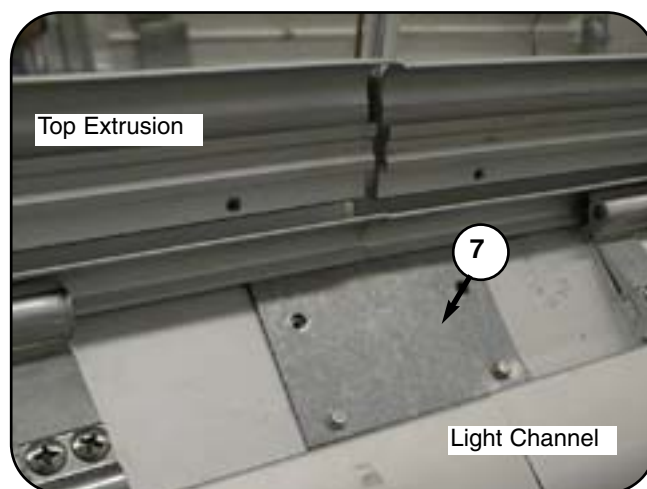

Figure 10. Joining Plate in place

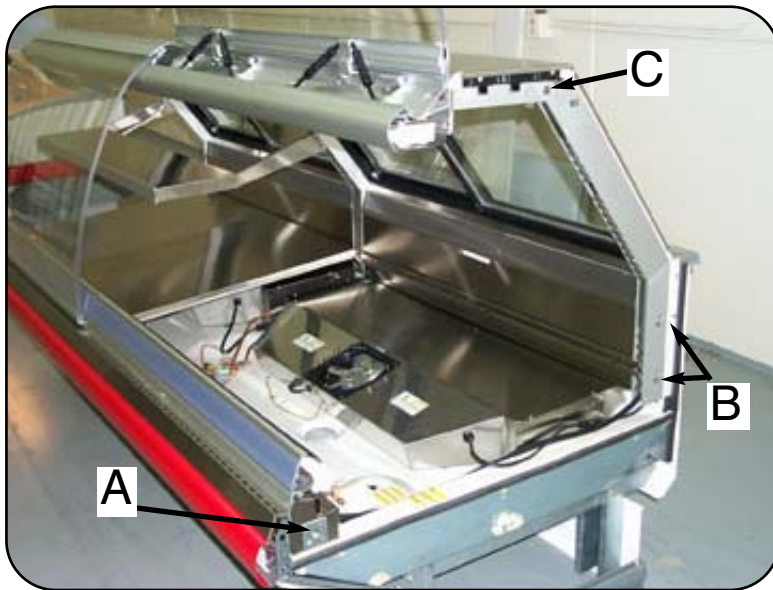

Figure 11. Sequence of Fastening

13 Follow the sequence correctly when bolting the cases together.

See Figure 11.

Note: Make sure that no more than (2) threads are exposed when the cases are bolted together. If this does occur, the bolt should be shortened, replaced with a shorter bolt or capped off according to NSF specifications.

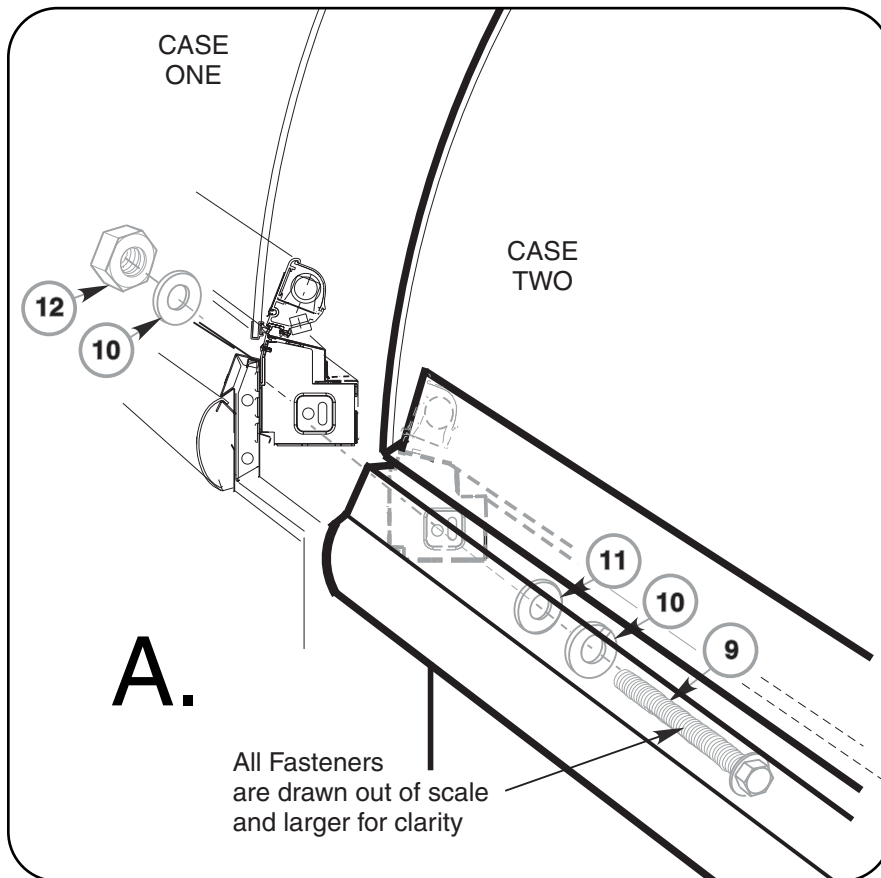

Figure 12. Fastening Front of Cases Together (Sequence A)

14 Fasten the fronts together using the following:
Cap Screws (Item -9),
Flat Washers (Item - 10),
Lock Washers (Item - 11)
and Hex Nut (Item - 12).
 See Figure 12.

15 Fasten the rear of the cases together at two locations shown below using, **Spacers (Item – 13), Cap Screws (Item – 14), Flat Washers (Item – 15), Lock Washers (Item – 16) and Hex Nut (Item – 17).** See Figure 13. Detail J.

! WARNING
Use caution when installing fasteners around wiring or refrigeration lines inside of struts.

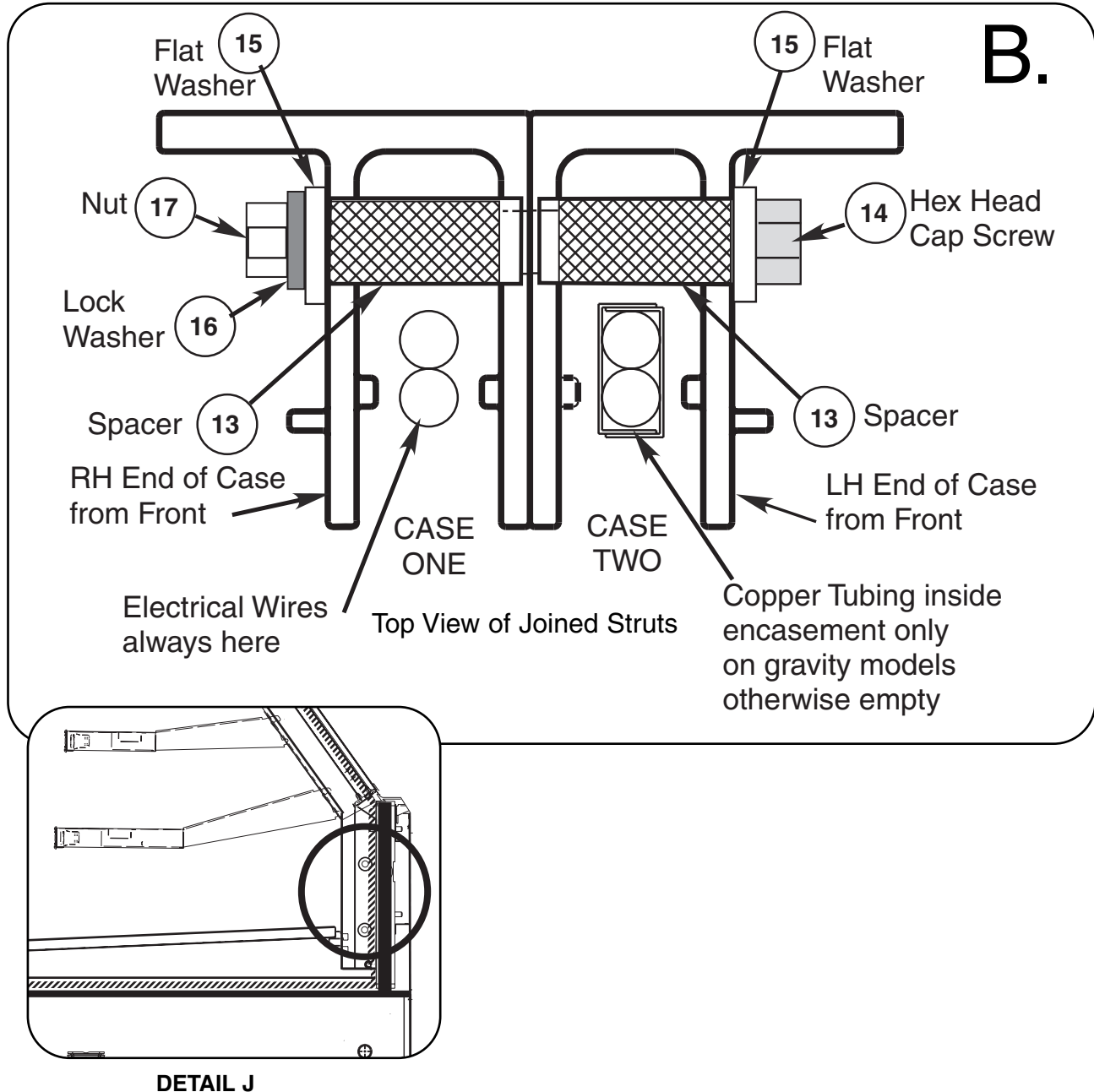

Figure 13. Fastening Rear of Cases Together (Sequence B)

16 Fasten the top rear of the cases together using **Cap Screws (Item – 18), Flat Washers (Item – 19), Lock Washers (Item – 20) and Hex Nut (Item – 21)**. See Figure 14.

Tighten until gaskets are compressed, and cases join smoothly.

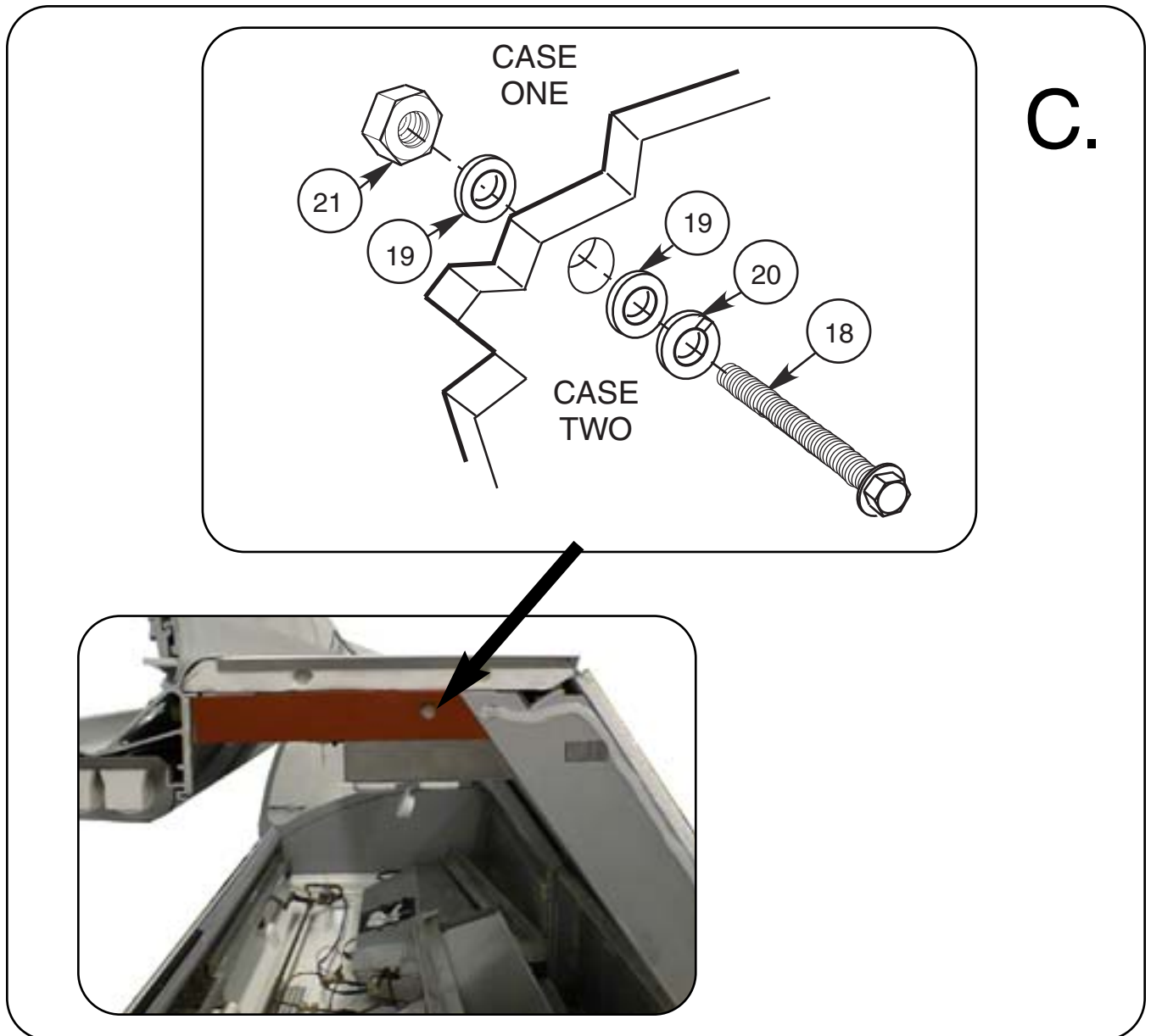
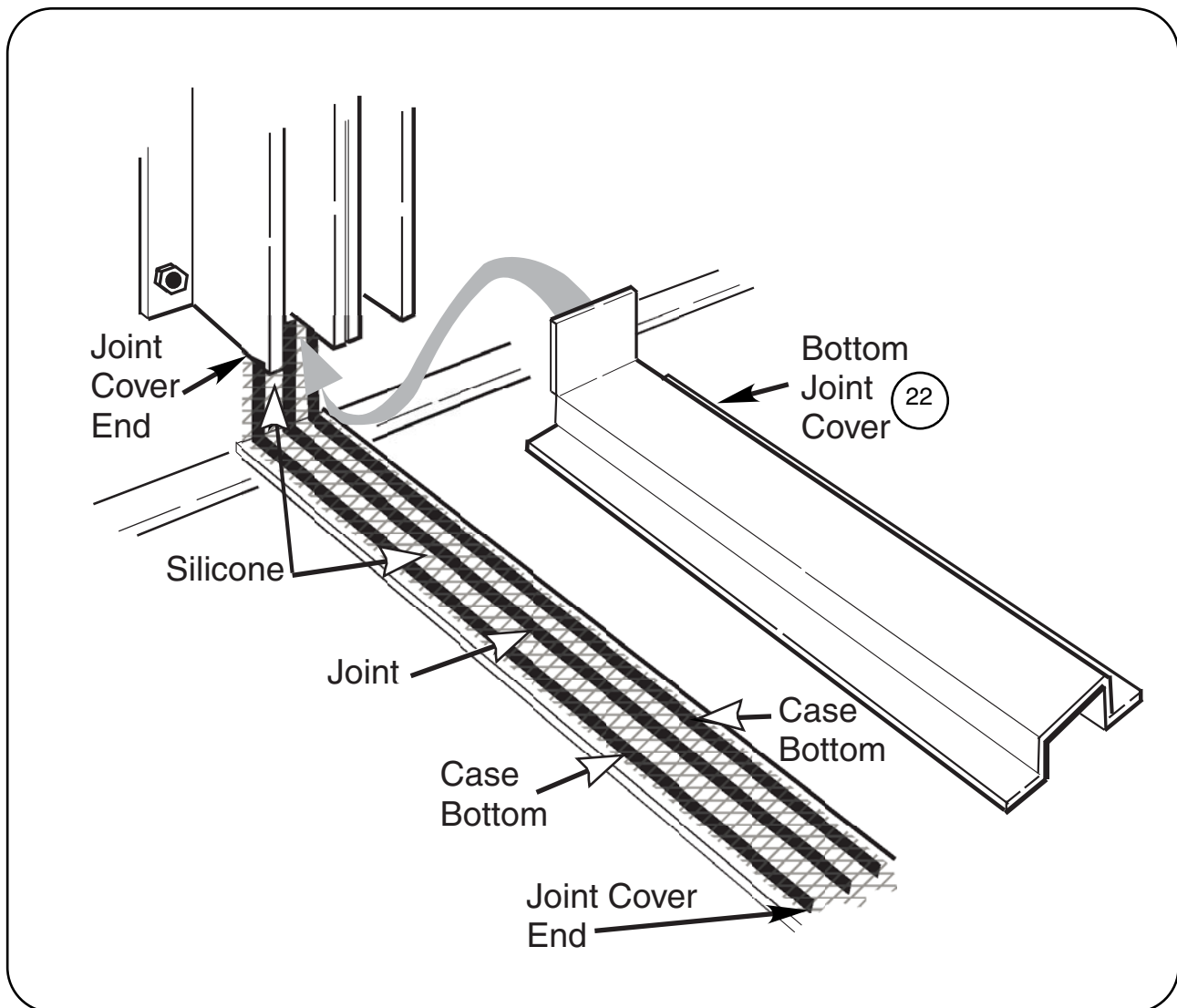

Figure 14. Fastening Top Fronts of Cases Together (Sequence C)

**SEALING THE INTERIOR
BOTTOM OF THE CASE****17** Apply a continuous bead
of **Silicone** to the joint.Apply a continuous bead of
silicone to each bottom. Press
Bottom Joint Cover (Item- 22)
over both cases.Apply silicone over each end of
the **Joint Cover.**

See Figures 15.

**Figure 15.** Installing and Sealing Joint Cover

SEALING THE EXTERIOR
OF THE CASE

18 Apply a smooth continuous
bead of silicone over the
Exterior Top Joint of the cases.



19 Continue sealing down the
Rear Mullion Joint of the
cases and finally seal the **Rear
Sill Joints**, as shown in
Figure 16, A, B and C.



Figure 16. Sealing Case Joints

20 Install the **Splashguard Joint Support (Item – 23)** to the splashguard retainer using the splashguard retainer using **Screws (Item – 24)**.

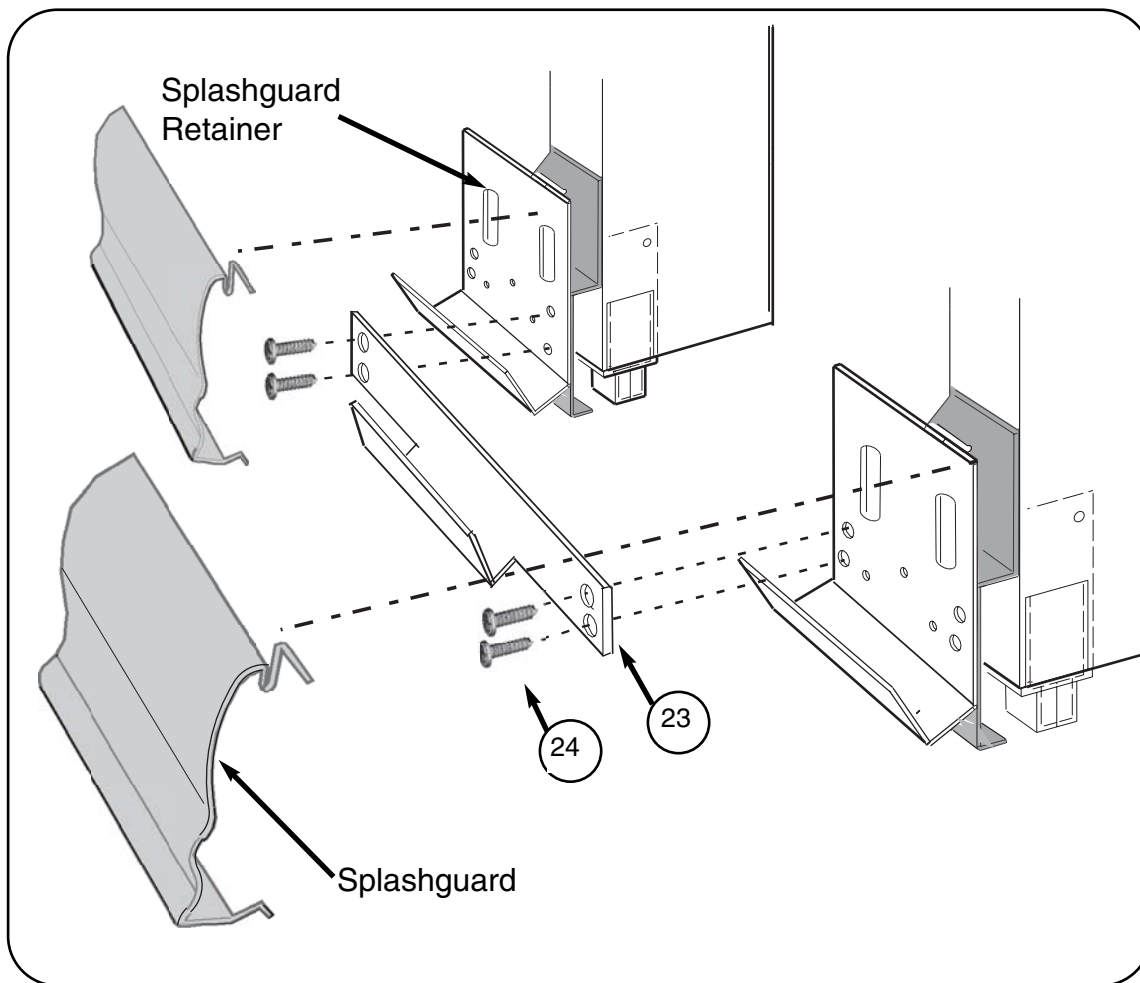

Figure 17. Installing the Splashguard Joining Bracket and Splashguard

INSTALLING BUMPERS

21

- A. Starting from left end of lineup, insert starter bumper into the front Top Bumper Retainer. Swing Bumper down into position until it “snaps” into place on the bottom of the retainer.
- B. Install full length bumper to overlap merchandiser joint. Slide toward left, closing all gaps. Repeat for rest of lineup.
- C. Use a miter box and fine toothed saw to cut last full-length bumper. See Figures 18 and 19.

22 Re-install all items that were removed in Step 1.

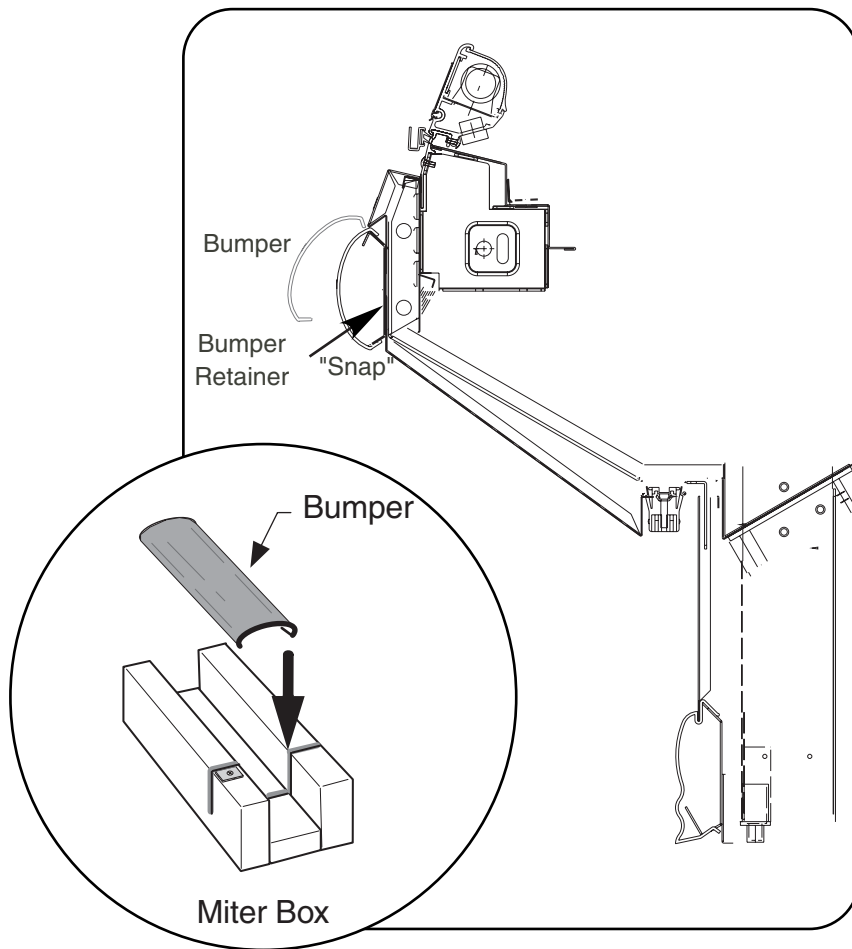

Figure 18. Install Impact Bumper

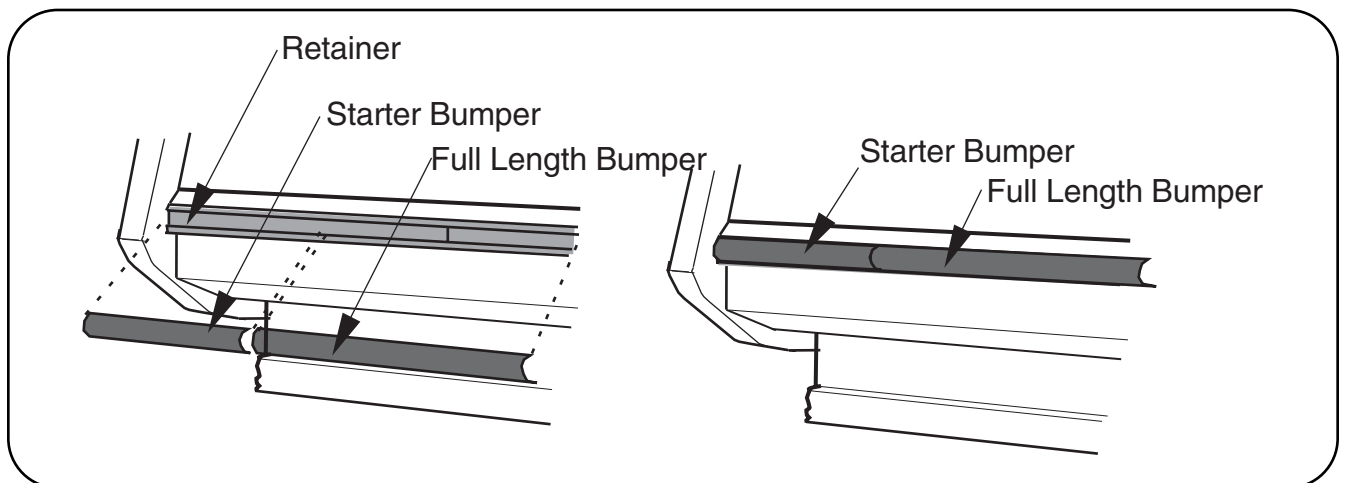

Figure 19. Installing and offsetting Bumpers