

HUSSMANN® IMPACT

Fresh Meat, Deli and Fish Merchandiser

Vertical Glass Service Merchandisers Joining Instruction

PARTS LIST

Item No.	Quantity	Description	
1.	3	Alignment Pin	
2.	1	Gasket $\frac{1}{2} \times 1\frac{5}{8} \times 180$	
3.	1	Gasket $\frac{1}{2} \times \frac{1}{2} \times 120$	
4.	1	Silicone	
5.	1	Top Gasket Pad	
6.	1	Front Gasket Pad	
7.	1	Rear Sill Joining Bracket	
8.	4	Washer Head Machine Screws 10-24 x $\frac{1}{2}$	
9.	1	Cap Screw $\frac{5}{16}$ -18 x $1\frac{1}{4}$	Front
10.	2	Flat Washer $\frac{5}{16}$	
11.	1	Lock Washer $\frac{5}{16}$	
12.	1	Hex Nut $\frac{5}{16}$ - 18	
13.	4	Spacer	Rear
14.	2	Cap Screw $\frac{5}{16}$ - 18 x $3\frac{1}{2}$	
15.	4	Flat Washer $\frac{5}{16}$	
16.	2	Lock Washer $\frac{5}{16}$	
17.	2	Hex Nut $\frac{5}{16}$ - 18	Top
18.	1	Cap Screw $\frac{5}{16}$ - 18 x 3	
19.	2	Flat Washer $\frac{5}{16}$	
20.	1	Lock Washer $\frac{5}{16}$	
21.	1	Hex Nut $\frac{5}{16}$ - 18	
22.	4	Cap Plug	
23.	1	Interior Trim	
24.	1	Exterior Trim	
25.	1	Bottom Joint Cover	
26.	1	Splashguard Joint Support	
27.	4	Hex Head Sheet metal Screw #8 x $\frac{1}{2}$	



NOTE: Be sure merchandisers have been leveled according to the installation instructions. Carefully unpack and inspect the Joining Kit, making sure there is no breakage or damage.



CAUTION

DO NOT remove rider until case is in its final position.

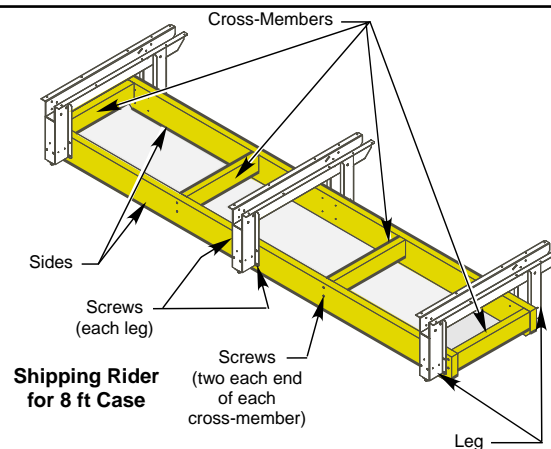

Removing Items from the Case:

- 1** Remove items below:
- A. *Shelves if installed,*
 - B. *Display Pans,*
 - C. *Rear Pan Bracket and Upright,*
 - D. *Rear Panel and Discharge Grille,*
 - E. *Front Return Air Grille*
- from case. **See Figure 1.**

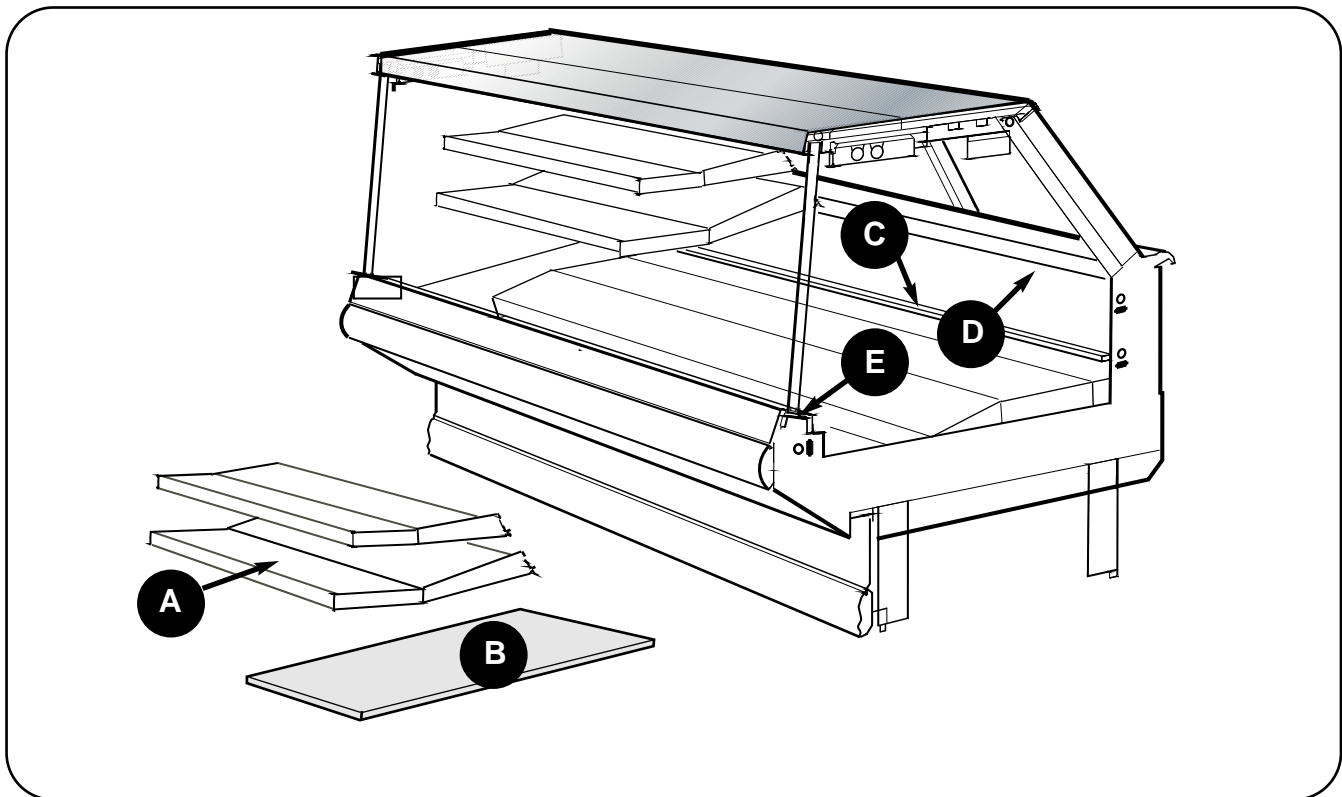

Figure 1. Removing Items from Case

Installing Gaskets:

IMPORTANT

Make sure the Alignment Pins (Item – 1) in the front near the bumpers and at top front are in place before gasketing and sealing cases. See Figures 2 and 3.

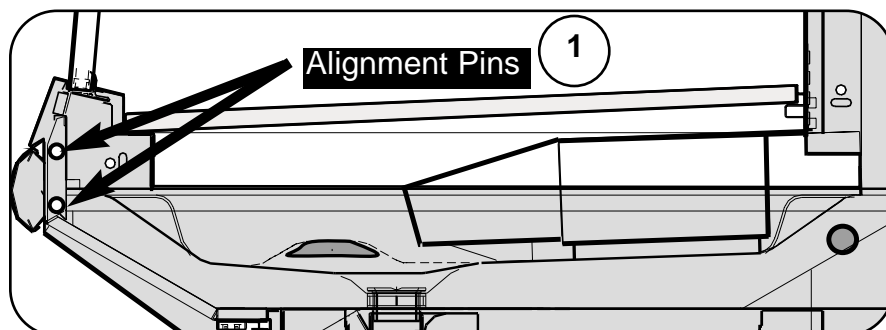

Figure 2. Checking Alignment Pins

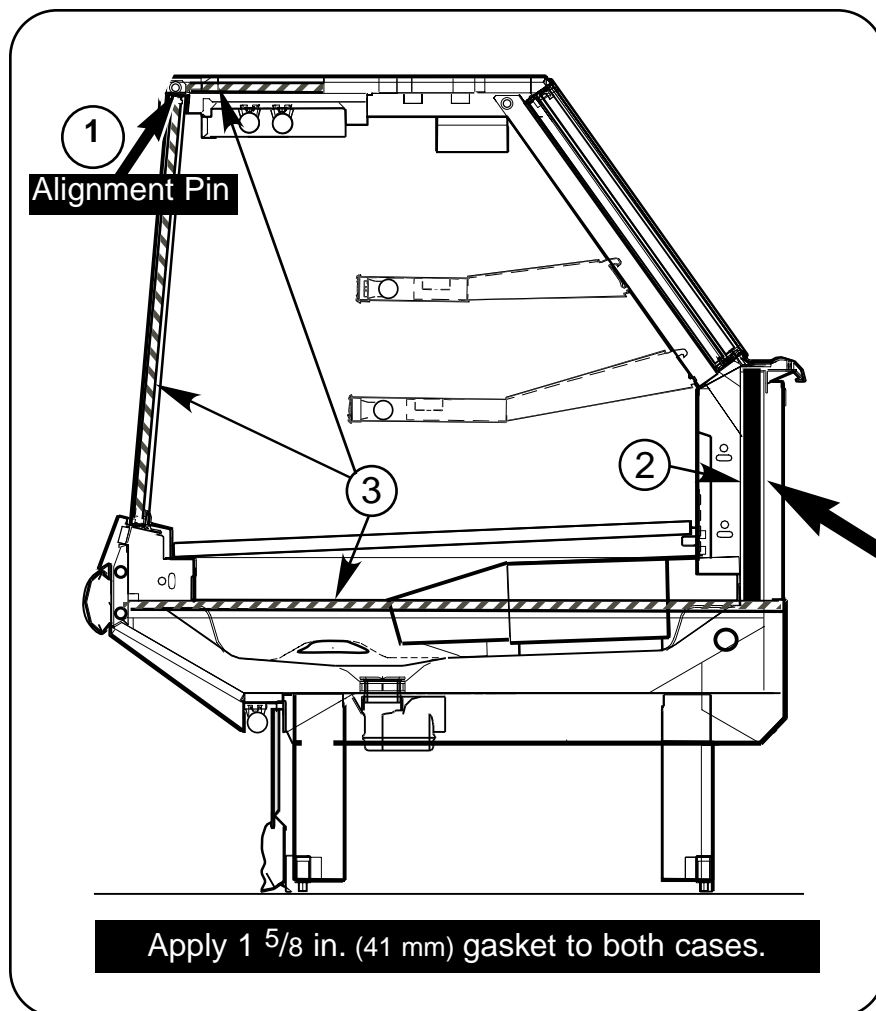

Figure 3. Applying 1 5/8 in. and 1/2 in. Gaskets to the Merchandiser

- 2** Apply 1 5/8 in. (41 mm) **Gasket (Item – 2)** to rear foam panel of both cases as shown. Check to be sure that there are no gaps between gasket and merchandiser.

NOTE: THIS IS THE ONLY GASKET THAT IS APPLIED TO BOTH CASES. THE FOLLOWING STEPS MUST BE DONE TO ONE CASE ONLY.

SEE FIGURE 3, DETAIL A.

- 3** Apply 1/2 in. (13 mm) **Gasket (Item – 3)** to the horizontal recess across the bottom and on the edge of the glass. See Figure 3, Detail A.

- Do not stretch gasket, especially around corners.
- Do not butt gaskets; always overlap them as shown.
- Remove paper backing after gasket has been applied.

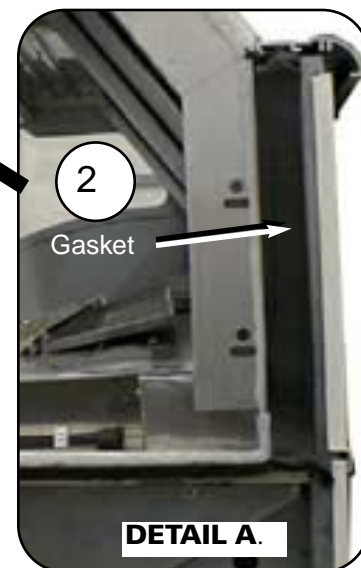

Applying Silicone

4 Before joining, lay a 1/2 in. bead of clear **Silicone (Item – 4)** along the perimeter of the case as shown in **Figure 4**.

5 In addition, apply silicone around the perimeter of the front box bracket and over a portion of the frame as shown in **Figure 4, Details B and C**.

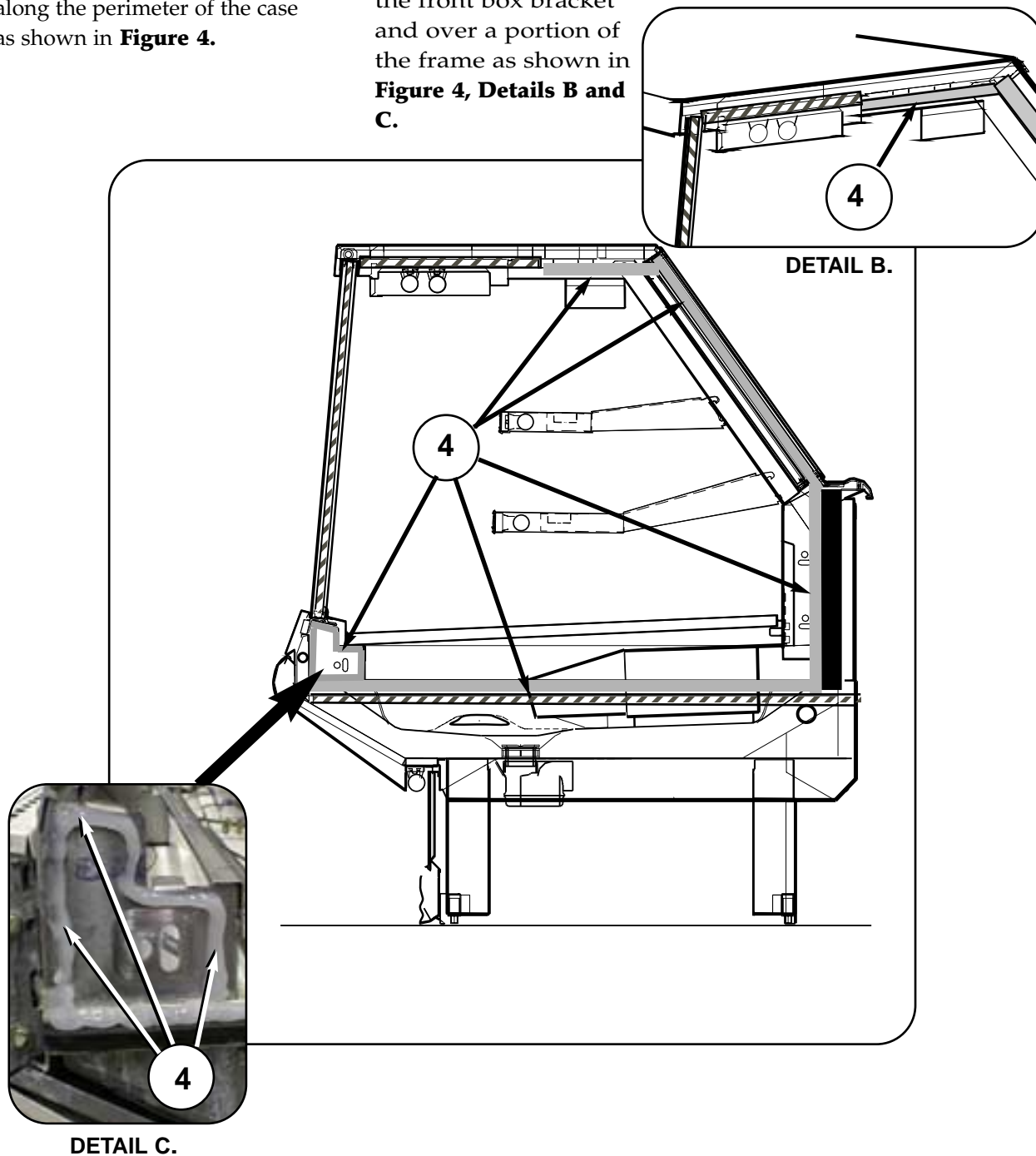

Figure 4. Applying Silicone

Applying Top and Front Gasket Pads

- 6** Install the **Top Gasket Pad**, (Item – 5) over the silicone applied in previous step. See **Figure 5, Detail D.**

- 7** Install the **Front Gasket Pad**, (Item – 6) over silicone applied in previous step. See **Detail E.**

- 8** Apply **Silicone** (Item – 4) onto the **Top Gasket Pad** (Item – 5) and the **Front Gasket Pad** (Item – 6). See **Details F and G.**

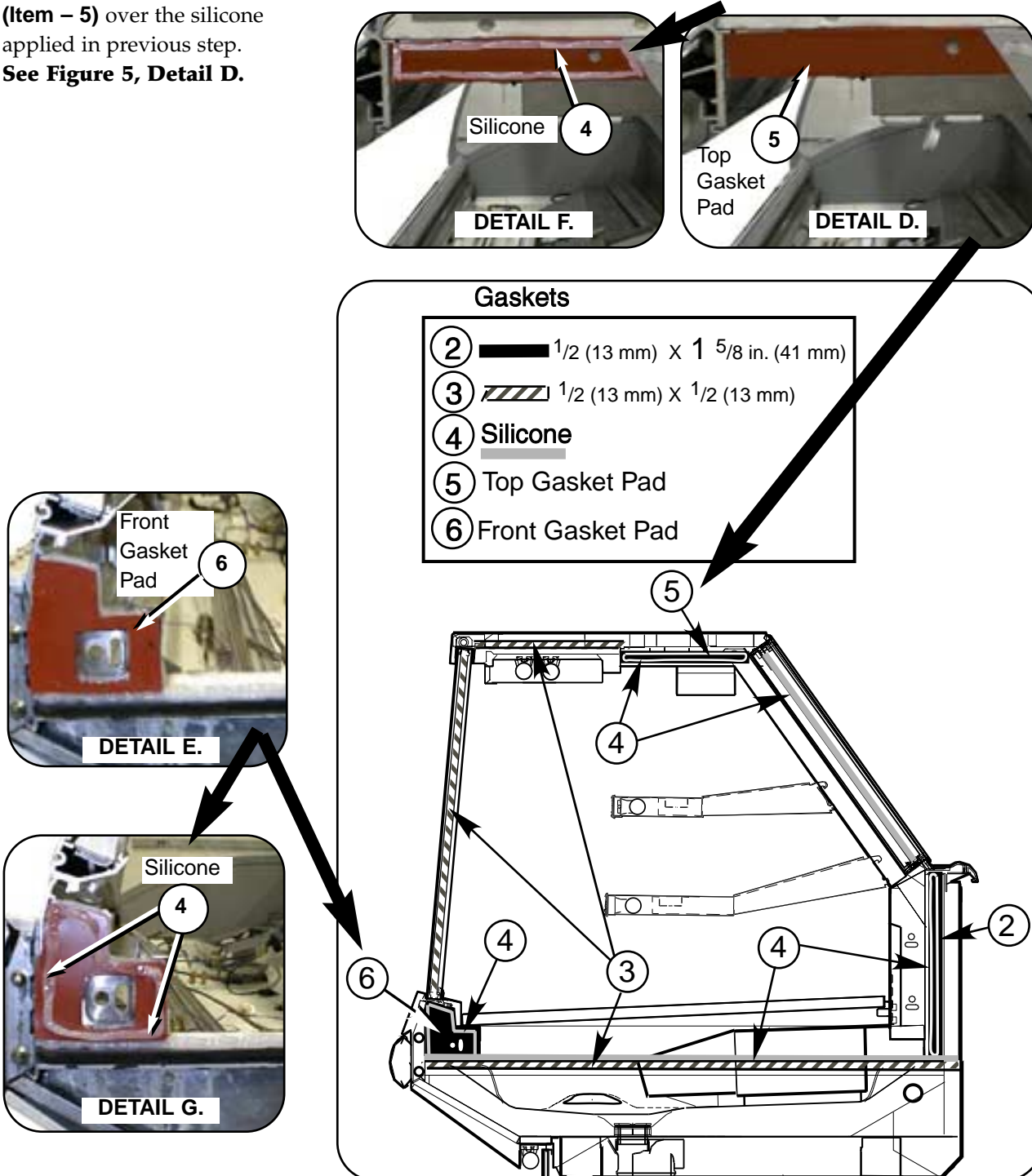

Figure 5. Applying Top and Front Gasket Pads

- 9** Move the second merchandiser into position against the first. Match the alignment pins with the corresponding holes. **See Figure 6, Details H and I.**

- 10** The complete lineup must be leveled to the highest point of the floor. After the first merchandiser has been set, position the second so the end frames touch.

- A.** Set a long level (4 foot or more) on the upper front panel of the merchandisers. Adjust case height by rotating the *Adjustable Leg Leveler* until the merchandisers are flush and level.

See Figure 6, Detail J.

- B.** Also check each joint area to be sure that the panels of adjoining merchandisers are flush to each other.

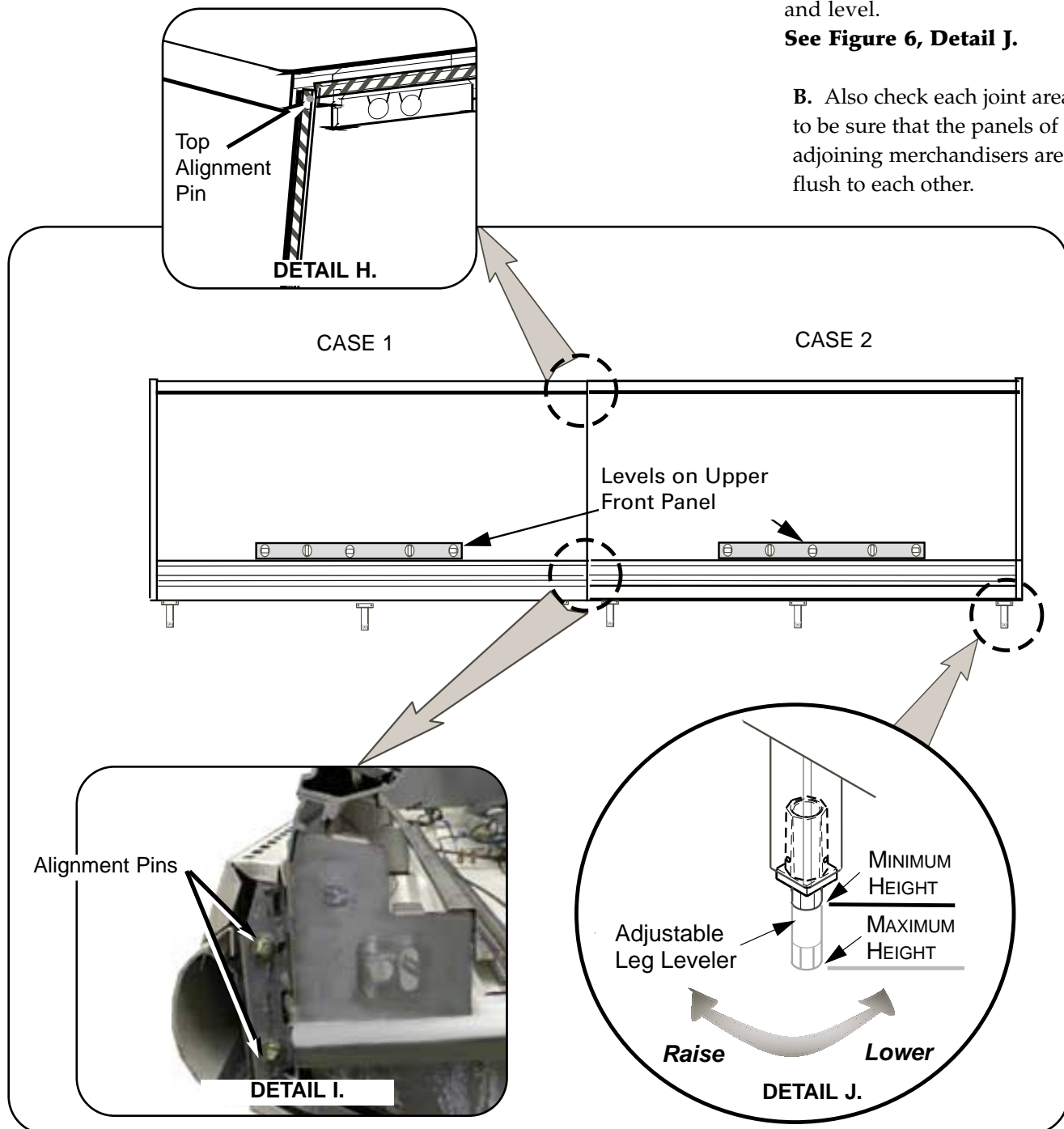
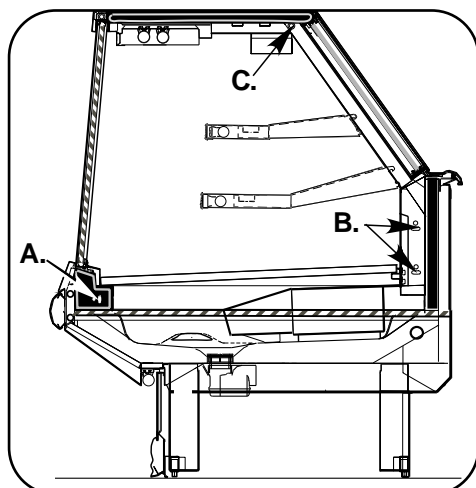

Figure 6. Leveling Merchandisers



DETAIL K.

11 Follow the sequence correctly when bolting the cases together. See Figure 7, Detail K.

12 Fasten the fronts together using Cap Screws (Item – 9), Flat Washers (Item – 10), Lock Washers (Item – 11), Hex Nut (Item – 12) and Cap Plug (Item – 22). See Figure 7, Sequence A.

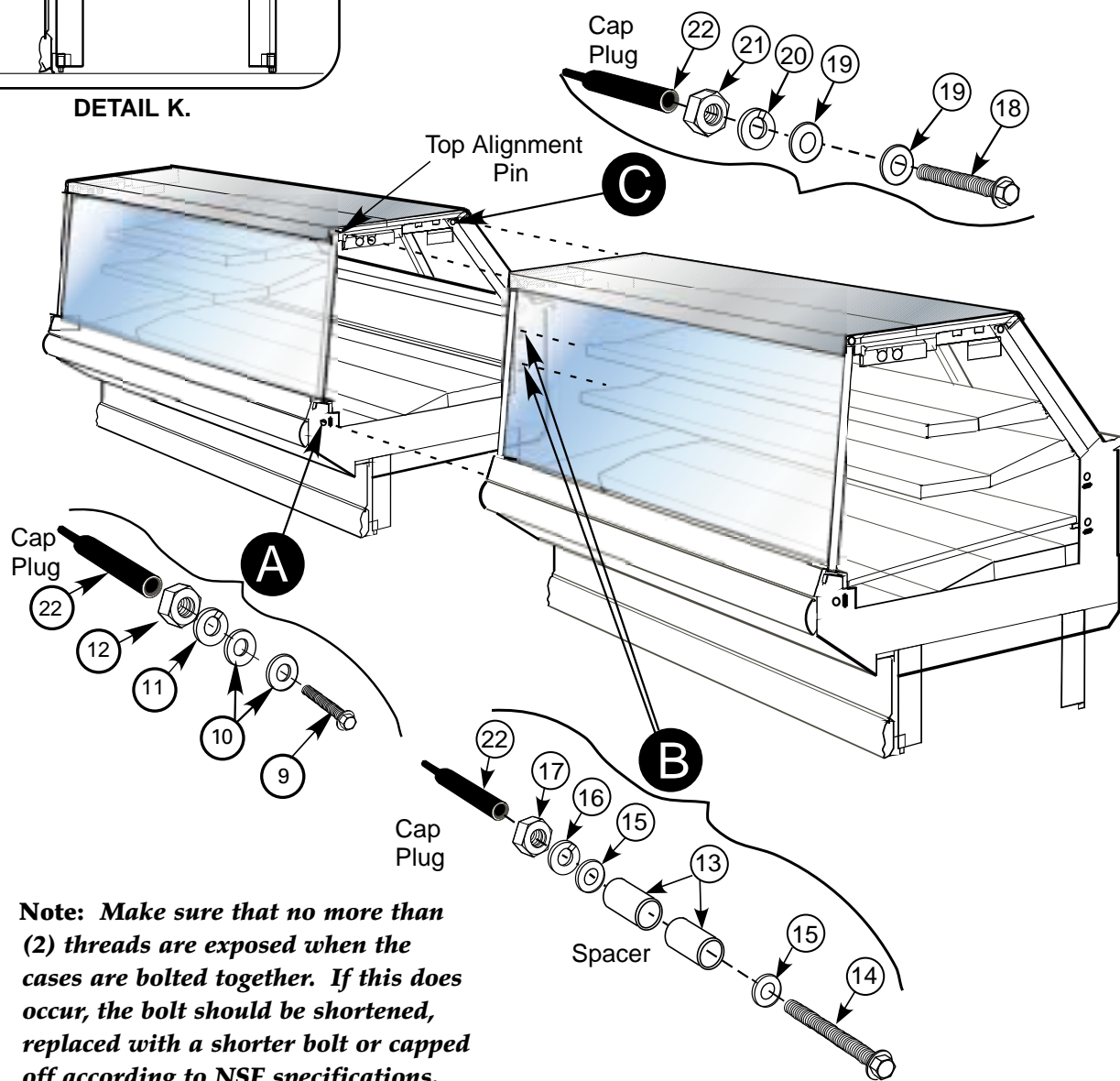

Figure 7. Overview of Fastener Locations

- 13** Fasten the rear of the cases together at two locations shown below using,
Spacer (Item – 13),
Cap Screws (Item – 14),
Flat Washers (Item – 15),
Lock Washers (Item – 16),
Hex Nut (Item – 17) and
Cap Plug (Item – 22).
 See **Figure 8, Detail L.**



WARNING

Use caution when installing fasteners around wiring or refrigeration lines inside of struts.

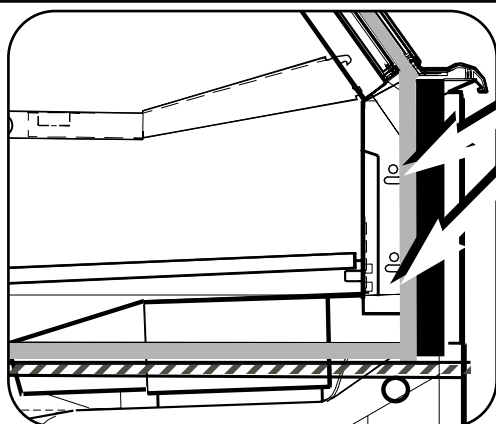
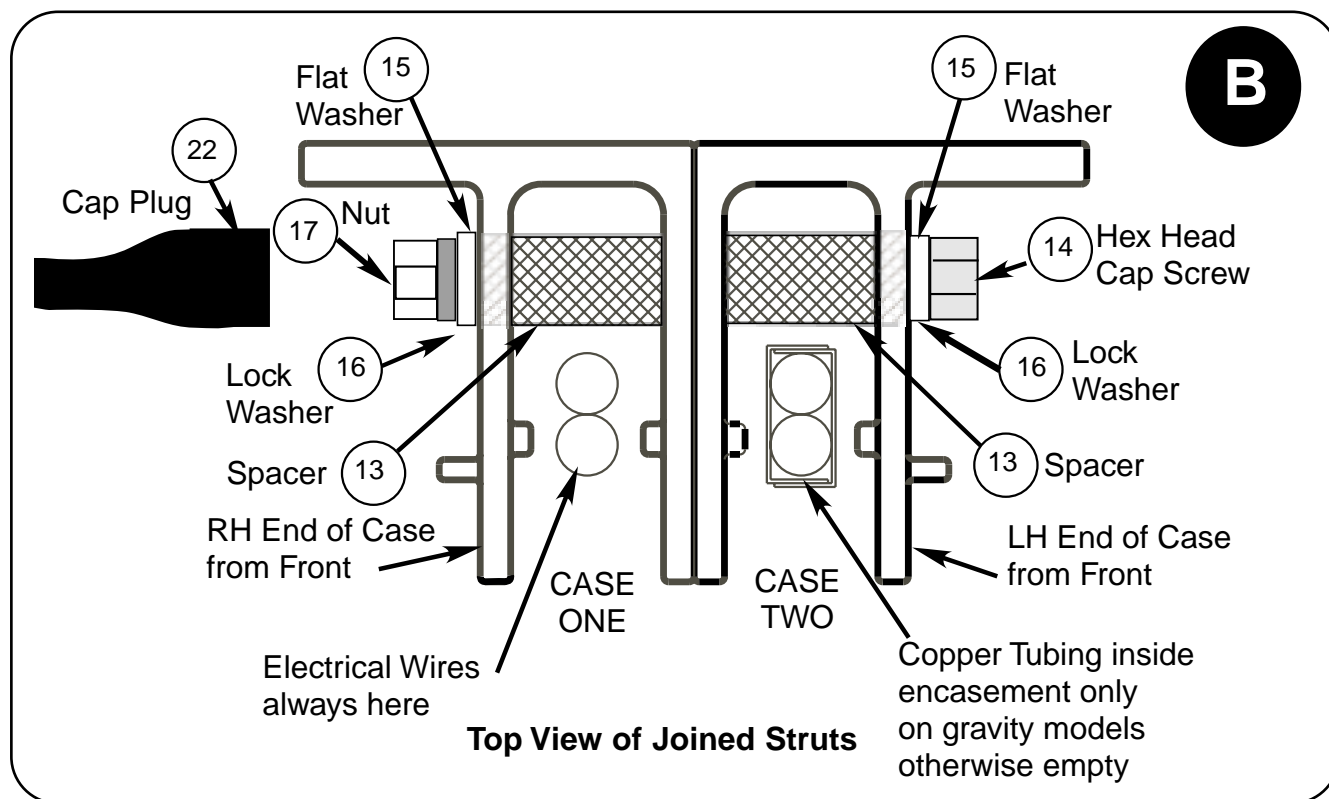

DETAIL L.

Strut Joining Location

Figure 8. Fastening Rear of Cases Together (Sequence B)

- 15** Fasten the top rear of the cases together using **Cap Screws (Item – 18), Flat Washers (Item – 19), Lock Washers (Item – 20) Hex Nut (Item – 21), and Cap Plug (Item – 22).** See Figure 9.

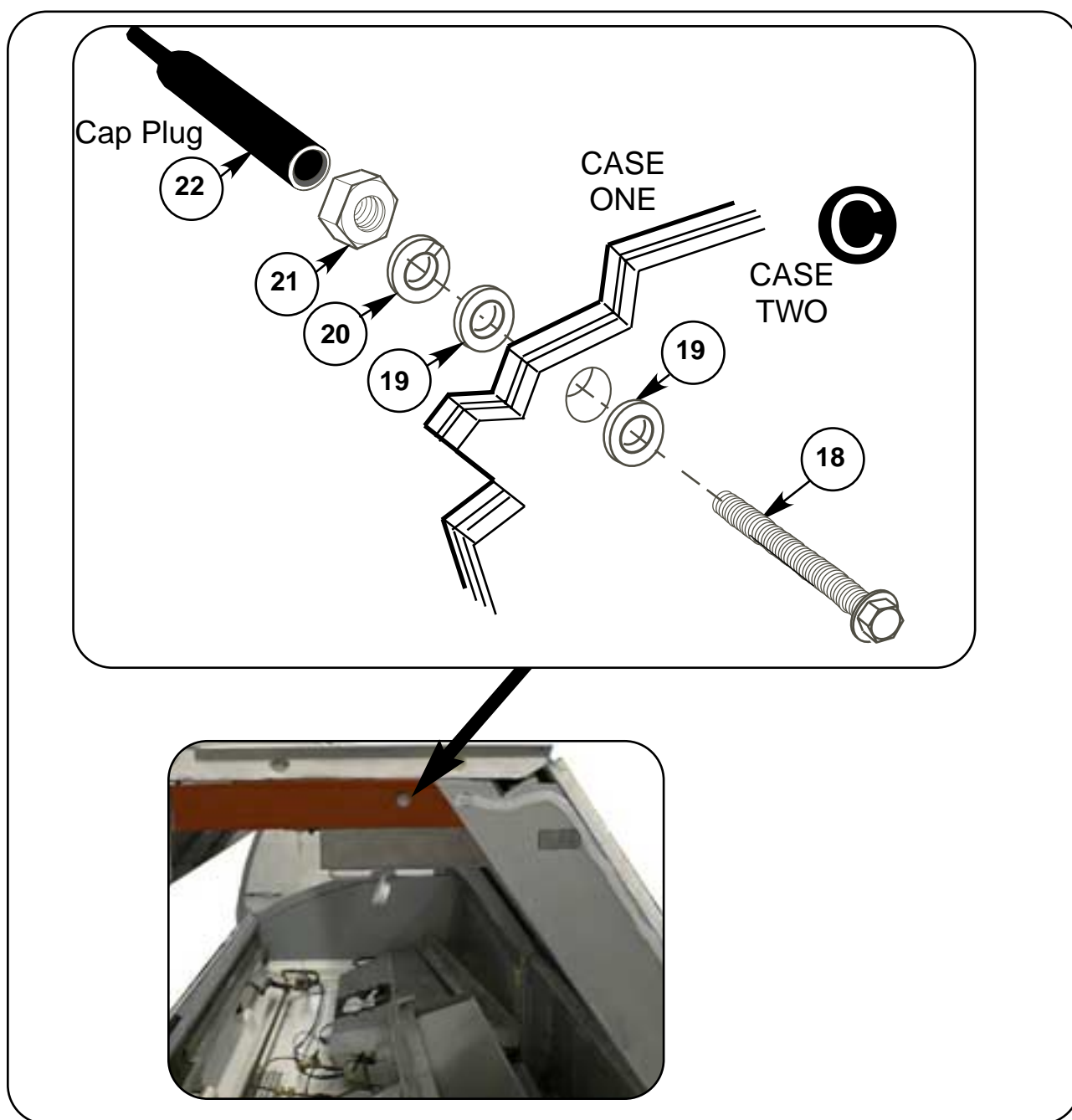

Figure 9. Fastening Top Fronts of Cases Together (Sequence C)

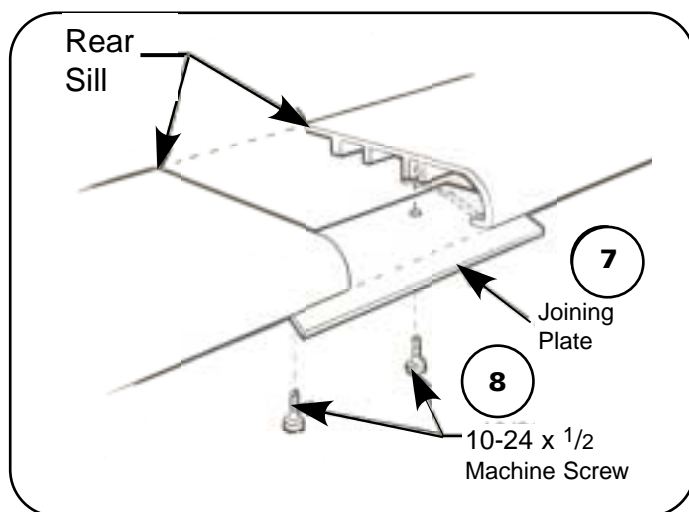

Figure 10. Joining Rear Sill

- 16** Align the **Rear Sill** and attach **Joining Bracket** (Item – 7) with **Washer Head Machine Screw** (Item – 8). See **Figure 10**.



CAUTION

Use only specified fasteners. Longer screws will penetrate rear sill causing damage.

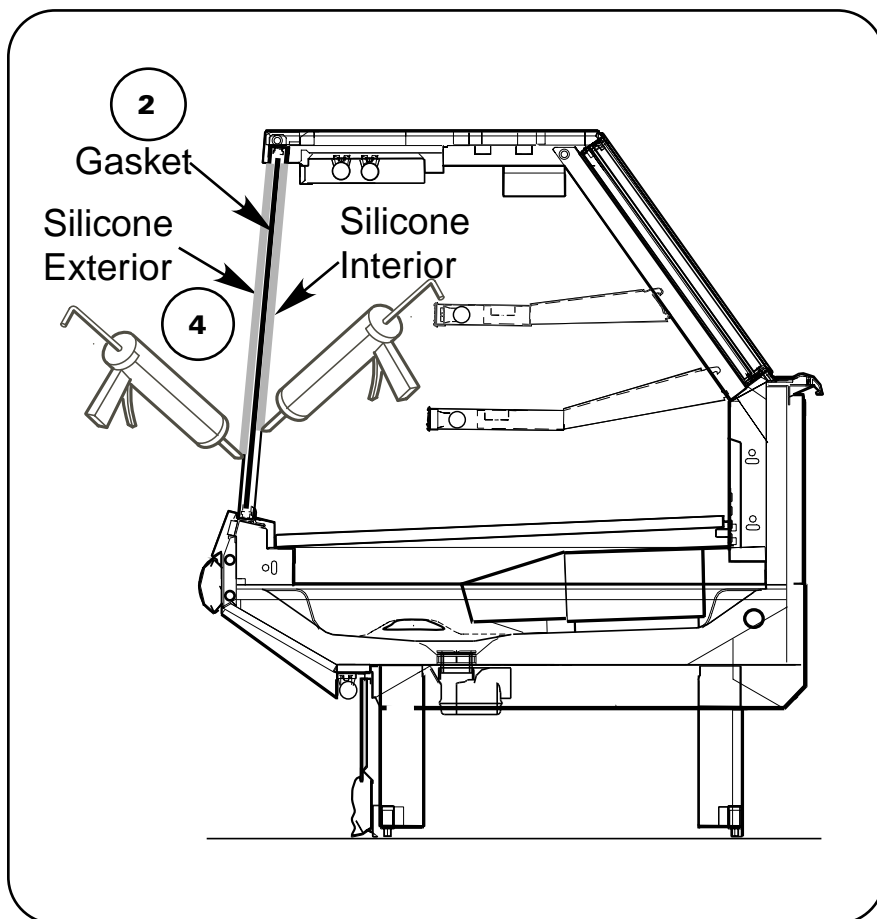

Figure 11. Front Lighting Rail Joining Plate

- 17** Apply a bead of **Silicone** (Item – 4) down and into the joint from the exterior and interior side of glass next to the **Gasket** (Item – 2). See **Figure 11** and **Figure 12** on next page.

Adding Trim to the Joint and Front Glass

- 18** While the silicone is still wet, insert the **Interior and Exterior Trim (Items – 23 and 24)** into the silicone that was applied in Step 17. Apply tape over the trims to hold them in place as the silicone dries for 24 hours. See **Figure 12, Details M, N and O** for this procedure.

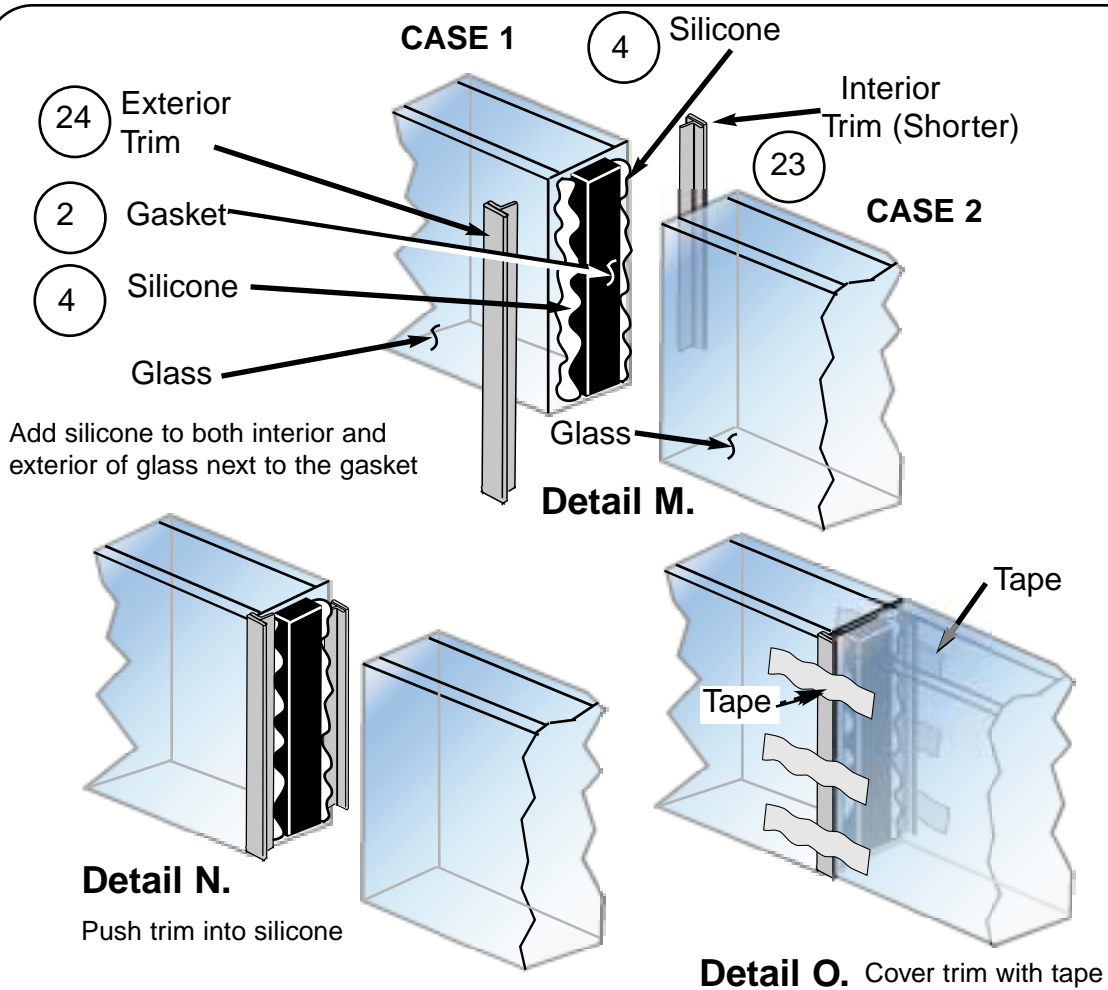
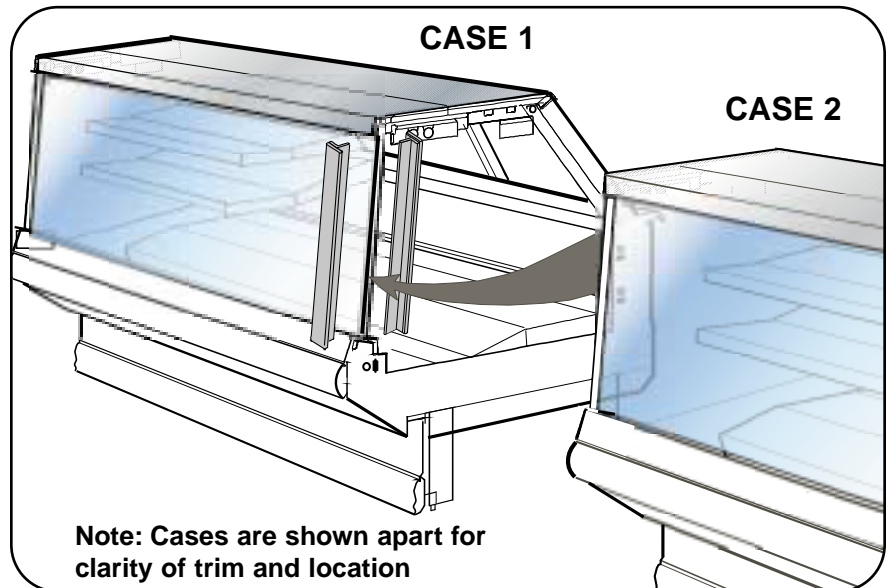

Figure 12. Sealing and adding trim to the Front Joint of Case

SEALING THE INTERIOR BOTTOM OF THE CASE

- 19** Apply a continuous bead of **Silicone (Item – 4)** to the joint. Apply a continuous bead of silicone to each bottom. Press **Bottom Joint Cover (Item – 25)** over both cases. Also apply silicone over each end of the Joint Cover. See **Figure 13**.

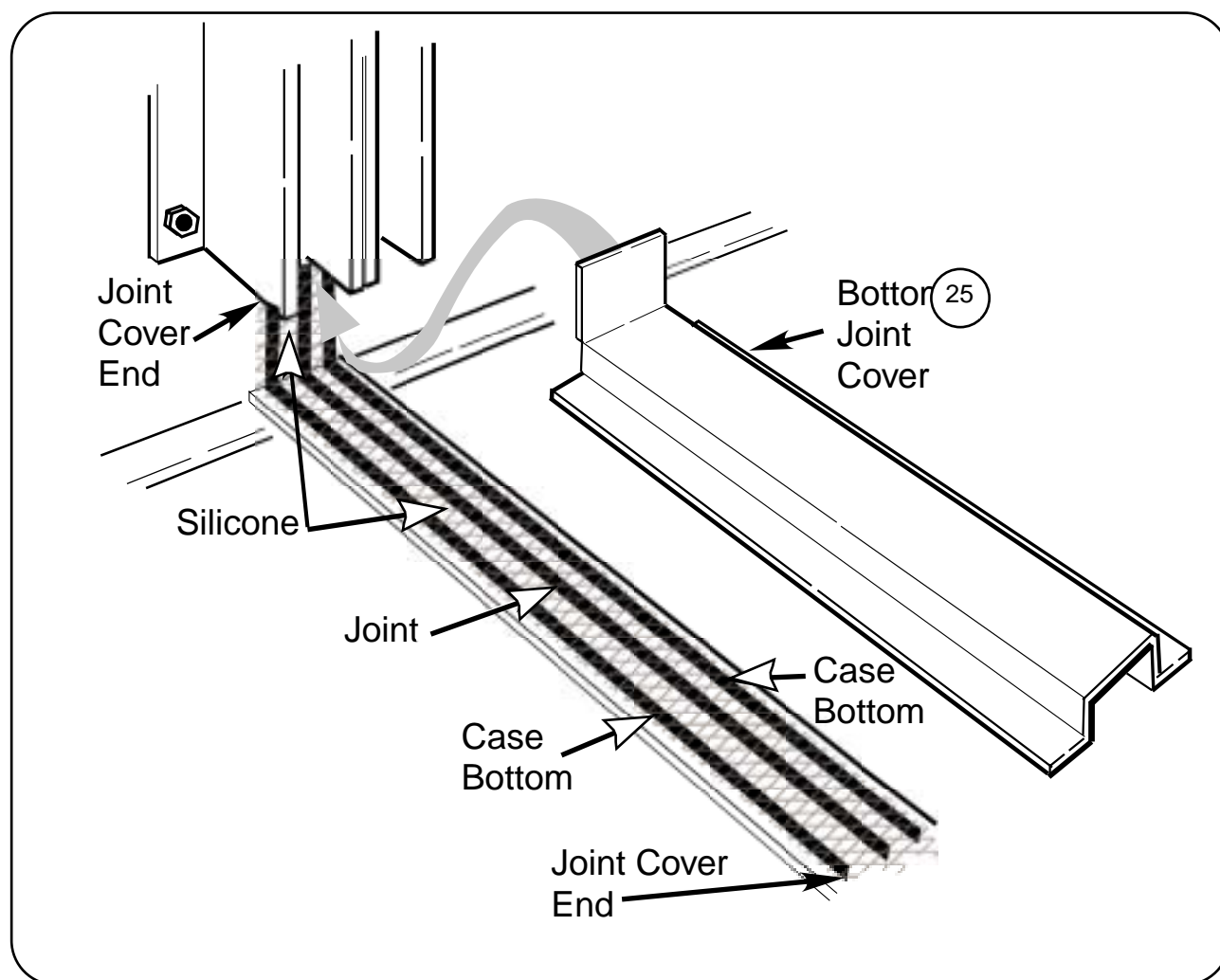

Figure 13. Installing and Sealing Joint Cover



SEALING THE EXTERIOR OF THE CASE

20 Apply a smooth continuous bead of silicone over the *Exterior Top Joint* of the cases.

See Figure 14, Detail P.



21 Continue sealing down the *Rear Mullion Joint* of the cases and finally seal the *Rear Sill Joints*, as shown in **Figure 14, Details Q & R.**



Figure 14. Sealing Case Joints

- 22** Install the **Splashguard Joint Support (Item – 26)** to the splashguard retainer using **Screws (Item – 27)**. See **Figure 15**.

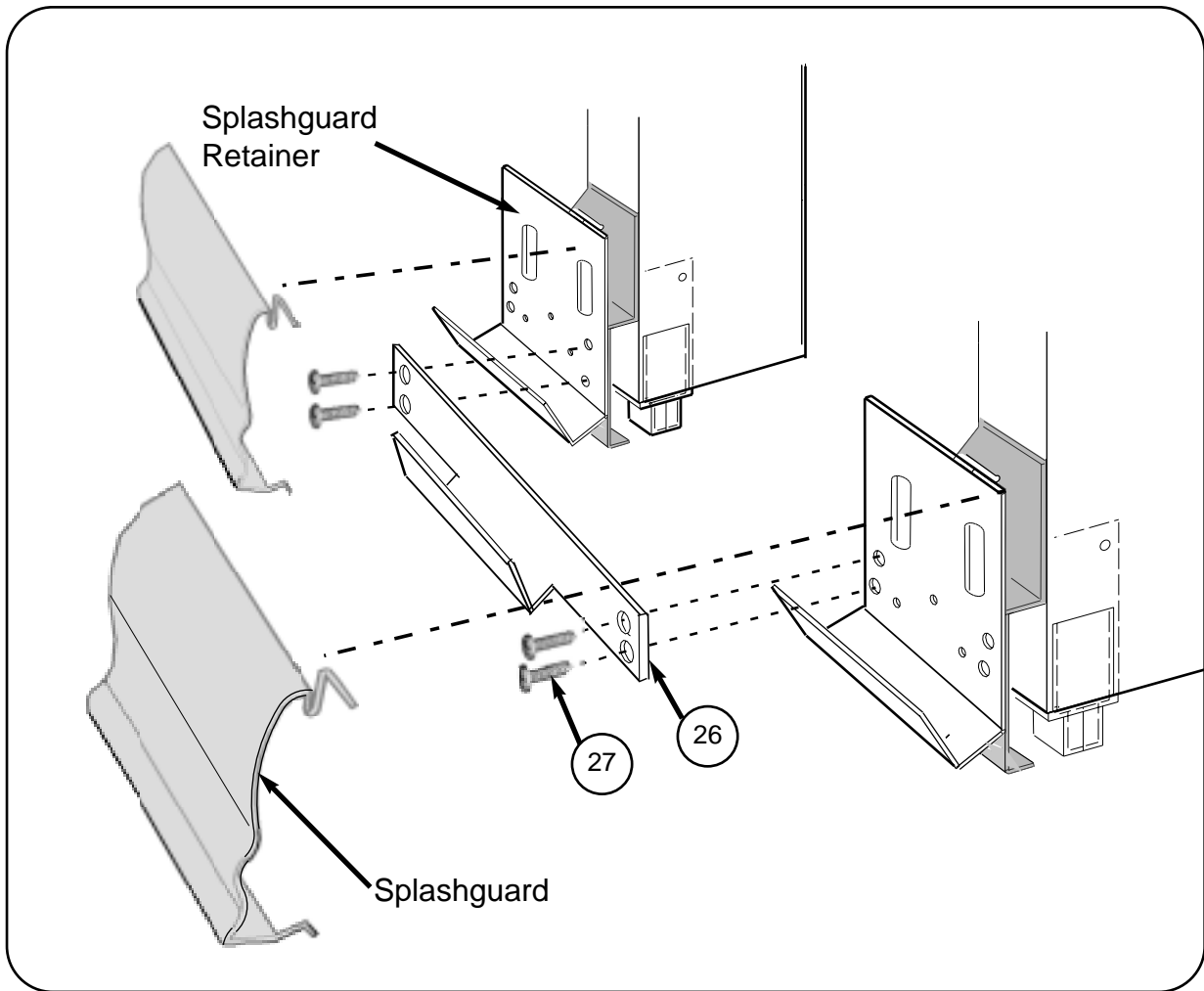

Figure 15. Installing the Splashguard Joining Bracket and Splashguard

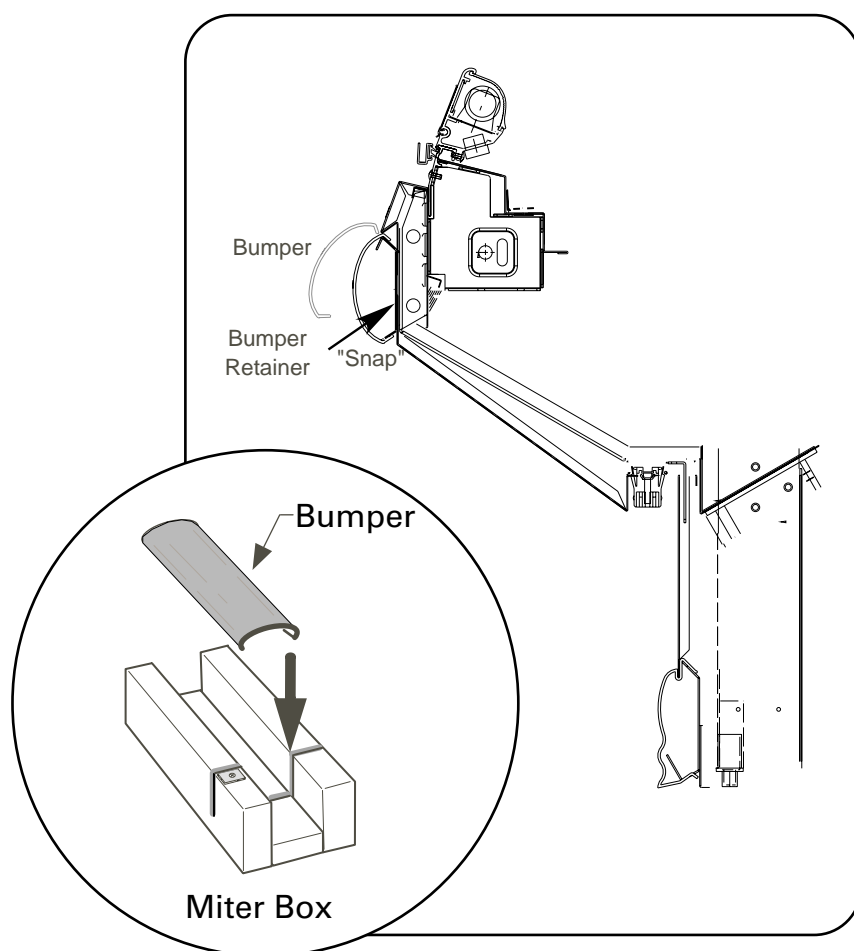

Figure 16. Installing Impact Bumper

23 TO INSTALL BUMPERS:

- A. Starting from left end of line-up, insert 2 foot (610 mm) starter bumper into the front Top Bumper Retainer. Swing Bumper down into position until it "snaps" into place on the bottom of the retainer.
- B. Install full length bumper to overlap merchandiser joint. Slide toward left, closing all gaps. Repeat for rest of line-up.
- C. Use a miter box and fine toothed saw to cut last full-length bumper.

See Figures 16 and 17.

24 Re-install all items that were removed in Step 1.

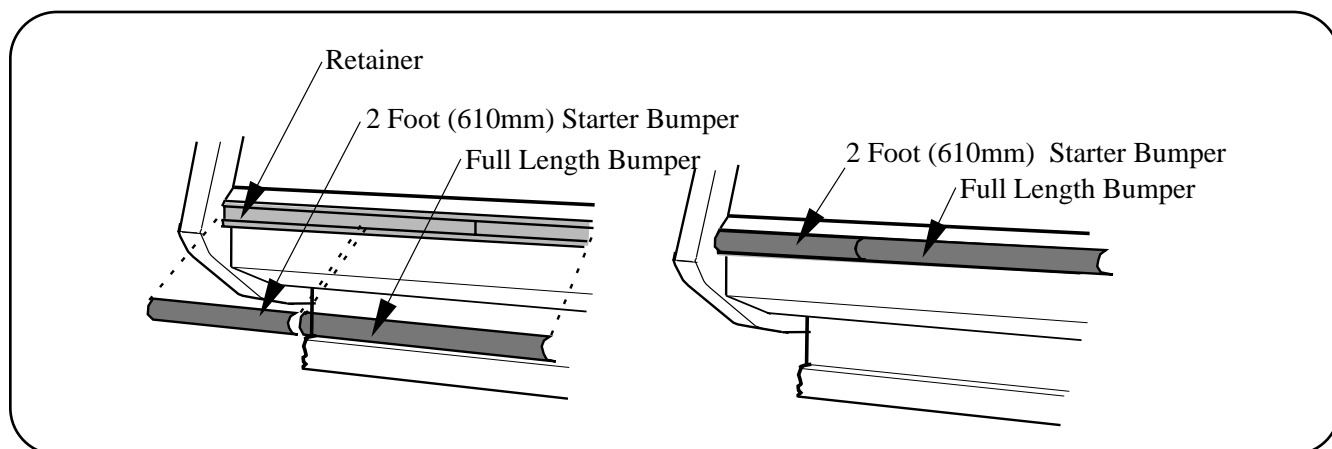

Figure 17. Installing and offsetting Bumpers