

PARTS LIST

Item	Quantity		Description
	D5RRI	D5RRIS	
1.	1	1	Gasket $\frac{1}{2} \times \frac{1}{2} \times 60$ (1524 mm)
2.	1	1	Gasket $\frac{1}{2} \times 1\frac{5}{8} \times 120$ (3048 mm)
3.	9	5	Cap Screw $\frac{5}{16}$ -18 x $1\frac{1}{4}$
4.	9	5	Lock Washer $\frac{5}{16}$
5.	9	5	Flat Washer $\frac{5}{16}$
6.	1	1	Threaded Rod $\frac{1}{2}$ -16 x 12 (305 mm)
7.	2	2	Flat Washer $\frac{1}{2}$
8.	2	2	Hex Nut $\frac{1}{2}$ -16
9.	1	1	Silicone Sealer

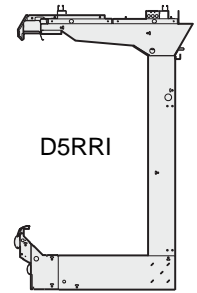

D5RRI

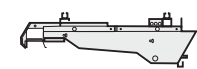

D5RRIS

Note: Nut retainers are factory installed in the left end, and alignment pins are factory installed in the right end of each merchandiser.



NOTES:

- Be sure merchandisers have been leveled according to the installation instructions.
- Be sure factory-installed nut retainers and alignment pins are in place.
- Install optional shelf kits after all merchandisers have been joined.

- 1 Remove front air grille and honeycomb from the right end as shown in Figure 1.

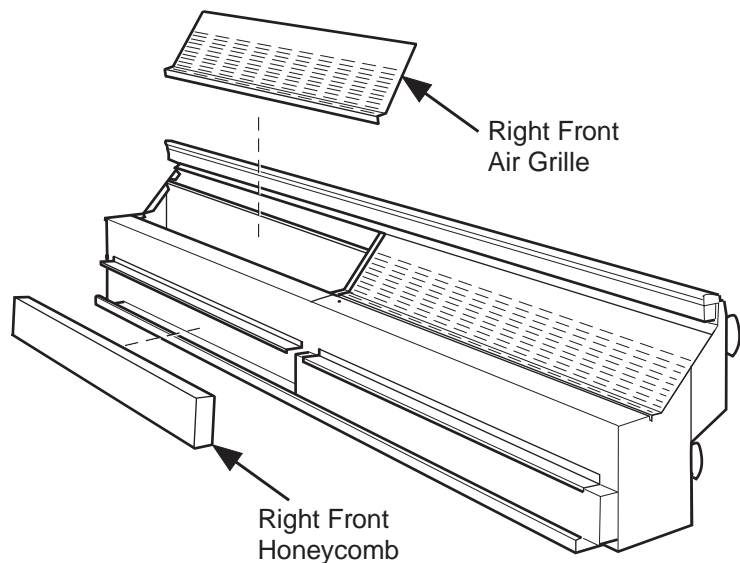

Figure 1. Remove Air Grille and Honeycomb

P/N 0435047
January, 2003

- 2** Verify that nut retainers and alignment pins are installed in the right-hand end of the left case in the locations shown in Figure 2.

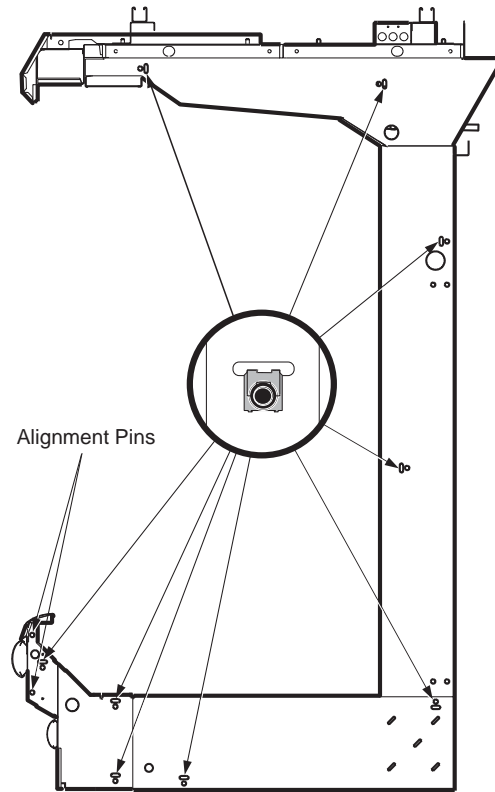
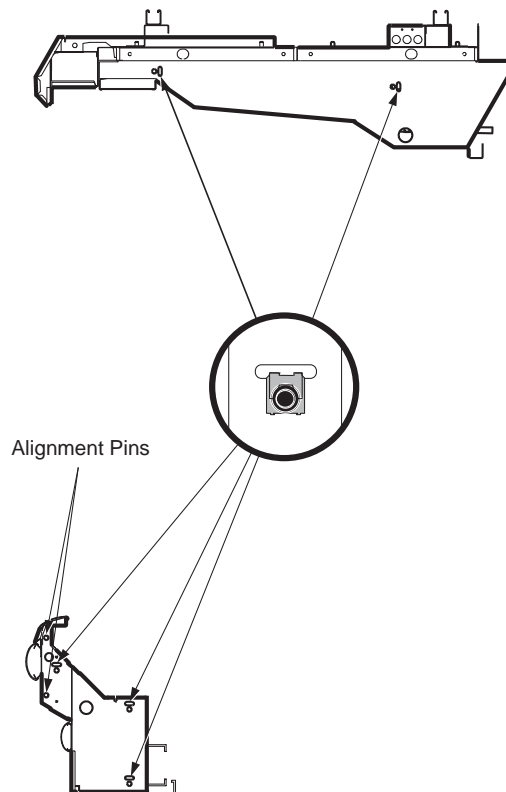
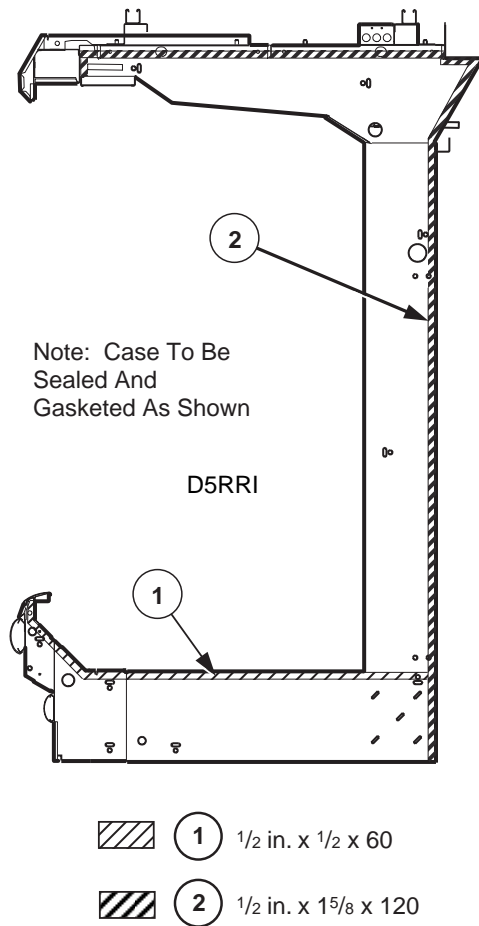

Figure 2. Verify Nut Retainer and Alignment Pin Installation





- 3** Apply **Gasket – 1** along the center of the lower assembly. Apply **Gasket – 2** to *cover foam-to-metal gap* at rear and across top as shown in Figure 3. Lap gaskets at lower corners. Check that there are no gaps between gasket and case.
- Do not stretch gasket, especially around corners.
 - Do not butt gaskets; always lap joints.
 - Remove paper backing after gasket is applied.

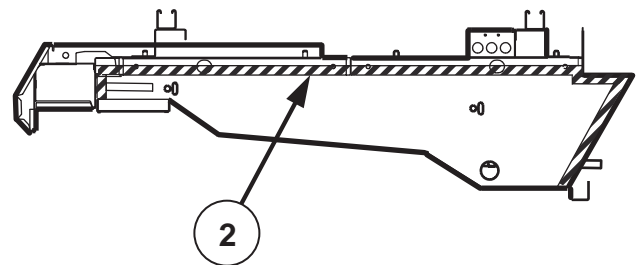
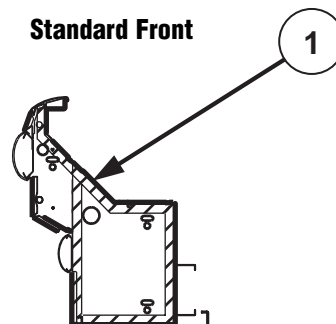
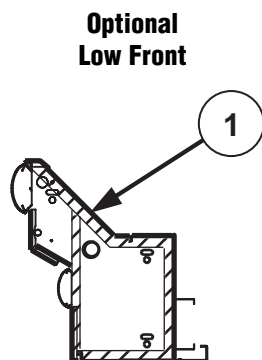

Figure 3. Apply Gaskets



4 Move second merchandiser against first, mating alignment pins with corresponding holes.

5 Fasten fronts together using **Cap Screw – 3**, **Flat Washers – 4**, and **Lock Washers – 5** as shown in Figure 4. *Tighten only until front panels touch. Do not tighten fully.*

6 Use **Cap Screws – 3** with **Flat Washers – 4** and **Lock Washers – 5** to draw merchandisers together at rear. Start at the bottom, then middle, then top; tighten until gaskets are compressed.

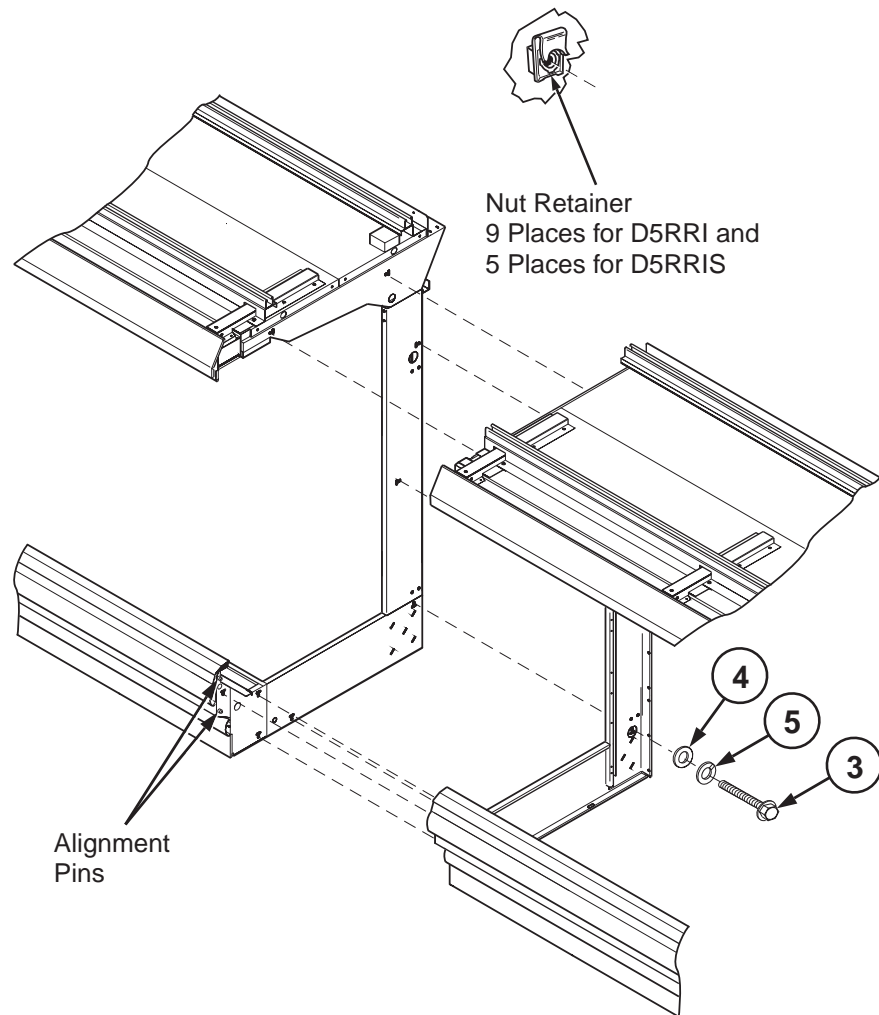

Figure 4. Joining Ends

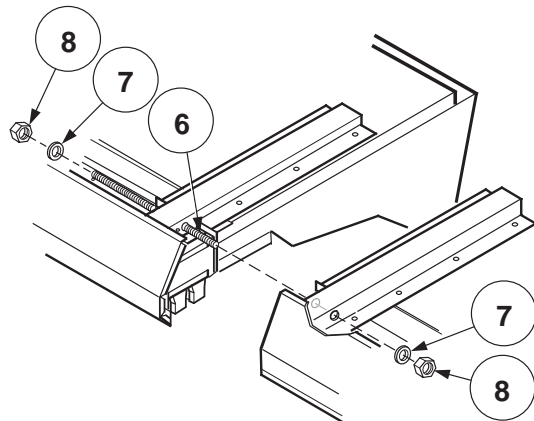
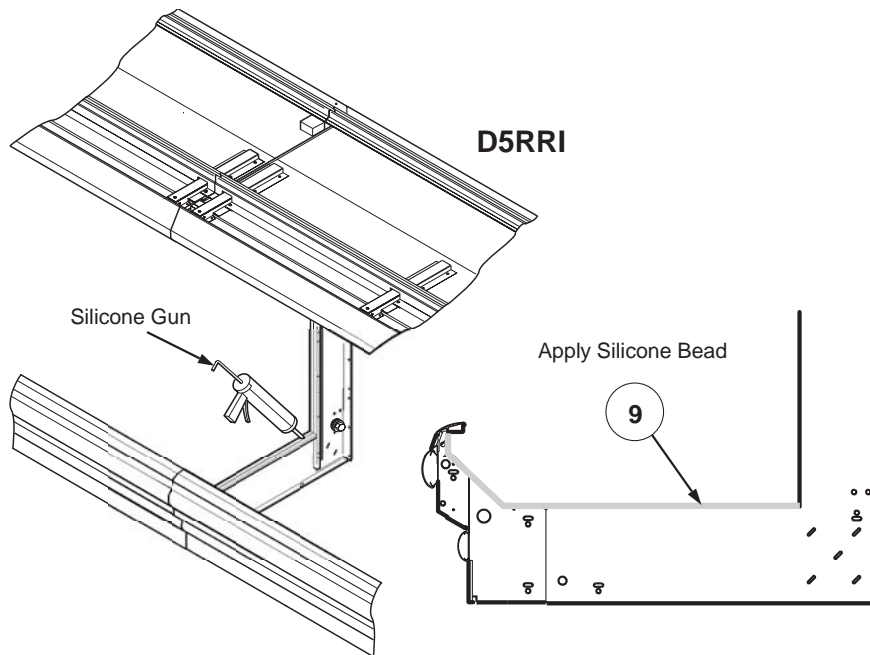

Figure 5. Canopy Joining

7 Draw canopies together using **Rod – 6** through top shoe, and **Washers – 7**, and **Nuts – 8** on each end of rod as illustrated in Figure 5. *Stop when canopies touch.*



8 Apply a bead of **Silicone – 9** to the joined merchandisers as shown in Figure 6. When dry, replace honeycomb.

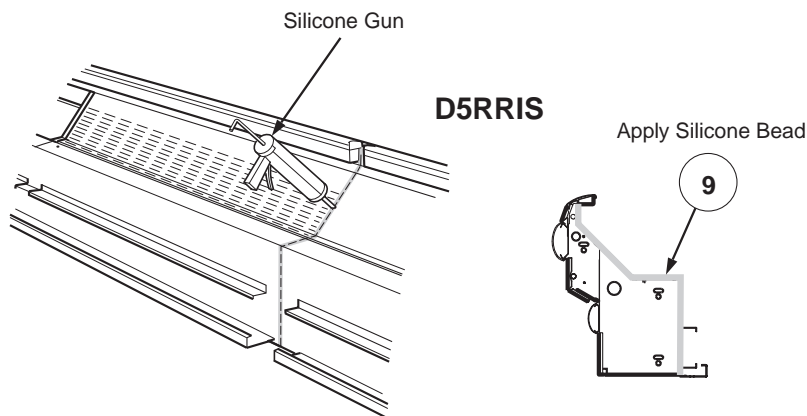

Figure 6. Applying Silicone