

Parts List

Item

Quantity

Description

**Revision A added
Table 1 on Page 6.**

	<i>Lit</i>				<i>Unlit</i>				
	48-in.		58-in.		48-in.		58-in.		
	8 ft	12 ft	8 ft	12 ft	8 ft	12 ft	8 ft	12 ft	
1.	1	1	—	—	—	—	—	—	Superstructure Assembly
	—	—	1	1	—	—	—	—	Superstructure Assembly
	—	—	—	—	1	1	—	—	Superstructure Assembly
	—	—	—	—	—	—	1	1	Superstructure Assembly
2.	16	24	16	24	16	24	16	24	Thread Cutting Flange Screw, 1/4 x 3/4
3.	2	2	2	2	2	2	2	2	Snap Bushing – 7/8 in.
4.	1	1	1	1	1	1	1	1	Vinyl Sleeve Tube – 1/2 in. ID – 80 In.
5.	2	3	2	3	2	3	2	3	Center Flue Superstructure Anti-sweat Heater
6.	1	1	1	1	1	1	1	1	Harness Assembly – White
7.	1	1	1	1	1	1	1	1	Harness Assembly – Purple
8.	1	1	1	1	1	1	1	1	Tag – Anti-sweat Heaters
9.	1	1	1	1	—	—	—	—	Tag – Shelf Light Harness
10.	4	6	4	6	4	6	4	6	Upright Insulation – Internal
11.	8	12	8	12	8	12	8	12	Upright Insulation – External
12.	2	3	2	3	2	3	2	3	Upright Insulation – Center
13.	2	3	2	3	2	3	2	3	Center Flue Heater Cover
14.	16	28	20	36	24	36	32	48	Screw – #8-18 x 3/8 – Truss Head SM
15.	2	4	2	4	4	6	4	6	Upright Cover
16.	2	2	2	2	2	2	2	2	End Upright Cover and Trim

This superstructure can be installed only on units ordered from the factory with superstructures. Such units have internal modifications to support the superstructure and facilitate correct routing of wiring harnesses. See Figure 1 and Figure 2.

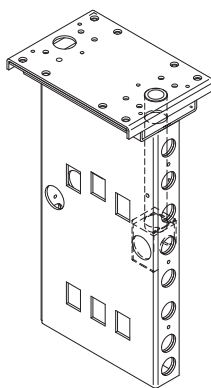

**Figure 1 — Center Flue
Internal Support for
Wide Island Superstructure**

This superstructure should be installed after the case is added to the lineup.

1. Carefully unpack and inspect the kit. Confirm that all parts listed above are included and not damaged.

**P/N 0484796_B
September 2009**



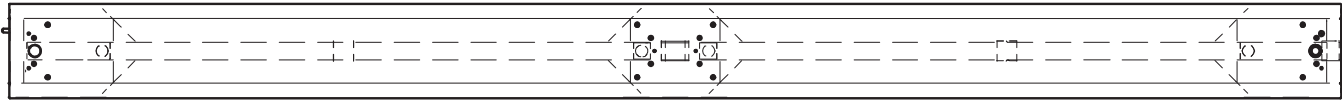

Top View of Center Flue Modified for Superstructure

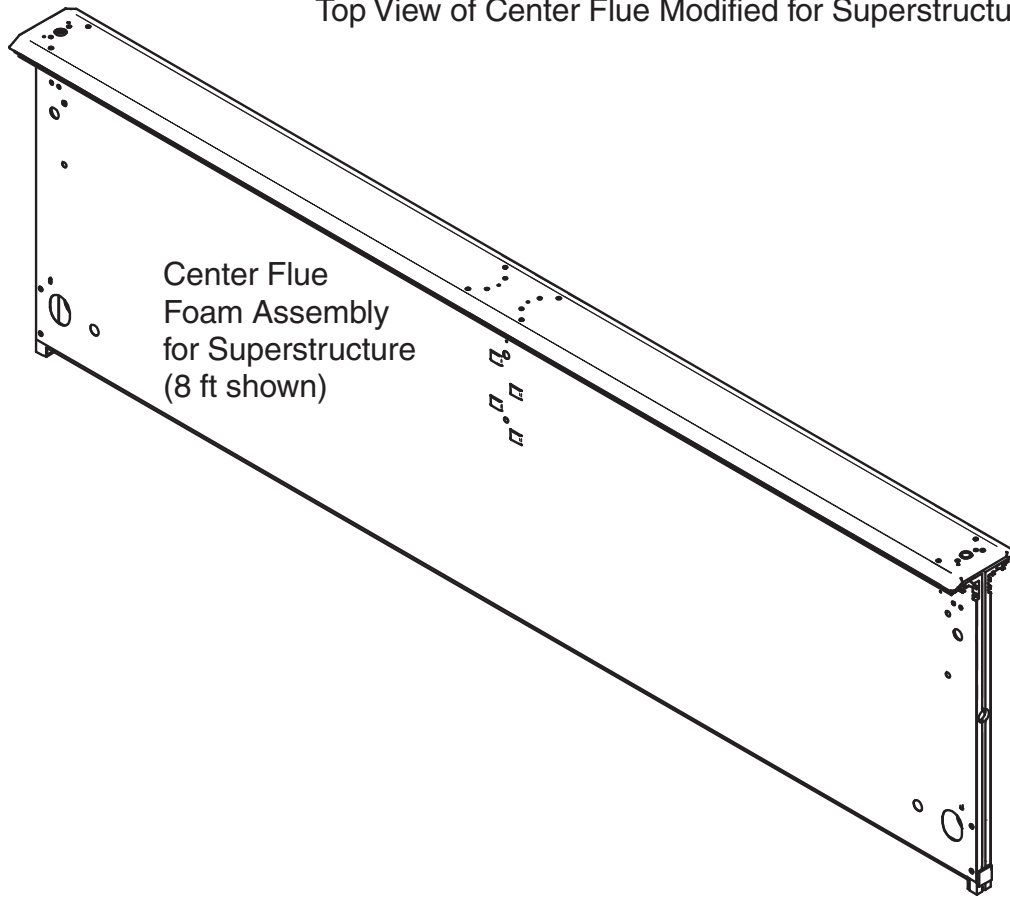

Figure 2 — Top and Side Views of Center Flue for Superstructure

Be sure case is level as described in
Section 1 of the installation manual.

2. Remove retainers and discharge air louvers as shown in Figure 3. They will be reinstalled once modification is complete.

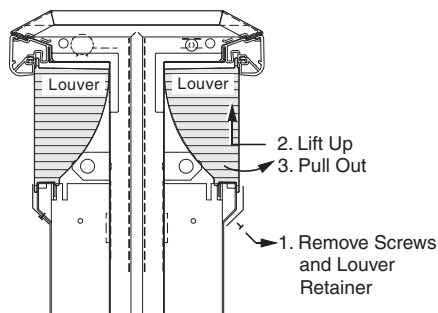

Figure 3 — Remove Louvers

3. On each side of wide island, remove
- Display racks and pans
 - Display rack supports
 - Interior back panels from center flue as shown in Figure 4.

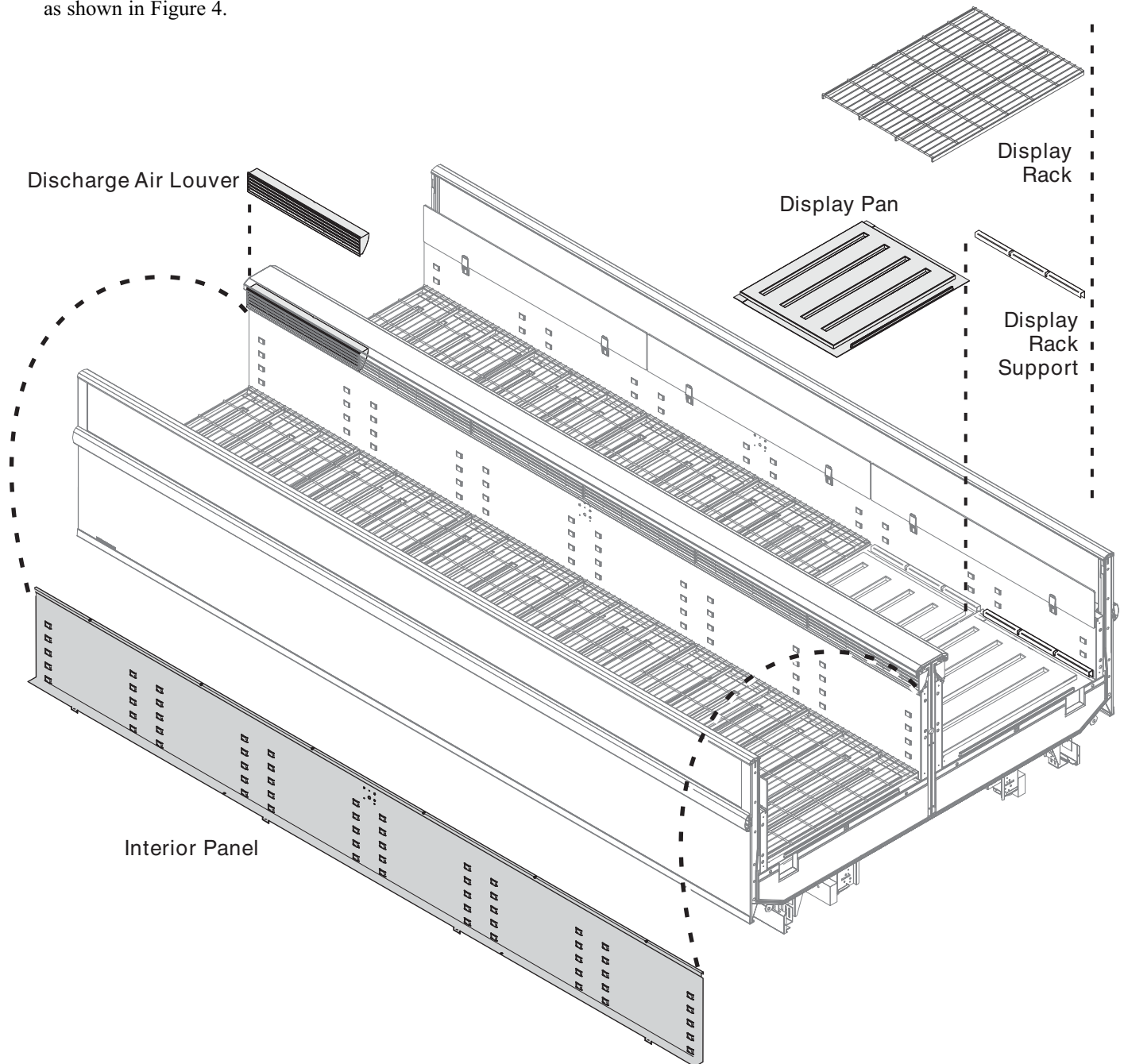

Figure 4 — Remove Racks, Pans & Panels

Requires at least two (2) people!

4. Position *Superstructure Assembly* on top of center flue as shown in Figure 5. Align outside edge of end uprights with ends of top panel. Use a level to ensure the uprights are plumb.

Fasten end uprights to top of center flue using *Thread Cutting Flange Screws* as shown in Figure 6.

Fasten center upright(s) using *Thread Cutting Flange Screws* as shown in Figure 7.

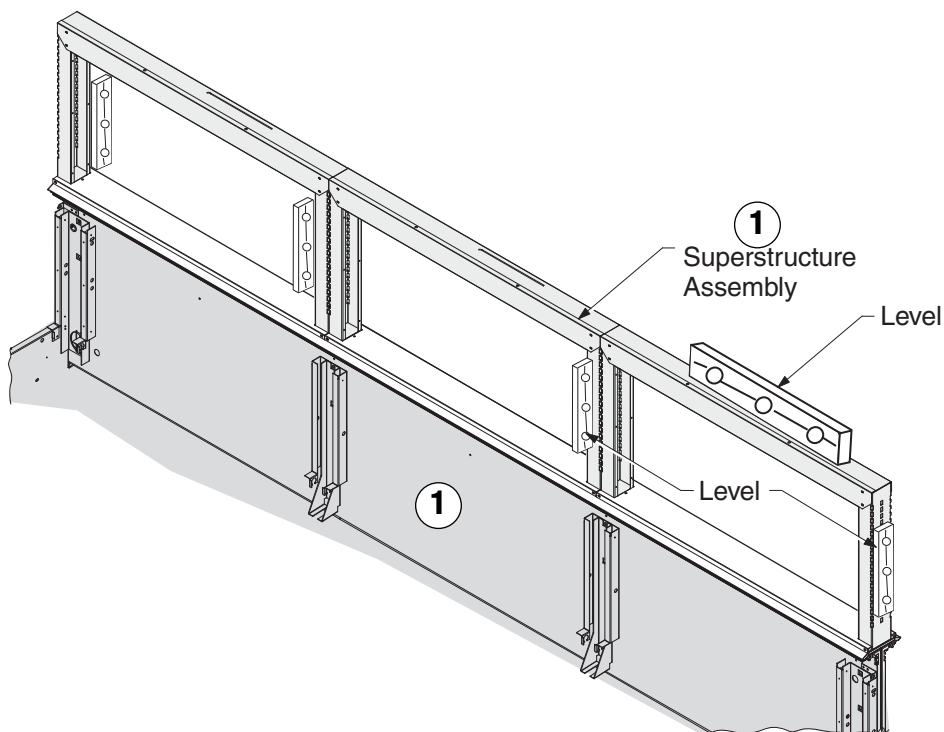

Figure 5 — Level Superstructure and Plumb Uprights

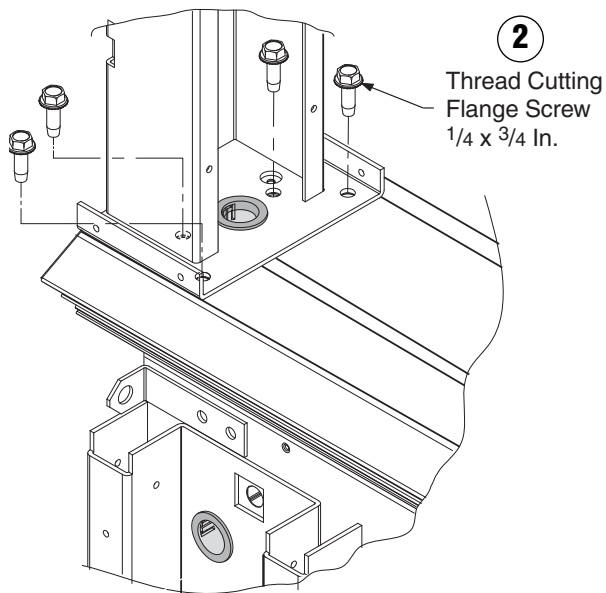

Figure 6 — Fasten End Uprights

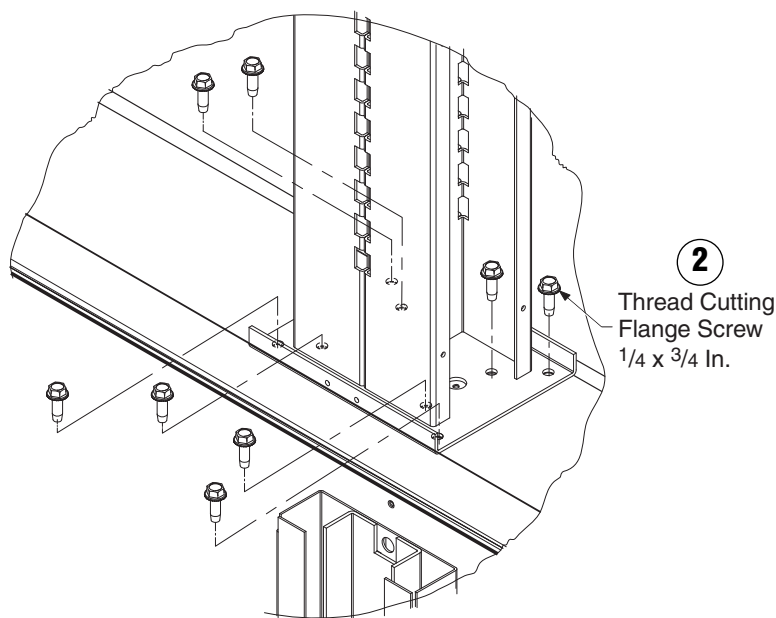

Figure 7 — Fasten Center Upright(s)

5. Insert *Snap Bushings* on left end at locations indicated in Figure 8.

Route anti-sweat harness *Vinyl Sleeve Tube* from hole inside LH upright through foam wireway to raceway at lower front of case.

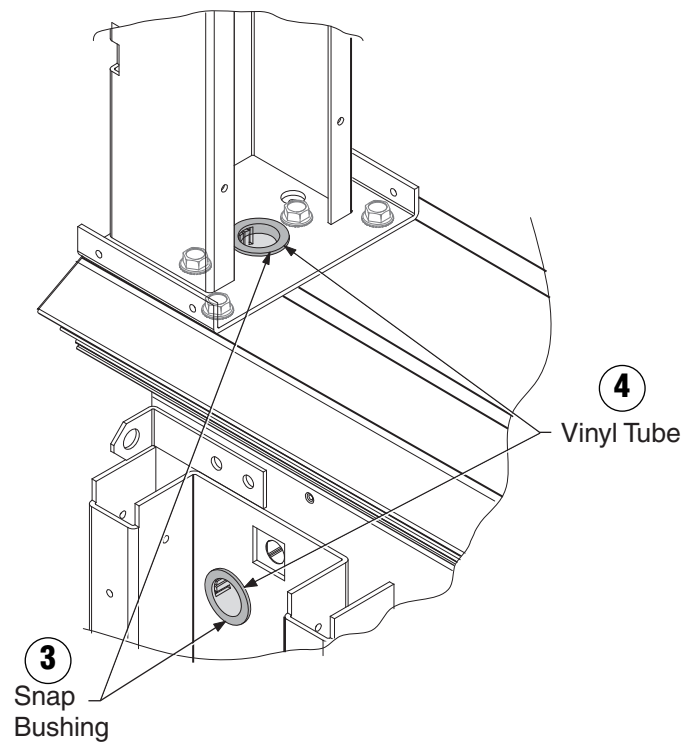

Figure 8 — Snap Bushings and Vinyl Sleeve Tube

6. Install *Anti-sweat Heaters* on top of center flue, between uprights, as shown in Figure 9. (**Note: for clarity, superstructure is not shown.**) Route all connectors toward left-hand end.

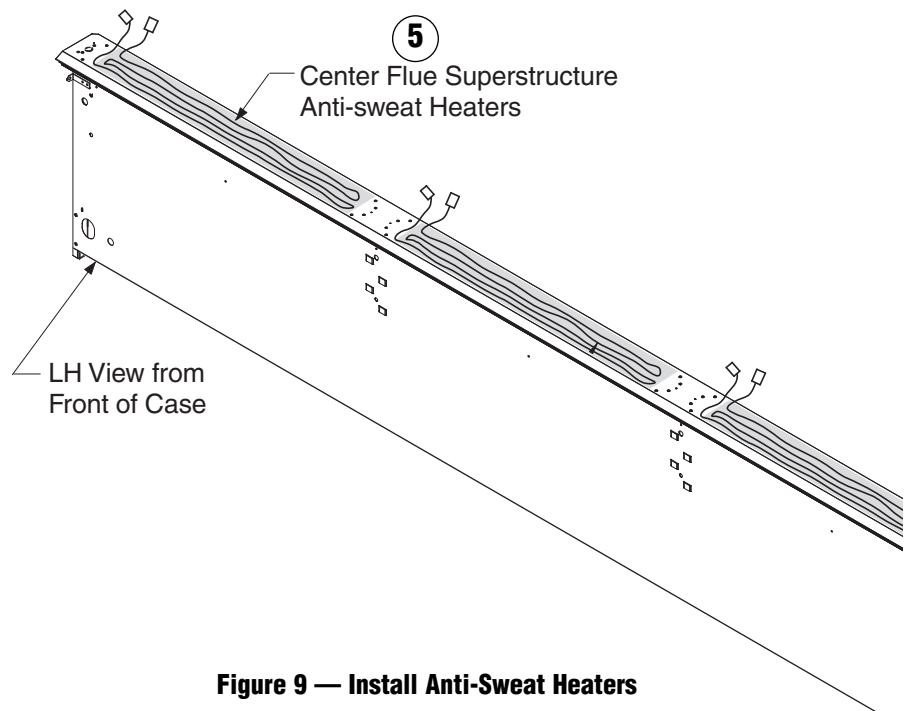

Figure 9 — Install Anti-Sweat Heaters

7. The wiring diagram for a 48-inch or 59-inch superstructure without lighted shelves is shown in Figure 10.

The wiring diagram for a 48-inch or 59-inch superstructure with lighted shelves is shown in Figure 11.

Amp draw per kit is given in Table 1.

Table 1 — Amp Draw per Kit		
<i>With Lights</i>	<i>Heaters</i>	<i>Ballast</i>
4FW48T8	0.54	1.02
6FW48T8	0.93	2.04
6FW58T8	0.93	2.04
8FW48T8	1.08	2.04
8FW58T8	1.08	2.04
12FW48T8	1.62	3.06
12FW58T8	1.62	3.06
JK38	—	0.51
JK39	—	0.51
<i>Without Lights</i>	<i>Heaters</i>	
8FW48	1.08	
8FW58	1.08	
12FW48	1.62	
12FW58	1.62	

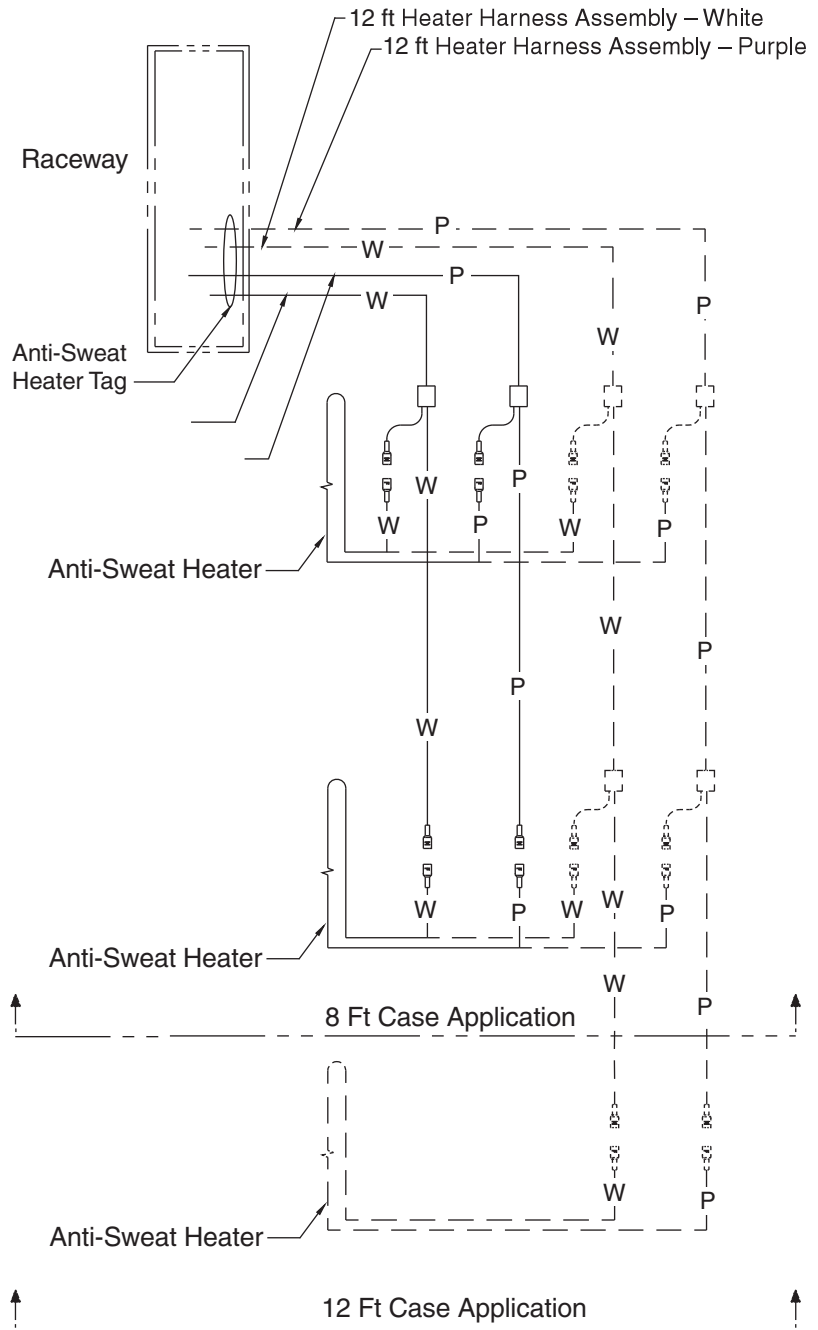

Solid line - 8 ft Case
Dash line - 12 ft Case

Wiring Color Code
P — Purple
W — White

Figure 10 — Wiring Diagram
Excel Low Temperature Wide Island with Unlit Shelves

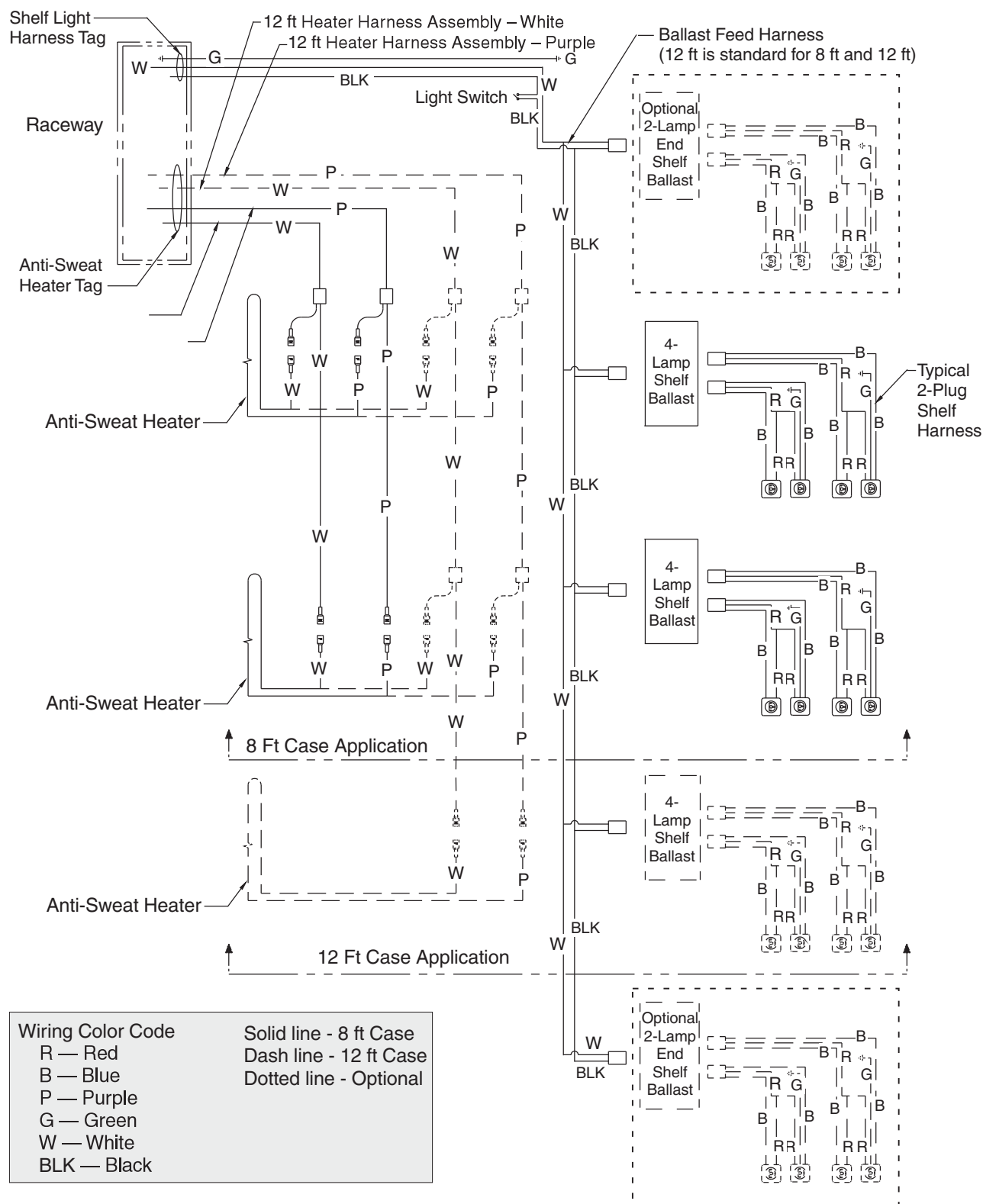

**Figure 11 — Wiring Diagram
Excel Low Temperature Wide Island with Lighted Shelves**

8. Remove factory-applied butyl and silicone sealants from electrical nipple at inside front of case shown in Figure 12.



Figure 12 — Remove Sealant

Following the wiring diagram, connect the *White and the Purple Anti-Sweat Heater Harnesses* to anti-sweat heaters.

Route the wires up through the superstructure to the **LH** end of the case. Run the wires in 1/2 inch vinyl sleeve **at LH end only**. Route wires to the raceway as shown in Figure 13, Figure 14 and Figure 15. Apply *Anti-Sweat Heater Tag* (Figure 16) in raceway.

If superstructure is lighted, run wires in 1/2 inch vinyl sleeve **at LH end only**. Route wires to raceway as shown in Figure 14 and Figure 15. Tag wires with *Shelf Light Harness Tag* (Figure 16) in raceway.

Seal inside electrical nipple with silicone as shown in Figure 17. Apply butyl to cover as shown in Figure 12.

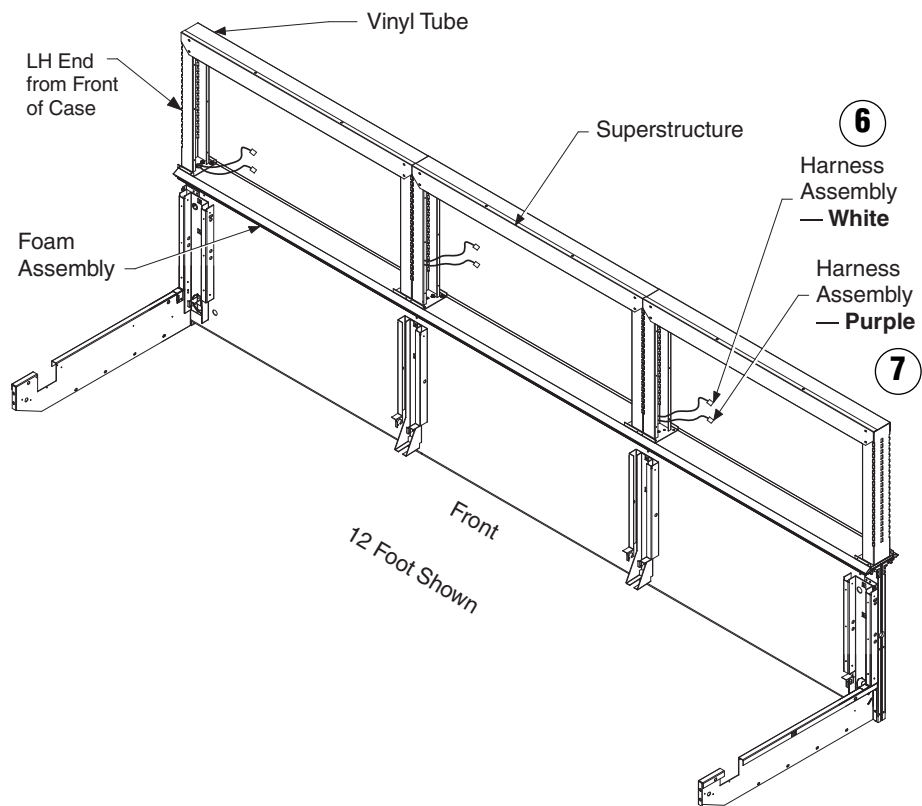

Figure 13 — Install Heater Harness

**Field-Installed, Lit or Unlit, 48-In. or 58-In.
Superstructure for *EXCEL* Wide Island**

P/N 0484796_B

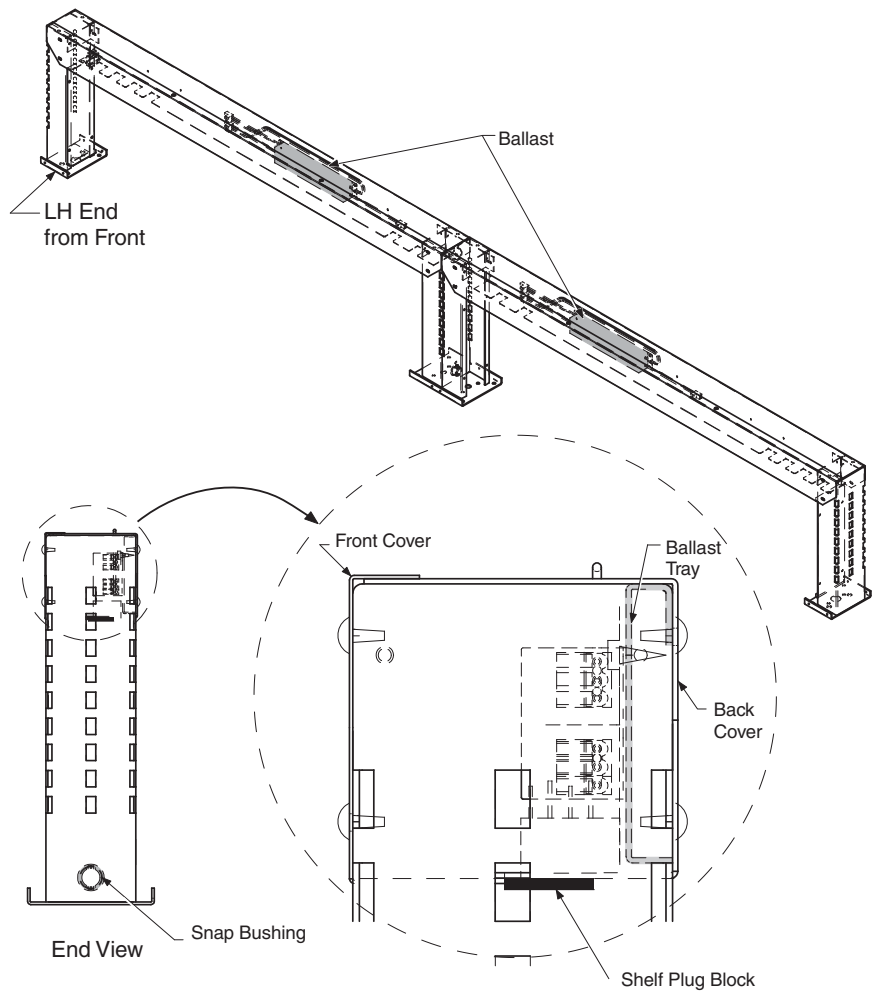

Figure 14 — Connect Lighting Harness

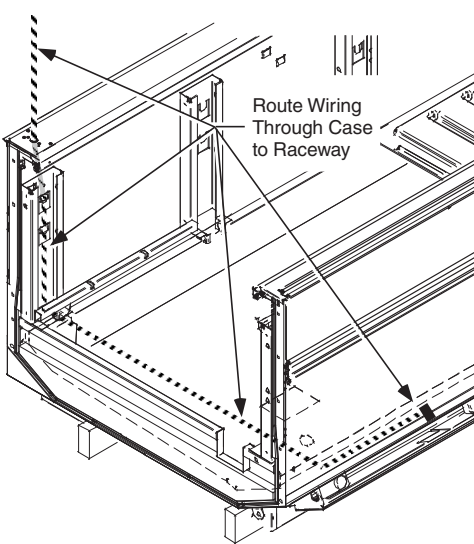

Figure 15 — Route Wiring Through Case



8



9

Figure 16 — Apply Tags in Raceway



Figure 17 — Seal Electrical Nipple

9. Install *External Insulation* and *Internal Insulation* in bottom of upright as shown in Figure 18.

Note: For clarity, the superstructure assembly is not shown.

Chamfer External Insulation as shown in Detail.

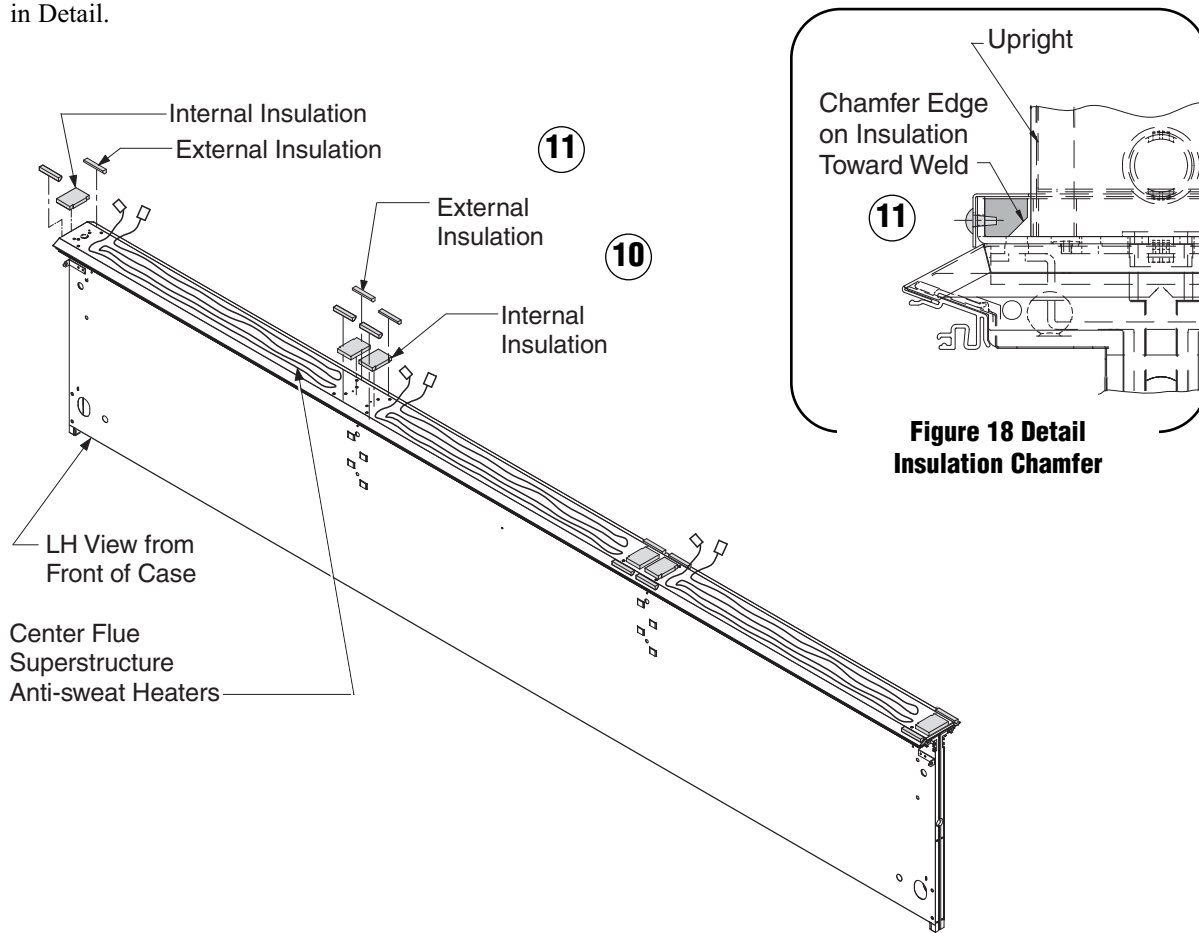

Figure 18 — Install External and Internal Insulation

10. Install *Center Insulation* and *Center Flue Heater Covers* as shown in Figure 19.

Note: For clarity, the superstructure assembly is not shown.

Fasten Center Flue Heater Covers with $\frac{3}{8}$ -inch #8-18 *Truss Head Sheetmetal Screws* as shown in Detail.

Install screws at each end of case in Step 12 with End Trim.

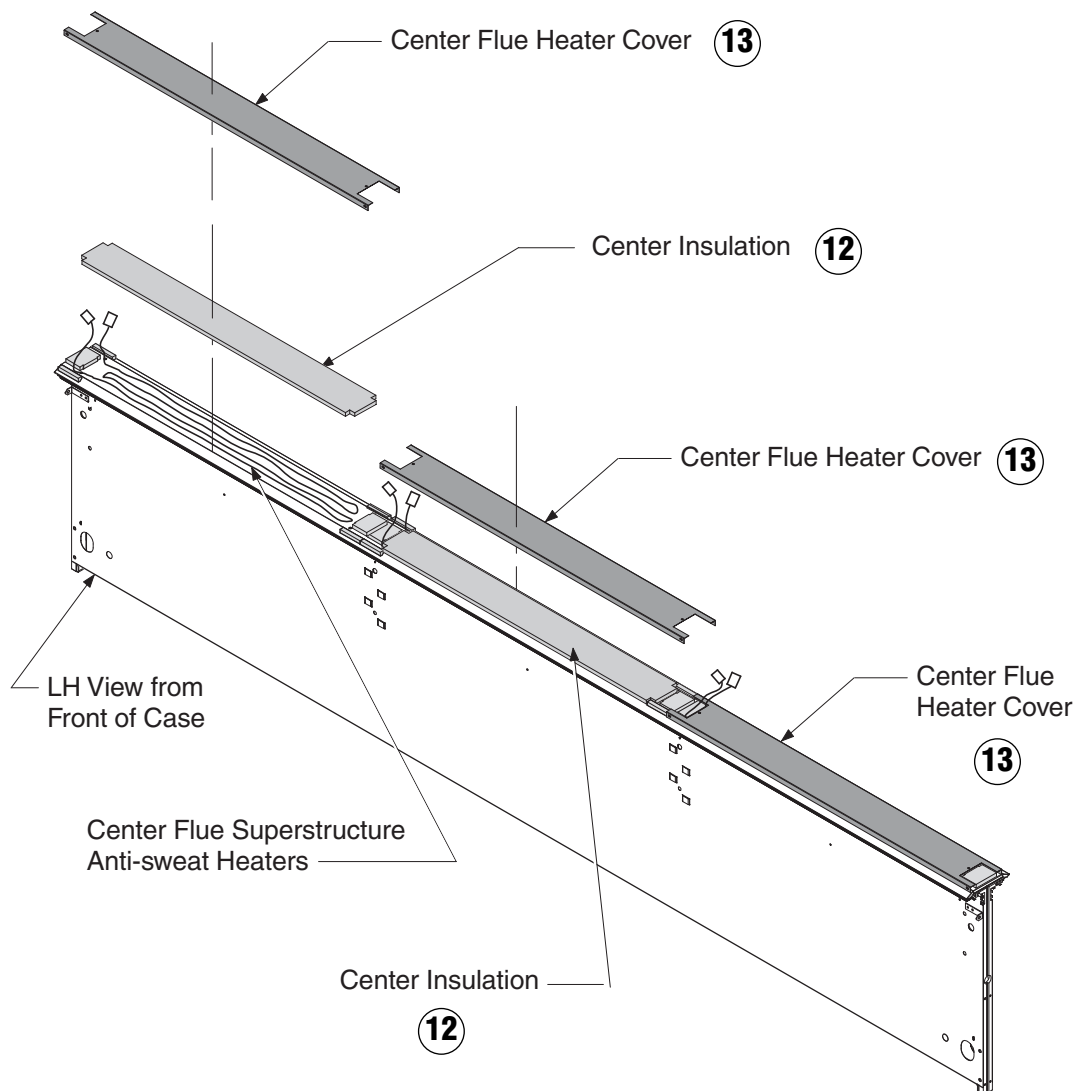
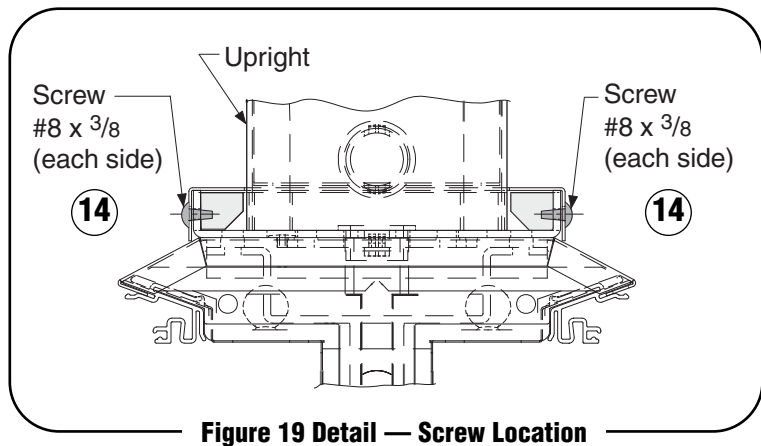

Figure 19 — Install Insulation and Heater Covers

11. Install an *Upright Cover* on each side of the superstructure uprights as shown in Figure 20. Fasten with $\frac{3}{8}$ -inch #8-18 *Truss Head Sheetmetal Screws*.

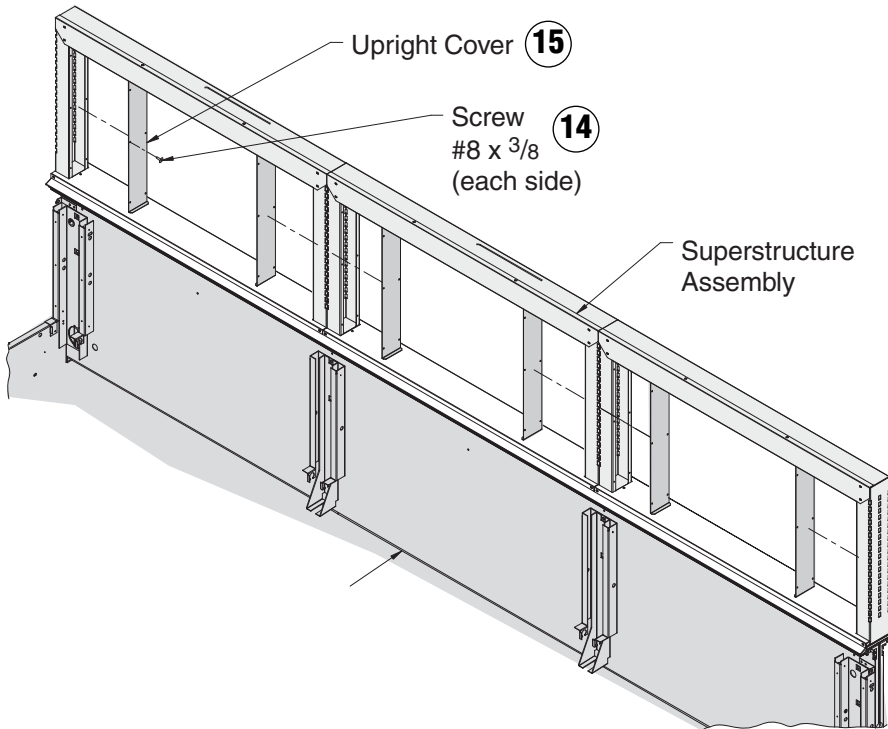

Figure 20 — Install Upright Covers

12. Install *End Upright Cover and Trim* over the ends of the Center Flue Heater Cover at end case or end of lineup as shown in Figure 21. Fasten with $\frac{3}{8}$ -inch #8-18 *Truss Head Sheetmetal Screws*.

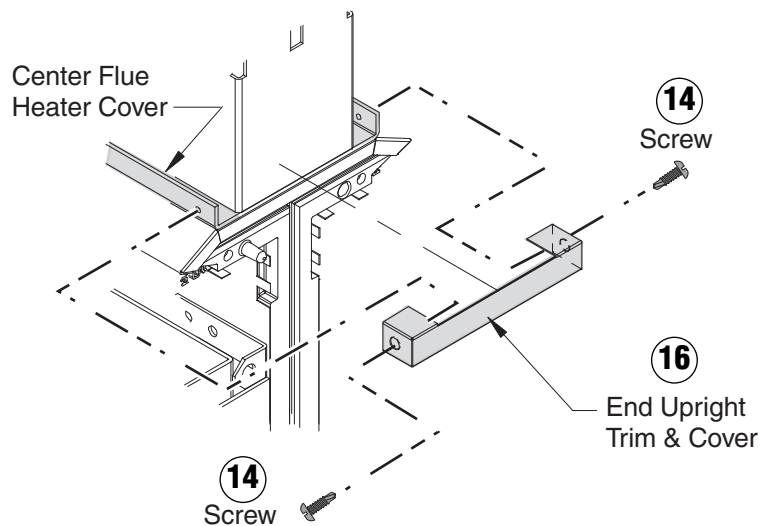

Figure 21 — Install Upright Covers