

Fresh Meat, Deli and Fish Merchandiser

## SOLID ENDS (ONLY)

### PARTS LIST

Item No.	Quantity	Description
1.	1	Gasket $\frac{1}{2}$ x $1\frac{1}{2}$ x 146
2.	1	Silicone
3.	1	Top Gasket Pad
4.	1	Solid End Assembly
5.	2	Spacers
6.	2	Cap Screw $\frac{5}{16}$ - 18 x $1\frac{1}{4}$
7.	3	Cap Screw $\frac{5}{16}$ - 18 x $2\frac{1}{2}$
8.	10	Flat Washer $\frac{5}{16}$
9.	5	Lock Washer $\frac{5}{16}$
10.	5	Hex Nut $\frac{5}{16}$ - 18
11.	2	Cap Plug
12.	5	Plug Button
13.	1	End Splashguard Retainer
14.	4	Hex Washer Head Screw #10 - 16 x $\frac{3}{4}$

**Level cases  
are critical  
for end  
installation  
and glass  
alignment!**

**NOTE:** Make sure merchandisers have been leveled according to the installation instructions. Carefully unpack and inspect the End Kit, making sure there is no breakage or damage.

### ALL ENDS:

Follow **Steps 1-6** (pages 2 - 5) of this instruction before going to **Step 7 — Solid Ends (Page 6)** or **Step 7a — Plastic Ends with Glass Insert (Page 10)**.

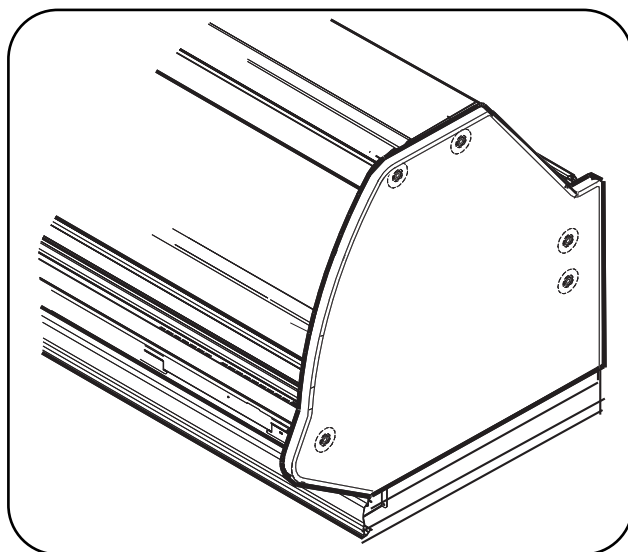

## REMOVING ITEMS FROM THE MERCHANDISER

- 1** Remove items below:
- A. Shelves if installed,
  - B. Display Pans,
  - C. Rear Pan Bracket,
  - D. Rear Panel and Discharge Grille
  - E. Front Return Air Grille
- from merchandiser.  
See Figure 1.

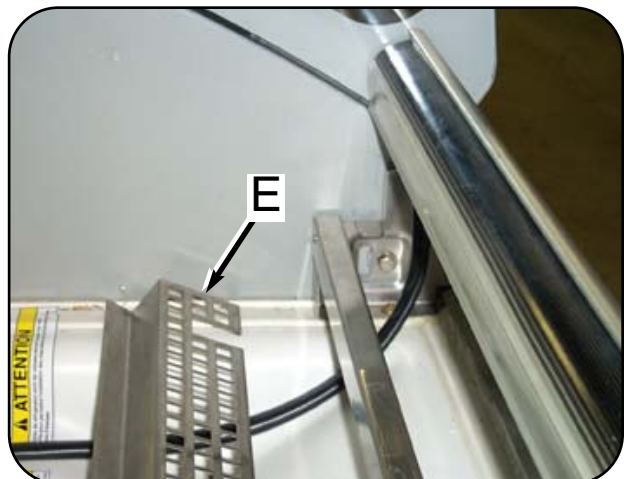
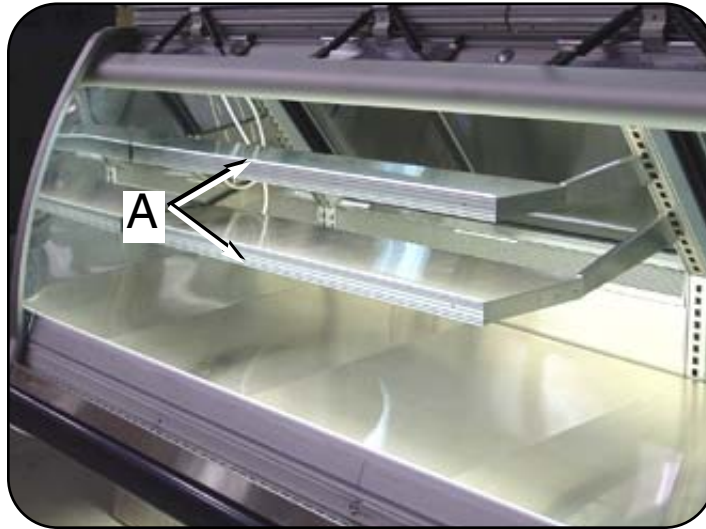

**Figure 1.** Removing Items from the Merchandiser

## GASKETING AND SEALING PROCEDURE

**2** Apply 1 1/2 in. (38 mm) **Gasket (Item – 1)** to rear foam panel as shown. See **Figure 2. Detail A.**

- Do not stretch gasket

- Remove paper backing after gasket has been applied.

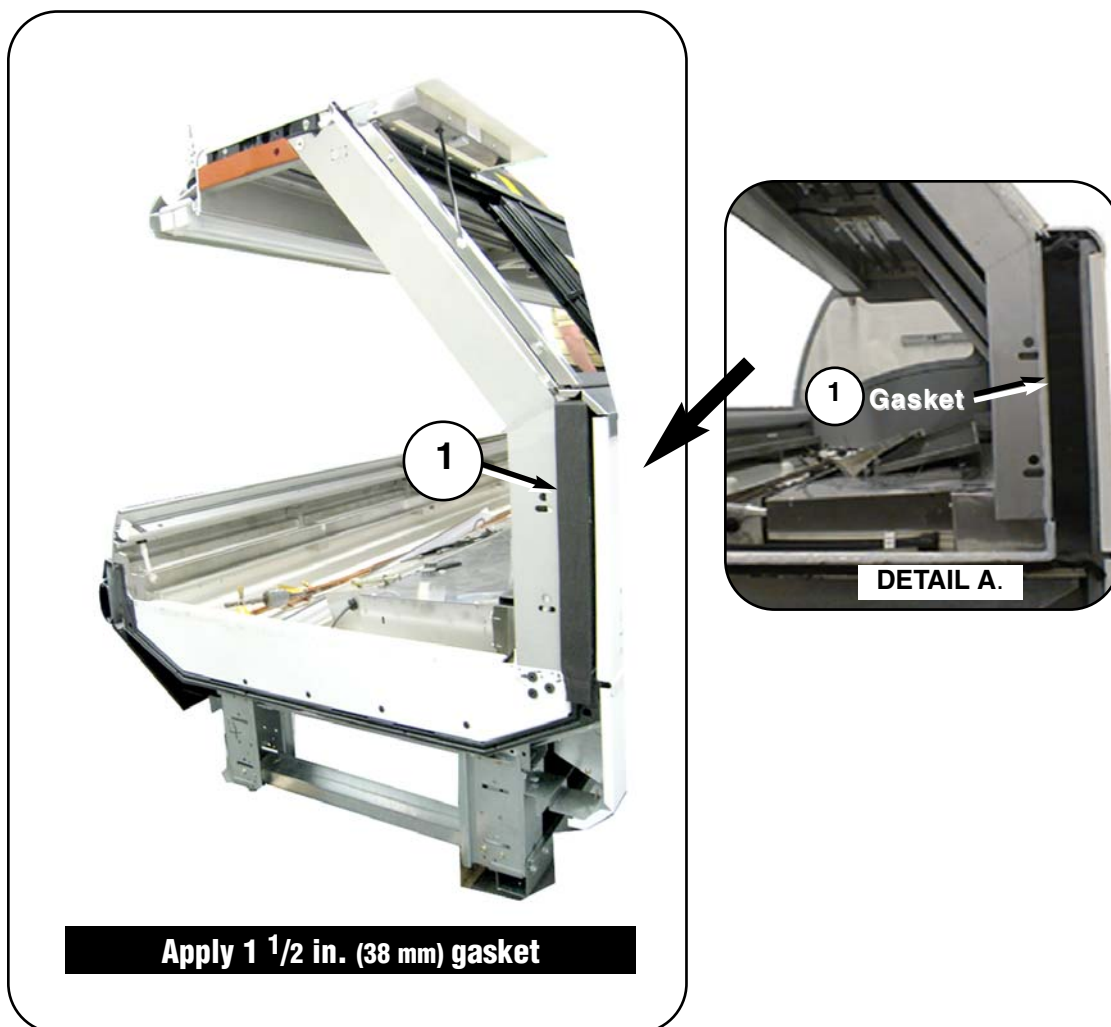

**Figure 2.** Applying 1 1/2 in. Gasket to the Merchandiser

**3** Before installing end, make sure to apply a 1/2 inch bead of clear **Silicone (Item- 2)** along the entire perimeter of the case as shown in **Figure 3**.

**4** In addition, apply silicone around the perimeter of the front joining hole and over the top of the frame. See **Figure 3**, **Details B and C**.

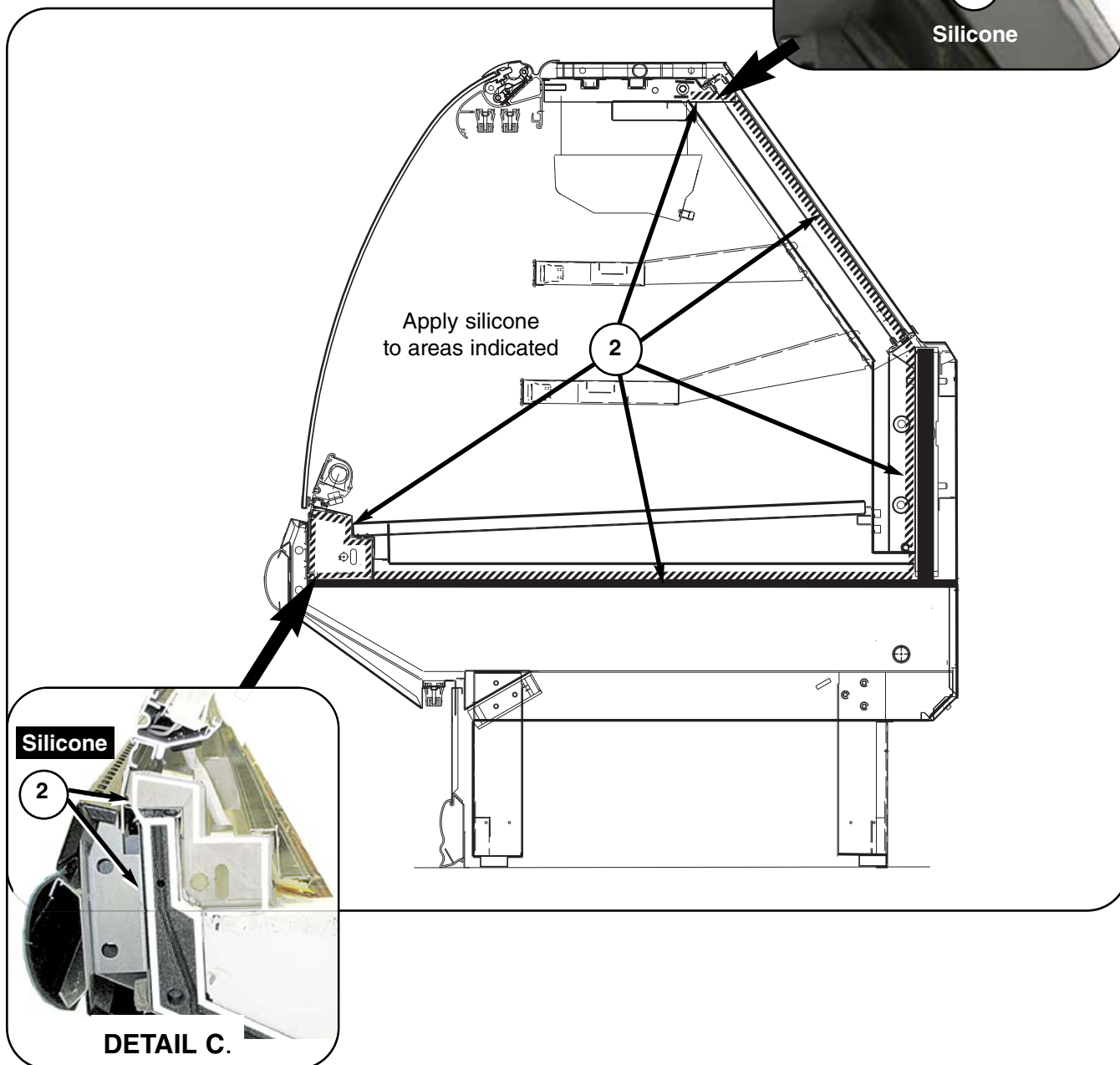

**Figure 3.** Applying Silicone

**5** Install the **Top Gasket Pad** (Item – 3) See Figure 4, Detail D.

**6** Apply **Silicone** (Item – 2) onto the top face of the **Top Gasket Pad** (Item – 3). See Figure 4, Details D, E and F.

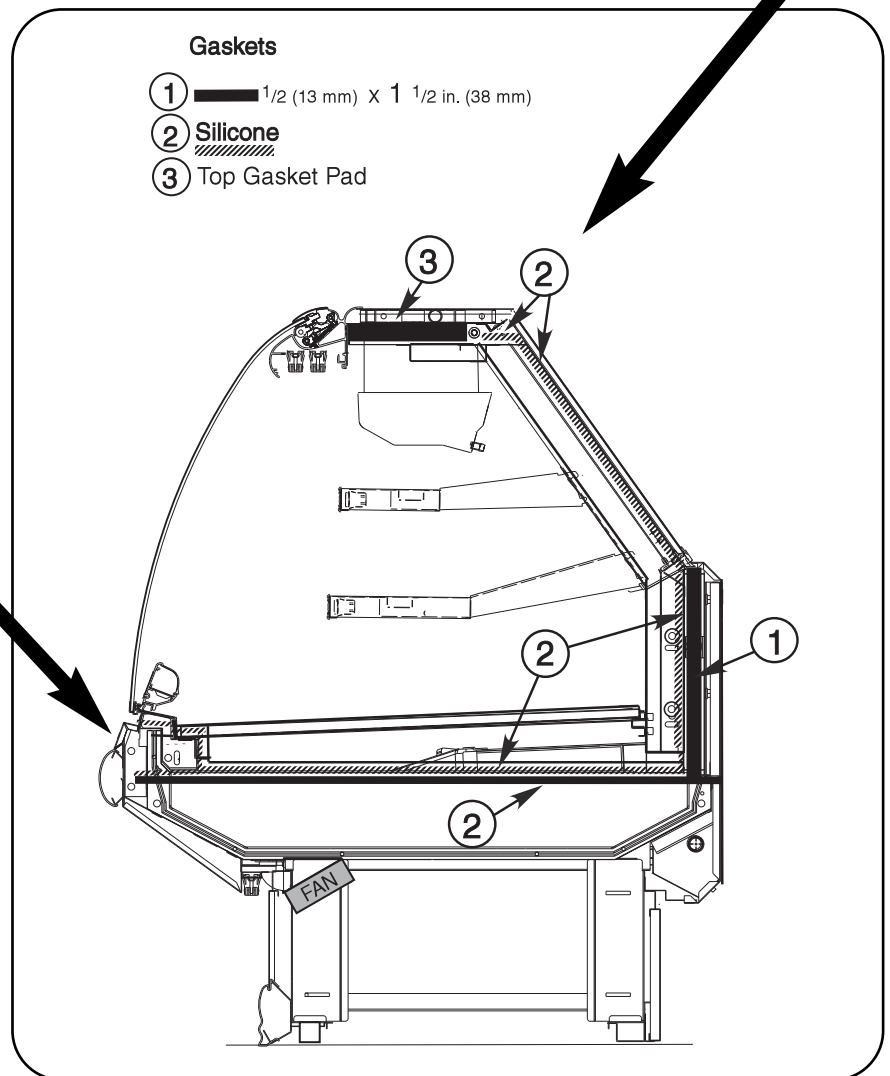
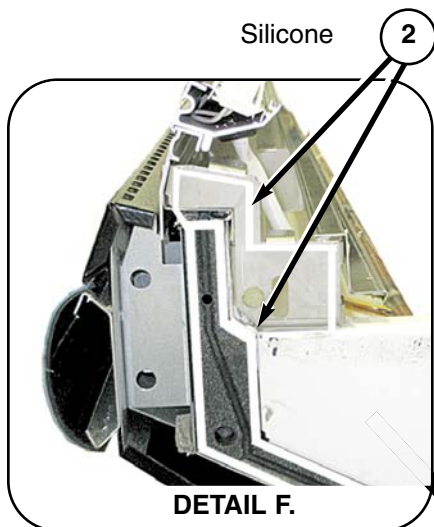
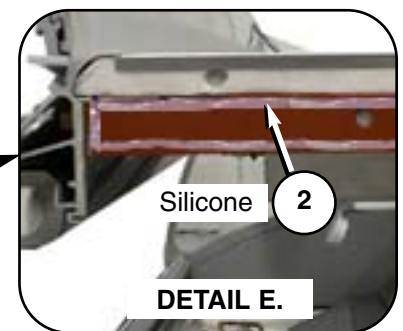
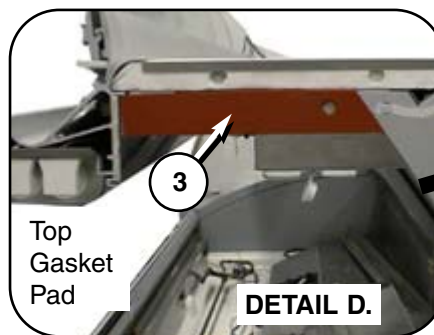
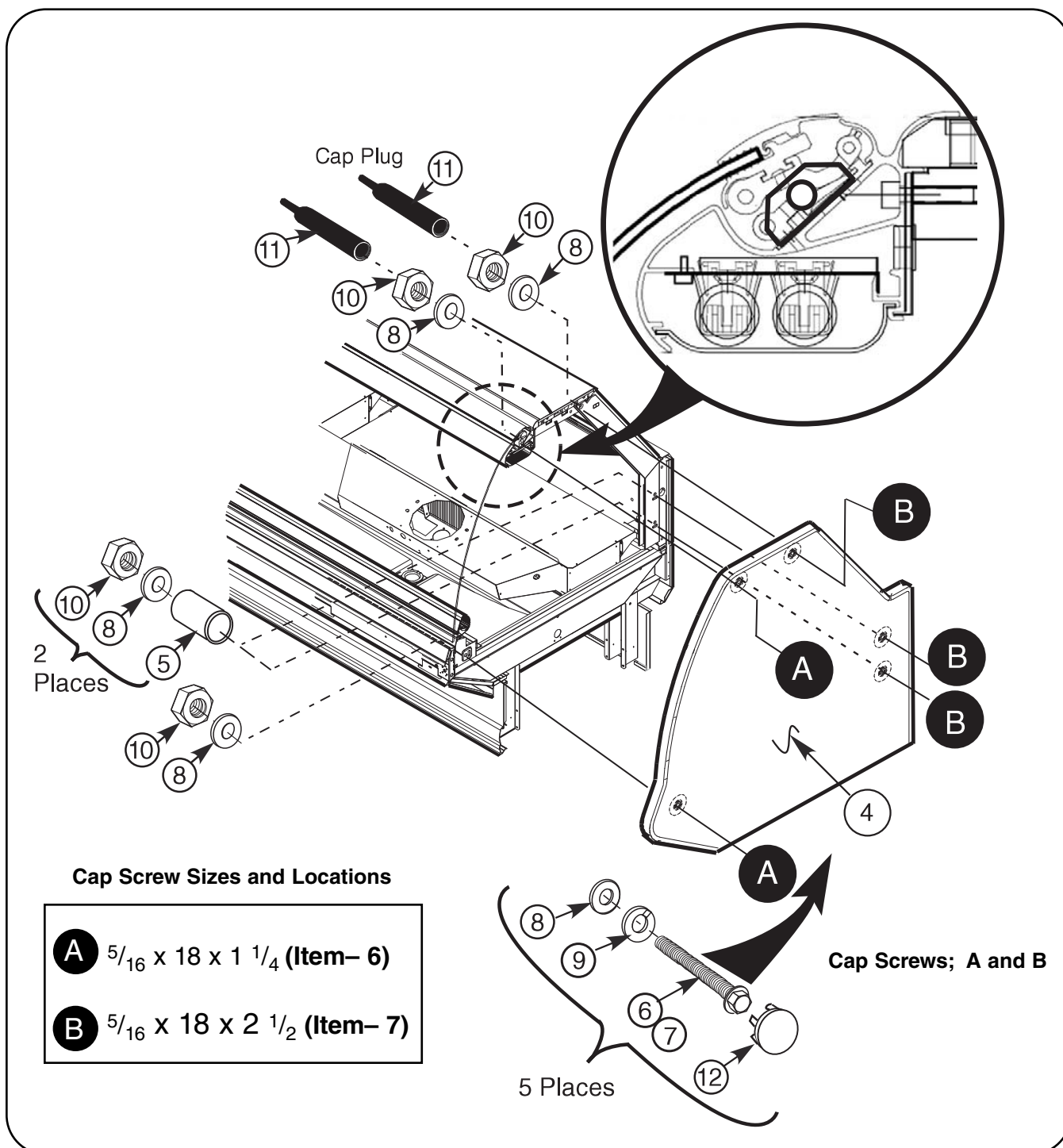

**Figure 4.** Applying Top Gasket Pad

**7** Place and fasten the **Solid End Assembly (Item – 4)** using **Spacers (Item – 5)**, **Cap Screws (Items – 6 & 7)**,

**Flat Washers (Item – 8)**,  
**Lock Washers (Item – 9)**  
**Hex Nut (Item – 10)**

**Cap Plug (Item – 11)** and  
**Plug Button (Item – 12)**.  
See Figure 5.



**Figure 5. Fastening End Assembly**

## SEALING THE INTERIOR BOTTOM OF THE CASES

- 8** Apply a continuous bead of **Silicone (Item – 2)** to the joint. Smooth and even out silicone so that there are no gaps or ridges in the case joint.

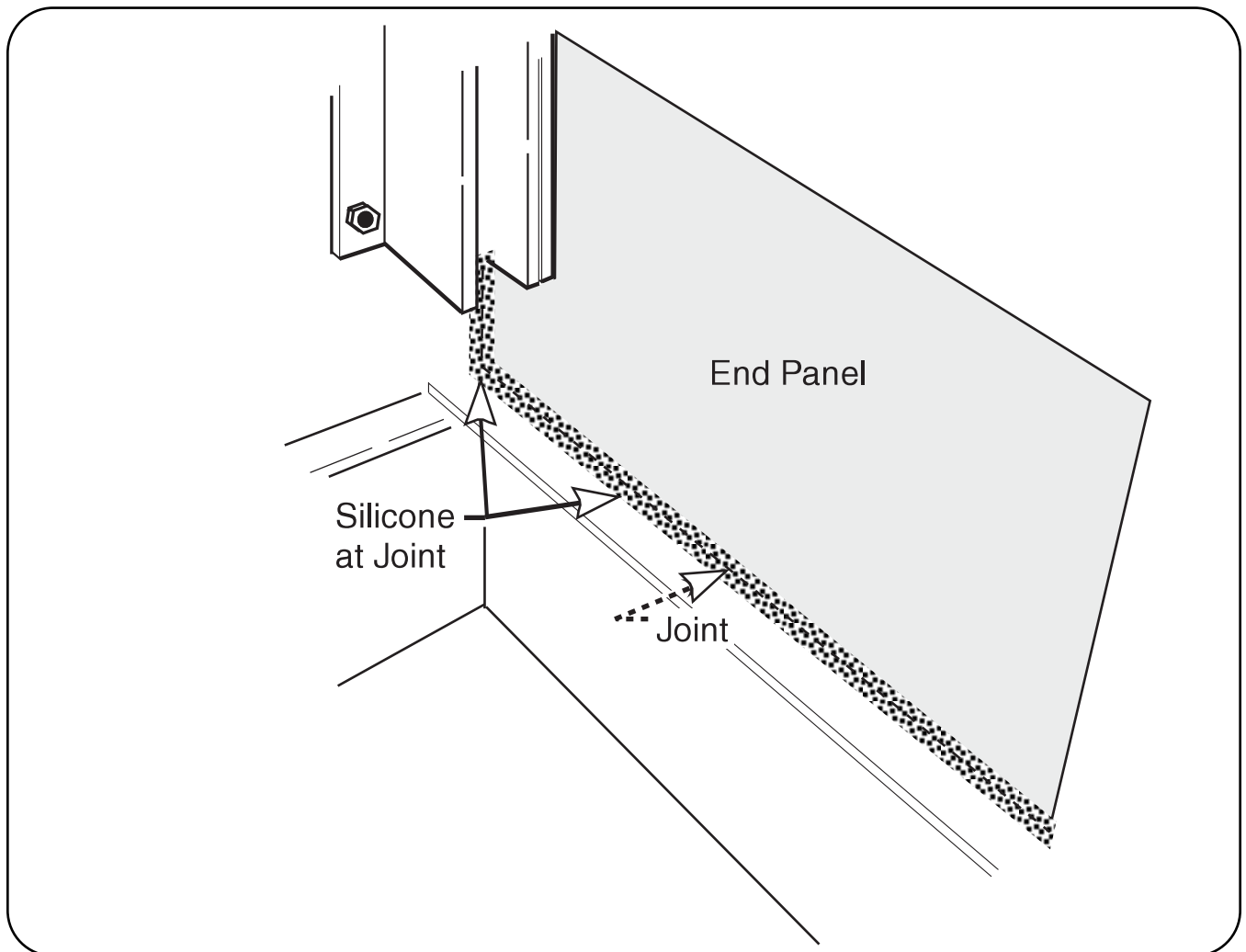
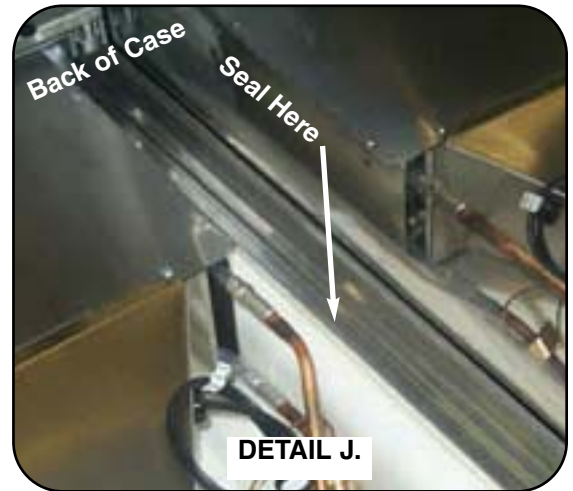

**Figure 6.** Sealing the End

## INSTALLING SPLASHGUARD ASSEMBLY

- 9** Attach **Splashguard Retainers** (Item – 13) to the side of front and back legs as shown using **Screws** (Item – 14). Push the lower edge of the splashguard toward the bottom of the bracket until it snaps into place. See **Figure 7** and **Detail G**.

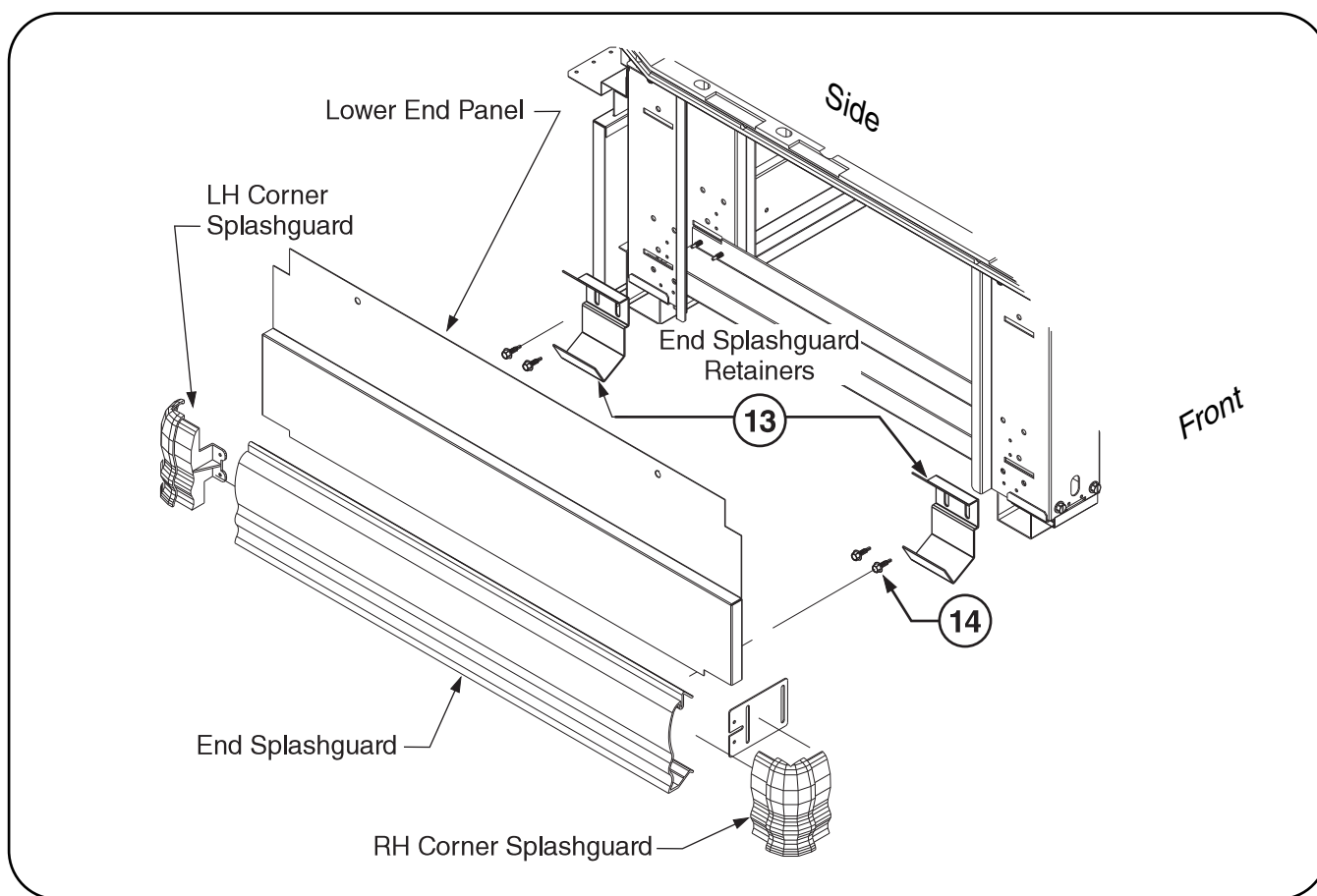
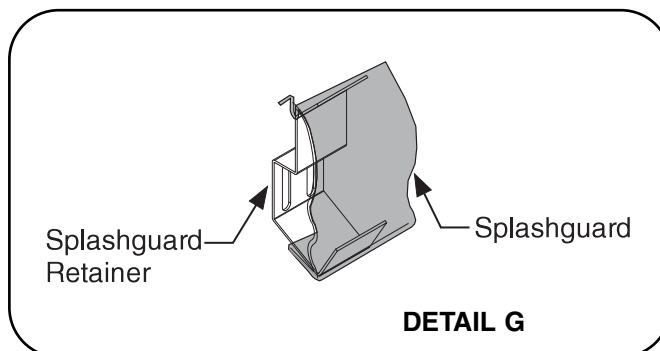

**Figure 7.** Installing Splashguard Assembly

## PLASTIC WITH GLASS ENDS (ONLY)

### PARTS LIST

Item No.	Quantity	Description
1	1	Gasket 1/2 x 1 1/2 x 146
2	1	Silicone
3	1	Top Gasket Pad
4	1	Plastic Glass End Assembly
5	1	Glass
6	2	Spacers
7	1	Cap Screw 1/4 - 20 x 3/4
8	1	Cap Screw 1/4 x 20 x 1
9	3	Cap Screw 1/4 x 20 x 2
10	10	Flat Washer 1/4
11	3	Lock Washer 1/4
12	2	Hex Nut 1/4
13	2	Plug Button
14	2	Cap Plug
15	1	End Splashguard Retainer
16	4	Hex Washer Head Screw #10 - 16 x 3/4
17	1	End Bumper Retainer
18	2	Truss Head Sheet Metal Screw #10 - 24 x 3/8
19	1	Wrap-around End Bumper

**Level cases  
are critical  
for end  
installation  
and glass  
alignment!**

Follow **Steps 1-6** in the *Solid End* section of this instruction before going on to Step 7a:

REMOVING ITEMS FROM THE CASE.

GASKETING AND SEALING PROCEDURE.



# ATTACHING THE PLASTIC END WITH GLASS TO THE CASE

**7a** Place and fasten the **Plastic End Assembly (Item – 4)** using **Spacers (Item – 6)**, **Cap Screws (Items – 7, 8 and 9)**, **Flat Washers (Item – 10)**,

**Lock Washers (Item – 11)**, **Hex Nut (Item – 12)**, **Plug Button (Item – 13)** and **Cap Plug (Item – 14)**. See Figure 5a.

Place **Glass (Item – 5)** over rubber spacers in groove on plastic end. Fasten with screws provided as shown in **Figure 5a Detail**.

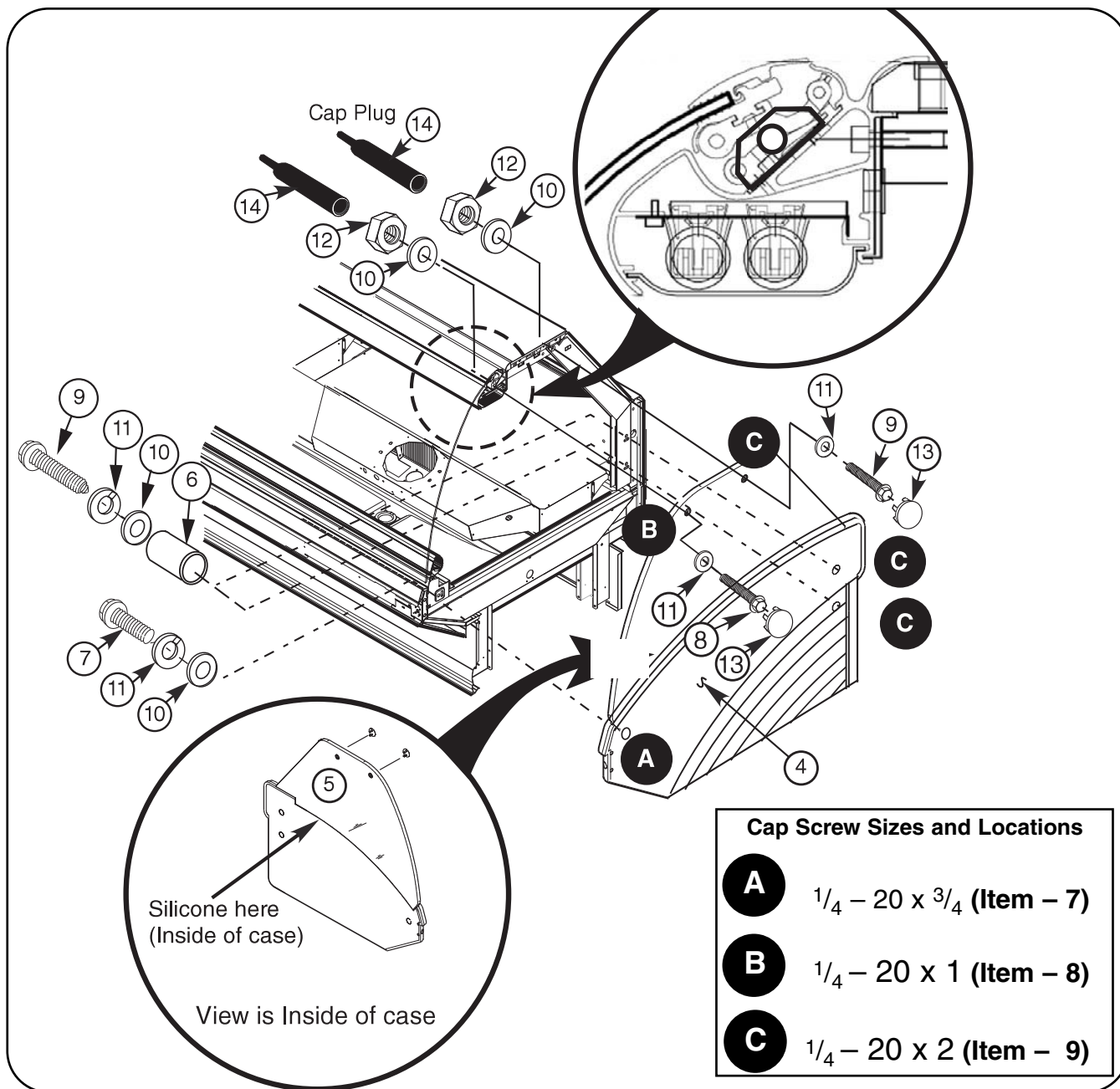

**Figure 5a.** Installing the Plastic End, and Glass to the Case

## INSTALLING AND SEALING INTERIOR END PANEL

- 8a** Apply a continuous bead of **Silicone (Item – 2)** to the joint. Smooth and even out silicone so that there are no gaps or ridges in the case joint.

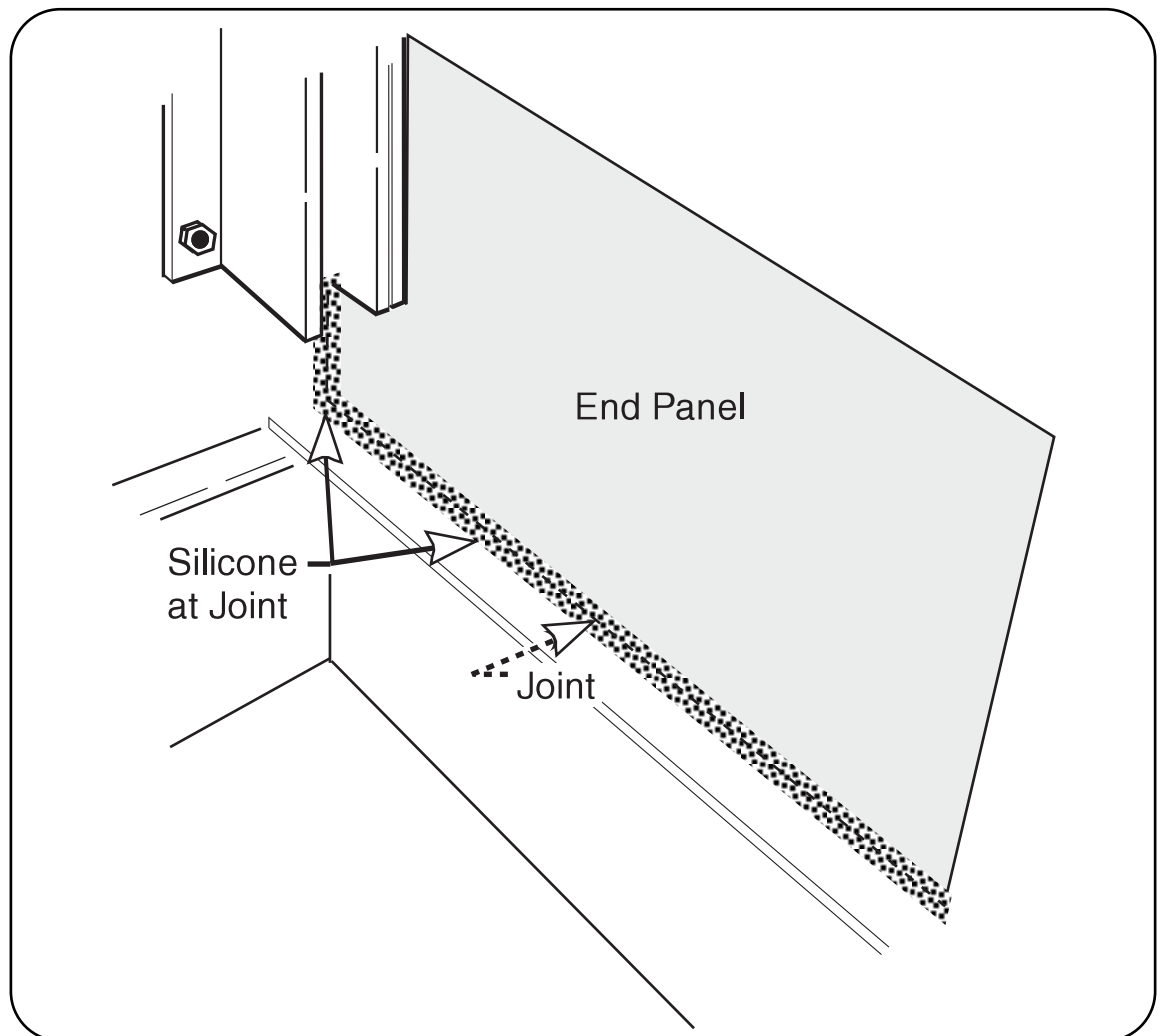

**Figure 6a.** Sealing the End

## INSTALLING SPLASHGUARD AND LOWER END PANEL

**9a** Attach the **End Splashguard Retainers (Item – 15)** to the side of front and back legs as shown using **Screws (Item – 16)**. Push the lower edge of the splashguard toward the bottom of the bracket until it snaps into place.

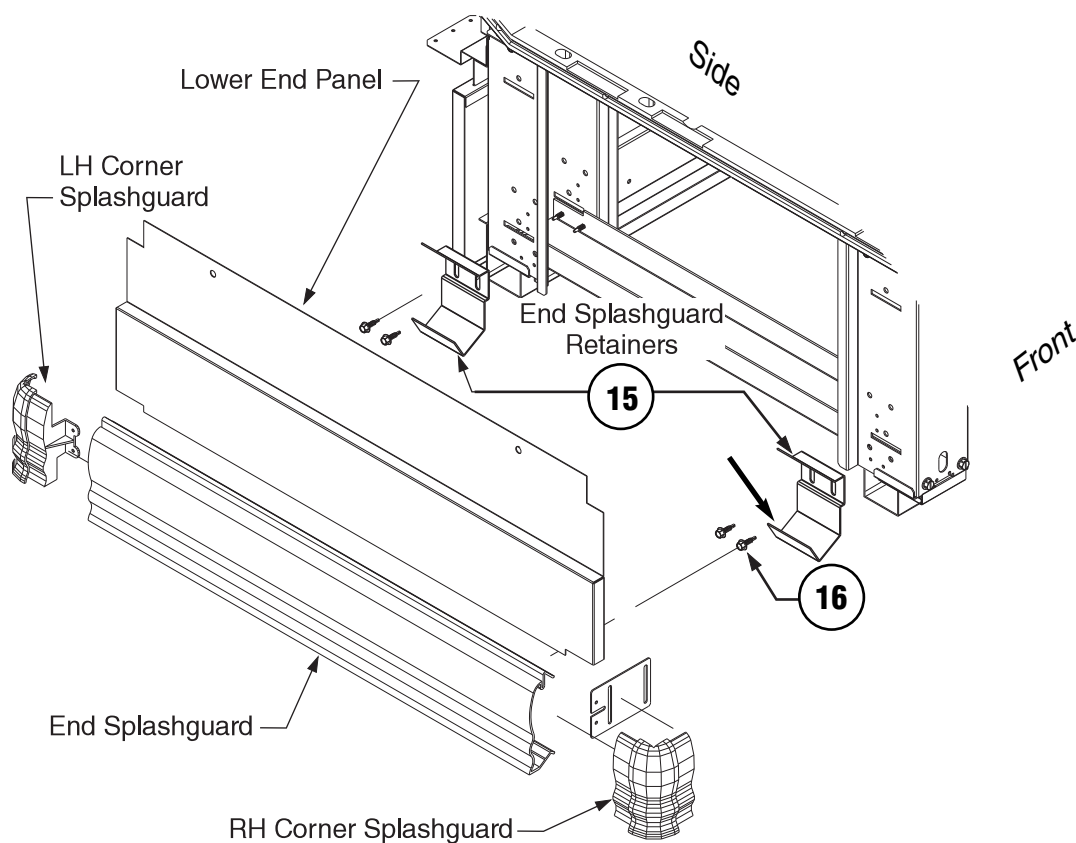
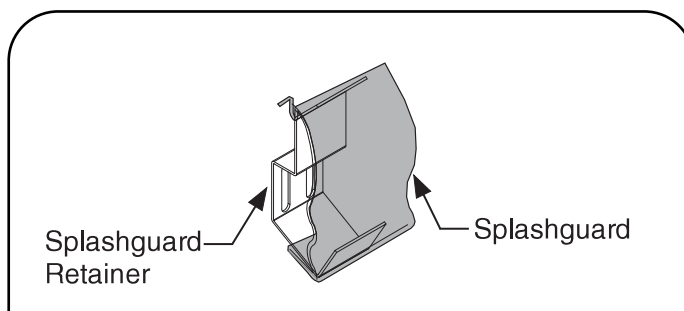

**Figure 7a.** Installing Splashguard and Lower End Panel

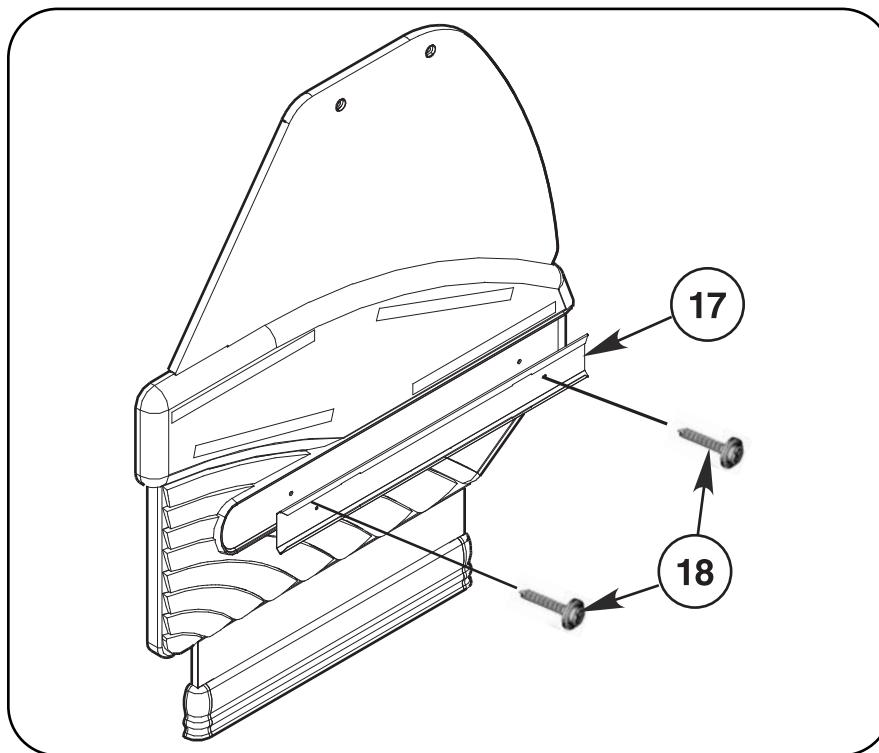

**Figure 8a.** Installing Bumper Retainer

## INSTALLING BUMPER RETAINER AND BUMPER

**10a** Fasten End Bumper Retainer (Item – 17 ) to the end with Screws (Item – 18). See Figure 8a.

### **NOTICE**

Do not over tighten screws as this may cause inserts to come loose.

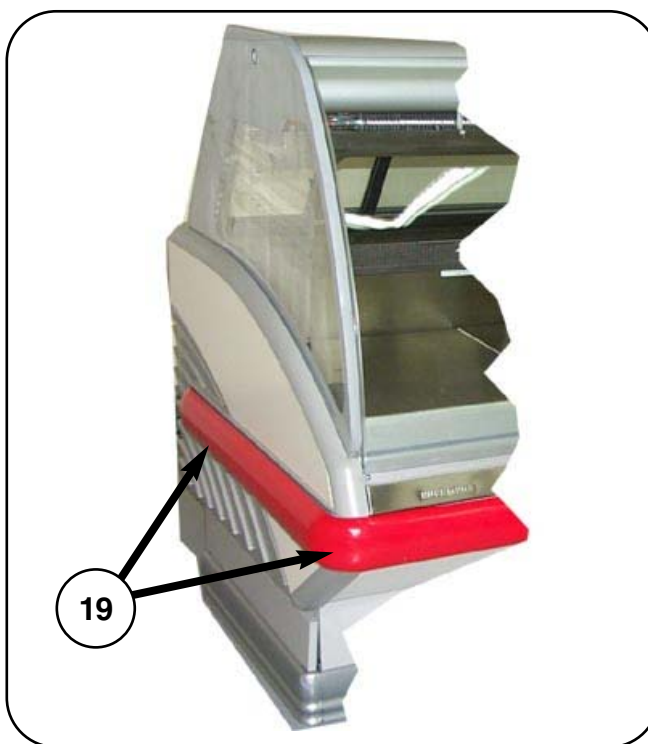

**Figure 9a.** Installing Corner Bumper

**11a** Snap Wrap around Corner Bumper (Item – 19 ) on to end and front of case. See Figure 9a.

**12a** Re-install in reverse order, all items that were removed in Step 1.