

Fresh Meat, Deli and Fish Merchandiser

## PARTS LIST

Item No.	Quantity	Description	
1.	3	Alignment Pin	
2.	1	Gasket $\frac{1}{2}$ x $1\frac{5}{8}$ x 146	
3.	1	Silicone	
4.	1	Top Gasket Pad	
5.	1	Cap Screw $\frac{5}{16}$ - 18 x $1\frac{1}{4}$	
6.	2	Flat Washer $\frac{5}{16}$	Front
7.	1	Lock Washer $\frac{5}{16}$	
8.	1	Hex Nut $\frac{5}{16}$ - 18	
9.	4	Spacer	
10.	2	Cap Screw $\frac{5}{16}$ - 18 x $3\frac{1}{2}$	Rear
11.	4	Flat Washer $\frac{5}{16}$	
12.	2	Lock Washer $\frac{5}{16}$	
13.	2	Hex Nut $\frac{5}{16}$ - 18	
14.	1	Cap Screw $\frac{5}{16}$ - 18 x 3	
15.	2	Flat Washer $\frac{5}{16}$	Top
16.	1	Lock Washer $\frac{5}{16}$	
17.	1	Hex Nut $\frac{5}{16}$ - 18	
18.	4	Cap Plug	
19.	1	Interior Trim	
20.	1	Exterior Trim	
21.	1	Splashguard Joint Trim	
22.	1	Splashguard Retainers	
22.	4	Hex Head Sheet metal Screw #8 x $\frac{1}{2}$	

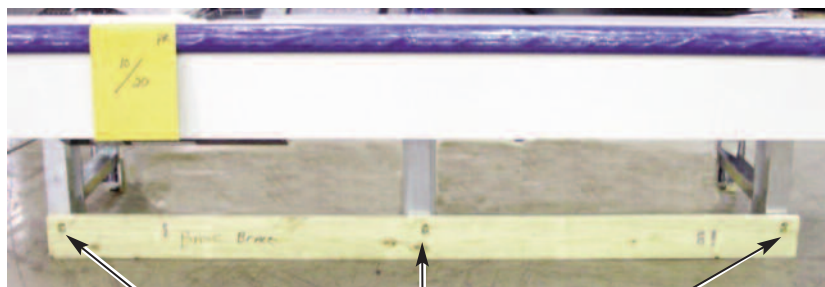


**NOTE:** Merchandisers must be leveled according to the installation instructions. Carefully unpack and inspect the Joining Kit, making sure there is no breakage or damage.



## WARNING

DO NOT remove riders until case is in its final position.



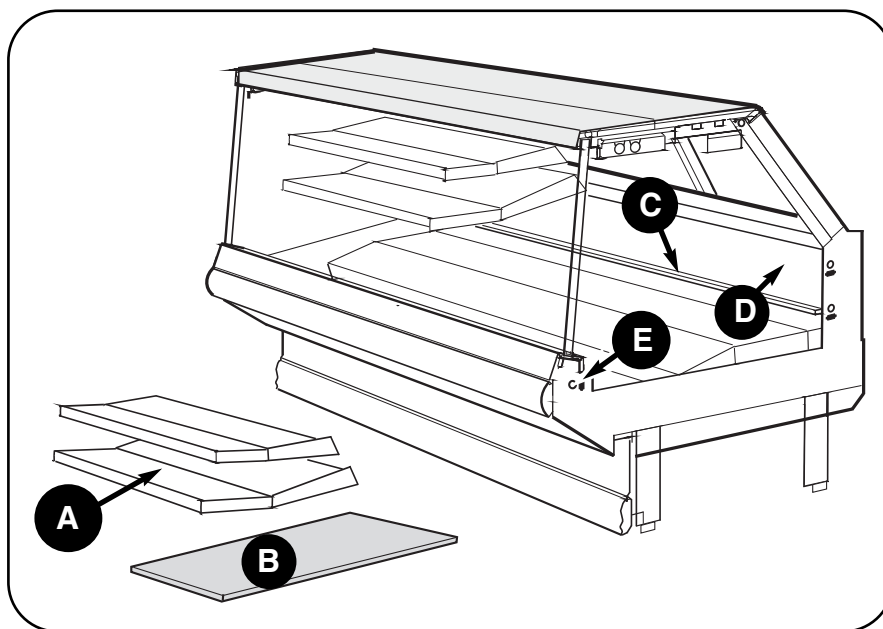
Remove Bolts from Front

**P/N 0518590\_C**  
**March 2012**

## PREPARATION

**1** Remove the following items from the case:

- A. Shelves if installed,
  - B. Display Pans,
  - C. Rear Pan Bracket and Upright
  - D. Rear Panel and Discharge Grille
  - E. Front Return Air Grille
- See Figure 1.

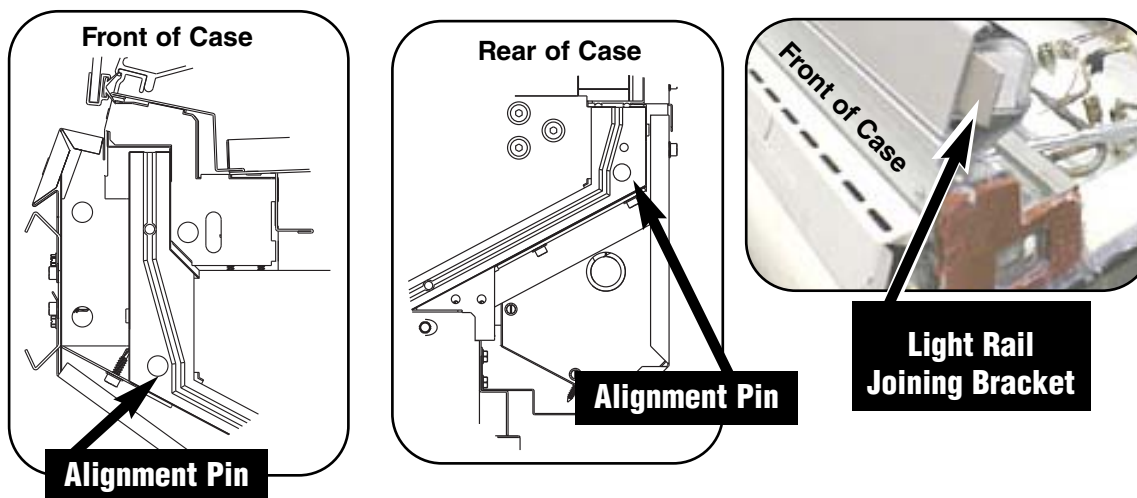


**Figure 1.** Remove Items from Case

## INSTALL GASKETS

**IMPORTANT**

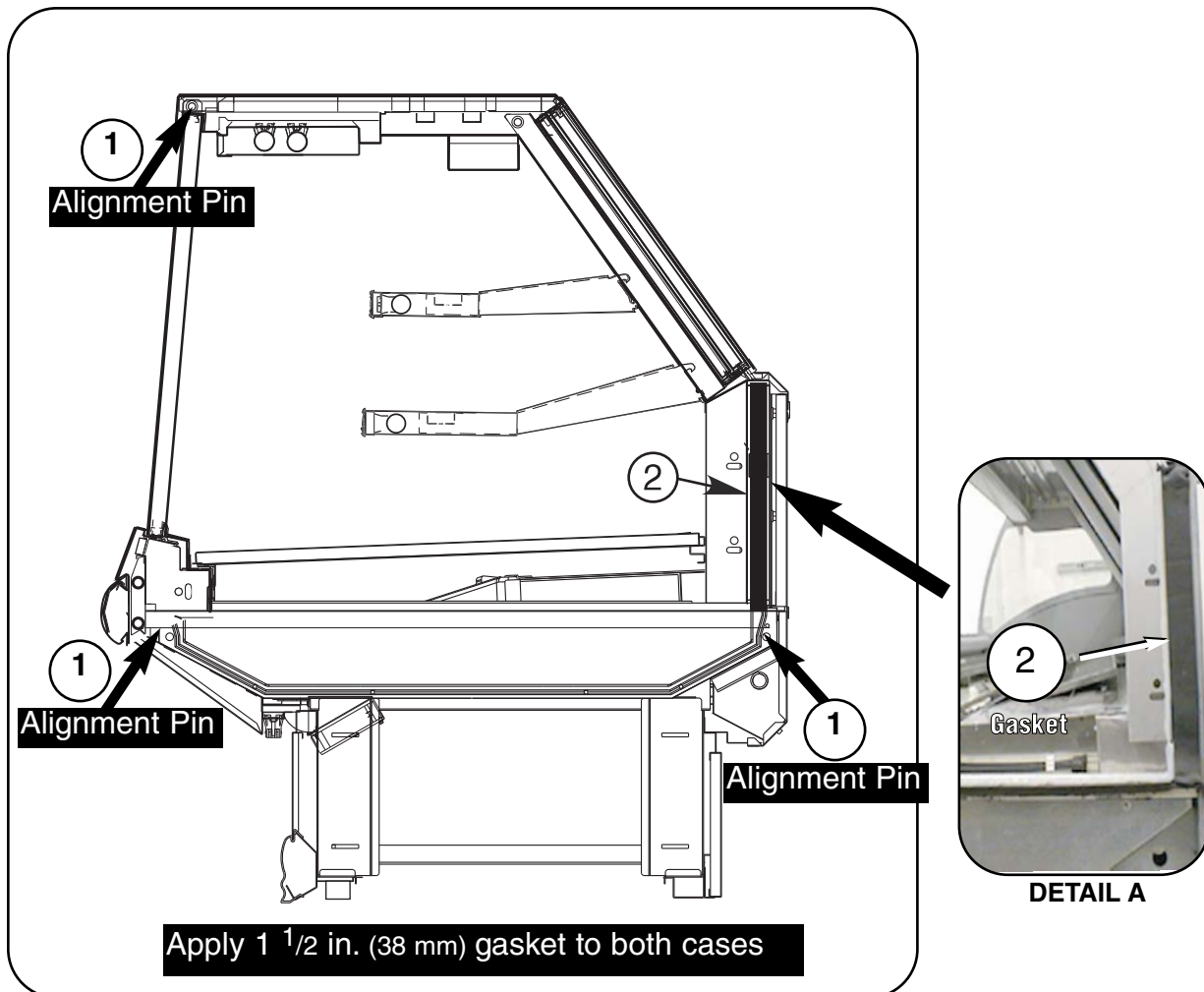
Make sure the Alignment Pins and Light Rail Joining Bracket are in place before gasketing and sealing cases.



**Figure 2.** Check Alignment Pins and Install Light Rail Joining Bracket

**2** Apply 1 1/2 in. (321 mm) **Gasket (Item – 2)** to rear foam panel of both cases as shown. Check to be sure there are no gaps between gasket and merchandiser. **NOTE: THIS IS THE ONLY GASKET THAT IS APPLIED TO BOTH CASES. THE FOLLOWING STEPS MUST BE DONE TO ONE CASE ONLY. SEE FIGURE 3, DETAIL A.**

- Do not stretch gasket
- Remove paper backing after gasket has been applied.

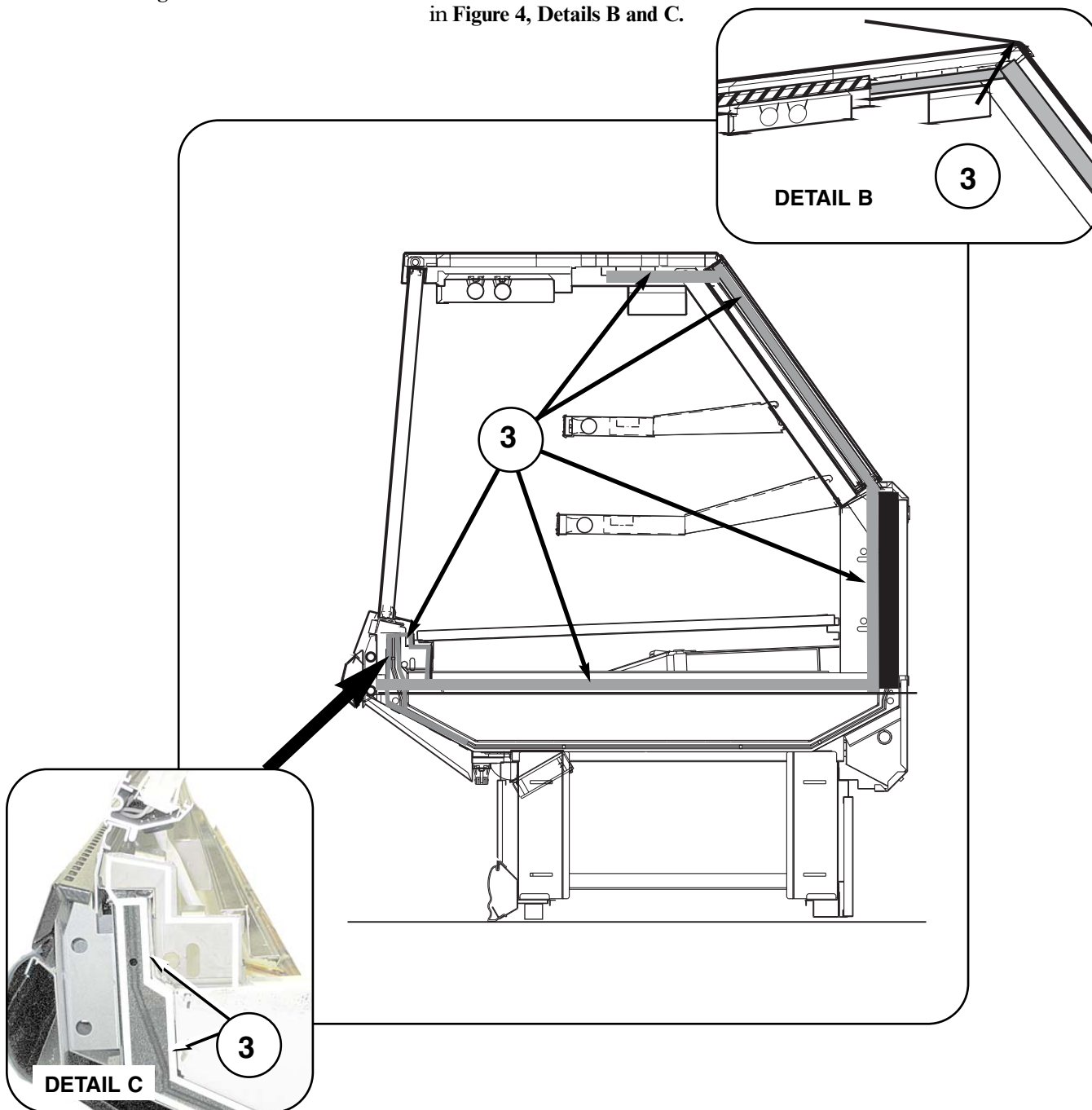


**Figure 3.** Apply 1 1/2 in. Gasket to the Merchandisers

## APPLY SILICONE

**3** Before joining, lay a 1/2 in. bead of clear **Silicone (Item – 3)** along the perimeter of the case as shown in **Figure 4**.

**4** In addition, apply silicone around the perimeter of the front box bracket and over a portion of the frame as shown in **Figure 4, Details B and C**.

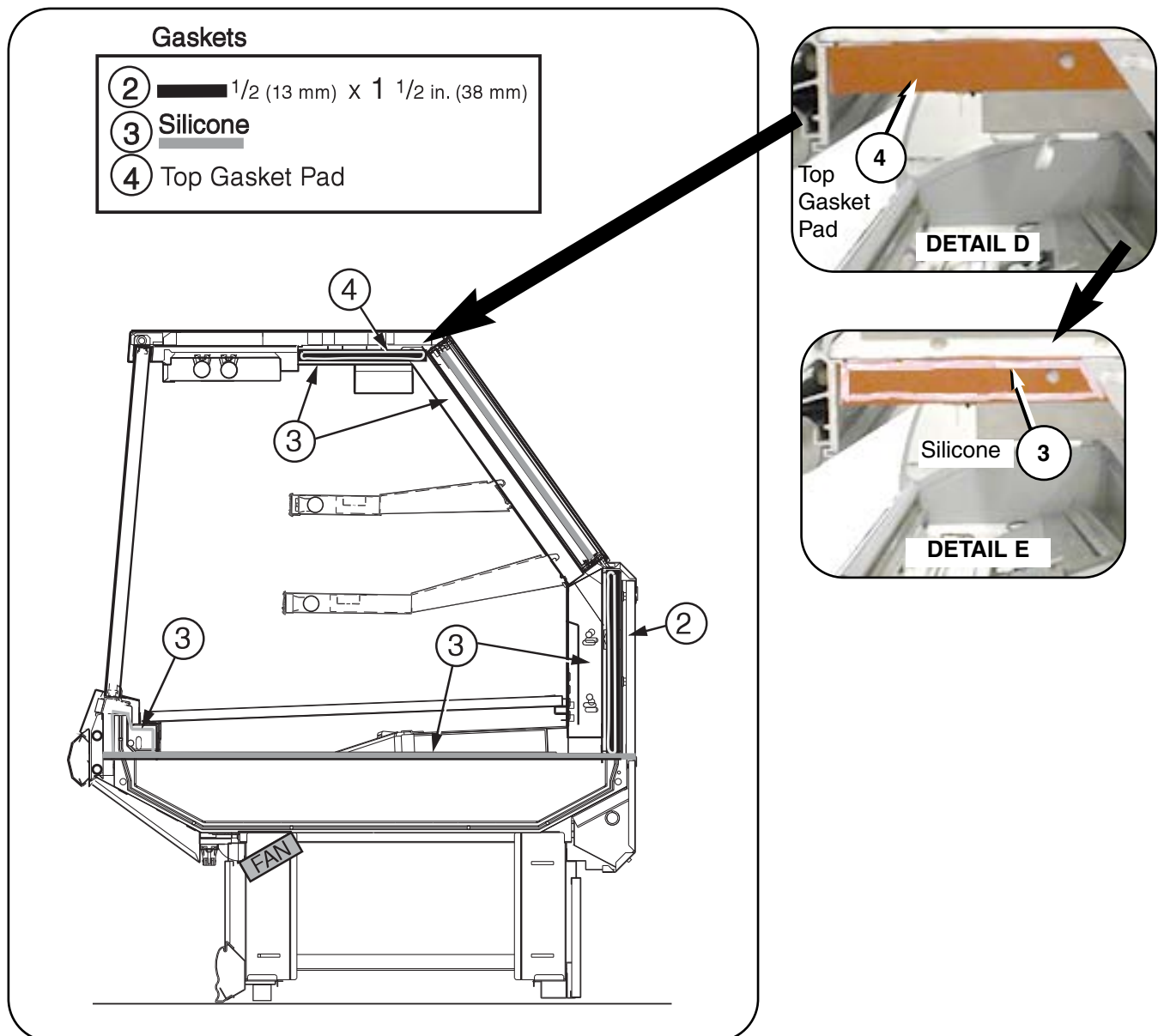


**Figure 4.** Apply Silicone

## APPLY TOP GASKET PAD

**5** Install the **Top Gasket Pad**, (Item – 4) over the silicone applied in previous step. See Figure 5, Detail D.

**6** Apply **Silicone** (Item – 3) onto the **Top Gasket Pad** (Item – 4). See Detail E.



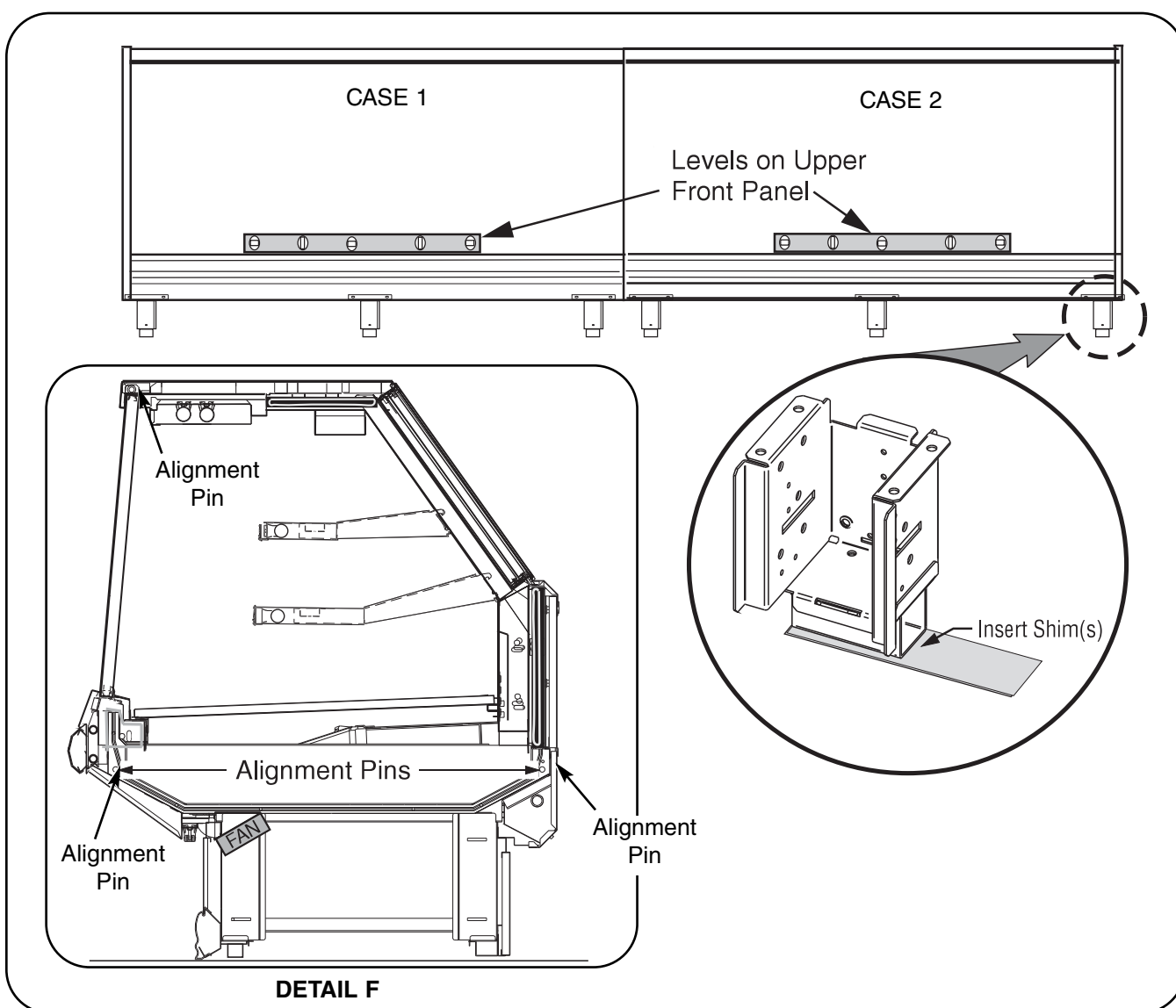
**Figure 5.** Apply Top Gasket Pad

**7** Move the second merchandiser into position against the first. Match the alignment pins with the corresponding holes. See **Figure 6, Detail F**.

**8** The complete lineup must be leveled to the highest point of the floor. After the first merchandiser has been set, position the second so the end frames touch.

A. Set a long level (4 foot or more) on the upper front panel of the merchandisers. Adjust case height by adding shims until the merchandisers are flush and level. See **Figure 6**.

B. Check each joint area to be sure that the panels of adjoining merchandisers are flush to each other.



**Figure 6. Level Merchandisers**

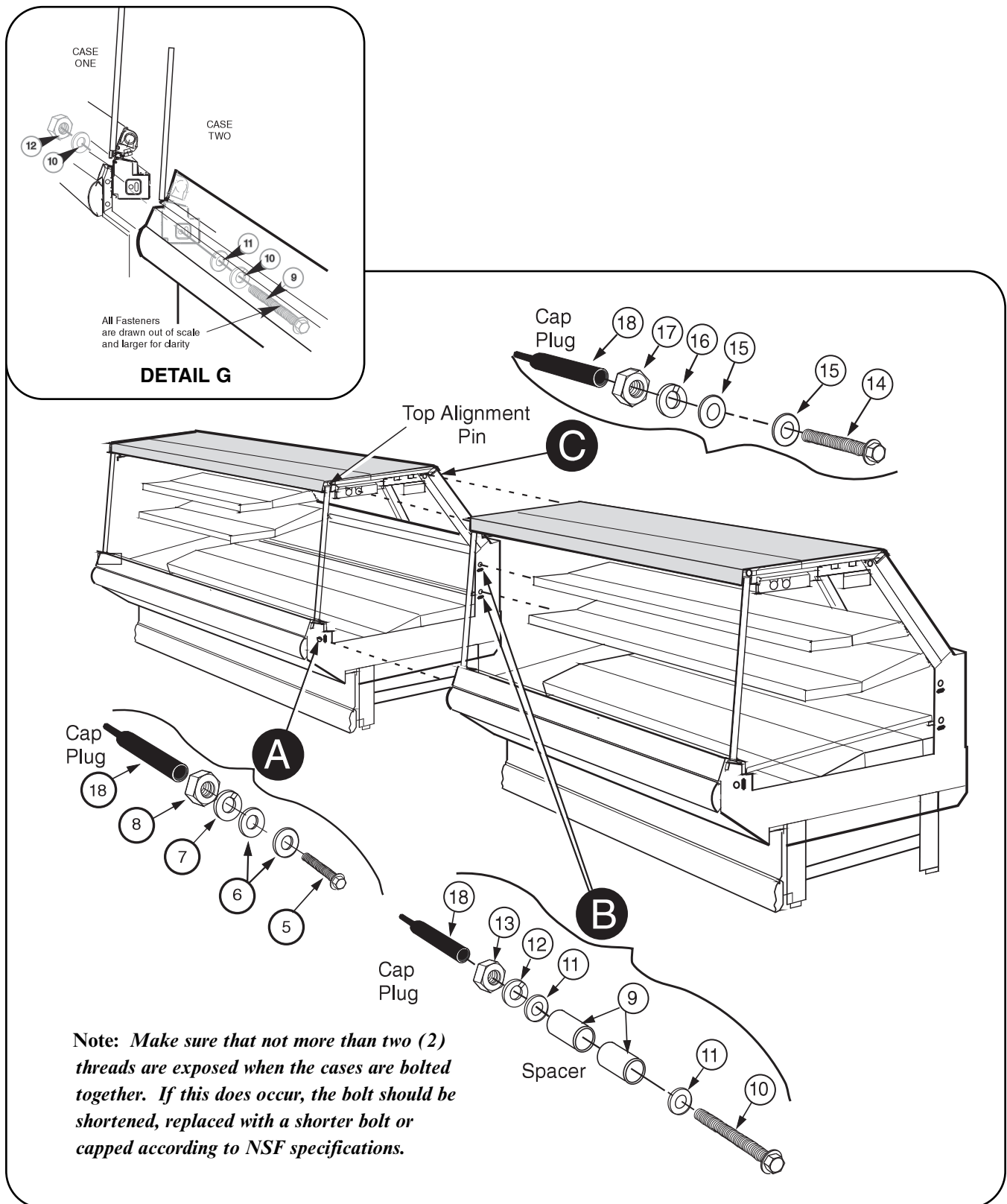


Figure 7. Overview of Fastener Locations

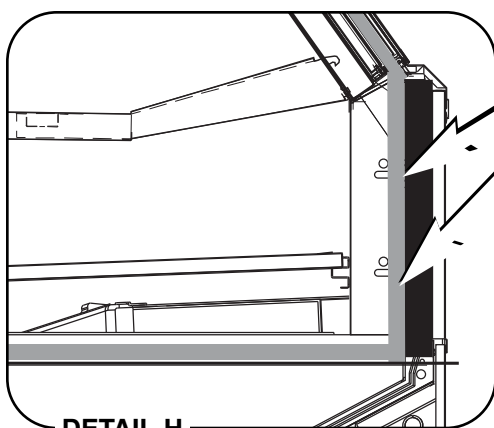
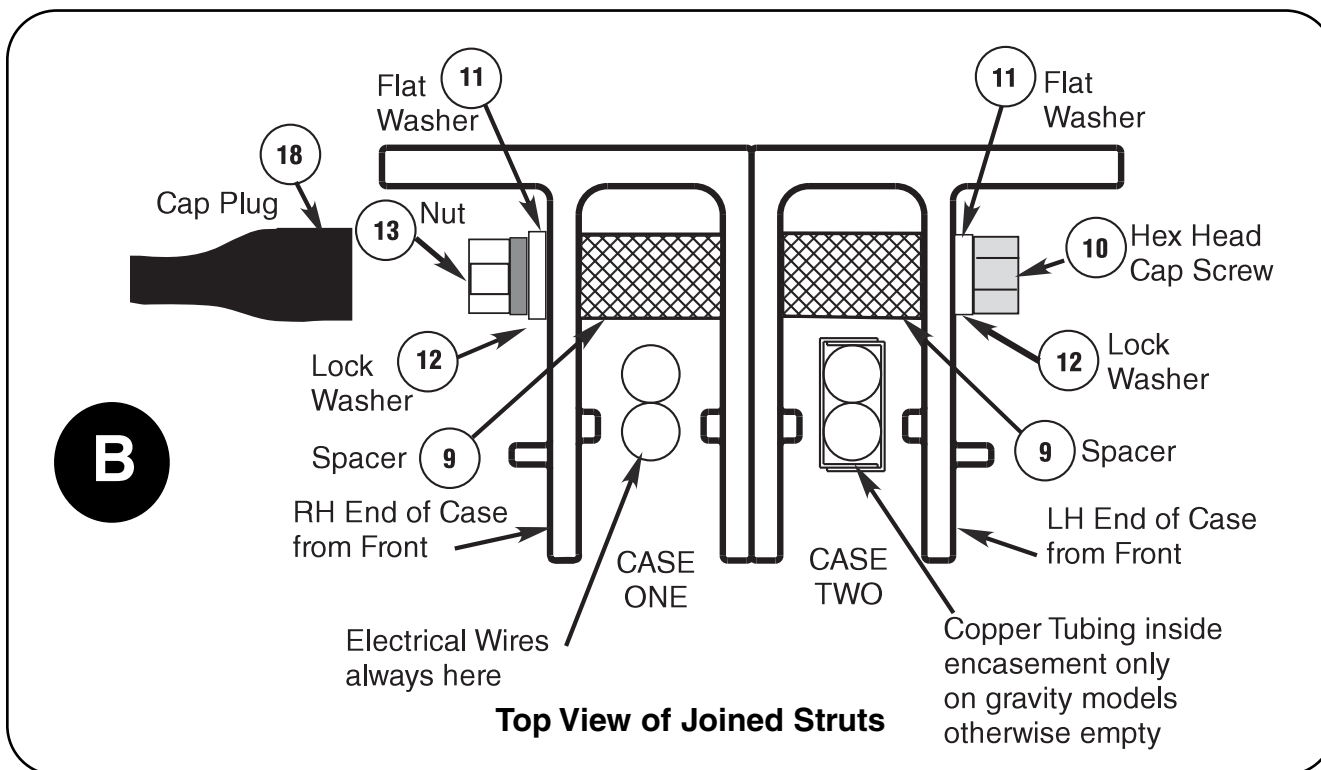


- 9** Fasten the rear of the cases together at two locations shown below using,  
**Spacer (Item – 9),**  
**Cap Screws (Item – 10),**  
**Flat Washers (Item – 11),**  
**Lock Washers (Item – 12),**  
**Hex Nut (Item – 13 and**  
**Cap Plug (Item – 18). )**  
 See Figure 8, Detail H.



## CAUTION

Use caution when installing fasteners around wiring or refrigeration lines inside of struts.



Strut Joining Location

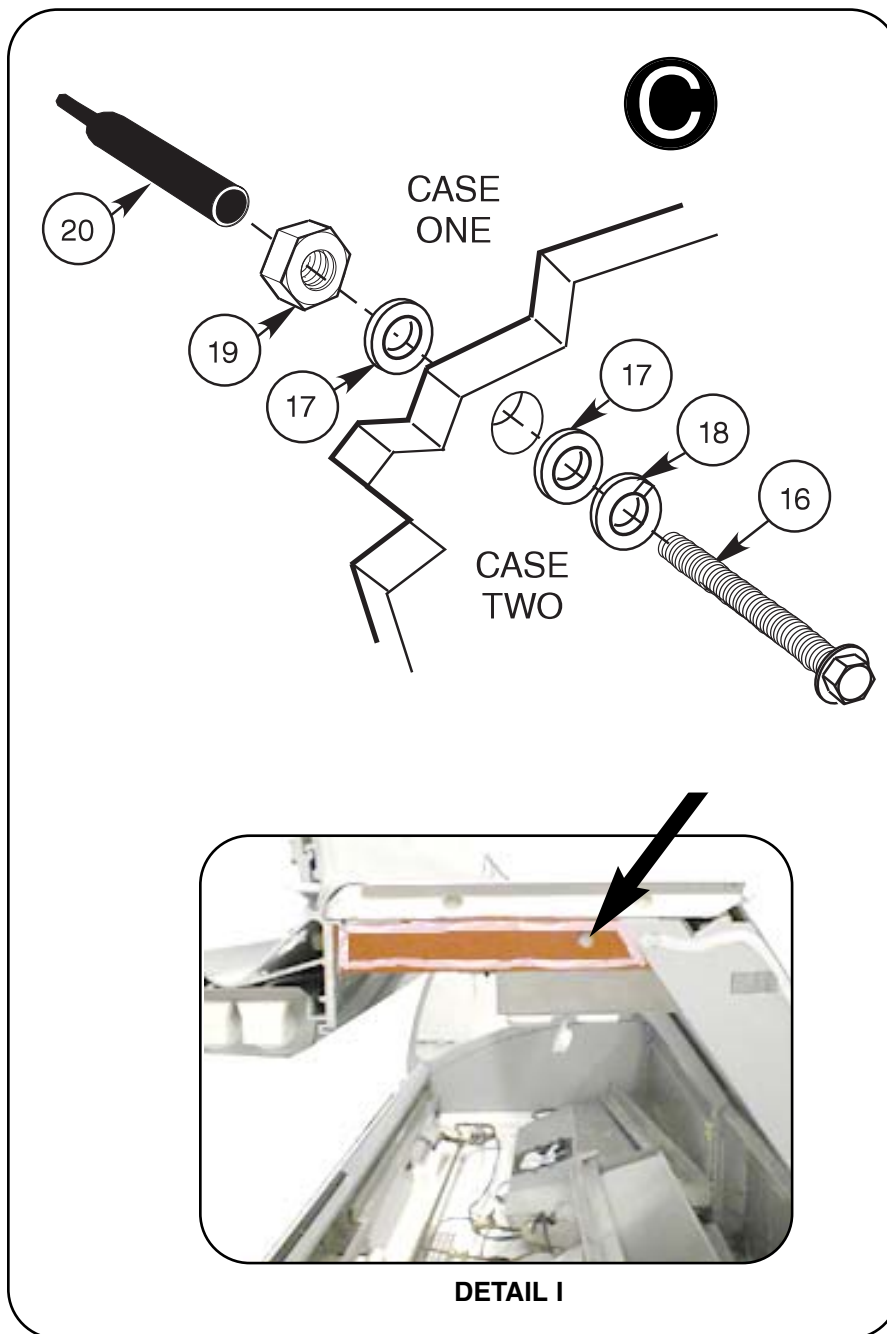
**Figure 8. Fasten Rear of Cases Together (Sequence B)**



**10** Fasten the top rear of the cases together using:

**Cap Screws (Item – 14),  
Flat Washers (Item – 15),  
Lock Washers (Item – 16)  
Hex Nut (Item – 17), and  
Cap Plug (Item – 18).**

See Figure 9.



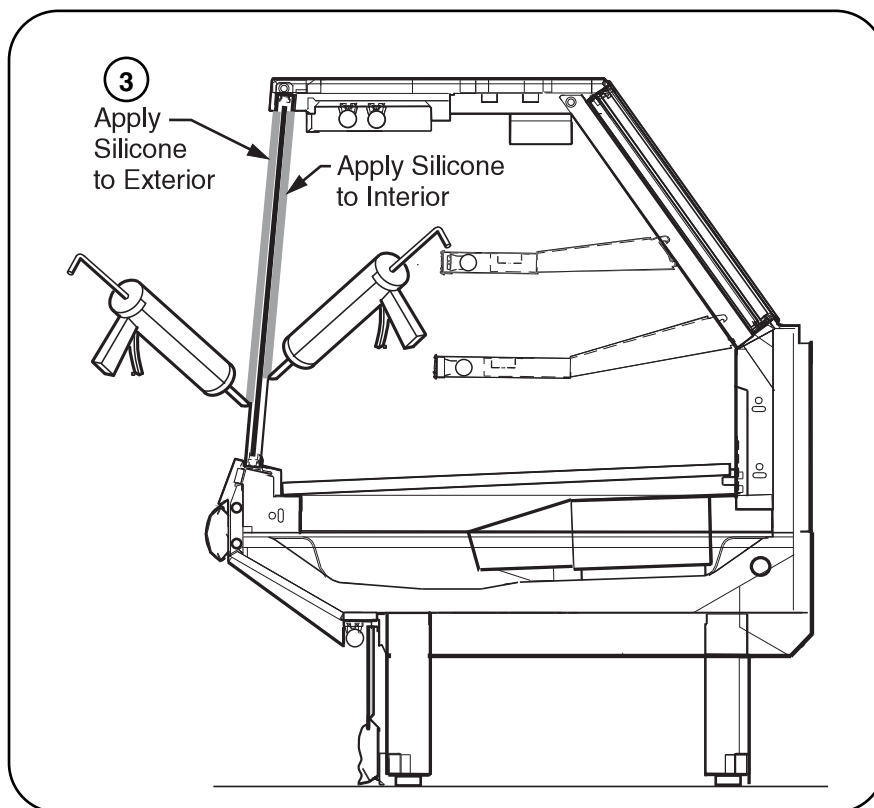
**Figure 9.** Fasten Top Fronts of Cases Together  
(Sequence C)

- 11** Apply a bead of **Silicone (Item – 3)** down and into the joint from the exterior and interior side of glass.

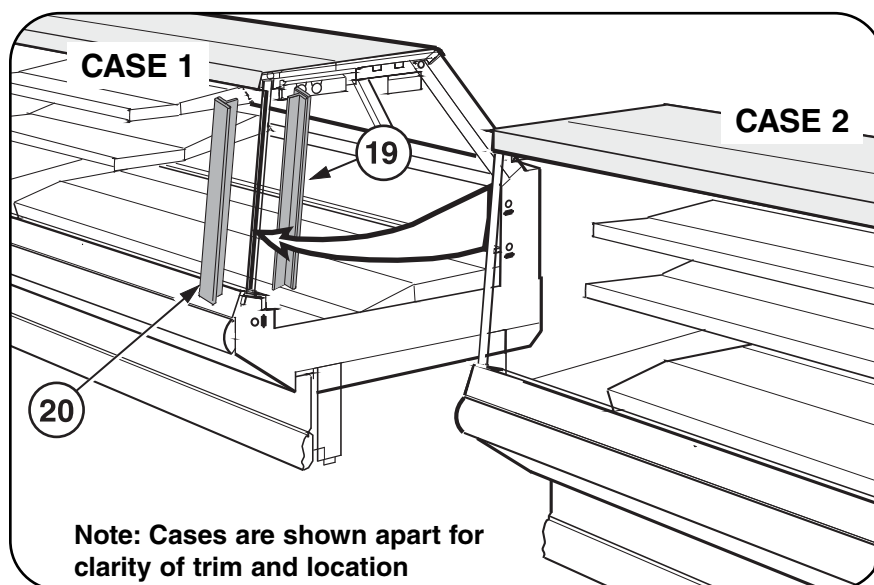
### Add Trim Between Glass While Silicone is Still Wet

- 12** Insert the **Interior and Exterior Trim (Items – 19 and 20)** into the silicone that was applied in Step 11.

See **Figure 11** and detail on next page.

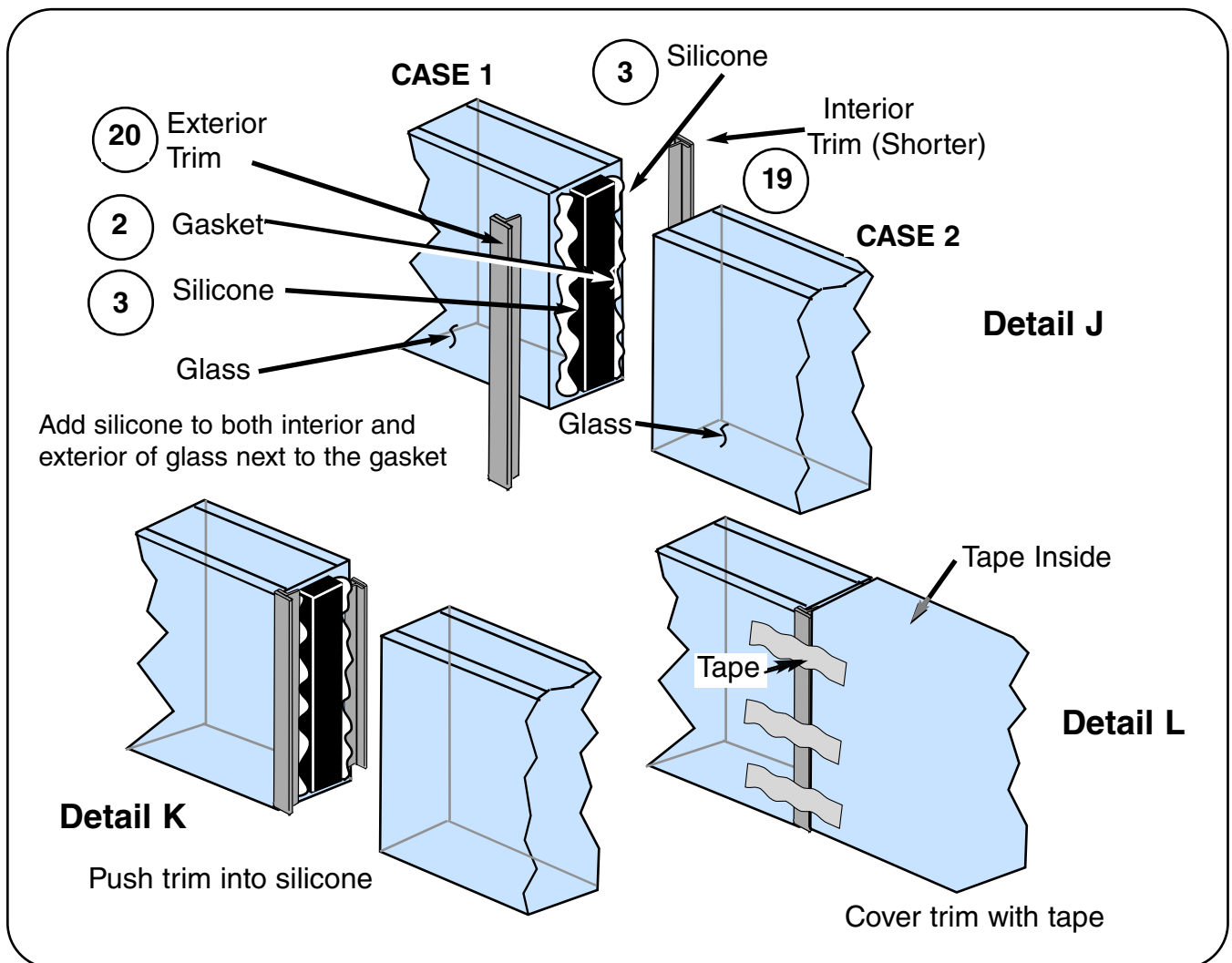


**Figure 10.** Sealing Front Glass



**Figure 11.** Seal and Add Trim to the Front Joint of Case

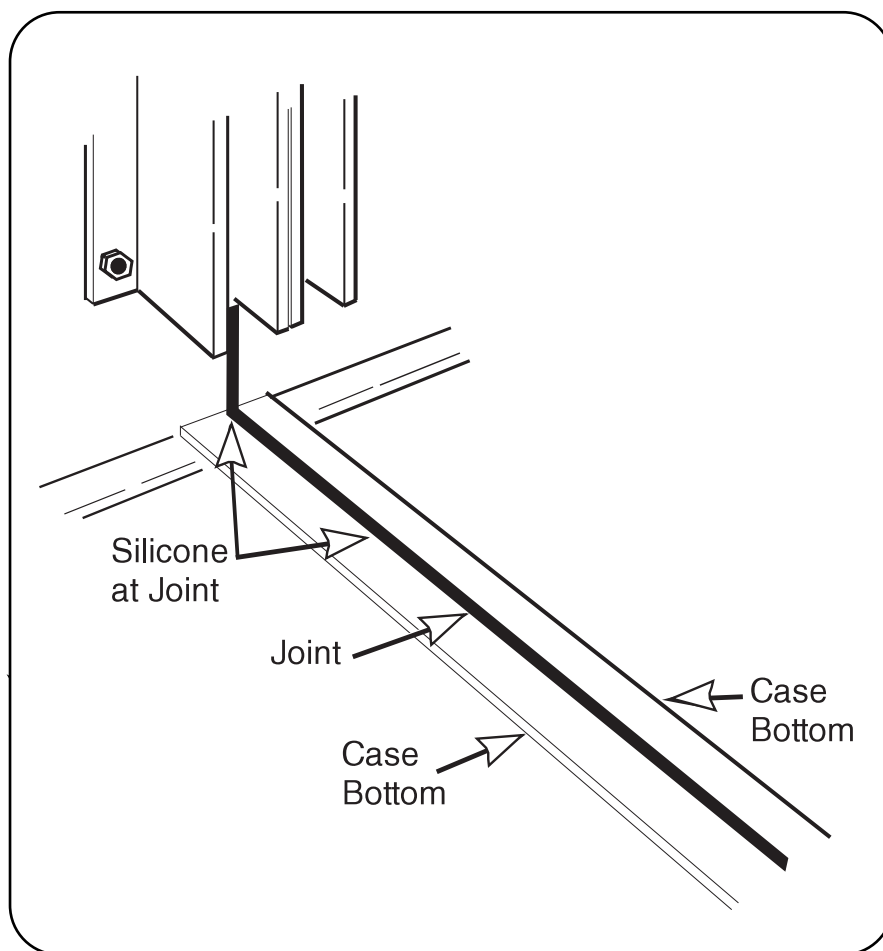
Apply tape over the trim to hold them in place as the silicone dries for 24 hours. See **Figure 11** and **Details J, K and L** for this procedure.



**Figure 11 Detail.** Seal and Add Trim to the Front Joint of Case

### SEALING THE INTERIOR BOTTOM OF THE CASES

- 13** Apply a continuous bead of **Silicone (Item – 2)** to the joint. Smooth and even out silicone so that there are no gaps or ridges in the case joint.



**Figure 12.** Install and Seal Joint Cover

**SEAL THE EXTERIOR OF THE CASE**

- 14** Apply a smooth continuous bead of silicone over the *Exterior Top Joint* of the cases.

See Figure 13, Detail M.



- 15** Continue sealing down the *Rear Mullion Joint* of the cases and finally seal the *Rear Sill Joints*, as shown in **Figure 13, Details N & O.**



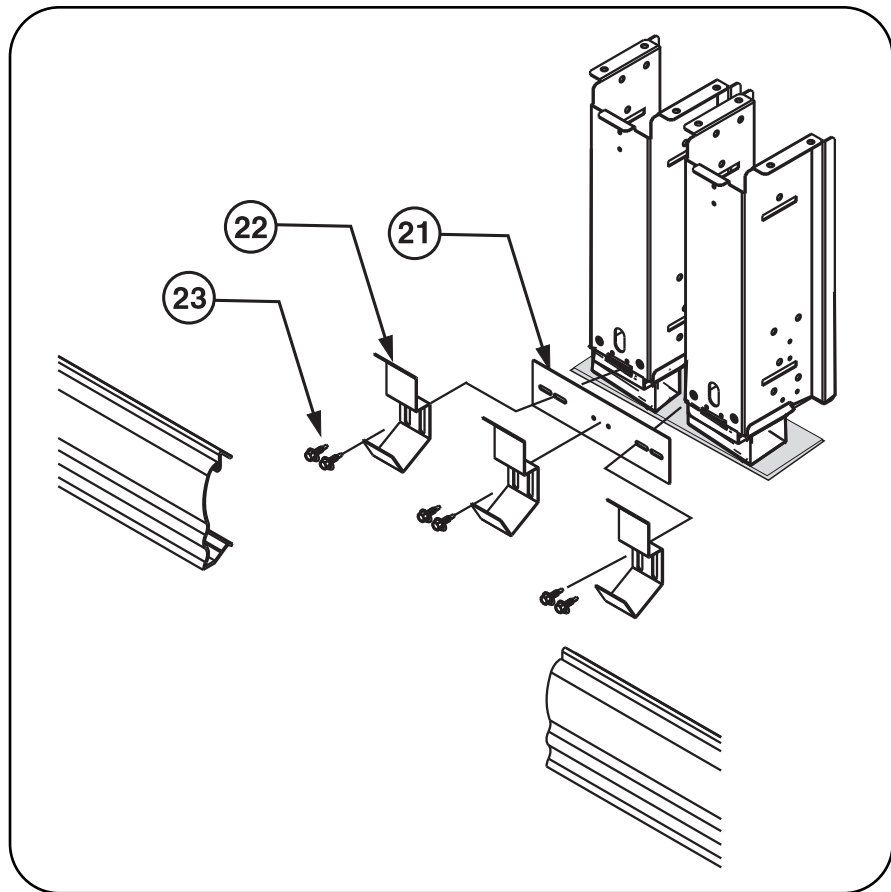
**Figure 13. Seal Case Joints**

## INSTALLING SPLASHGUARD

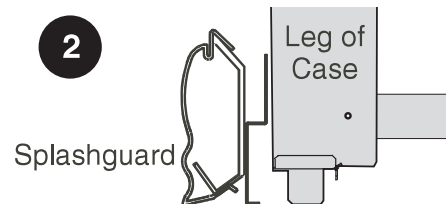
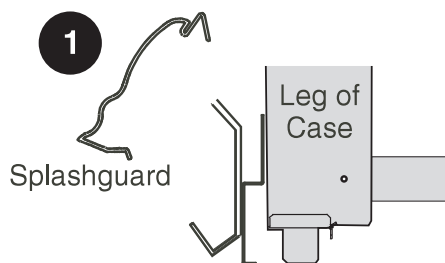
- 16** Attach the **Splashguard Joint Plate (Item – 21)**, and **Splashguard Retainers (Item – 22)** to the front side of the legs as shown using **Screws (Item – 23)**.

*After* merchandisers have been leveled and joined, and all drip piping, electrical and refrigeration work has been completed, install the splashguard.

- Position top of splashguard over the top edge of the retainer/ bracket as shown in Detail I.
- Push the lower edge of the splashguard toward the bottom of the bracket until it snaps into place.



**Figure 14.** Installing Splashguard Retainers and Splashguard

**DETAIL I**