

Vertical Glass Service Merchandisers Solid / Glass End Instruction

Fresh Meat, Deli and Fish Merchandiser

SOLID END

PARTS LIST

Item No.	Quantity	Description	
1.	1	Gasket 1/2 x 15/8 x 180	
2.	1	Gasket 1/2 x 1 1/2 x 120	
3.	1	Silicone	
4.	1	Top Gasket Pad	
5.	1	Front Gasket Pad	
6.	1	Solid End Assembly	
7.	1	Cap Screw 5/16 - 18 x 13/4	↑
8.	1	Lock Washer 5/16	
9.	2	Flat Washer 5/16	
10.	1	Hex Nut 5/16 - 18	Front of Case
11.	1	Cap Plug	
12.	1	Plug Button	↓
13.	2	Cap Screw 5/16 - 18 x 2 1/2	↑
14.	2	Lock Washer 5/16	
15.	4	Flat Washer 5/16	
16.	2	Spacer	
17.	2	Hex Nut 5/16 - 18	Rear of Case
18.	2	Cap Plug	
19.	2	Plug Button	↓
20.	1	Cap Screw 5/16 - 18 x 2 1/2	↑
21.	1	Lock Washer 5/16	
22.	2	Flat Washer 5/16	
23.	1	Hex Nut 5/16 - 18	Top Rear of Case
24.	1	Cap Plug	
25.	1	Plug Button	↓
26.	1	Cap Screw 5/16 - 18 x 13/4	↑
27.	1	Lock Washer 5/16	
28.	1	Flat Washer 5/16	
29.	1	Nut Retainer 5/16	Top Front of Case
30.	1	Plug Button	↓
31.	1	Interior Trim	
32.	1	Exterior Trim	
33.	1	Interior End Cover	
34.	1	Splashguard Retainer Assembly	
35.	6	Hex Washer Head Sheet Metal Screw #10 - 16 x 3/4	
36.	1	End Splashguard Assembly	
37.	1	Lower End Panel	

Note: For Glass End, replace Step 9 with Steps 9a through 9f. See page 13.



KIT
END

Removing Items from the Case:

NOTE: Make sure merchandisers have been leveled according to the installation instructions. Carefully unpack and inspect the End Kit, making sure there is no breakage or damage.

- Steps**
- 1** Remove items below:
- A.** *Shelves if installed,*
 - B.** *Display Pans,*
 - C.** *Rear Pan Bracket and Upright*
 - D.** *Rear Panel and Discharge Grille*
 - E.** *Front Return Air Grille*
- from case. See Figure 1.

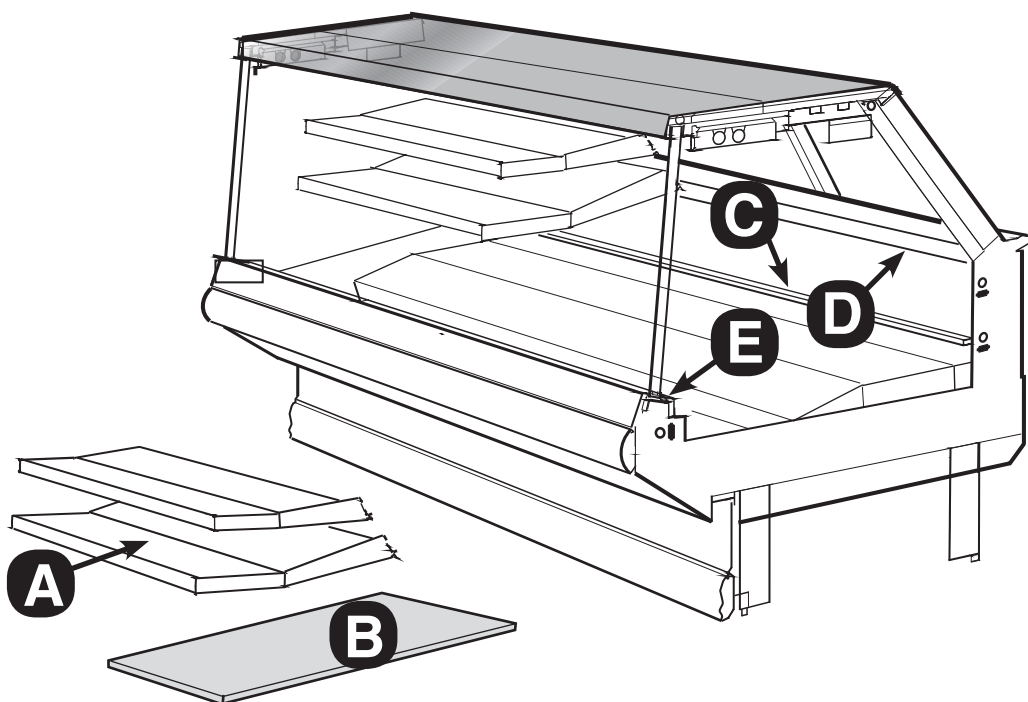

Figure 1. Removing Items from Case

Installing Gaskets:

2 Apply 1 $\frac{5}{8}$ in. (41 mm) **Gasket (Item – 1)** to rear foam panel as shown. Check to be sure that there are no gaps between gasket and merchandiser.

3 Apply $\frac{1}{2}$ in. (13 mm) **Gasket (Item – 2)** to the horizontal recess across the bottom and on the edge of the glass. See Figure 2, Detail A.

- Do not stretch gasket, especially around corners.
- Do not butt gaskets; always overlap them as shown.
- Remove paper backing after gasket has been applied.

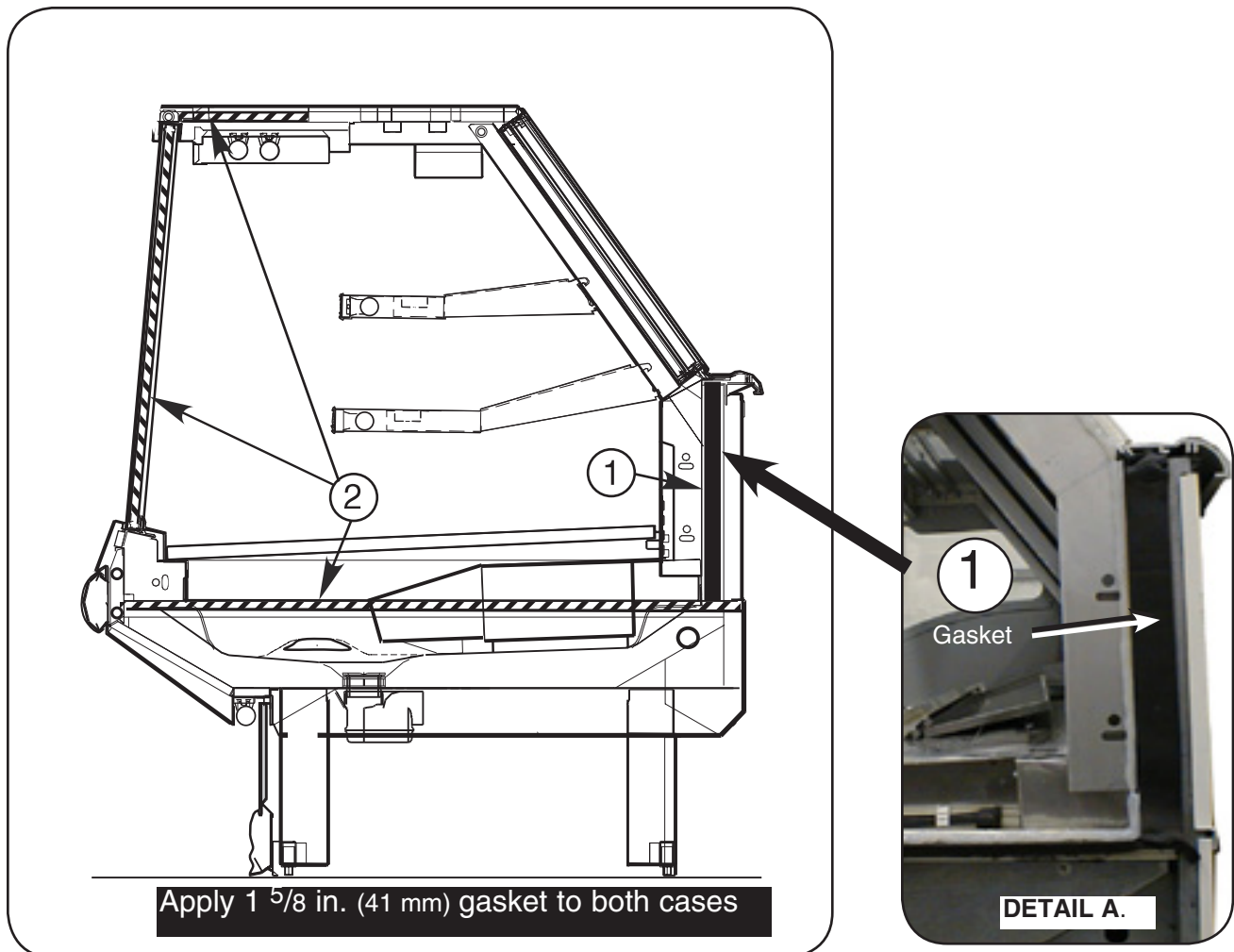

Figure 2. Applying 1 $\frac{5}{8}$ in. and $\frac{1}{2}$ in. Gaskets to the Merchandiser

4 Before installing end, make sure to apply a 1/2 inch bead of clear **Silicone (Item – 3)** along the perimeter of the case as shown in Figure 3.

5 In addition, apply silicone around the perimeter of the front box bracket and over the top of the frame. See Figure 3, Details B and C.

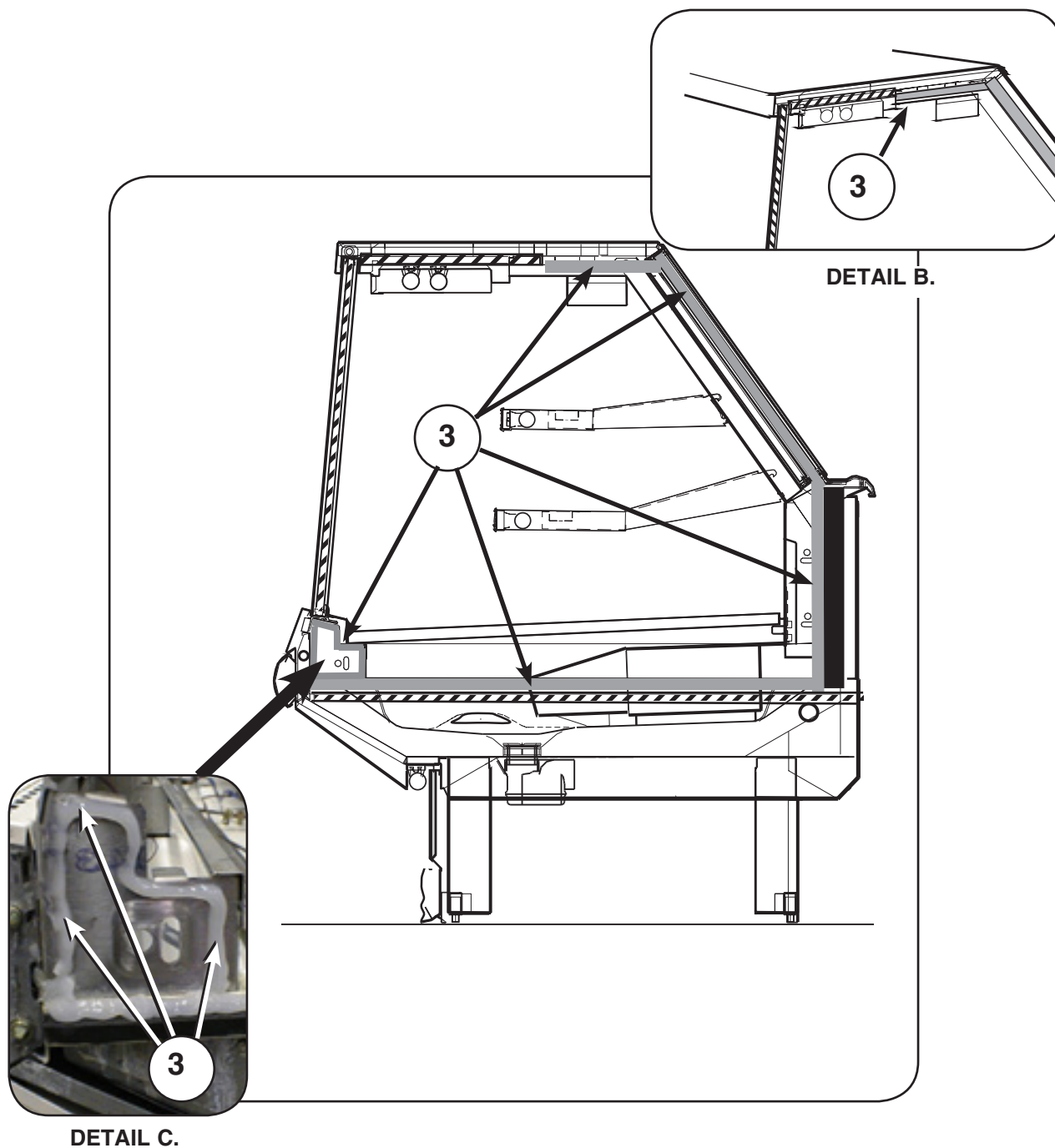

Figure 3. Applying Silicone

Applying Top and Front Gasket Pads

6 Install the **Top Gasket Pad**, (Item – 4) over the silicone applied in previous step. See Figure 4, Detail D.

7 Install the **Front Gasket Pad**, (Item – 5) over silicone applied in previous step. See Detail E.

8 Apply Silicone (Item – 3) onto the **Top Gasket Pad** (Item – 4) and the **Front Gasket Pad** (Item – 5). See Details F and G.

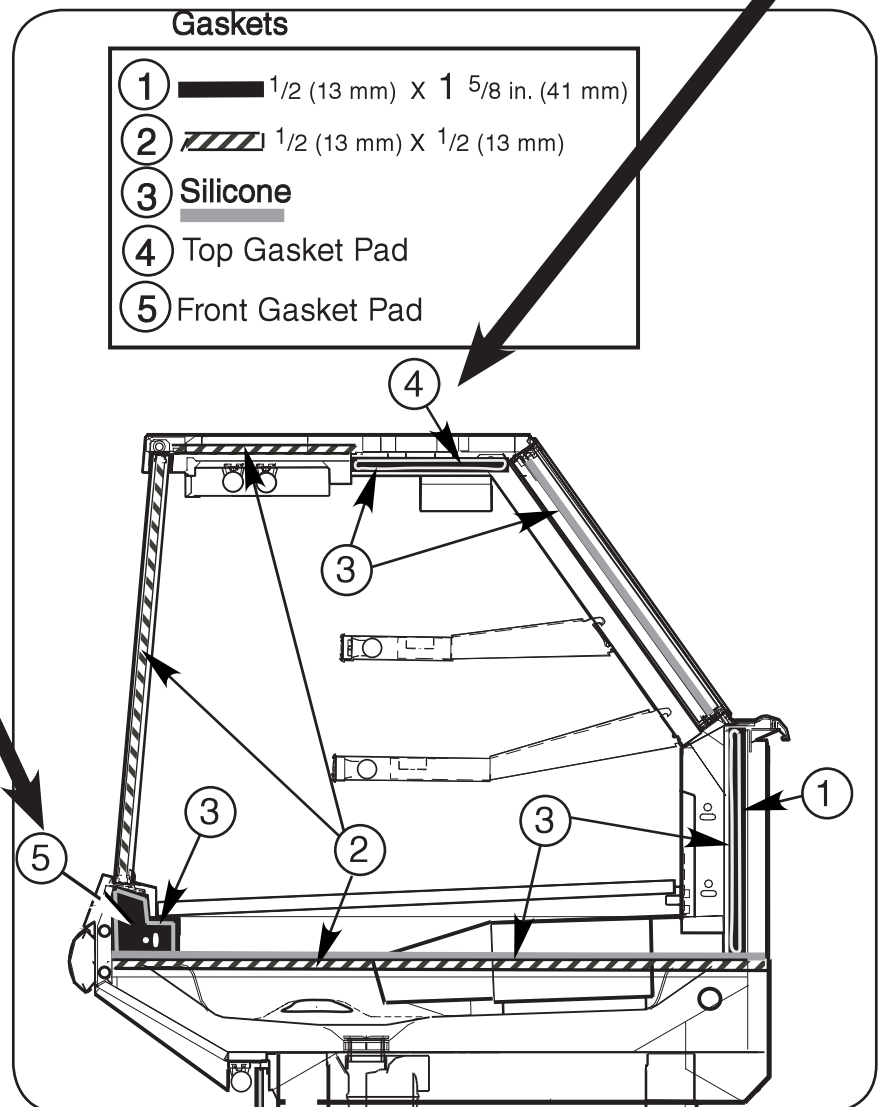
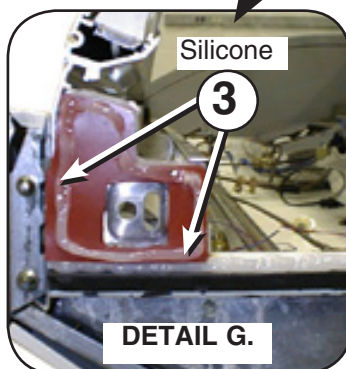
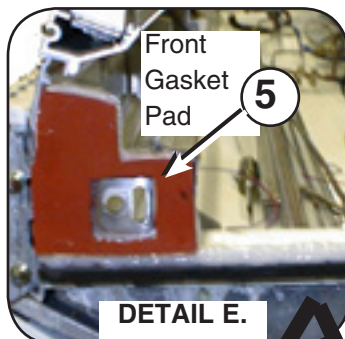
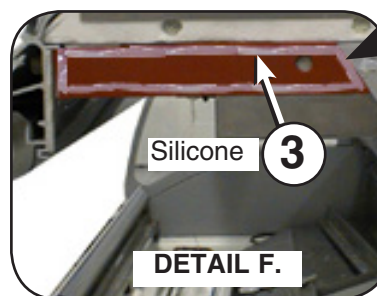

Figure 4. Applying Top and Front Gasket Pads

9 Place and fasten the **Solid End Assembly (Item – 6)** using **Cap Screws (Items – 7, 13, 20 & 26)**,

Lock Washers (Items – 8, 14, 21 & 27),
Flat Washers (Items – 9, 15, 22 & 28),
Spacer (Item – 16),

Hex Nut (Items – 10, 17 & 23),
Nut Retainer (Item – 29),
Cap Plug (Item – 11, 18 & 24)
 and **Plug Button (Items 12, 19, 25 & 30)**. See Figure 5.

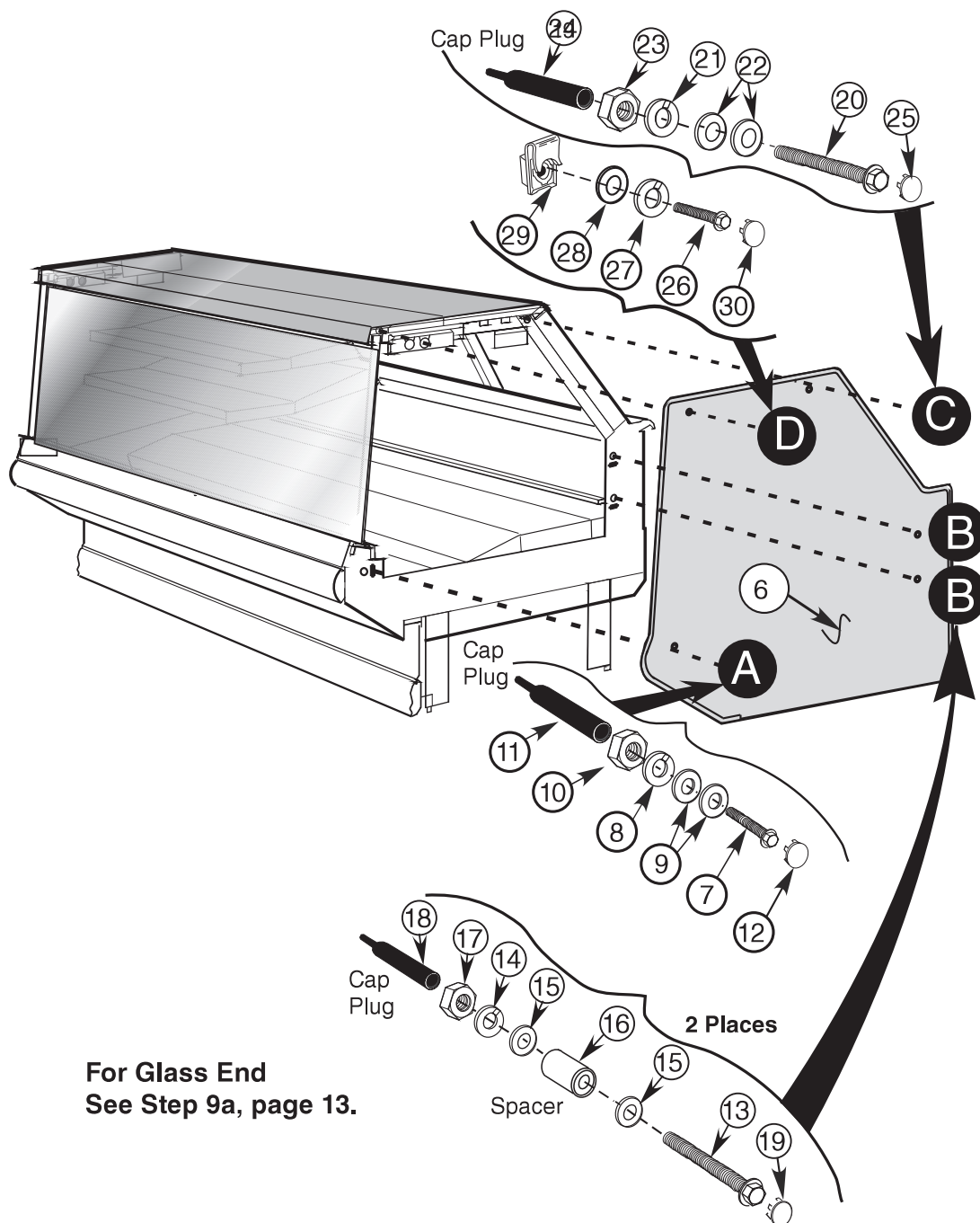

Figure 5. Fastening Solid End Assembly

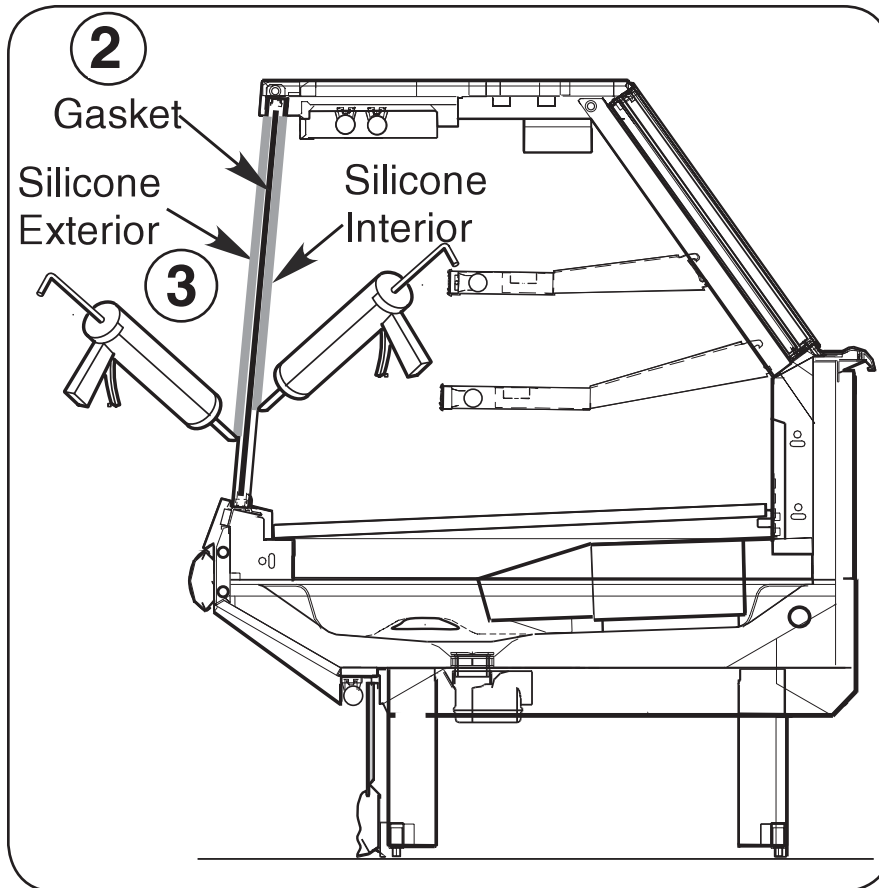

Figure 6. Applying Silicone to End Trim

- 10** Apply a bead of **Silicone (Item – 3)** down the end of the front glass from the exterior and interior side of glass next to the **Gasket (Item – 2)**.
See Figures 6 and 7.

Adding Trim to the End Front Glass

Note: Case is shown without end attached for clarity of trim and location.

- 11** While the silicone is still wet, insert the **Interior and Exterior Trim (Items – 31, 32)** into the silicone that was applied in Step 10. Apply tape over the trim to hold in place as the silicone dries for 24 hours. See Figure 7 and Details H, I and J for this procedure.

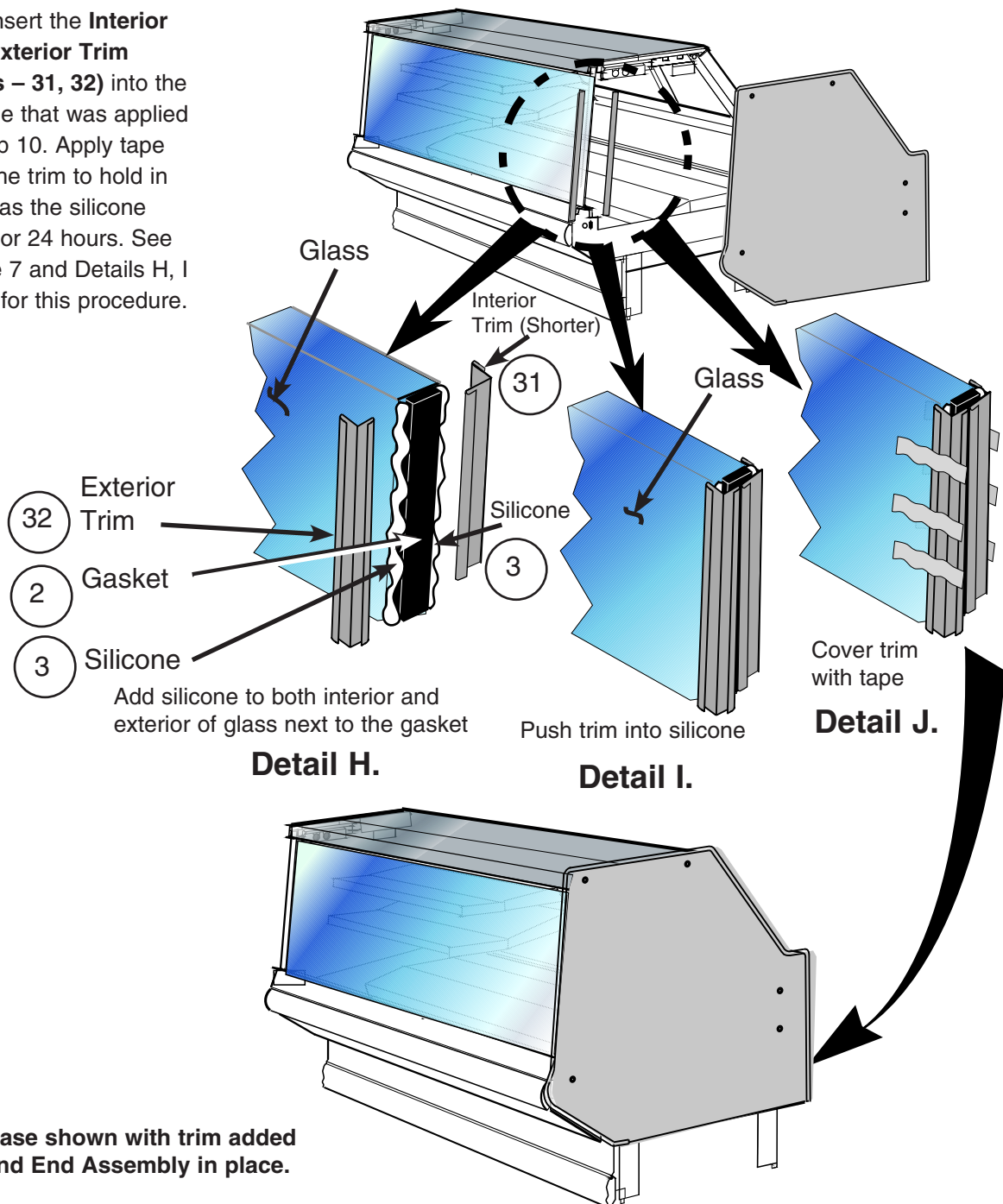

Figure 7. Sealing and adding Trim to the Front Glass and End of Case

Installing and Sealing Interior End Cover

Apply silicone over each end
of the Interior Cover.
See Figure 8, Details K & L.

- 12** Apply a continuous bead
of **Silicone (Item – 3)** to the
case bottom. Press the
Interior End Cover (Item – 33)
onto the bottom.

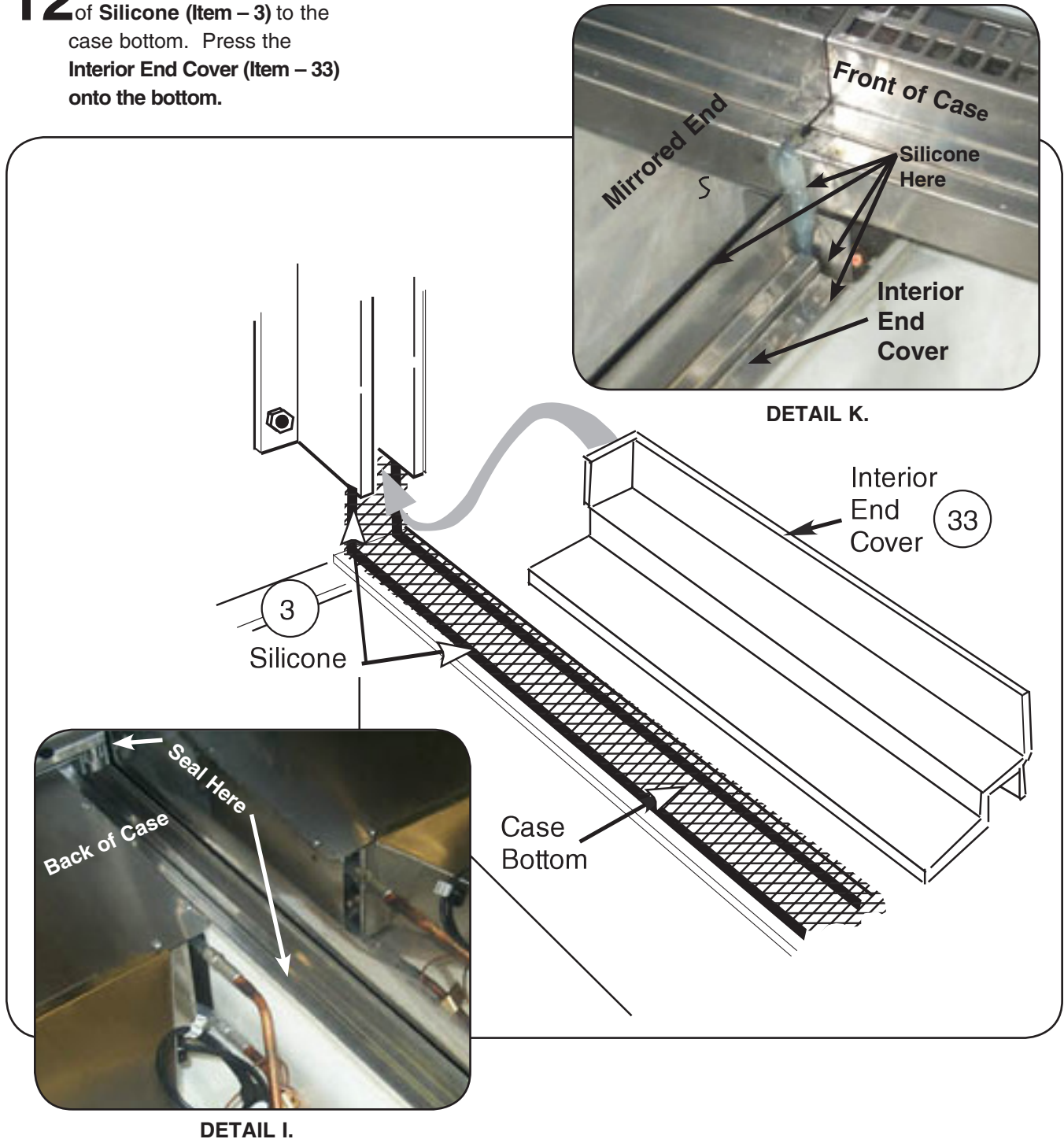

Figure 8. Installing Interior End Cover

Installing End Splashguard and Lower End Panel.

- 13** Install the **Splashguard Retainer Assembly (Item – 34)**, to the case leg using **Screws (Item – 35)**. Position the **Splashguard Assembly (Item – 36)** over the top edge of the bracket/retainer.

Push the lower edge of the splashguard. Push the lower edge of the splashguard toward the bottom of the bracket until it “snaps” into place.

- 14** Position the **Lower End Panel (Item – 37)**. Lift the panel up and drop into the groove at the top of the splashguard. See Figure 8 and Details, M and N.

- 15** Using **Silicone (Item – 3)**, seal all of remaining gaps around the exterior perimeter of end.

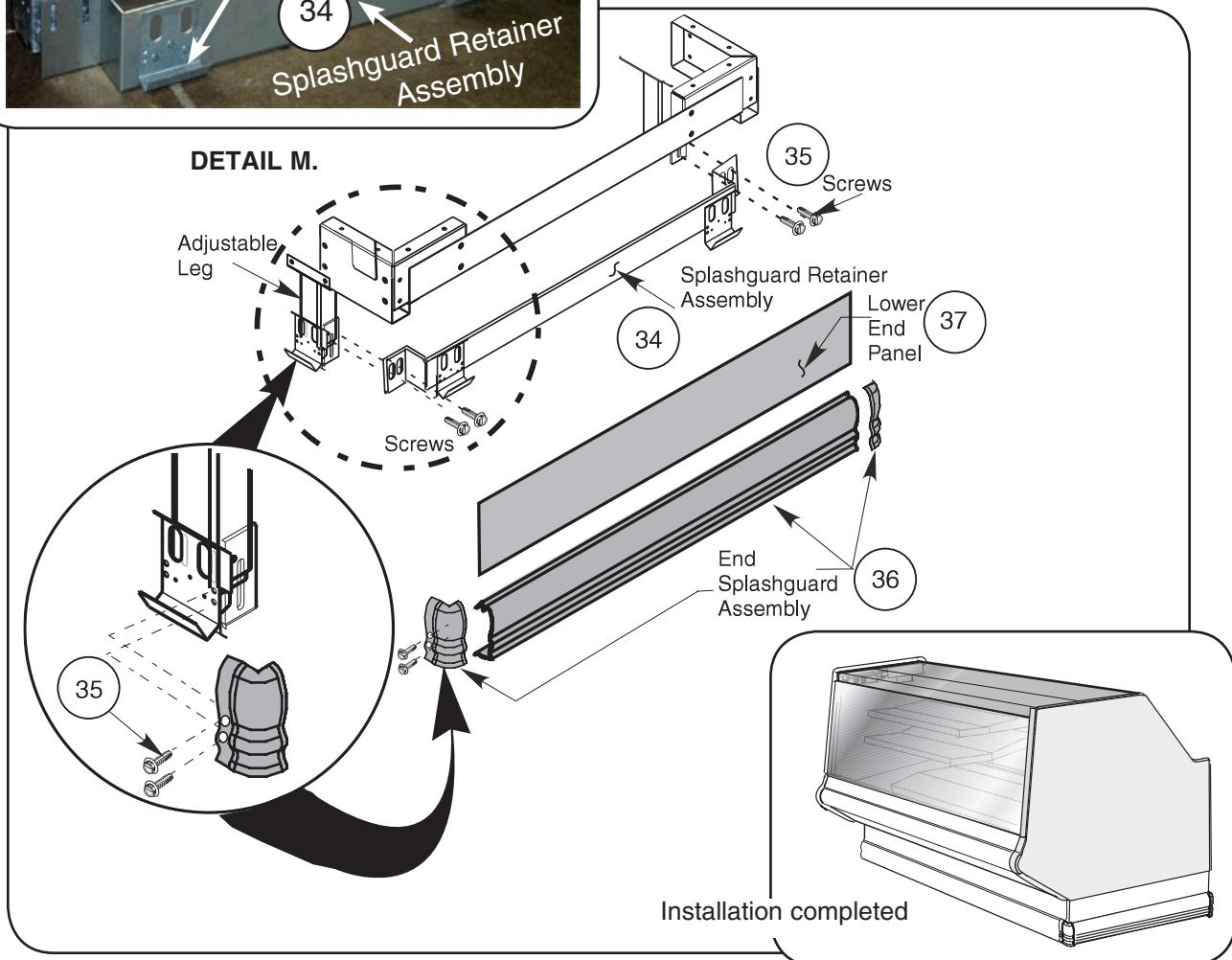
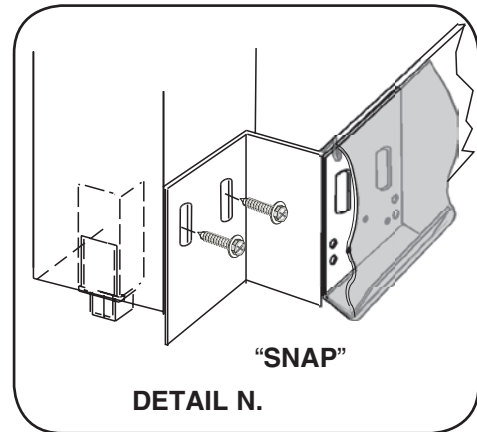
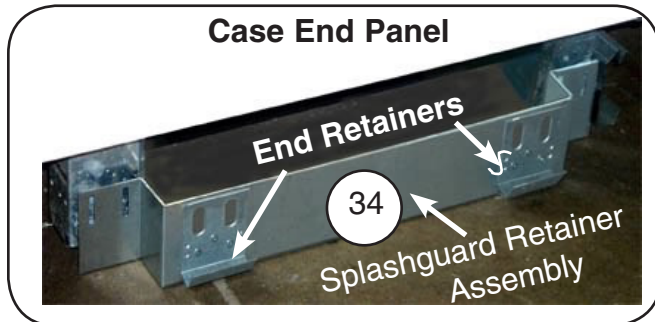

Figure 9. Installing End Brackets, Retainers Splashguard and Lower Panel

Sealing the Exterior of the Case

- 16** Apply a smooth continuous bead of silicone over the **Exterior Top Joint** of the cases.
See Figure 10, Detail O.



- 17** Continue sealing down the **Rear Mullion Joint** of the cases and finally seal the **Rear Sill Joints**, as shown in Figure 10, Details P & Q.



Figure 10. Sealing Case Joints

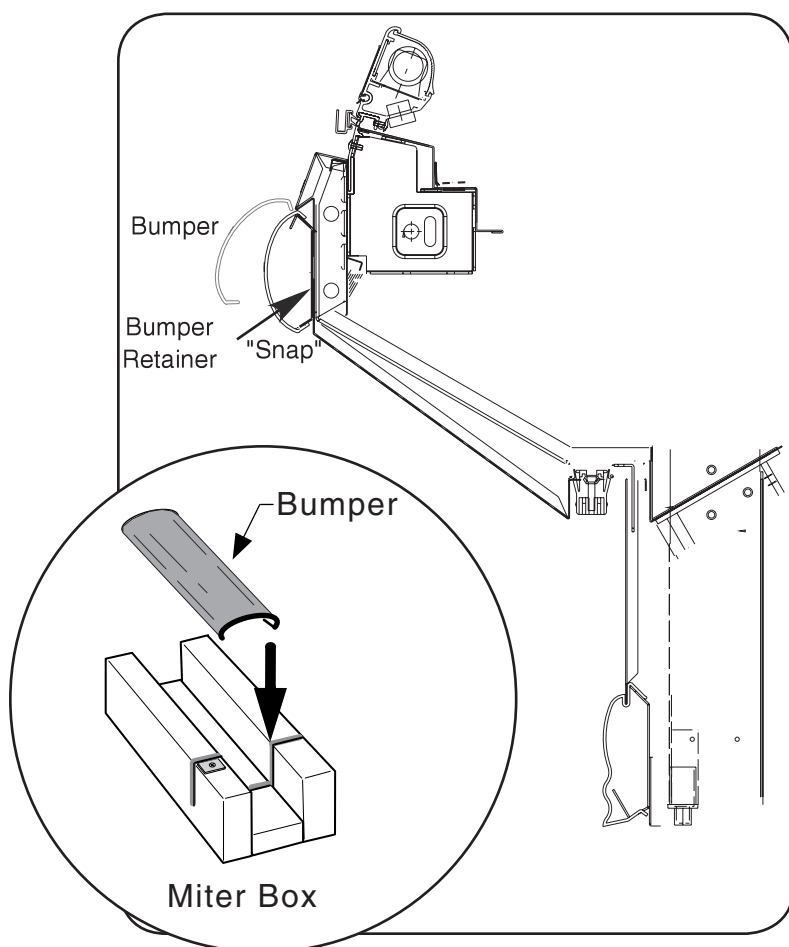

Figure 11. Installing Impact Bumper

18 TO INSTALL BUMPERS:

- A.** Starting from left end of line-up, insert 2 foot (610 mm) starter bumper into the front Top Bumper Retainer. Swing Bumper down into position until it "snaps" into place on the bottom of the retainer.
- B.** Install full length bumper to overlap merchandiser joint. Slide toward left, closing all gaps. Repeat for rest of line-up.
- C.** Use a miter box and fine toothed saw to cut last full-length bumper. See Figures 11 and 12.

19 Re-install all items that were removed in Step 1.

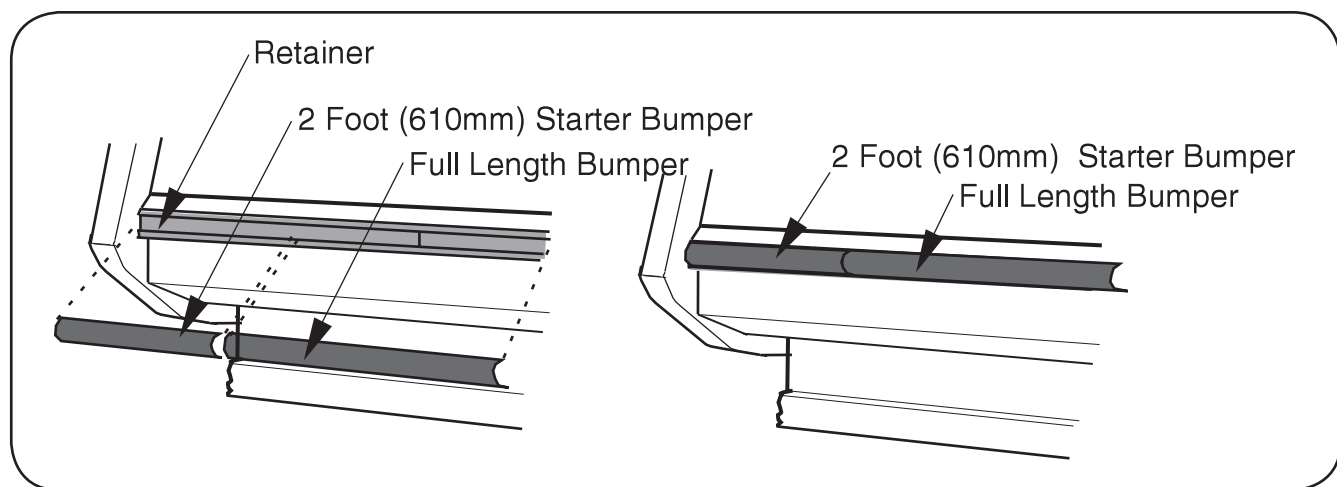

Figure 12. Installing and offsetting Bumpers

GLASS END

PARTS LIST

Item No.	Quantity	Description	
1.	1	Gasket $\frac{1}{2}$ x $1\frac{5}{8}$ x 180	
2.	1	Gasket $\frac{1}{2}$ x $\frac{1}{2}$ x 120	
3.	1	Silicone	
4.	1	Top Gasket Pad	
5.	1	Front Gasket Pad	
6.	1	End Assembly	
7.	1	Cap Screw $\frac{5}{16}$ - 18 x $1\frac{3}{4}$	Front of Case ↑ ↓
8.	1	Lock Washer $\frac{5}{16}$	
9.	2	Flat Washer $\frac{5}{16}$	
10.	1	Hex Nut $\frac{5}{16}$ - 18	
11.	1	Cap Plug	
12.	1	Plug Button	
13.	2	Cap Screw $\frac{5}{16}$ - 18 x $2\frac{1}{2}$	Rear of Case ↑ ↓
14.	2	Lock Washer $\frac{5}{16}$	
15.	4	Flat Washer $\frac{5}{16}$	
16.	2	Spacer	
17.	2	Hex Nut $\frac{5}{16}$ - 18	
18.	2	Cap Plug	
19.	2	Plug Button	
20.	1	Glass (for end)	
21.	1	Clear Plastic Channel	
22.	4	#8-18 x $\frac{1}{2}$ Hex Head Self Drilling Sheet Metal Screw	
23.	1	Cap Screw $\frac{5}{16}$ - 18 x $2\frac{1}{2}$	Top Rear of Case ↑ ↓
24.	1	Lock Washer $\frac{5}{16}$	
25.	2	Flat Washer $\frac{5}{16}$	
26.	1	Hex Nut $\frac{5}{16}$ - 18	
27.	1	Cap Plug	
28.	1	Plug Button for Glass	
29.	1	Cap Screw $\frac{5}{16}$ - 18 x $1\frac{3}{4}$	Top Front of Case ↑ ↓
30.	1	Lock Washer $\frac{5}{16}$	
31.	1	Flat Washer $\frac{5}{16}$	
32.	1	Nut Retainer $\frac{5}{16}$	
33.	1	Plug Button for Glass	
34.	1	Interior Trim	
35.	1	Exterior Trim	
36.	1	Interior End Cover	
37.	1	Splashguard Retainer Assembly	
38.	6	Hex Washer Head Sheet Metal Screw #10 - 16 x $\frac{3}{4}$	
39.	1	End Splashguard Assembly	
40.	1	Lower End Panel	

 KIT
 END

Installing End with Glass

Follow: **Steps 1-8** in the Solid End, beginning section of this instruction before going on to **Step 9a**.

9a Place and fasten the **End Assembly (Item – 6)** using **Cap Screws (Items – 7, 13)**, **Lock Washers (Items 8, 14)**.

Flat Washers (Items – 9, 15).
Spacer (Item – 16),
Hex Nut (Items – 10, 17)
Cap Plug (Items – 11, 18)
Plug Button (Items – 12, 19).

See Figure 13.

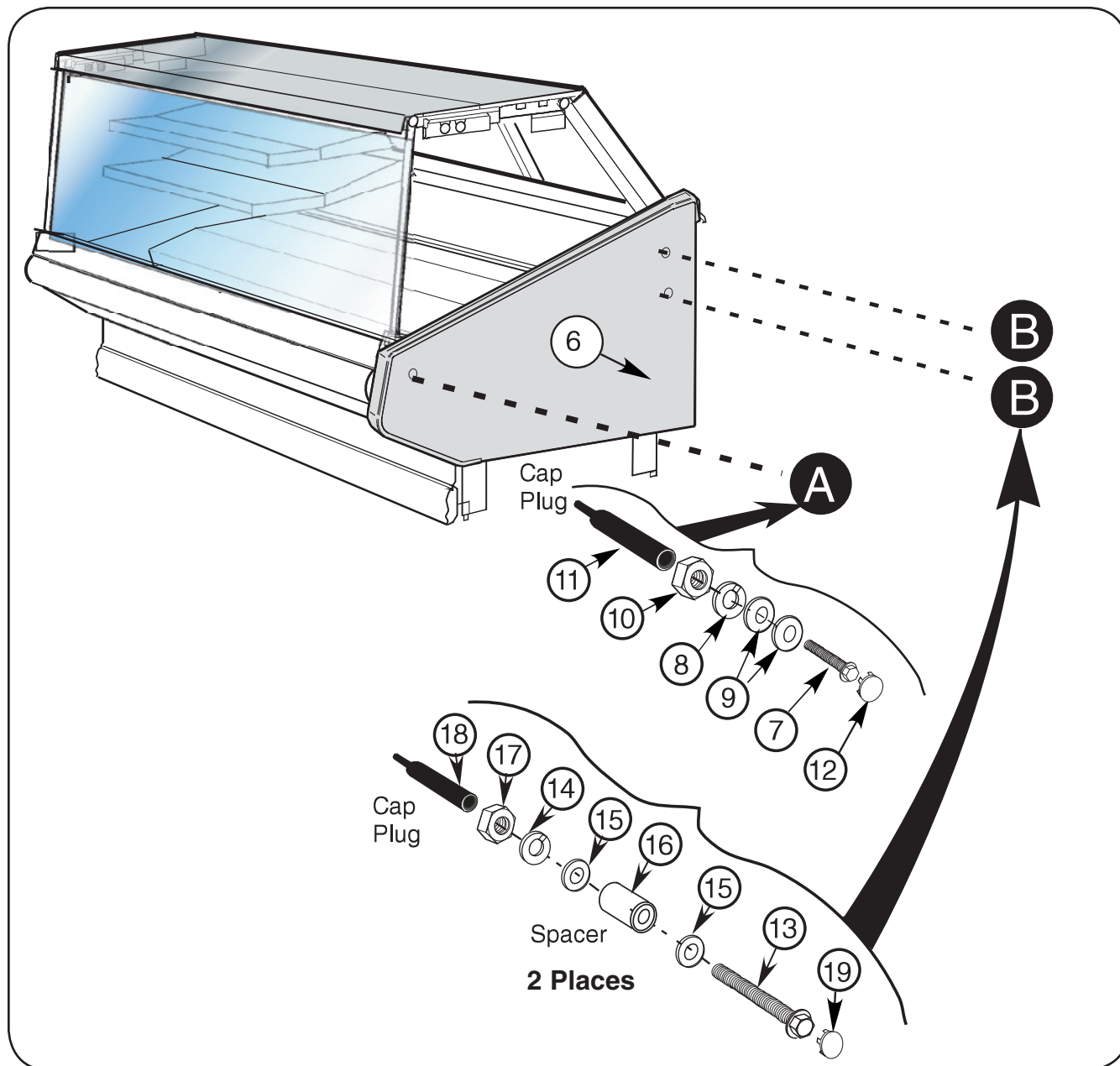

Figure 13. Installing Solid End with Glass

Installing Glass Channel onto the End

9b Place the clear plastic Channel (Item – 21) on to Glass (Item – 20) and position on top of the end panel. Align holes for mounting the glass to the case.
Mark location of channel on the end and remove glass from the channel.
See Figure 14.

9c Mount clear plastic Channel (Item – 21) flush with inside edge of end trim.
Using Screws (Item – 22) mount the channel to the top of the end trim.
See Figure 14.

Note: Screws must be centered in the channel to clear the glass.

9d Seal Glass at ends of channel with Silicone Sealant (Item – 3).

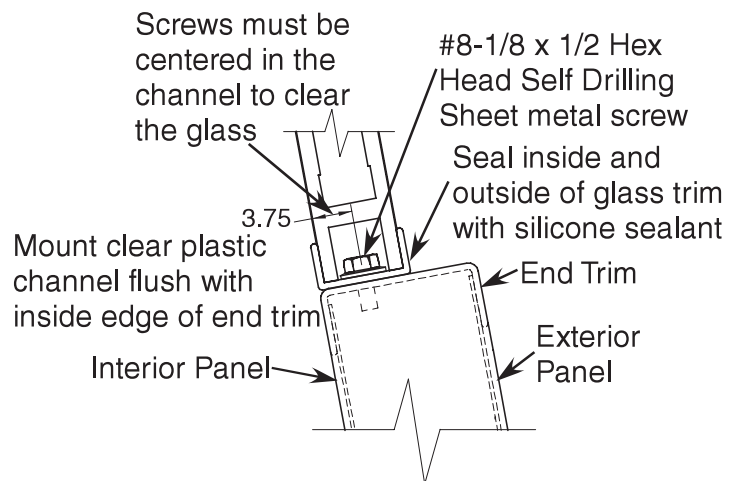
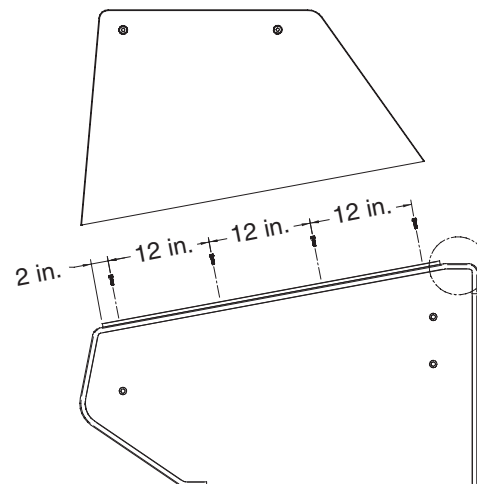
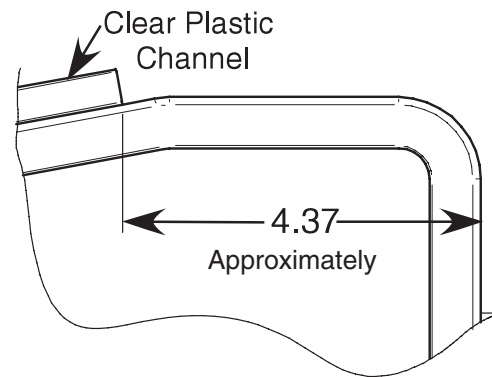

Figure 14. Installing Glass End

9e

Place **Glass (Item – 20)** into channel and fasten to the case using, **Cap Screws (Items – 23, 29)** and **Lock Washers (Items – 24, 30)**.

Flat Washers (Items – 25, 31), Hex Nut (Item – 26), Nut Retainer (Item – 32), Cap Plug (Item – 27) and Plug Button (Items – 28, 33)
See Figure 15.

9f

Go back and follow Steps 10 through 19 in the front section of this instruction to complete installation of Glass End.

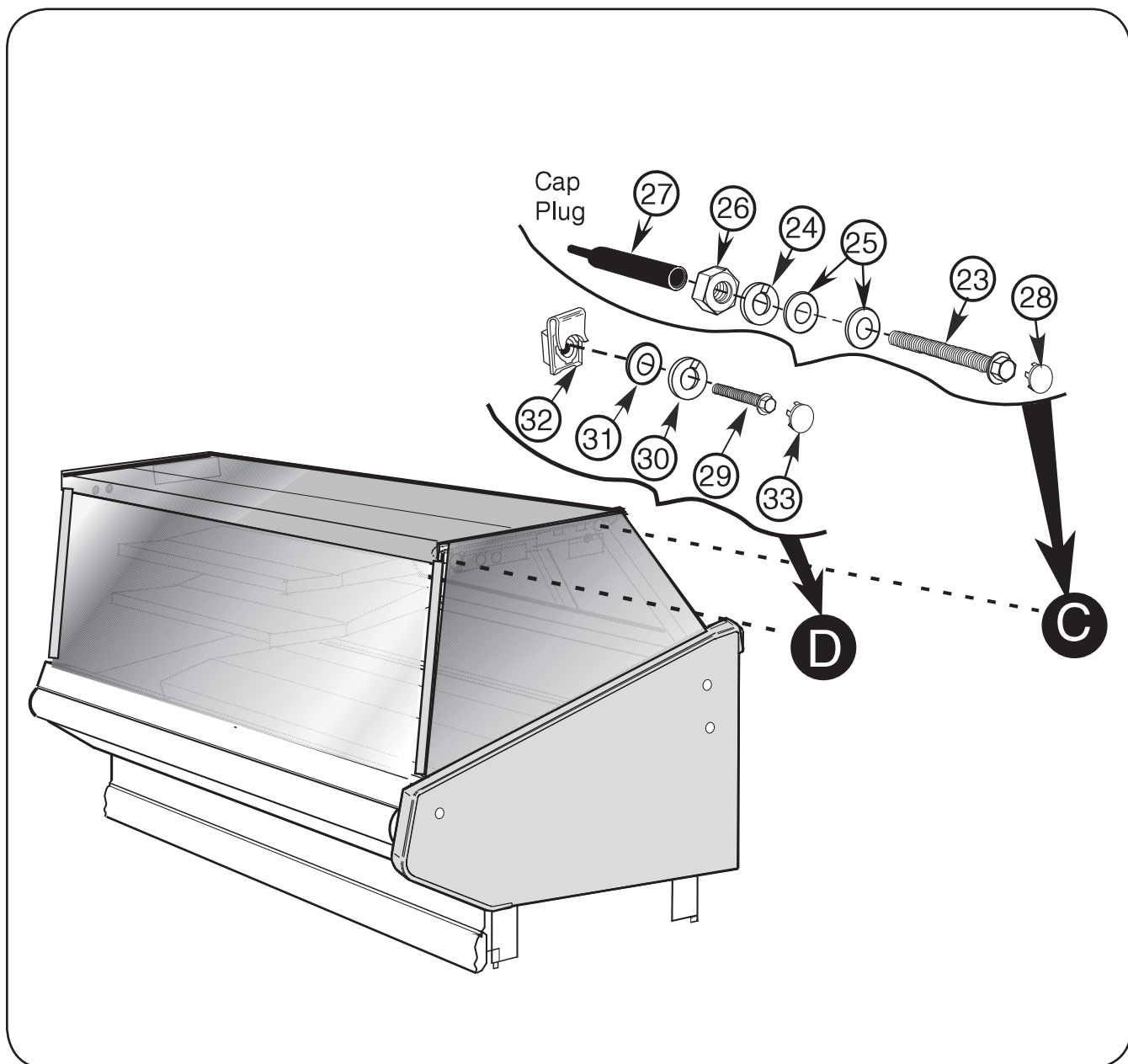

Figure 15. Installing Glass End onto Case

