

HUSSMANN®



HSD ***Sliding Glass Top & Solid Top*** ***Freezer / Cooler Chests***



HSD/SC-Y



HSD/SC



HSD/SC/P

Installation & ***Service Manual***

IMPORTANT
Keep in store for future reference!

P/N 2402294_C

July 2011



ATTENTION

Merchandiser must operate for 24 hours
before loading product!

Regularly check merchandiser temperatures.

Do not break the cold chain. Keep products
in cooler before loading into merchandiser.

These merchandisers are designed
for pre-frozen or pre-chilled products only.



IMPORTANT
KEEP IN STORE FOR FUTURE REFERENCE
Quality that sets industry standards!

HUSSMANN® 12999 St. Charles Rock Road • Bridgeton, MO 63044-2483
U.S. & Canada 1-800-922-1919 • Mexico 1-800-522-1900

www.hussmann.com

© 2011 Hussmann Corporation

TABLE OF CONTENTS

v

ANSI DEFINITIONS	vi	START UP / OPERATION	
INSTALLATION		Start-Up	3-1
Certification	1-1	Controls and Adjustments	3-1
Husmann Product Control	1-1	Load Limits	3-2
Shipping Damage	1-1	Stocking	3-2
Location	1-1		
Self Contained Location	1-2	MAINTENANCE	
Model Description	1-3	Care and Cleaning	4-1
Unloading	1-3	Do NOT Use:	4-1
Exterior Loading	1-3	Do:	4-1
Merchandiser Leveling	1-3	Glass Lids	4-2
Casters	1-3	Cleaning Coils	4-2
Serial Plate Location	1-3		
Sliding Doors	1-4	SERVICE	
Baskets	1-4	Troubleshooting Guide	5-1
Refrigeration Unit Access	1-4	Warnings	5-2
Interior Liner	1-4		
Sealing Merchandiser to Floor	1-4		
ELECTRICAL / REFRIGERATION		APPENDIX	
Merchandiser Electrical Data	2-1	Ordering Parts	A-1
Field Wiring	2-1	HSD/SC Plan View	A-3
Electrical Connections	2-1	HSD/SC/Y Plan View	A-4
Electrical Outlet	2-1	HSD/SC/P Plan View	A-5
Refrigeration (Self Contained)	2-1	HSD/BY Plan View	A-6
Drain	2-2	Refrigeration Data	A-7
Defrost	2-2	Electrical Data	A-8
Temperature Control	2-2		

WARRANTY

REVISION HISTORY

REVISION A — JULY 2011

- 1. Added Appendix A, Technical Data

ANSI Z535.5 DEFINITIONS



• **DANGER** – Indicate[s] a hazardous situation which, if not avoided, will result in death or serious injury.



• **WARNING** – Indicate[s] a hazardous situation which, if not avoided, could result in death or serious injury.



• **CAUTION** – Indicate[s] a hazardous situation which, if not avoided, could result in minor or moderate injury.

• **NOTICE** – *Not related to personal injury* – Indicates[s] situations, which if not avoided, could result in damage to equipment.

INSTALLATION

CERTIFICATION

These merchandisers are manufactured to meet ANSI / National Sanitation Foundation (NSF®) Standard #7 requirements. Proper installation is required to maintain certification. Near the serial plate, each case carries a label identifying the type of application for which the case was certified.

**ANSI/NSF-7 Type I - Display Refrigerator / Freezer
Intended for 75°F / 55% RH Ambient Application**

**ANSI/NSF-7 Type II - Display Refrigerator / Freezer
Intended for 80°F / 55% RH Ambient Application**

**ANSI/NSF-7 - Display Refrigerator
Intended for Bulk Produce**

HUSSMANN PRODUCT CONTROL

The serial number and shipping date of all equipment is recorded in Hussmann's files for warranty and replacement part purposes. All correspondence pertaining to warranty or parts ordering must include the serial number of each piece of equipment involved. This is to ensure the customer is provided with the correct parts.

SHIPPING DAMAGE

All equipment should be thoroughly examined for shipping damage before and during unloading. This equipment has been carefully inspected at our factory. Any claim for loss or damage must be made to the carrier. The carrier will provide any necessary inspection reports and/or claim forms.

Apparent Loss or Damage

If there is an obvious loss or damage, it must be noted on the freight bill or express receipt and signed by the carrier's agent; otherwise, carrier may refuse claim.

Concealed Loss or Damage

When loss or damage is not apparent until after equipment is uncrated, retain all packing materials and submit a written response to the carrier for inspection within 15 days.

LOCATION

These merchandisers are designed for displaying products in air conditioned stores where temperature is maintained at or below the ANSI / NSF-7 specified level and relative humidity is maintained at or below 55%.

**HSD recommended operating ambient temperature is between 65°F (18°C) and 75°F (23.9°C).
Maximum relative humidity is 55%.**

Placing refrigerated merchandisers in direct sunlight, near hot tables or near other heat sources could impair their efficiency. Like other coolers, these merchandisers are sensitive to air disturbances. Air currents passing around merchandisers will seriously impair their operation. Do NOT allow air conditioning, electric fans, open doors or windows, etc. to create air currents around the merchandiser.

1-2 INSTALLATION

SELF CONTAINED (LOCATION)

HSD merchandisers require a 5 in. clearance at the front, rear and air exhaust side. Do not block air intake or exhaust areas. Keep air intake free from warm air currents.

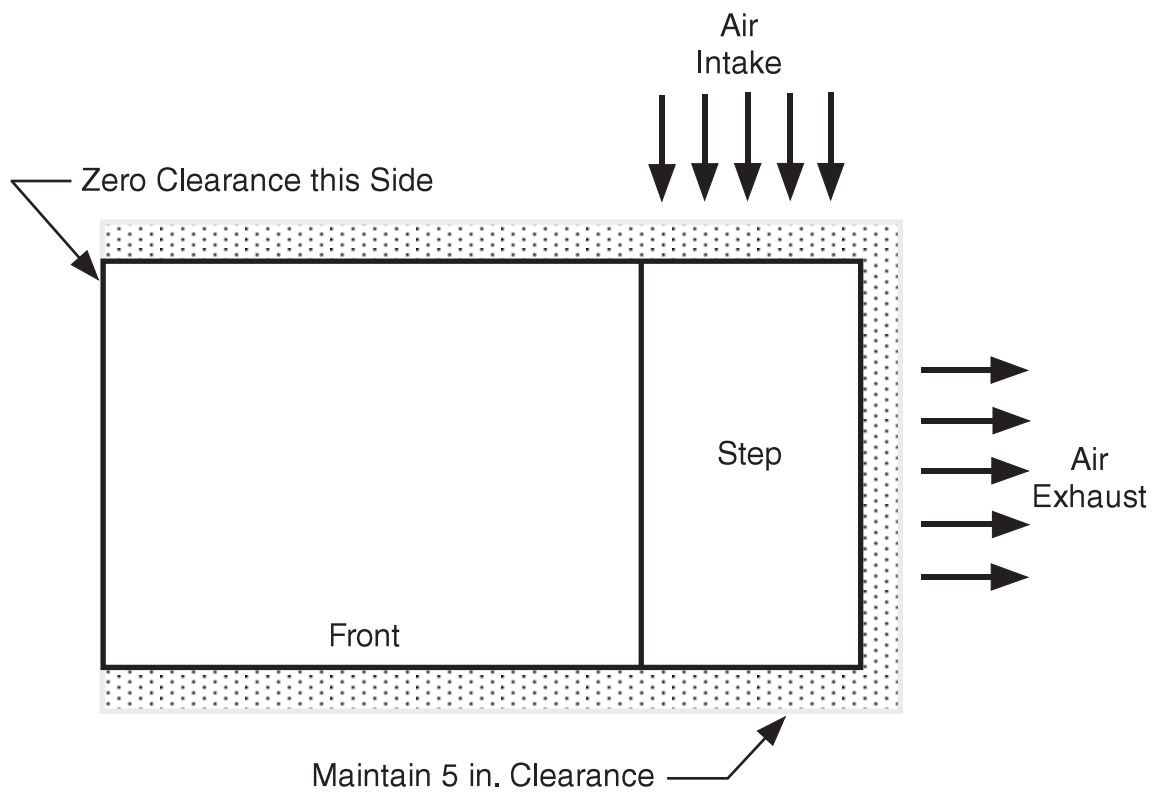

MODEL DESCRIPTION

HSD models have versatile product temperature ranges. These models can be used for display of ice cream at sub zero temperatures (-10° F). It can also be used to store frozen foods or to cool products at medium (refrigerator) temperatures.



CAUTION

Do not walk or put heavy objects on case.

Move the merchandiser as close as possible to its permanent location and remove all packaging. Check for damage before discarding packaging.

Improper handling may cause damage to the merchandiser when unloading. To avoid damage:

1. Do not drag the merchandiser out of the trailer. Use a Johnson bar (mule).
2. Use a forklift or dolly to remove the merchandiser from the trailer.

EXTERIOR LOADING

MERCHANDISERS ARE NOT STRUCTURALLY DESIGNED TO SUPPORT EXTERNAL LOADING such as the weight of a person. Do not place heavy objects on the merchandiser.

MERCHANDISER LEVELING

BE SURE TO POSITION MERCHANDISERS PROPERLY. Level the merchandiser by all four corners. Merchandiser(s) must be installed level to ensure proper operation of the refrigeration system.

CASTERS

These merchandiser are shipped with four swivel casters attached to each underside corner of the merchandiser. The front two casters can be locked in place. Push firmly on the caster's plastic flange to lock the caster in place. Pull up on the flange to unlock the caster. The casters have high-quality sealed bearings that do not require any oiling or maintenance.



SERIAL PLATE LOCATION

The serial plate is located on the back rear side of the merchandiser. The serial plate contains all pertinent refrigeration and electrical information. The merchandiser's serial number is printed on a sticker next to the serial plate. This number should be provided when ordering replacement parts.

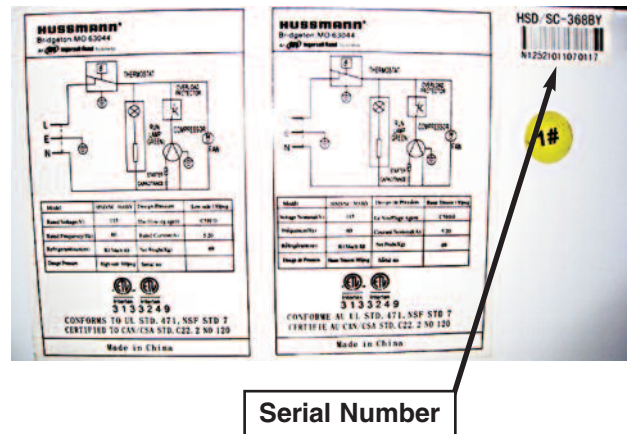

Serial Number

1-4 INSTALLATION

SLIDING DOORS

Sliding doors are shipped installed. Remove all packaging, and make sure the doors open freely. Doors should remain closed as often as possible during operation.

BASKET

Each HSD merchandiser is shipped with one standard hanging basket. Additional baskets may be ordered. See literature brochures for sizes and quantities of baskets for each specific model.

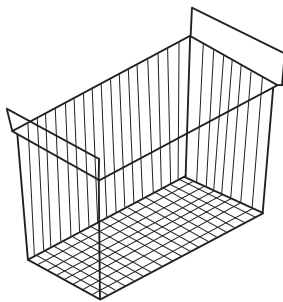

REFRIGERATION UNIT ACCESS

The access panel on the base of the cabinet provides access to the condensing unit and electrical box. Remove the access panel screws to service.

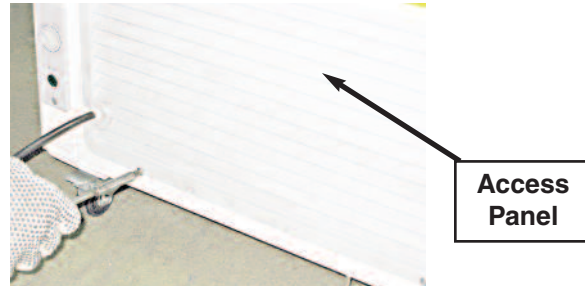

INTERIOR LINER

The liner is made of durable pattern aluminum. Do not fasten anything to the interior or exterior walls of these merchandisers. Doing so may puncture a refrigeration line.

SEALING MERCHANDISER TO FLOOR

If required by local sanitary codes, or if the customer desires, merchandisers may be sealed to the floor using a vinyl cove base trim. The size needed will depend on how much variation there is in the floor, from one end of the merchandiser to the other. Sealing of the lower front and rear panels on self contained models may hamper their removal for servicing or maintenance of the condensing unit.

NOTE: Do not allow trim to cover any intake or discharge grilles.

WARNING

— LOCK OUT / TAG OUT —

To avoid serious injury or death from electrical shock, always disconnect the electrical power at the main disconnect when servicing or replacing any electrical component. This includes, but is not limited to, such items as doors, lights, fans, heaters, and thermostats.

ELECTRICAL / REFRIGERATION

MERCHANDISER ELECTRICAL DATA

Refer to Appendix A of this manual or the merchandiser’s serial plate for electrical information.

FIELD WIRING

Field wiring must be sized for component amperes stamped on the serial plate. Actual ampere draw may be less than specified.

ALWAYS CHECK THE SERIAL PLATE FOR COMPONENT AMPERES

ELECTRICAL CONNECTIONS

HSD models have a power cord attached to the unit with a ground prong. The cord is rated 115V / 15 Amp.

All of these models are 60hz, 1ph. Connecting this unit to any electrical supply other than specified on the serial plate will void the warranty and may result in serious damage to the unit. The cabinet should be supplied with its OWN service.

⚠ WARNING
— LOCK OUT / TAG OUT —
To avoid serious injury or death from electrical shock, always disconnect the electrical power at the main disconnect when servicing or replacing any electrical component. This includes, but is not limited to, such items as doors, lights, fans, heaters, and thermostats.

⚠ WARNING
Merchandiser must be grounded.
Do not remove the power supply cord ground.

ELECTRICAL OUTLET:

Before the merchandiser is connected to any wall circuit, use a voltmeter to check that the outlet is at 100% of the rated voltage. The wall circuit must be dedicated for the merchandiser. Failure to do so voids the warranty. Do not use an extension cord. Never plug in more than one merchandiser per electrical circuit.

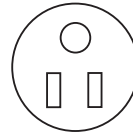

NEMA 5-15P Receptacle
All Models

- Always use a dedicated circuit with the amperage stated on the unit.
- Plug into an outlet designed for the plug.
- Do not overload the circuit
- Do not use long or thin extension cords. Never use adapters.
- If in doubt, call an electrician.

⚠ CAUTION
Risk of Electric Shock. If cord or plug becomes damaged, replace only with a cord and plug of the same type.

REFRIGERATION (Self Contained Models)

Each self contained model is equipped with its own condensing unit and control panel located beneath the display area. The correct type of refrigerant will be stamped on each merchandiser’s serial plate. The merchandiser refrigeration piping is leak tested. The unit is charged with refrigerant, and shipped from the factory with all service valves open.

DRAIN

A 1-inch drain is provided on the cabinet floor that runs to the outside of the cabinet where it is capped. The exterior drain cap must be in place when the merchandiser is in operation.

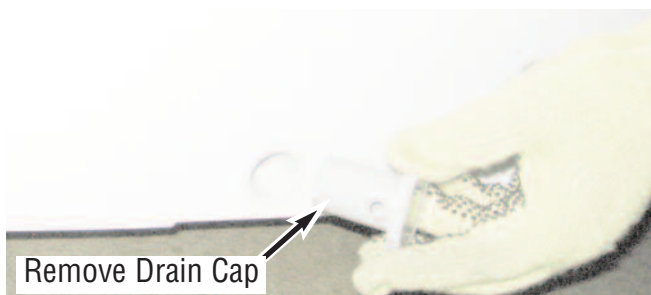
**DEFROST**

These merchandisers require manual defrost. When defrosting is necessary, disconnect electrical power to the merchandiser. Remove all products. Remove drain plug. Attach a hose, or use a pan before melting ice begins to drip out of the drain.

Do not remove frost with a pick, knife or by scraping with a sharp object. Do not allow water to drain on the floor. Clean the inside when the unit is finished defrosting. Install the plug on the drain tube, and connect the unit to the correct power supply.

**WARNING**

Product will be degraded and may spoil if allowed to sit in a non-refrigerated area.

TEMPERATURE CONTROL

An adjustable thermostat is provided for either medium temperature or low temperature operation. The thermostat is easily reached by removing the plastic cover located on the base. For low temperature operation, turn the screw on the thermostat clockwise. In the full clockwise position, the compressor will run 100% of the time. For medium temperature, set control screw midway between full clockwise and full counter clockwise.

**WARNING**

Refrigeration lines are under pressure. Refrigerant must be recovered before attempting any connection or repair.

START UP / OPERATION

START UP

Follow the electromechanical controls start up procedures as detailed in Section 2 of this manual.

- a. Inspect the refrigeration lines for visible damage or chafing.
- b. Turn on the electrical power, by plugging in the merchandiser. The merchandiser must pull down in temperature.
- c. For units that have condenser fans, make sure the blade is rotating.

Allow merchandiser 24 hours to operate before loading product.



Temperature Control

CONTROLS and ADJUSTMENTS

Refrigeration Controls		Defrost Controls			
Model	Product Application	Defrost Frequency	Type of Defrost	Temp. Termination	Failsafe Time (Minutes)
HSD (Self Contained)	Low & Med. Temp. (Frozen Food)	When Required	Manual	N/A	N/A

1. The T-stat controller controls refrigeration temperature. This is factory installed in the control panel.

Defrosts are manual and required when a layer of ice builds up on the interior walls.

LOAD LIMITS

Each merchandiser has a load limit decal. Shelf life of perishables will be short if load limit is violated.



AT NO TIME SHOULD MERCHANDISERS BE STOCKED BEYOND THE LOAD LIMITS INDICATED.

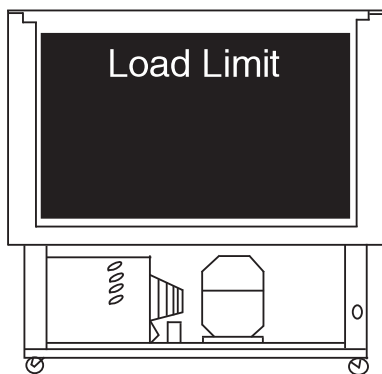

STOCKING

Product should NOT be placed inside the merchandisers until merchandisers are at proper operating temperature.

Allow merchandiser 24 hours to operate before loading product.

Proper rotation of product during stocking is necessary to prevent product loss. Always bring the oldest product to the top and set the newest to the bottom.



MAINTENANCE

CARE AND CLEANING

Long life and satisfactory performance of any equipment is dependent upon the care it receives. To ensure long life, proper sanitation and minimum maintenance costs, these merchandisers should be thoroughly cleaned, all debris removed and the interiors washed down, weekly.

Exterior Surfaces

The exterior surfaces must be cleaned with a mild detergent and warm water to protect and maintain their attractive finish. **NEVER USE ABRASIVE CLEANSERS OR SCOURING PADS.**

Interior Surfaces

The interior surfaces may be cleaned with most domestic detergents, ammonia based cleaners and sanitizing solutions with no harm to the surface. Self contained models empty into a limited capacity evaporation pan, which will overflow if excess water is used in cleaning.

Do NOT Use:

- Abrasive cleansers and scouring pads, as these will mar the finish.
- Coarse paper towels on coated glass.
- Ammonia-based cleaners on acrylic parts.
- Solvent, oil or acidic based cleaners on any interior surfaces.
- Do not use high pressure water hoses.



WARNING

Product will be degraded and may spoil if allowed to sit in a non-refrigerated area.

Do:

- Disconnect electrical power before cleaning.**
- Remove the product and all loose debris to avoid clogging the waste outlet.
- Store product in a refrigerated area such as a cooler or freezer. Remove only as much product as can be taken to the cooler in a timely manner. **Remove drain cap.**
- Thoroughly clean all surfaces with soap and hot water. **DO NOT USE STEAM OR HIGH WATER PRESSURE HOSES TO WASH THE INTERIOR. THESE WILL DESTROY THE MERCHANDISERS' SEALING CAUSING LEAKS AND POOR PERFORMANCE.**



WARNING

Do NOT allow cleaning agent or cloth to contact food product.

- Do NOT flood merchandiser with water. **NEVER INTRODUCE WATER FASTER THAN THE WASTE OUTLET CAN REMOVE IT.**

REMOVE DRAIN CAP, AND COLLECT WATER DURING THE CLEANING PROCESS IN A PAN. DO NOT ALLOW THE WATER TO DRAIN ON THE FLOOR.

- Allow merchandisers to dry before resuming operation. **Replace drain cap.**
- After cleaning and drying is complete, turn on power to the merchandiser.
- Allow merchandiser to cool down to operating temperature **BEFORE** loading product.

GLASS LIDS

The glass lids are made of tempered, non-heated glass. The lids are not self-closing. The lid tracks must be cleaned periodically to allow the lids to close freely.

**CAUTION**

Do NOT use HOT water on Cold glass Surfaces. This can cause the glass to shatter and could result in personal injury. Allow glass fronts, to warm before applying hot water.

CLEANING COILS

Condenser coils should be cleaned at least once per month. Additional cleaning may be needed depending on the operational environment.

Airflow blockage increases energy consumption and reduces the merchandiser's ability to maintain operating temperature.

To clean coils, use a vacuum cleaner with a wand attachment and a soft (non-metallic) brush to remove dirt and debris. Always wear gloves and protective eye wear when cleaning near sharp fins and dust particles. **Unplug merchandiser before servicing.**

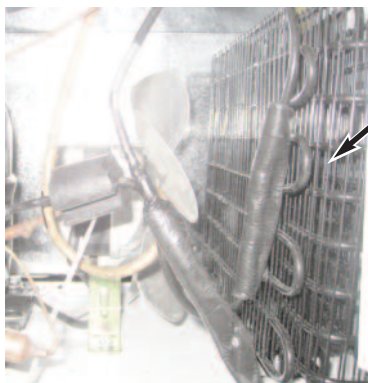

Coils

**CAUTION**

Always Wear gloves and protective eye wear when servicing.

**WARNING**

— LOCK OUT / TAG OUT —

To avoid serious injury or death from electrical shock, always disconnect the electrical power at the main disconnect when servicing or replacing any electrical component. This includes, but is not limited to, such items as doors, lights, fans, heaters, and thermostats.

SERVICE

TROUBLESHOOTING GUIDE

PROBLEM	PROBABLE CAUSE	SOLUTION
<p>Compressor will not start; no noise.</p>	<ol style="list-style-type: none"> 1. Power disconnected 2. Dirty condenser 3. Defective or broken wiring 4. Defective overload 5. Defective temperature control 	<ol style="list-style-type: none"> 1. Check service cord for proper connection 2. Replace fuse or reset breaker 3. Repair or replace 4. Replace 5. Replace
<p>Compressor will not start; cuts out on overload</p>	<ol style="list-style-type: none"> 1. Low voltage 2. Defective compressor 3. Defective relay 4. Restriction pinched cap tube 5. Restriction moisture 6. Inadequate air flow condenser 7. Defective condensers fan motor 	<ol style="list-style-type: none"> 1. See serial plate for proper electrical requirements 2. Replace 3. Replace 4. Repair or replace 5. Leak check replace drier evacuate and recharge 6. Move merchandiser so it has a 5 in. front and back of unit compartment opening 7. Replace

PROBLEM	PROBABLE CAUSE	SOLUTION
Compressor runs continuously; product too cold	<ol style="list-style-type: none"> 1. Defective control 2. Control feeler tube not installed in well 3. Short on refrigerant 	<ol style="list-style-type: none"> 1. Check service cords or wiring connections 2. Push control feeler tube into well 3. Leak check change dryer evacuate and recharge
Compressor runs continuously; product too warm	<ol style="list-style-type: none"> 1. Short on refrigerant 2. Insufficient compressor 	<ol style="list-style-type: none"> 1. Leak check change dryers evacuate and recharge 2. Replace



WARNING

— LOCK OUT / TAG OUT —

To avoid serious injury or death from electrical shock, always disconnect the electrical power at the main disconnect when servicing or replacing any electrical component. This includes, but is not limited to, such items as doors, lights, fans, heaters, and thermostats.



WARNING

Product will be degraded and may spoil if allowed to sit in a non-refrigerated area.

ORDERING PARTS

Contact your Hussmann distributor for instructions for returning parts that are in warranty. Always specify the merchandiser’s model and serial number. Provide a clear description of part itself and its function in the cabinet or remote unit. Provide the original date of cabinet and forward a copy of the original invoice or delivery receipt if possible. Warranty parts must be returned to the factory within 30 days of date of failure.

Item Part #	Description	Model(s) Used On
5-HM-1007	Compressor DG57C84RAU6	HSD/SC-190Y HSD/SC-220Y
5-HM-1008	Compressor DG73C12RAU6	HSD/SC-280Y HSD/SC-320Y HSD/SC-258 HSD/SC-302
5-HM-10035	Compressor (206W) SK182C-L2U	HSD/SC-248BY
5-HM-10036	Compressor (275 W) SK1A1C-L2W	HSD/SC-328BY
5-HM-10037	Compressor (275 W) SK1A1C-L2W	HSD/SC-368BY
5-HM-1006	Compressor LGETR MA53LBCM	HSD/SC-132P
5-HM-2001	Temperature Control WPF27H-102-022-EX	Used on all Models
5-HM-2002	Temperature Control Knob	
5-HM-3002	Condenser Fan Motor M4Q045CA2704	Used on all Models (Except –H)
5-HM-8001	Caster – Non Locking (2)	Used on all Models
5-HM-8002	Caster – Locking (2)	Used on all Models

Sliding Glass Door Part # (Lower)	Sliding Glass Door Upper Part #	Model(s) Used On
5-HM-10001	5-HM-10031	HSD/SC-258
5-HM-10002	5-HM-10015	HSD/SC-302
5-HM-10006	5-HM-10019	HSD/SC-190Y
5-HM-10007	5-HM-10020	HSD/SC-220Y
5-HM-10008	5-HM-10021	HSD/SC-280Y
5-HM-10009	5-HM-10022	HSD/SC-320Y
5-HM-10010	5-HM-10023	HSD/SC-132P
5-HM-10027	5-HM-10031	HSD/SC-248BY
5-HM-10028	5-HM-10032	HSD/SC-328BY
5-HM-10029	5-HM-10033	HSD/SC-368BY

Item Part #	Description	Model(s) Used On
5-HM-12006	Lid Lock Key	HSD/SC-258,302 HSD/SC-132P
5-HM-12007	Lid Lock Key	HSD/SC-190Y, 220Y, 280Y, 320Y
5-HM-12009	Lid Lock Key	HSD/SC-248BY, 328BY, 368BY
5-HM-13001	Opt. Light Fuse 2-Amp	Curved Glass with Lighted Sign
5-HM-15001	Outside Drain Cap	Used on all Models

HSD/SC

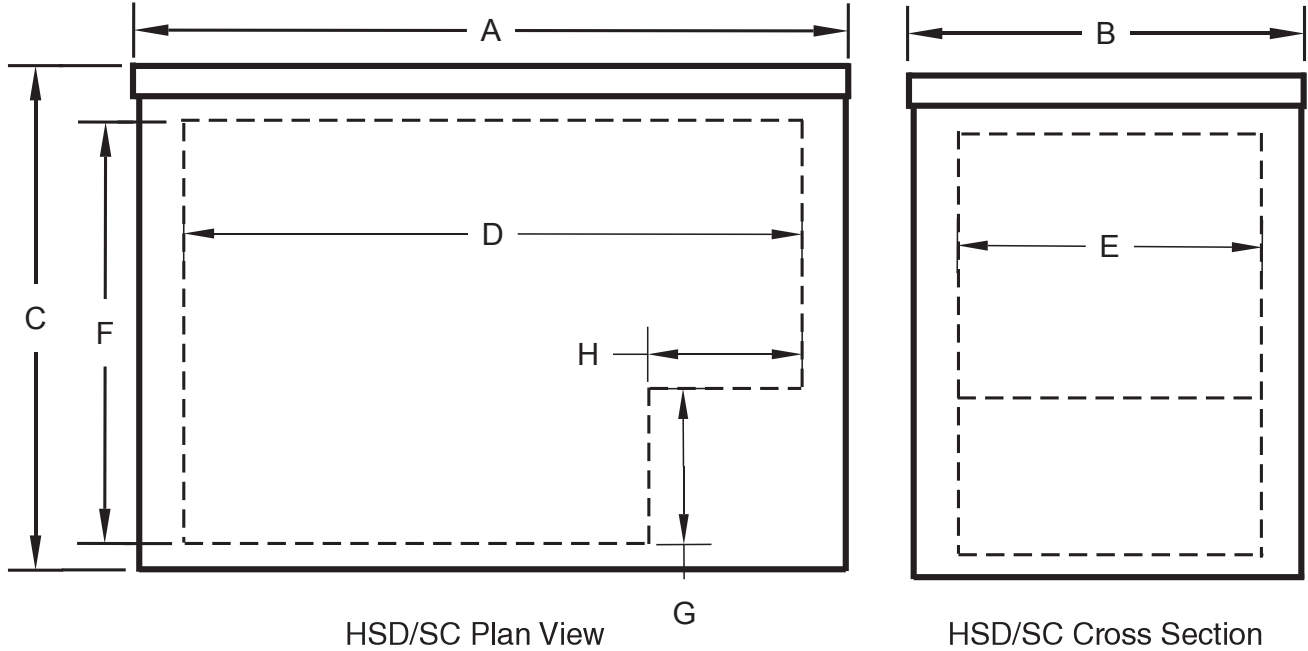

(All Dimensions in inches / feet)

Model	External			Internal				
	A	B	C	D	E	F	G	H
	Length	Depth	Height	Length	Depth	Height	Step Height	Step Width
HSD/SC-258	42.5	23.6	33.8	40.55	18.5	25.59	9.45	9.25
HSD/SC-302	45.7	23.6	33.8	40.55	18.5	25.59	9.45	9.25

* Height includes 2.6 in. casters.

HSD/SC/Y

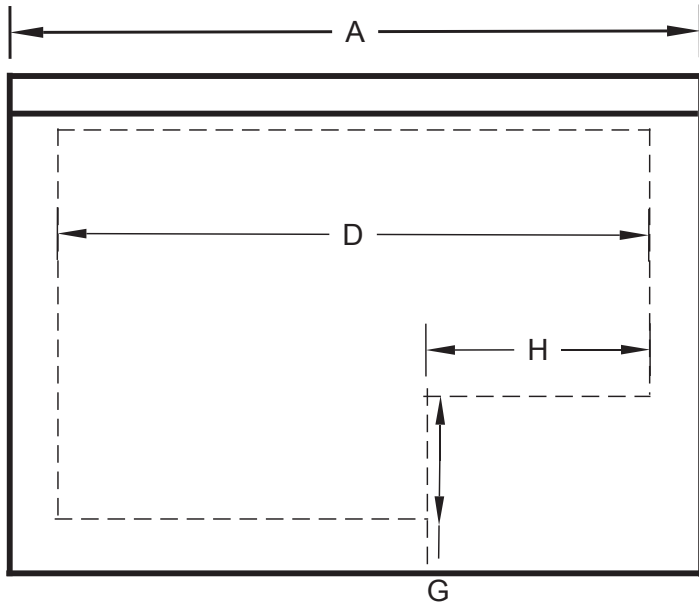

HSD/SC/Y Plan View

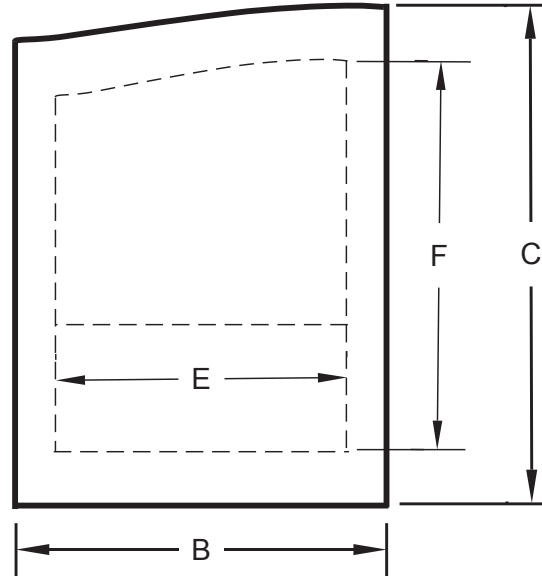

HSD/SC/Y Cross Section

(All Dimensions in inches / feet)

Model	External			Internal				
	A	B	C	D	E	F	G	H
	Length	Depth	Height	Length	Depth	Height	Step Height	Step Width
HSD/SC-190Y	36.5	23.6	34.2	31.26	18.35	24.5	7.93	11.81
HSD/SC-220Y	40.6	23.6	34.2	35.43	18.35	24.5	7.93	11.81
HSD/SC-280Y	48.6	23.6	34.2	43.62	18.35	24.5	7.93	11.81
HSD/SC-320Y	54.4	23.6	34.2	49.21	18.35	24.5	7.93	11.81

* Baskets for curved glass cases will not fit in any other style case. Height includes 2,6 casters.

HSD/SC/P

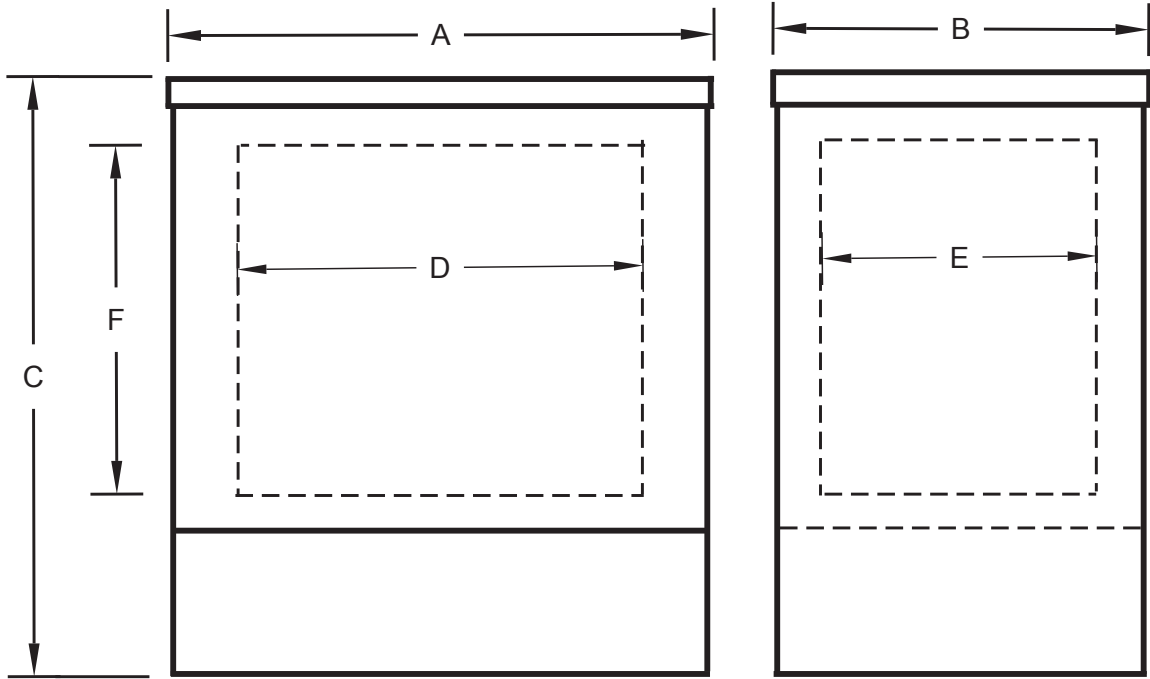

HSD/SC/P Plan View

HSD/SC/P Cross Section

(All Dimensions in inches / feet)						
Model	External			Internal		
	A	B	C	D	E	F
	Length	Depth	Height	Length	Depth	Height
HSD/SC-132P	28.9	21.26	36.3	23.82	16.14	20.59

*Height includes 2.6 casters.

HSD/SC/BY

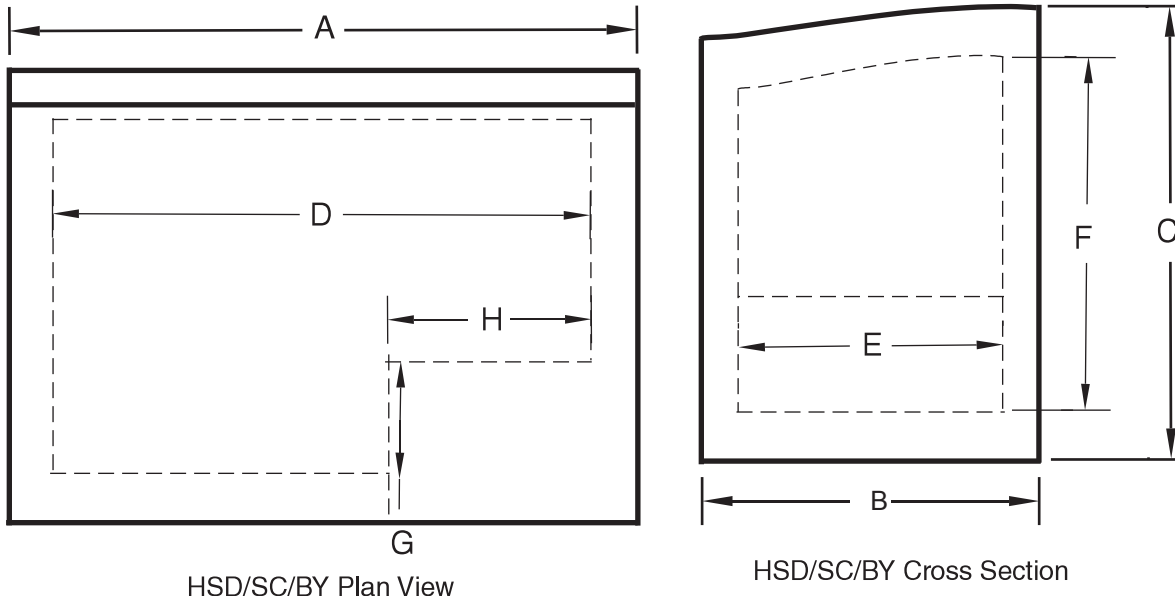

(All Dimensions in inches / feet)

Model	External			Internal				
	A	B	C	D	E	F	G	H
HSD/SC-248BY	40.6	24.4	34.2	35	19	27.75	10.25	11.75
HSD/SC-328BY	48.6	24.4	34.2	43	19	27.75	10.25	11.75
HSD/SC-368BY	54.4	24.4	34.2	48.8	19	27.75	10.25	11.75

* Baskets for curved glass cases will not fit in any other style case. Height includes 2.6 in. casters.

REFRIGERATION DATA

Models: HSD/SC-258, 302 HSD/SC-190Y, 220Y, 280Y, 320Y
 HSD/SC-132P, HSD/SC-248BY, 328BY, 368BY

Setting CI/CO (°F)

All Models

Knob Position	7	6	2.5	2	0
CI (°F)	—	- 4 ± 2.7	6.8 ± 2.7	28.4 ± 2.7	41
CO (°F)	- 20.2	- 16.6 ± 2.7	- 4 ± 2.7	19.4 ± 2.7	32

Condensing Unit Capacity 115V~60Hz

Tested at ASHRAE Standard

Evaporation Temperature: - 10°F (- 23.3°C) Condensing Temperature: - 130°F (- 54.4°C)

Ambient Temperature: 90°F (32.2°C)

<i>HSD/SC-248BY</i>	<i>HSD/SC-328BY</i>	<i>HSD/SC-368BY</i>
278W (950BTU/h)	352W (1202BTU/h)	352W (1202BTU/h)

DEFROST DATA

Frequency: **Manual Defrost**
 (as needed)

PHYSICAL DATA

Refrigerant Charge Refrigerant charge is subject to change. Check the unit serial plate location on the rear of the case for the type and amount of refrigerant used

134A Refrigerant

<i>HSD/SC-190Y</i>	<i>HSD/SC-220Y</i>	<i>HSD/SC-280Y</i>	<i>HSD/SC-320Y</i>
5.82oz (165g)	6.35oz (180g)	7.58oz (215g)	8.29oz (235g)
<i>HSD/SC-258</i>	<i>HSD/SC-302</i>	<i>HSD/SC-132P</i>	
5.64oz (160g)	6oz (171g)	3.17oz (90g)	
<i>HSD/SC-248BY</i>	<i>HSD/SC-328BY</i>	<i>HSD/SC-368BY</i>	
5.64oz (160g)	6.53oz (185g)	6.88oz (195g)	

Note: This data is based on store temperature and humidity that does not exceed 80°F and 55% R.H. unless otherwise stated. Schedule defrost at night while lights are off.

Electrical Data

Note: These are rated values for individual components and should not be added together to determine total merchandiser electrical load.

Condensing Unit (115V, 1Ph, 60Hz) Standard

	<i>HSDISC248BY</i>	<i>HSDISC328BY</i>
Compressor LRA	16.5A	24.6A
Compressor RLA	2.18A	3.5A

ESTIMATED SHIPPING WEIGHT ¹**Case:**

<i>HSDISC-190Y</i> 128 lb (58.1kg)	<i>HSDISC-220Y</i> 137 lb (62kg)	<i>HSDISC-280Y</i> 150 lb (68kg)	<i>HSDISC-320Y</i> 159 lb (72.1kg)
<i>HSDISC-258</i> 104 lb (47.2kg)	<i>HSDISC-302</i> 110 lb (49.9kg)	<i>HSDISC-132P</i> 92 lb (41.7kg)	
<i>HSDISC-248BY</i> 137 lb (62 kg)	<i>HSDISC-328BY</i> 172 lb (78kg)	<i>HSDISC-368BY</i> 181 lb (82kg)	

¹Actual weights will vary according to optional kits included

A decorative border in blue, consisting of a repeating geometric pattern of interlocking squares and lines, framing the entire page.

HUSSMANN[®]

To obtain warranty information
or other support, contact your
Husmann representative.
Please include the model and
serial number of the product.

Husmann Corporation
Ingersoll Rand Climate Solutions
12999 St. Charles Rock Road
Bridgeton, MO 63044

www.husmann.com

Husmann Corporation
Ingersoll Rand Climate Solutions
12999 St. Charles Rock Road
Bridgeton, MO 63044

www.husmann.com