

HUSSMANN®



Shelf Installation 30 x 75 Innovator Door



BEFORE YOU BEGIN
Read these instructions completely and carefully.



PERSONAL PROTECTION EQUIPMENT (PPE)

Personal Protection Equipment (PPE) is required whenever servicing this equipment. Always wear safety glasses, gloves, protective boots or shoes, long pants, and a long-sleeve shirt when handling glass, or heavy metal objects such as shelving. Do not climb or stand on shelves.

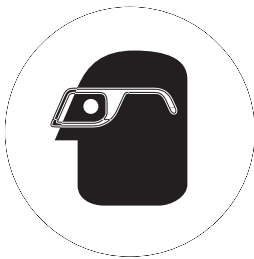

IMPORTANT
KEEP IN STORE FOR FUTURE REFERENCE
Quality that sets industry standards!

12999 St. Charles Rock Road • Bridgeton, MO 63044-2483

U.S. & Canada 1-800-922-1919 • Mexico 01-800-890-2900

www.hussmann.com

© 2018 Hussmann Corporation

P/N 2402372_C

Spanish 3031513

August 2018

Requirements:

1. Two to Three people.
2. Correct number of posts.
3. Desired number of shelves. (generally, 5 shelves per door minimum)
4. No tools necessary in assembly of shelves.

Getting Started:

Select desired post height by adjusting the post leveling bolts found at the bottom of the posts. Make sure that this post height is consistent on all of the posts.



This warning does not mean that Hussmann products will cause cancer or reproductive harm, or is in violation of any product-safety standards or requirements. As clarified by the California State government, Proposition 65 can be considered more of a 'right to know' law than a pure product safety law. When used as designed, Hussmann believes that our products are not harmful. We provide the Proposition 65 warning to stay in compliance with California State law. It is your responsibility to provide accurate Proposition 65 warning labels to your customers when necessary. For more information on Proposition 65, please visit the California State government website.

Place one post, with seams facing the frame's retaining bracket, up against the retaining bracket. Pick up a metal clip, and slide it down the vertical post until it rests next to the bottom frame-retaining bracket. Fasten 8-18 x 1/2" screws through the clearance holes in the clip into the post to secure it.

In order to secure the post to the top-retaining bracket, pick up another clip and repeat the same process by sliding the clip down the post until it rests next to the top frame-retaining bracket. Fasten 8-18 x 1/2" screws through the top clip into the post to finish securing it to the frame. Repeat this process until all front posts are attached to frame. (See pictures below for more detail).



First Stand Procedure:

1. Locate materials.

- a. Locate 2 posts to be placed behind the 2 front posts attached to frame.
- b. Locate shelves and/or shelf spacers.

2. Standing the posts upright.

- a. Stand back post upright. (See picture below)
- b. Orientate the back posts so that seams are facing toward the frame. Adjust the post to desired height with the leg leveling bolts found at the bottom.

NOTE:
Multiple shelf depth configurations may require a third row of posts to properly distribute the weight.

- i. For 24" & 27" shelves, hook the spacer in between the two posts to determine the back post's distance from the front post.
- ii. For shelves larger than 27" deep, use the shelves to determine the back post's distance from the front post. Insert the bottom shelf's front hooks into the 2 front posts at the desired level.

For all-level or all-gravity feed shelf configurations position the back post so that the rear-most shelf hook is inserted into the post.

For mixed level and gravity feed shelf configurations position the back post so that the rear-most shelf hook of the inclined shelf is inserted into the post.

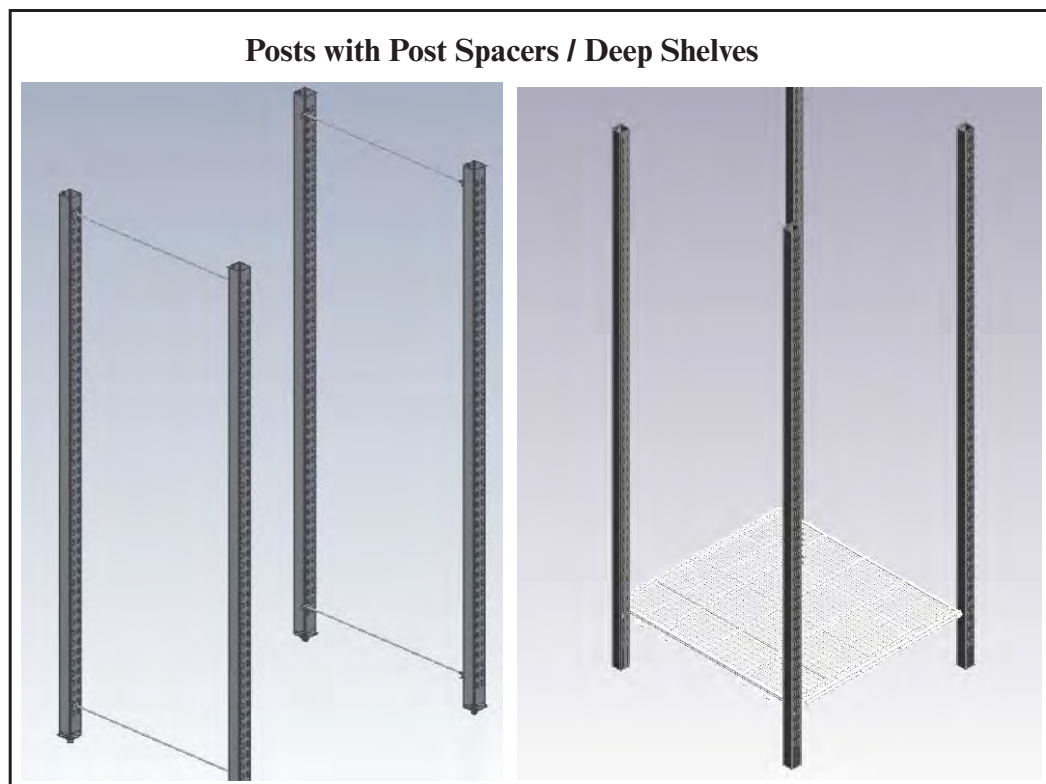

3. Place the remaining shelves.

a. Insert the shelves from the rear of the stand. (The shelf hooks point toward the front of the shelf.) To provide gravity feed, angle the shelf downward by hooking it into a higher hook point on the back post than the hook point of the front post.

b. Once the shelves are in place, the stand is complete.

c. Check if rear post leveling bolts are adjusted to desired level.

4. Continue building stands.

a. Locate an additional back post.

b. Repeat steps 1 through 4.

c. Repeat process until the desired number of stands is achieved. Make sure to check that rear post leveling bolts are adjusted to desired height.

 **CAUTION**

Excessive ambient conditions may cause condensation and therefore sweating of doors. Facility operators should monitor doors and floor conditions to ensure safety of persons.

Full Stand of Shelves (5 Doors)

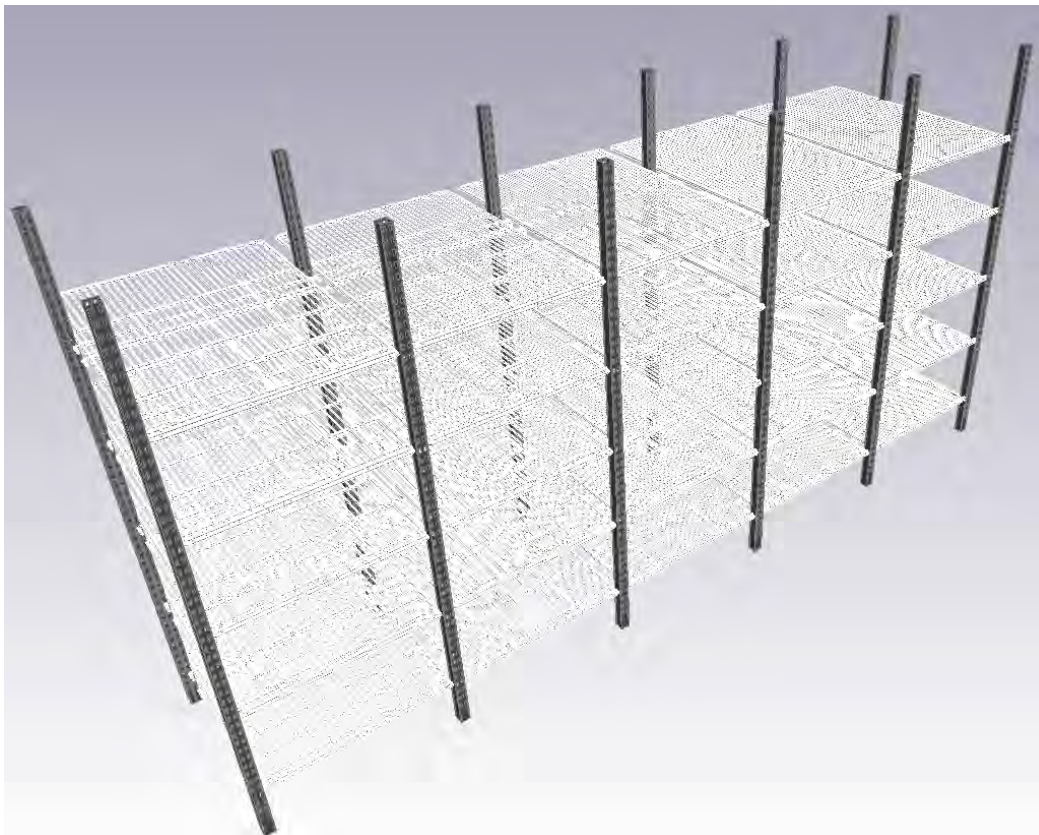



HUSSMANN®

**To obtain warranty information
or other support, contact your
Hussmann representative.
Please include the model and
serial number of the product.**

Hussmann Corporation, Corporate Headquarters: Bridgeton, Missouri, U.S.A. 63044-2483 01 October 2012

Hussmann Corporation

12999 St. Charles Rock Road
Bridgeton, MO 63044-2483
www.hussmann.com

