



HUSSmann®

BSM, GSM & GSS

End Kit Instruction
(Modified for IMPACT)

NSF® Certified



Curved Glass Meat, Delicatessen
and Seafood Merchandisers

P/N 414115
February, 1999

END KIT—SOLID

PARTS LIST—Solid Ends

Item	Quantity			Description
	GSM	BSM	GSS	
1.	3	3	3	Nut Retainer $\frac{5}{16}$ -18
2.	2	2	2	Gasket $\frac{1}{2}$ x 1 x 120
3.	1	1	1	End Assembly
4.	3	3	3	Cap Screw $\frac{5}{16}$ -18 x 1 $\frac{3}{4}$
5.	3	3	3	Flat Washer $\frac{5}{16}$
6.	3	3	3	Cap Plug
7.	3	3	3	Plug Button
8.	14	14	15	Phillips Head Sheet Metal Screw #8 x $\frac{1}{2}$ AB
9.	1	1	1	Top Glass End Trim
10.	1	1	1	Front Shelf Support End Trim
11.	1	1	1	Front Rail End Trim
12.	1	1	1	Upper Front End Trim
13.	1	1	1	Front Panel End Trim
14.	1	1	1	Frame End Trim
15.	1	1	1	Rear Panel End Trim
16.	1	1	1	Top Rear End Trim
17.	1	1	1	Inner Bottom End Trim
18.	-	-	1	Inner Front End Trim GSS (only
19.	2	2	2	End Bracket
20.	7	7	7	Hex Head Sheet Metal Screws 8 x $\frac{1}{2}$
21.	8	8	8	End Splashguard Retainer
22.	1	1	1	LH-End Splashguard
23.	1	1	1	LH-Lower End Panel
24.	1	1	1	RH-End Splashguard
25.	1	1	1	RH-Lower End Panel

NOTE: Parts below this line are not included in End Kit but are shown to clarify installation

26.	2	2	2	Front Splashguard Retainer (3 on 12ft)
27.	2	2	2	Lower Front Panel Retainer
28.	1	1	1	Front Splashguard
29.	1	1	1	Front Panel
30.	7	7	7	Hex Head Sheet Metal Screws 8 x $\frac{1}{2}$

STEP 1. Prepare end frames.

- A. Install **Nut Retainers – 1** into all three locations in end frame of merchandiser as shown.

NOTE: GSM model shown in all figures except where noted.

- B. Apply **Gasket – 2** around perimeter of merchandiser as shown.

- Apply gasket to metal surfaces only
- Apply gasket so it is *flush* with the end frame of the case leaving no gaps in compliance with NSF® (National Sanitation Foundation).
- Avoid splicing gasket on horizontal surfaces.
- Do not stretch gasket, especially around corners.
- Remove paper backing after gasket is applied.

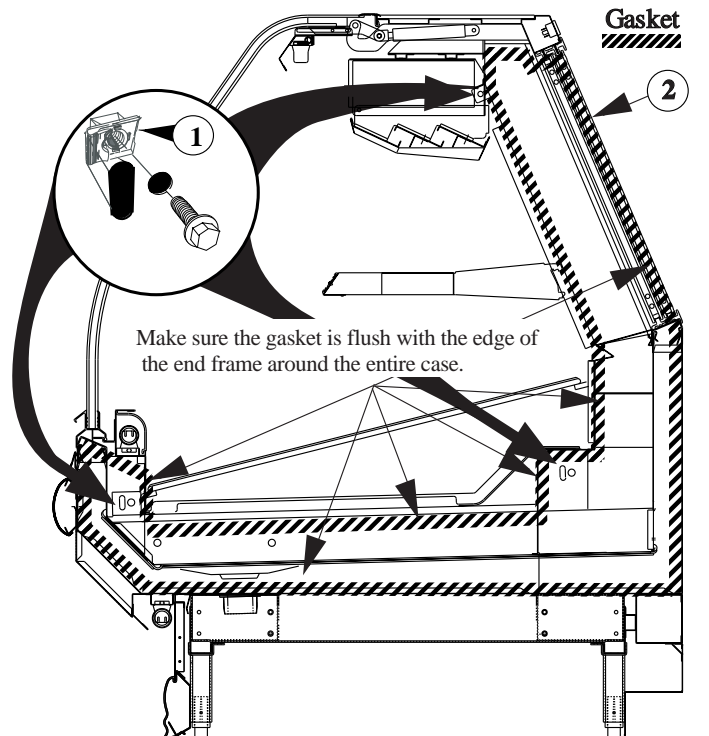
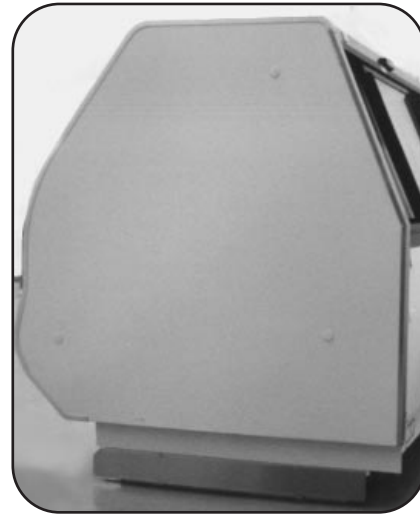

Figure 1. Installing Nut Retainers and Gasket

STEP 2. Fasten **End Assembly – 3**
to merchandiser using
Cap Screws – 4
Flat Washers – 5
Cap Plug – 6.

NOTE: Be sure to tighten screws
to 10–15 ft/lb.

After end assembly has been
tightened, insert **Plug Buttons – 7**
over cap screws.



End Assembly

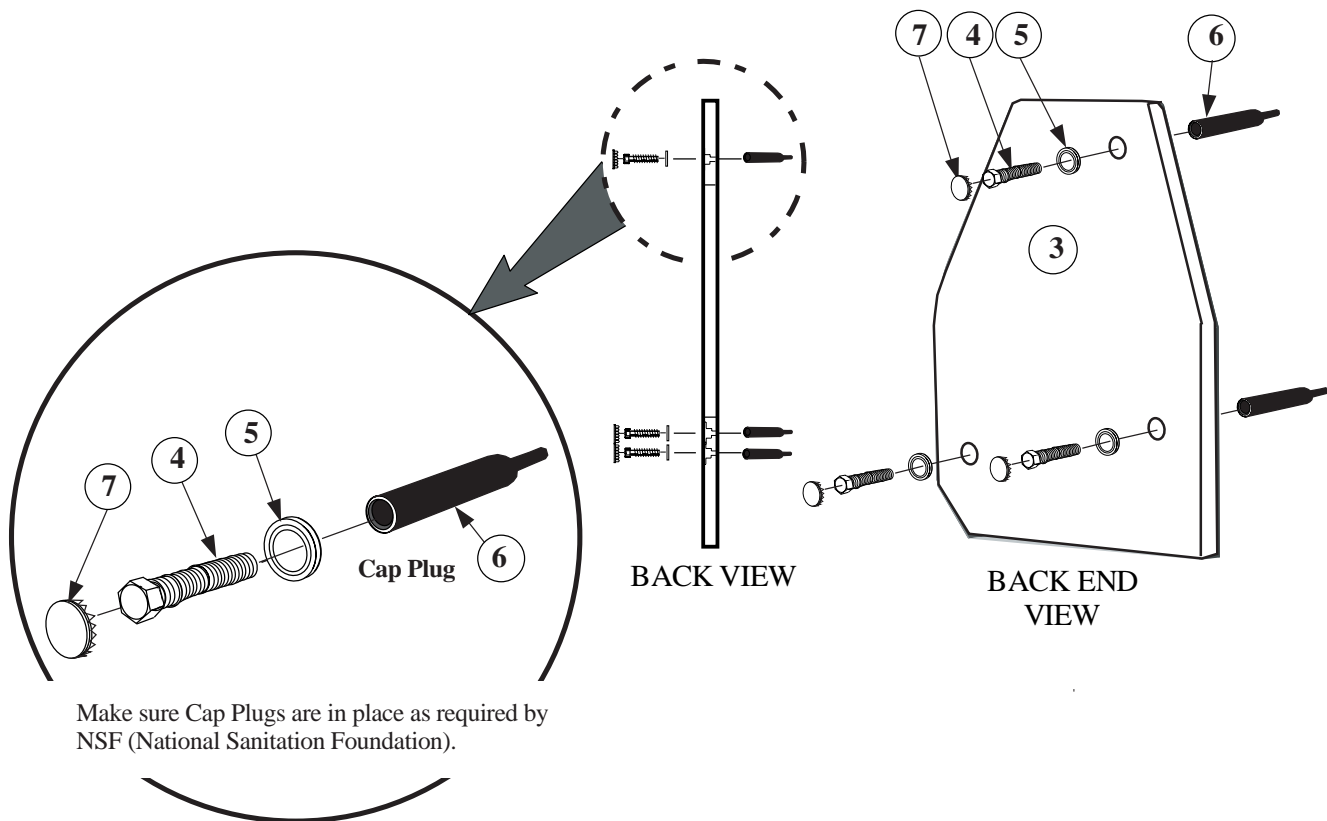

Figure 2. Fastening Solid End Assembly

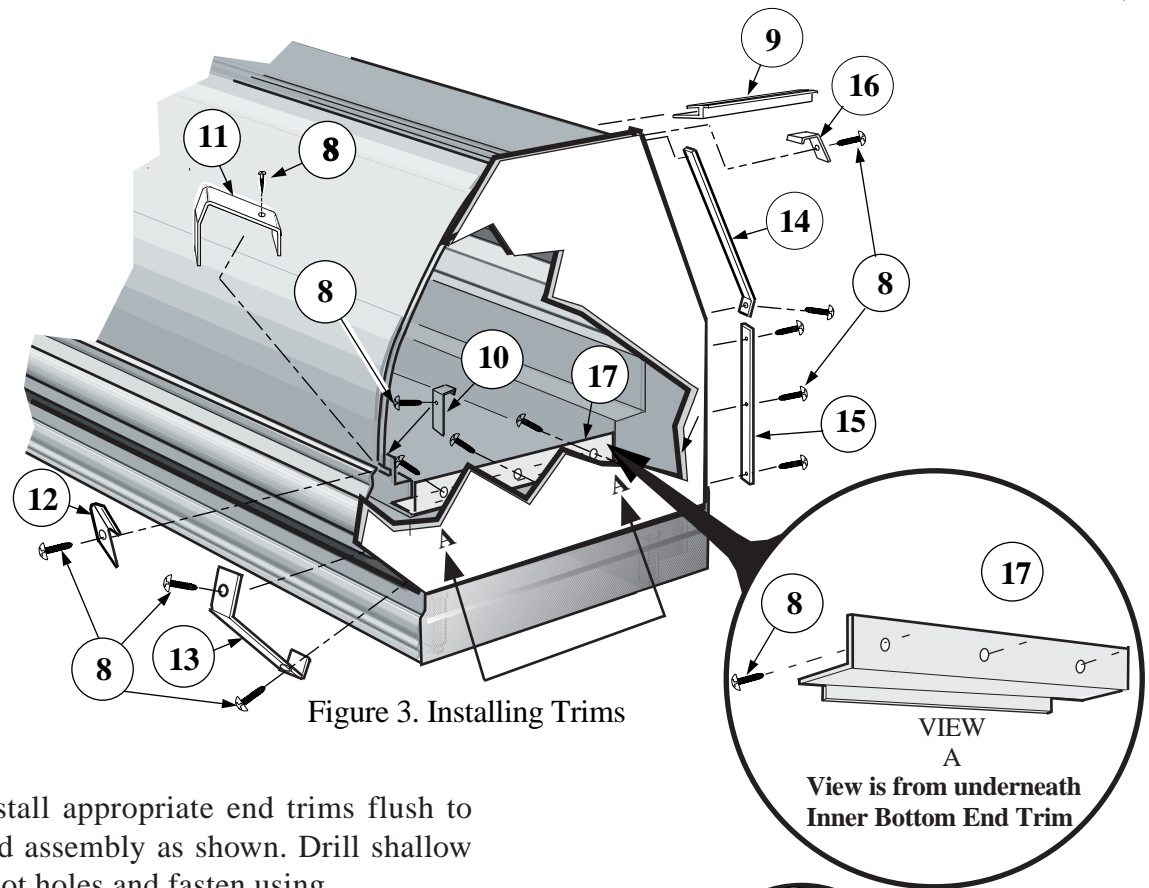

Figure 3. Installing Trims

STEP 3. Install appropriate end trims flush to end assembly as shown. Drill shallow pilot holes and fasten using **Phillips Screws – 8.**

- A. Slide **Top Glass End Trim – 9** between top glass and end assembly.
- B. Install **Front Shelf Support End Trim – 10.**
- C. Install **Front Rail End Trim – 11.**
- D. Install **Upper Front End Trim – 12.**
- E. Install **Front Panel End Trim – 13.**
- F. Install **Frame End Trim – 14.**
- G. Install **Rear Panel End Trim – 15.**
- H. Install **Top Rear End Trim – 16.**
- I. Install **Inner Bottom End Trim – 17** to end panel.
- J. Install **Inner Front End Trim – 18** **GSS (Only).**

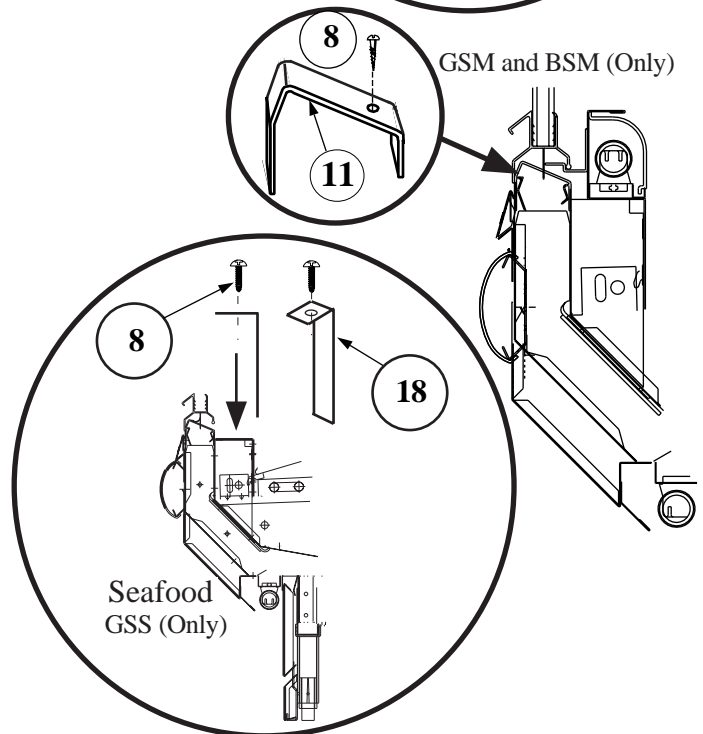

Figure 3a. Installing End Trims

STEP 4. After setting line up, install *Impact Modification Bumpers*.

- A. Starting from left end of lineup, insert 2 foot starter bumper into the front top bumper retainer.* Swing bumper down into position until it “snaps” into place on the bottom of the retainer. See Figure 6a.
- B. Install full length bumper to overlap merchandiser joint. Slide toward left, closing all gaps. Repeat for rest of lineup.
- C. Use a miter box and fine toothed saw to cut last full-length bumper.

*Not required for single 8 or 12ft case.

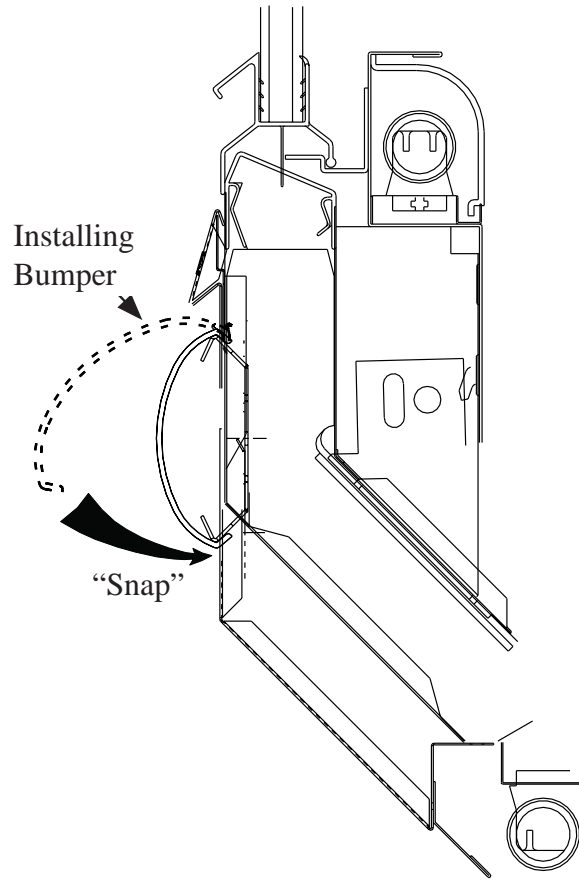

Figure 4a. Installing Bumper onto Retainer

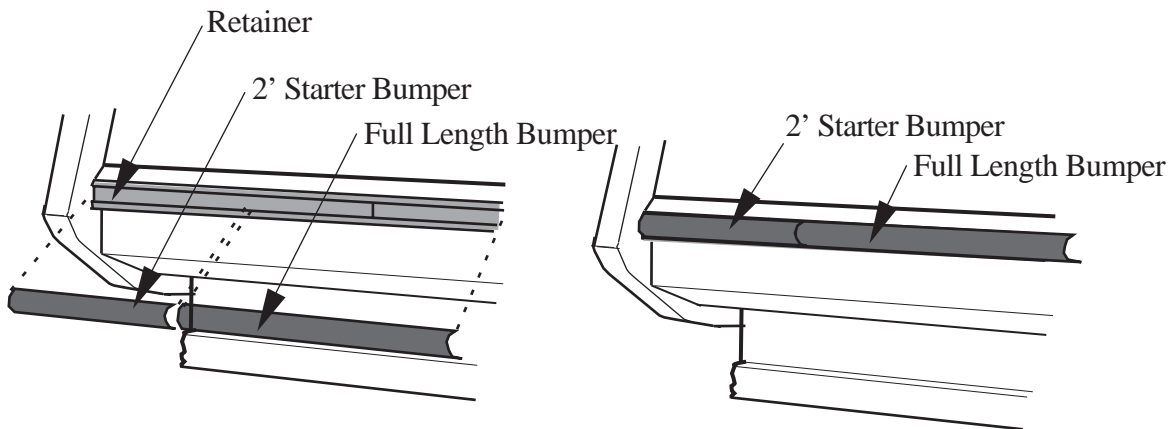

Figure 4. Installing Impact Modification Bumpers

STEP 5.

Note: Begin at the left end of the case to install the splashguard assembly.

- A. Install **End Bracket – 19** to legs of case using **(2) Hex Head Sheet Metal Screws – 20**, (see Figure 5).
- B. Attach **(2) Splashguard Retainers – 21** to End Bracket using **(2) Hex Head Sheet Metal Screws – 20**, (see Figure 6, Detail A).

Note: Do not fully tighten the screws into the retainers to leave flexibility to install the splashguard.

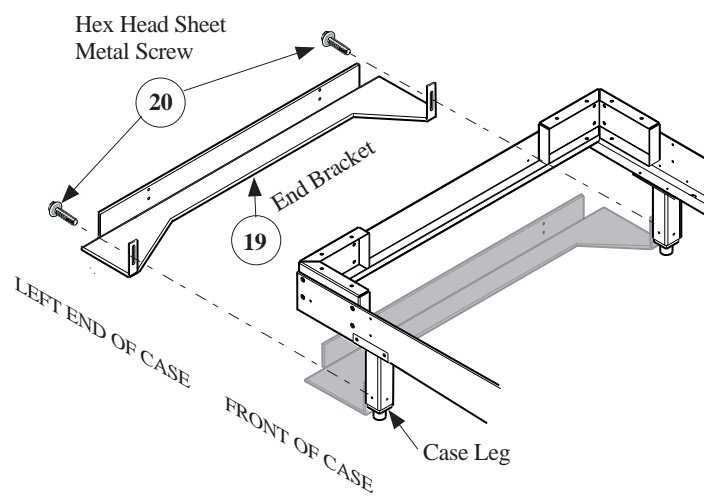

Figure 5. Installing End Brackets

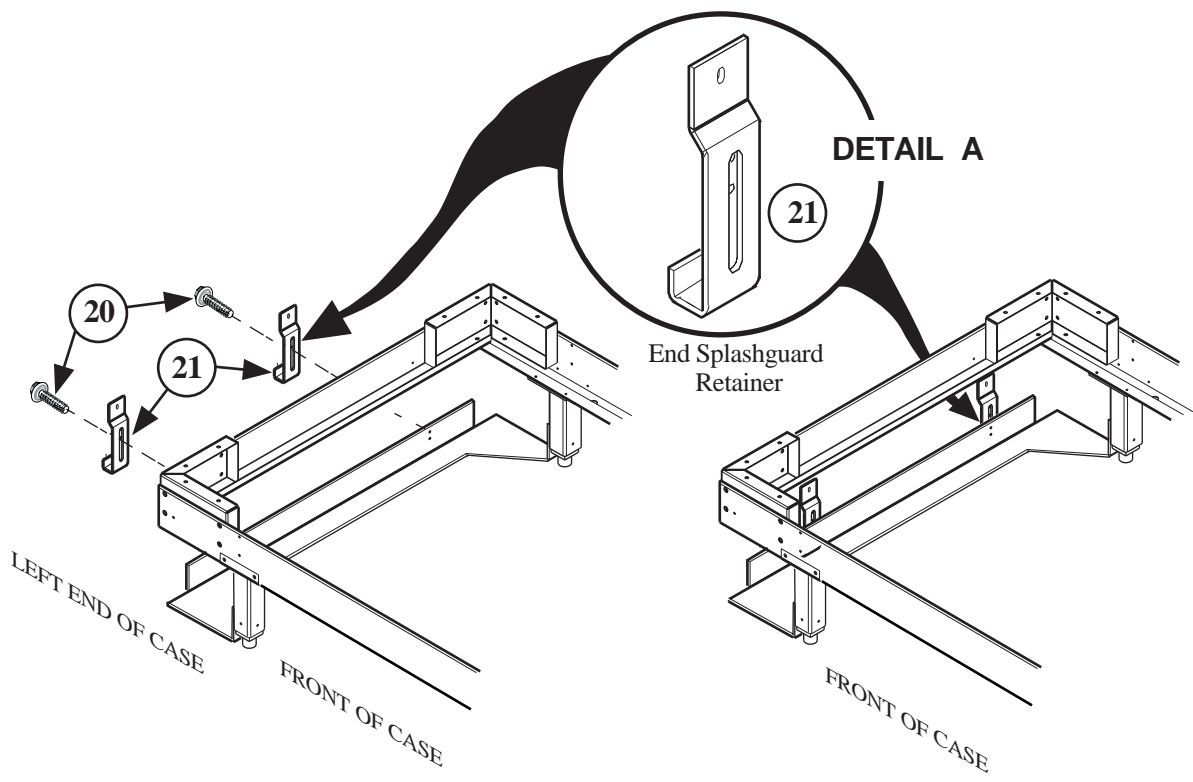

Figure 6. Installing Splashguard Retainers

INSTALLING LEFT END SPLASHGUARD

STEP 6. Position slots of the **LH End Splashguard – 22** over the bottom and top flanges of the **Splashguard Retainers – 21** and slide down into position.

STEP 7. Position **Left End Panel – 23** up and onto retainers, then down on top of splashguard.
(see Figure 7, Detail B).

STEP 8. Install the **RH End Splashguard – 24** and **RH End Panel – 25** following the same procedure in Steps 5, 6 and 7. (see Figures 7 and 8).

STEP 9. At the front of the case, with small hole in square leg as a guide, use a $\frac{1}{8}$ in. (4mm) drill bit and drill a hole through each leg and into leg leveler. Attach **Front Splashguard Retainers – 26** using **Screws – 20**, (see Figures 7 and 8, Details C and F).

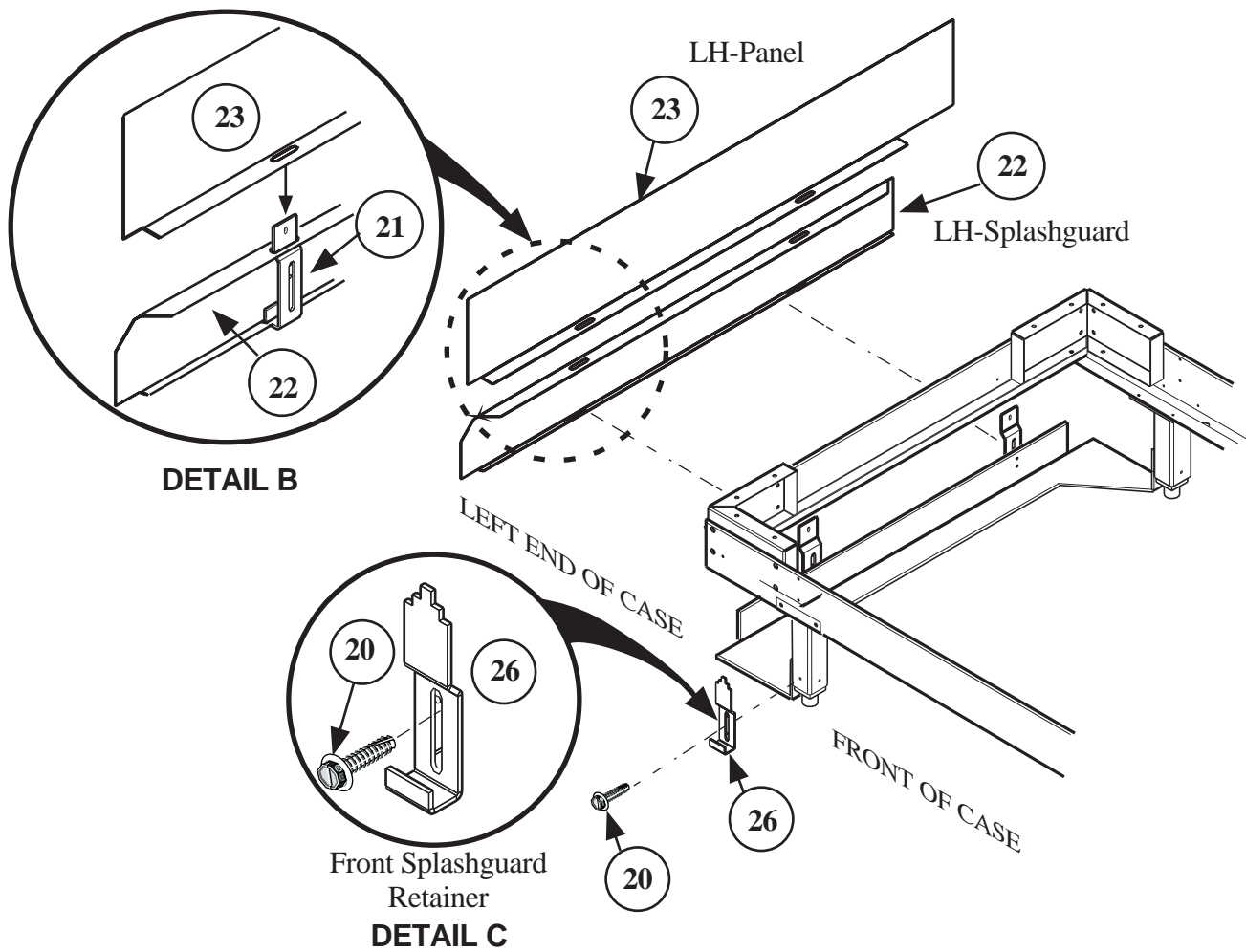

Figure 7. Installing End Splashguard, Splashguard Retainers and Lower Front Panel Retainers

INSTALLING FRONT SPLASHGUARD

STEP 10. Use one **Sheet Metal Screw – 30** to attach each pair of **Lower Front Panel Retainers – 27** centered in each four-foot section of the front of case. (see Figure 8, Detail D).

STEP 11. Position the slots of the **Front Splashguard – 28** over the bottom and top flanges of the **Splashguard Retainers – 26** and slide down into position.

STEP 12. Position and install the **Front Panel – 29** up onto the retainers, then down on top of splashguard.

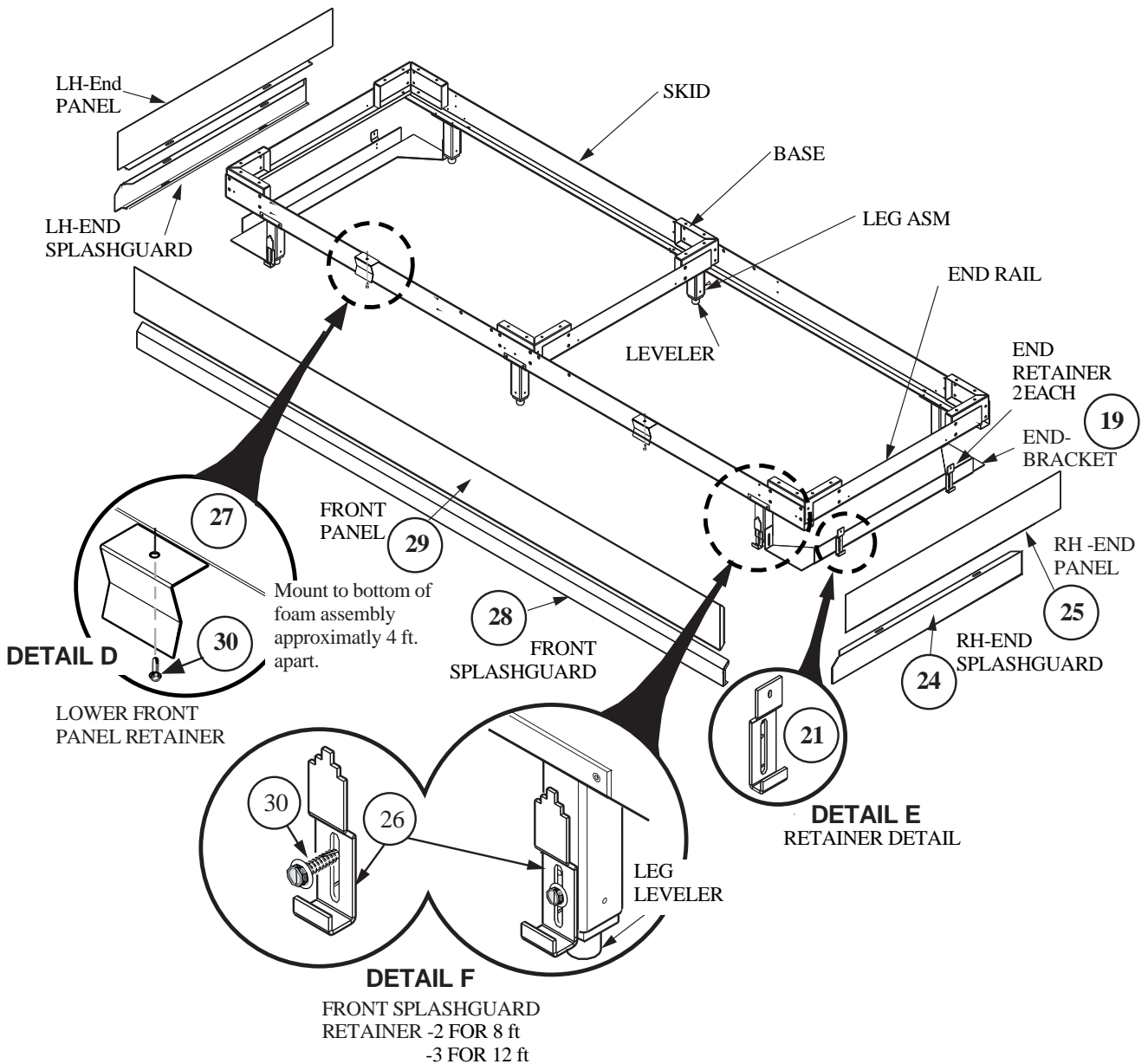

Figure 8. Installing Splashguards and Panels