



HUSSmann®

BSM, GSM & GSS

Joint Kit Instruction
(Modified for IMPACT)

(NSF® Certified)



Curved Glass Fresh Meat Delicatessen
and Seafood Merchandisers

P/N 415114
February, 1999

JOINT ASSEMBLY

PARTS LIST

Item	Quantity			Description
	BSM	GSM	GSS	
1.	1	1	1	Gasket $\frac{1}{2}$ x 1 x 120
2.	2	2	2	Joining Bracket Bolt
3.	4	4	4	Flat Washer
4.	2	2	2	Lock Washer
5.	2	2	2	Hex Nut
6.	3	3	3	Interior Frame Bolt $\frac{3}{8}$ -16 x 1 $\frac{1}{4}$
7.	3	3	3	Lockwasher $\frac{3}{8}$ Split
8.	6	6	6	Flat Washer $\frac{3}{8}$
9.	3	3	3	Hex Nut $\frac{3}{8}$ -16
10.	3	3	3	Cap Plug
11.	1	1	1	Butyl Sealant, Cartridge
12.	1	1	1	Joint Cover Assembly
13.	1	1	1	Frame Joint Trim
14.	1	1	1	Top Joint Trim
15.	1	1	1	Top Rear Trim
16.	12	12	12	Truss Head Sheet Metal Screw #8 x $\frac{1}{2}$
17.	1	1	1	Front Rail Trim
18.	-	-	1	Inner Front Joint Trim
19.	1	1	1	Front Shelf Support Joint Trim
20.	1	1	1	Rear Panel Joint Trim

NOTES:

LEGS MUST BE INSTALLED BEFORE JOINING CASES.

BE SURE MERCHANDISERS HAVE BEEN LEVELED ACCORDING TO THE INSTALLATION INSTRUCTIONS UNDER LEVELING.

Installing Gasket

Be sure the nut retainers used by the factory to install shipping braces have been removed.

STEP 1. Apply Gasket – 1

around the perimeter of one of the merchandisers being joined. If they have different front heights, apply to merchandiser with lower front height.

- A. Apply gasket so it is *flush* with the End Frame of the case leaving no gaps in compliance with NSF® (National Sanitation Foundation). See Figure 1.
- B. Do not splice gasket on horizontal surfaces.
- C. Do not stretch gasket, especially around corners.
- D. Remove paper backing after gasket is applied. See Figure 4.

Note: GSM Model shown in all figures

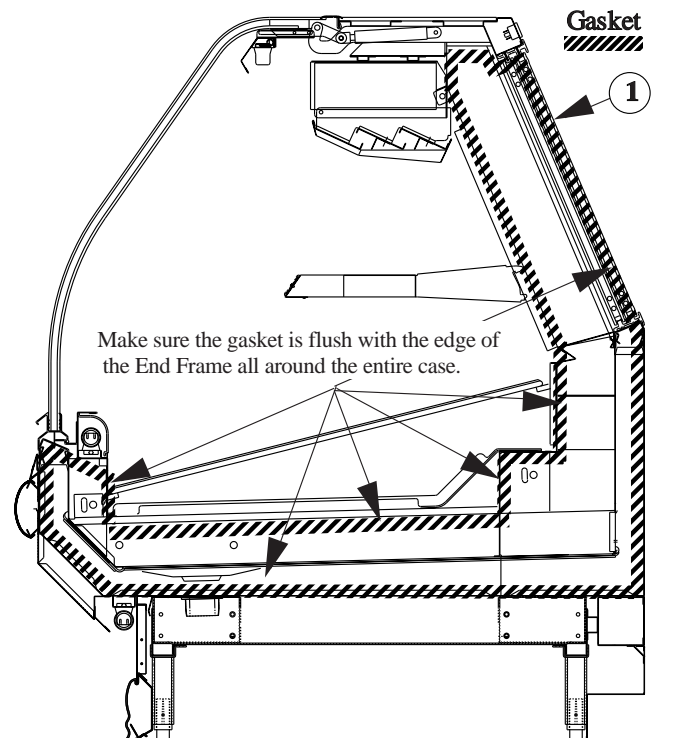

Figure 1. Installing Gasket

2 JOINT ASSEMBLY

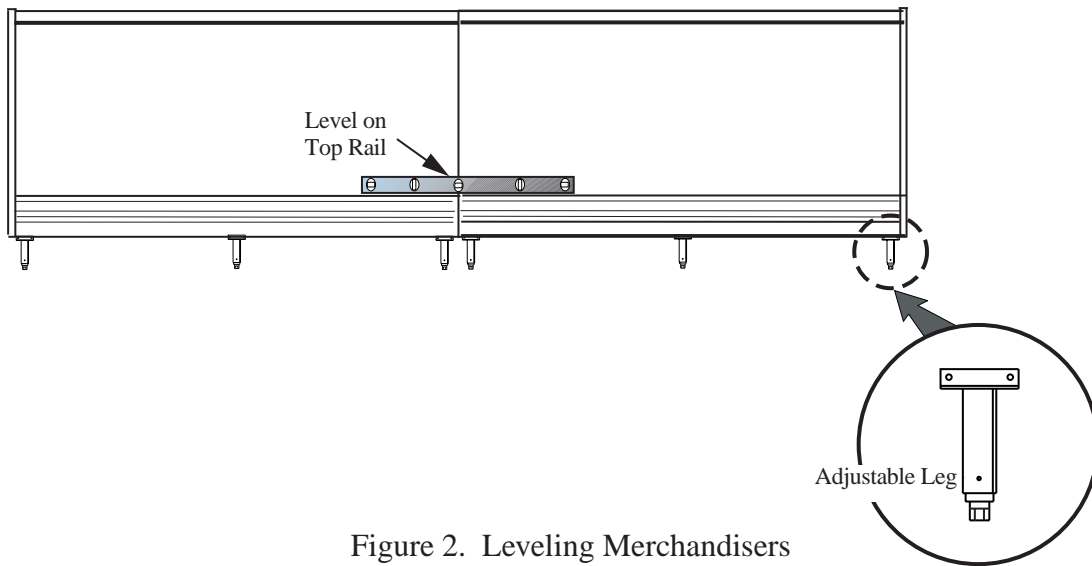

Figure 2. Leveling Merchandisers

STEP 2. The complete lineup must be leveled to the highest point of the floor. After the first merchandiser has been set, position the second so the end frames touch.

Note:

Adjustable Leg Levelers should be POSITIONED AT THE MIDDLE HEIGHT to allow clearance for the Lower Front Panel to be installed. (See Figure 3).

Set a long level (4 foot or more) on the top rail of the merchandisers at the joint. Adjust case height by rotating the Adjustable Leg Leveler in a counter-clockwise direction until the merchandisers are flush and level.

Also check each joint area to be sure that the panels of adjoining merchandisers are flush to each other.

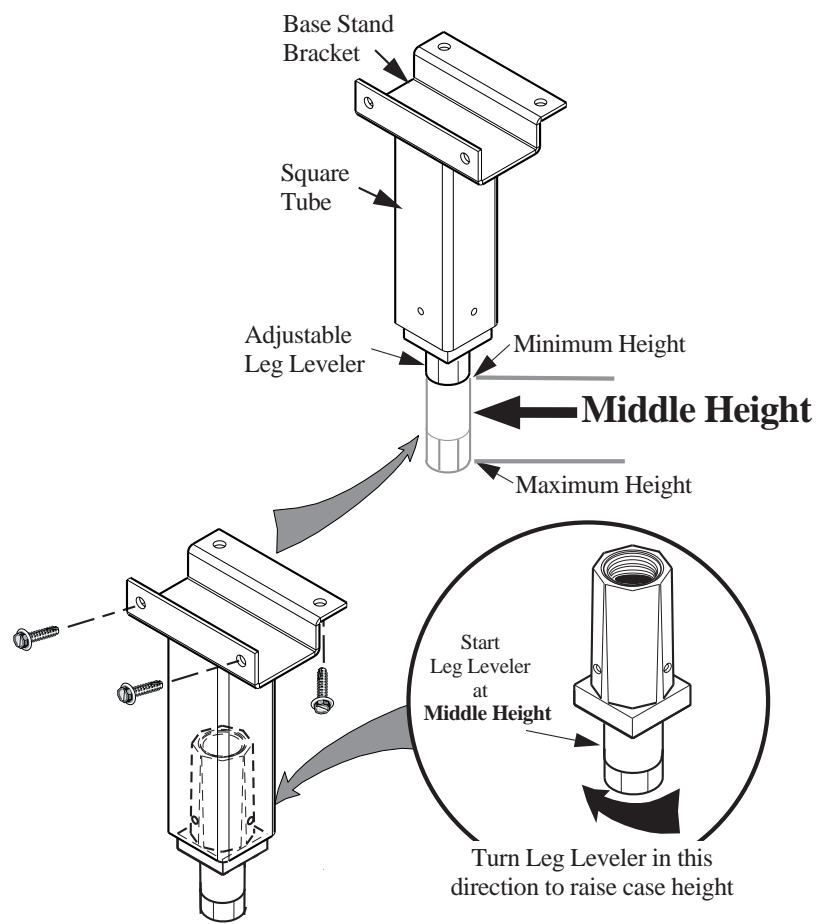

Figure 3. Adjusting Case Height

STEP 3.

A. Assemble

Joining Bracket Bolt – 2**Flat Washers – 3****Lock Washer – 4****Hex Nut – 5**

in joining brackets at the lower front and upper rear of the merchandisers.

Follow Torquing Sequence #1 then #2 exactly as shown.

- B. While applying force to the base end of the free merchandiser tighten the front **Joining Bracket Bolt #1** until the front gap is closed.

It is critical that merchandisers are drawn together with Bolt #1 while applying force at the free end until the gap between the panels is closed. Failure to follow this procedure may result in gaps or permanent damage to the merchandiser.

- C. Repeat for **Joining Bracket Bolt #2** until front gap is closed.

Do not continue to torque after the gap is closed. This will result in damage to the merchandiser.

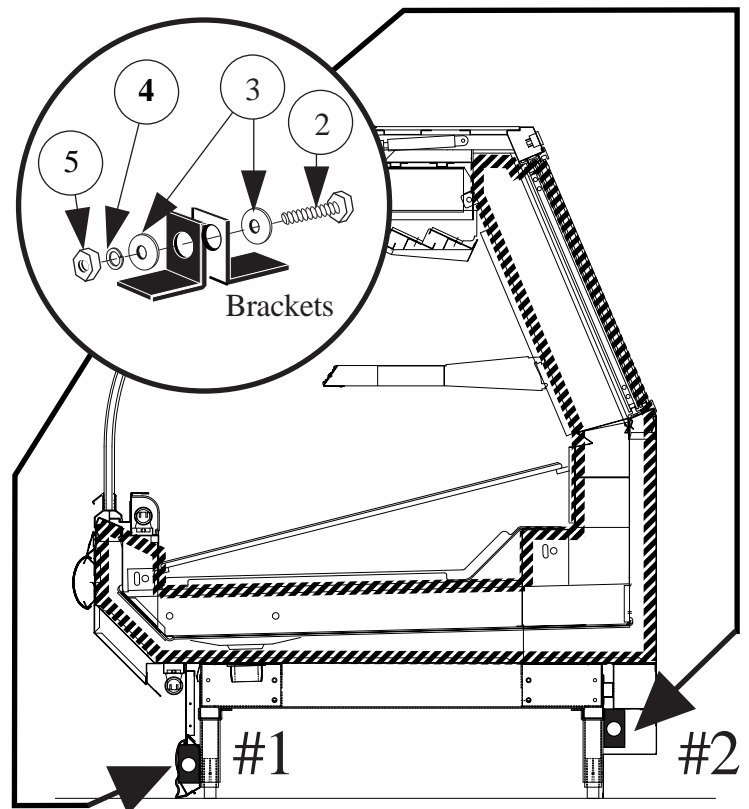

Bracket ■

Figure 4. Torquing Joining Bracket Bolts

4 JOINT ASSEMBLY

STEP 4. Remove access covers and front shelf supports for joining holes.

Install

Interior Frame Bolts – 6

Lock Washers – 7

Flat Washers – 8

Hex Nuts – 9.

Cap Plug – 10

(as required by NSF).

See Figure 5.

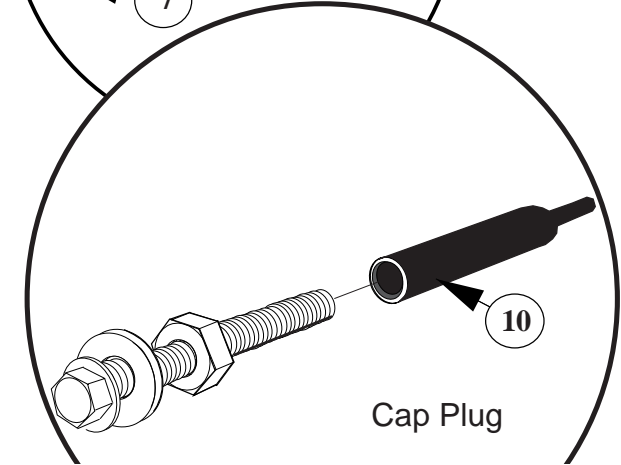
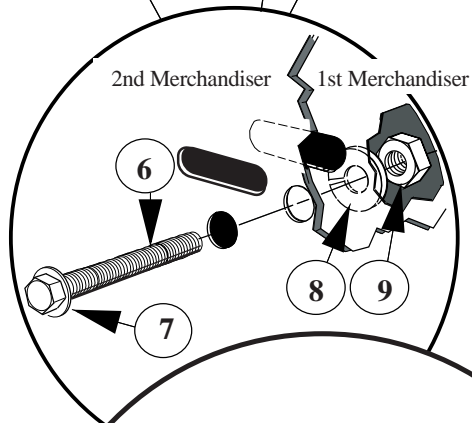
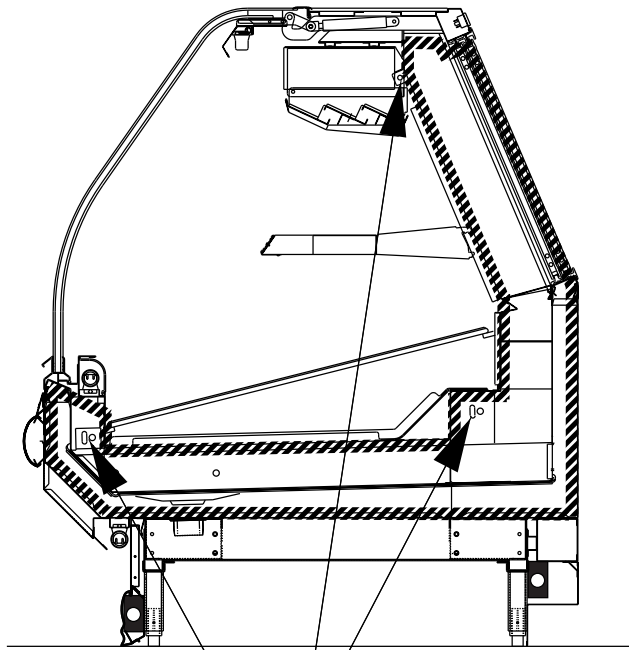

NOTE: Remove Joining Brackets before attempting to install splashguards.

Make sure Cap Plugs are in place as required by NSF (National Sanitation Foundation).

Figure 5. Installing Interior Frame Bolts

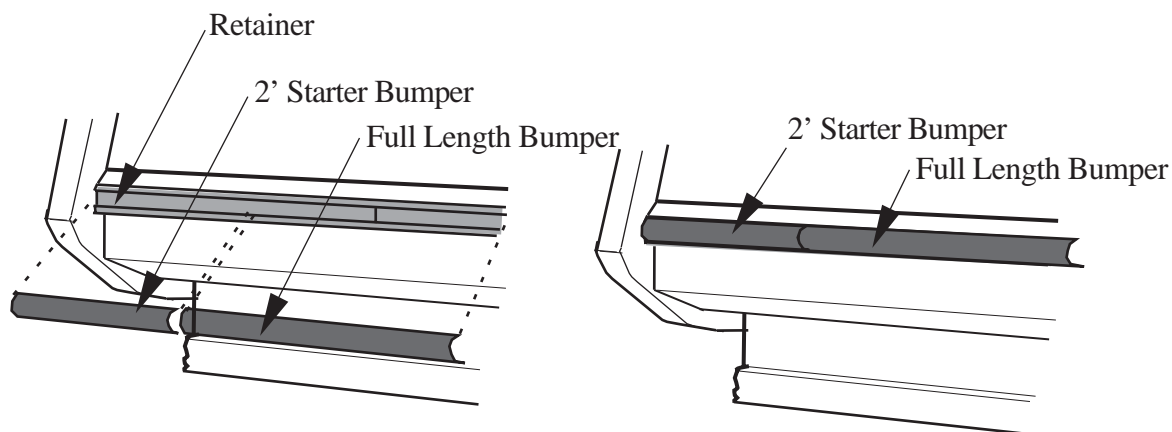

Figure 6. Impact Modification Bumpers

STEP 5. After setting line up, install *Impact Modification Bumpers*.

- A. *STARTING FROM LEFT END OF LINEUP*, insert 2 ft starter bumper into the front Top Bumper Retainer. See Figure 6. Swing Bumper down into position until it “snaps” into place on the bottom of the retainer. See Figure 7.
- B. Install full length bumper to overlap merchandiser joint. Slide toward left, closing all gaps. Repeat for rest of lineup.
- C. Use a miter box and fine toothed saw to cut last full-length bumper.

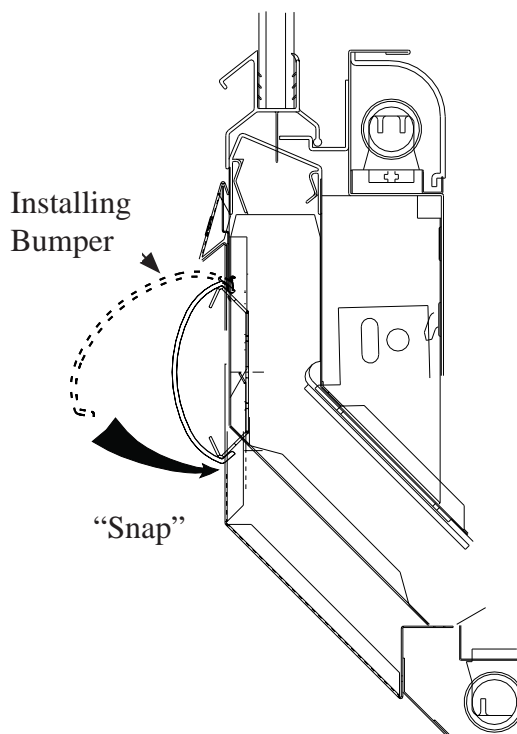

Figure 7. Installing Bumper onto Retainer

STEP 6. Apply a smooth, continuous bead of

Butyl Sealant – 11

to the joint interior seam of rear mullion and inside the

Joint Assembly Cover – 12

as shown in Figure 8.

After all the merchandisers have been joined, press

Joint Assembly Cover – 12

down in between the two cases being joined.

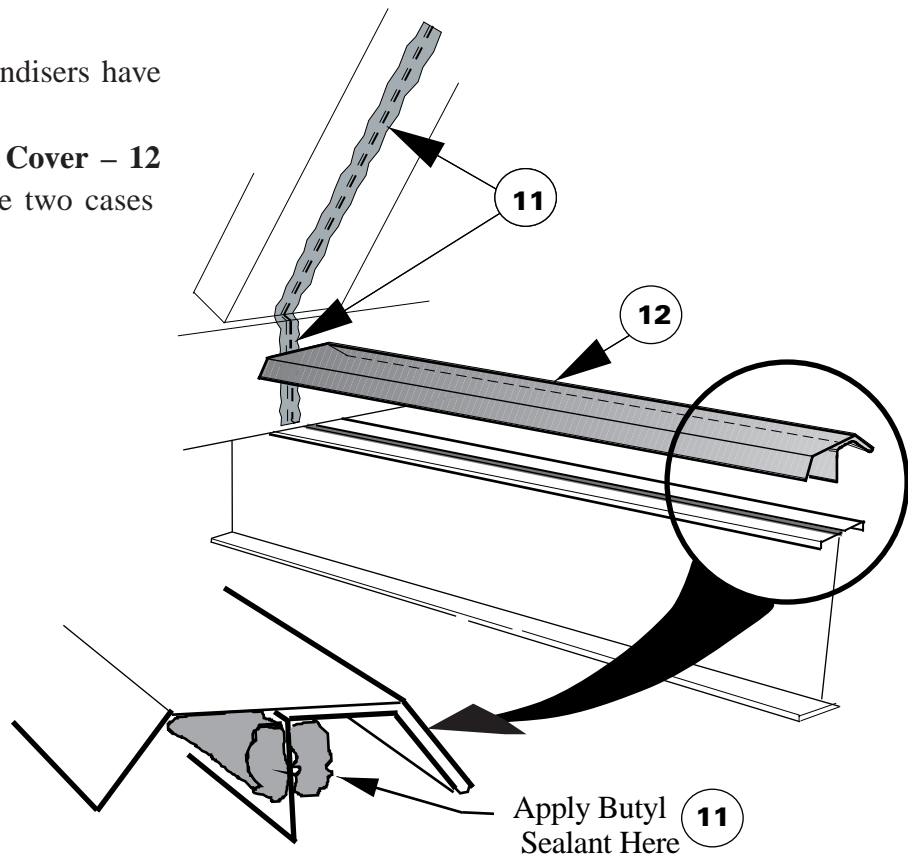

Figure 8. Sealing End Frame Joint

STEP 7. Loosen the screws holding the front and upper panels and push the panels towards the center of the case.
Use the trims as follows to cover any gaps.
See parts list and Figures 9 & 10 for trim application.

When screws are used, drill shallow pilot holes using trim as a template, then fasten the trim centered over the joint using **Screws – 16.**

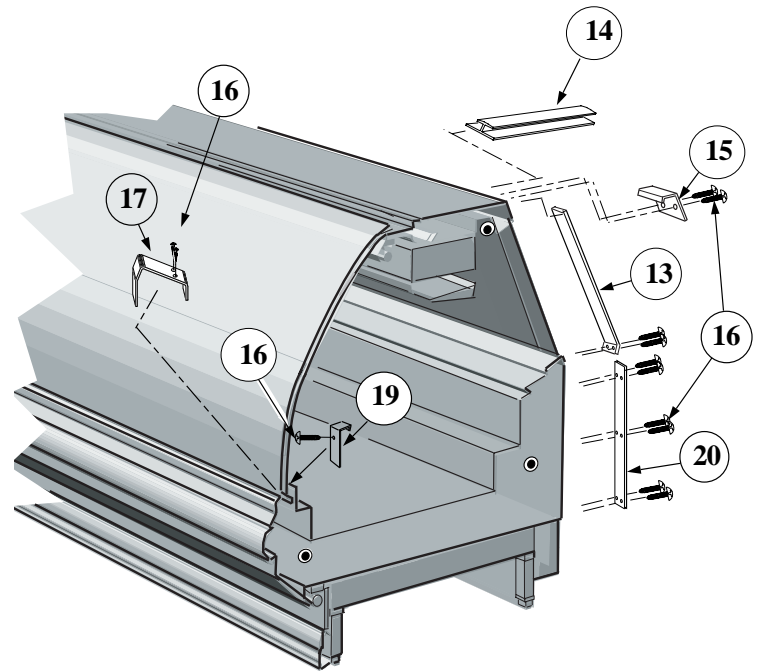

Figure 9. Installing Joint Trims

- A. Slip **Frame Joint Trim – 13** between mullions.
- B. Slide **Top Joint Trim – 14** between joining top glasses.
- C. Install **Top Rear Trim – 15.**
- D. Install **Front Rail Trim – 17.**
- E. Install **Inner Front Joint Trim – 18.**
- F. Install **Front Shelf Support Joint Trim – 19.**
- G. Remove Plug Buttons from both cases.
- H. Install **Rear Panel Joint Trim – 20.**

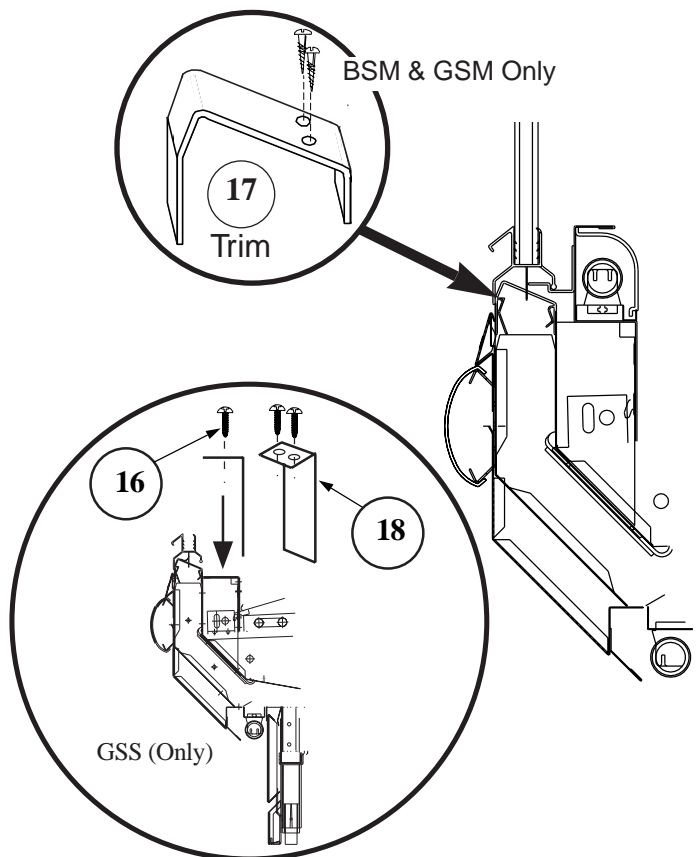

Figure 8. Detail and Location of Front Rail Trim