

Hussmann refrigerated merchandisers configured for sale for use in the United States meet or surpass the requirements of the DOE 2017 energy efficiency standards.

Q3-DV Multi-Deck Service Deli Case

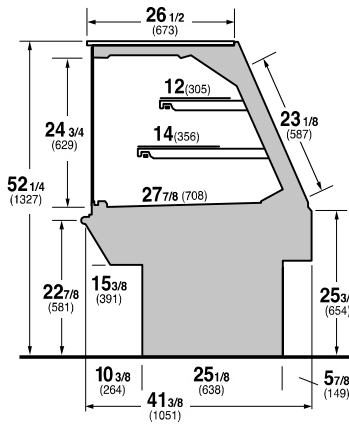

Q3-DV, BV

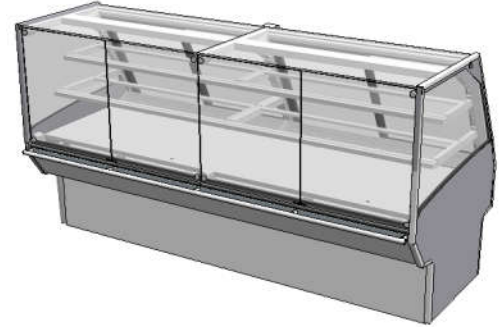
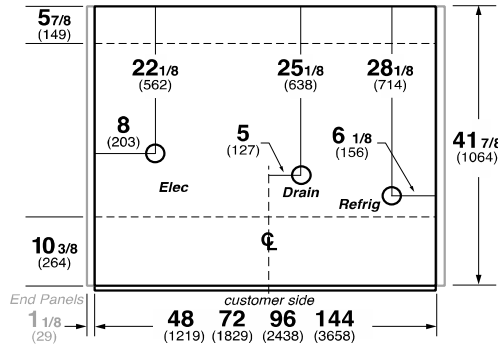

REFRIGERATION DATA:

CASE LENGTHS/ WEDGES	CASE USAGE	CAPACITY *** (BTU/HR/FT) (TOTAL FOR WEDGES)		TEMPERATURE (°F)			VELOCITY (FT/MIN)
		RATING CONDITION		EVAPORATOR		DISCHARGE AIR ** (°F)	
		NSF 7	AHRI 1200	NSF 7	AHRI 1200	NSF 7	NSF 7
3', 4', 5', 6', 8', 10', 12'	DELI / BAKERY	390	390	24	24	30~34	225~250
22.5° OS	DELI / BAKERY	1940	1940	24	24	30~34	225~300
45° IS	DELI / BAKERY	2080	2080	24	24	26~30	225~300
45° OS	DELI / BAKERY	900	900	24	24	30~34	225~300

CASE LENGTHS	EST. REFRIG. CHR.G. (LBS) (R404A)	GLYCOL (20°F INLET, 6° RISE)	
		GPM	PSI
3'	0.3	0.4	0.6
4'	0.4	0.6	1.3
5'	0.5	0.7	2.1
6'	0.6	0.8	3.1
8'	0.8	1.1	1.4
10'	0.9	1.4	2.5
12'	1.3	1.6	3.0
22.5° OS	0.3	0.6	1.1
45° IS	0.2	0.7	1.2
45° OS	0.2	0.3	0.1

\*\*FRONT DISCHARGE AIR MEASURED INSIDE AIR CURTAIN HONEYCOMB

\*\*\*REFRIGERATION NOTES:

- 1) BTUS INCLUDE CANOPY LIGHTS. ADD 10 BTUS/SHELF/FT FOR EACH SHELF (LIGHT)
- 2) AHRI 1200 RATING POINT FOR ENERGY CONSUMPTION COMPARISON ONLY
- 3) USE DEW POINT FOR HIGH GLIDE REFRIGERANTS. CARE SHOULD BE TAKEN TO USE THE DEW POINT IN P/T TABLES FOR MEASURING AND ADJUSTING SUPERHEAT. ADJUST EVAPORATOR PRESSURE AS NEEDED TO MAINTAIN THE DISCHARGE AIR TEMPERATURE SHOWN.
- 4) RATING CONDITION IS NSF TYPE I, 75°F/55% RH

REFRIGERATION DATA CONTINUED:

ELEC. THERMOSTAT / AIR SENSOR SETTINGS			DEFROST TYPE	TIME (MIN)	DEFROST FREQUENCY (#/DAY)	TERM. TEMP (°F) COIL ONLY	DRIP TIME	DEFROST WATER (LBS/DAY/FT)
USAGE	CUT IN (°F)	CUT OUT (°F)						
DELI / BAKERY	32	29	OFF TIME	40	3	45	N/A	1.6

END PANEL WIDTH KEY		
# OF END PNLS	END PNL WIDTH (IN.)	TOTAL ADDED LENGTH (IN.)
1	1.125	1.125
2	1.125	2.25

ELECTRICAL DATA:

STANDARD FANS, HEATERS, LED LIGHTS (115 VOLT)

CASE LENGTH	EVAPORATOR FANS					AIRSWEEP FAN			CANOPY LIGHTS LED		OPTIONAL LED SHELF LIGHTS		MAX. LED LOAD (W/ ALL OPTIONS)		ANTI-SWEAT HEATERS (ON FAN CIRCUIT)		CONVENIENCE OUTLETS (OPTIONAL)		
	# OF EVAP FANS	BLADE DIA. (IN.)	BLADE PITCH (°)	AMPS	WATTS	# OF FANS	AMPS	WATTS	AMPS	WATTS	AMPS	WATTS	AMPS	WATTS	AMPS	WATTS	# OUTLETS	VOLTS	AMPS
3'	1	6.7	15	0.12	8	1	0.08	9	0.16	19	0.13	15	0.30	34	0.96	110	1	115	15
4'	1	6.7	20	0.12	8	2	0.15	18	0.30	35	0.18	21	0.48	55	0.87	100	1	115	15
5'	1	6.7	25	0.12	8	2	0.15	18	0.35	40	0.23	26	0.57	66	1.09	125	1	115	15
6'	4	6.7	15	0.48	32	2	0.15	18	0.42	49	0.26	30	0.69	79	1.30	150	1	115	15
8'	4	6.7	20	0.48	32	2	0.15	18	0.60	69	0.36	41	0.96	110	1.74	200	1	115	15
10'	4	6.7	25	0.48	32	3	0.23	26	0.70	80	0.45	52	1.15	132	2.17	250	1	115	15
12'	6	6.7	20	0.72	48	3	0.23	26	0.90	104	0.54	62	1.44	166	2.61	300	2	115	30
22.5° OS	1	6.7	15	0.12	8	1	0.08	9	0.17	19	0.13	15	0.30	35	0.87	100	N/A	N/A	N/A
45° IS	2	6.7	15	0.24	16	1	0.08	9	0.16	18	0.13	15	0.29	33	0.65	75	N/A	N/A	N/A
45° OS	1	6.7	20	0.12	8	1	0.08	9	0.09	11	0.04	4	0.13	15	0.87	100	N/A	N/A	N/A

OPTIONAL HIGH OUTPUT LED LIGHTS (115 VOLT)

CASE LENGTH	CANOPY LIGHTS H.O. LED		OPTIONAL SHELF		MAX. H.O. LED LOAD	
	AMPS	WATTS	AMPS	WATTS	AMPS	WATTS
3'	N/A	N/A	N/A	N/A	N/A	N/A
4'	0.39	45	0.26	30	0.66	75
5'	N/A	N/A	N/A	N/A	N/A	N/A
6'	N/A	N/A	N/A	N/A	N/A	N/A
8'	0.78	90	0.53	61	1.31	151
10'	N/A	N/A	N/A	N/A	N/A	N/A
12'	1.17	135	0.79	91	1.97	226
22.5° OS	0.21	24	0.23	26	0.43	50
45° IS	N/A	N/A	N/A	N/A	N/A	N/A
45° OS	N/A	N/A	N/A	N/A	N/A	N/A