

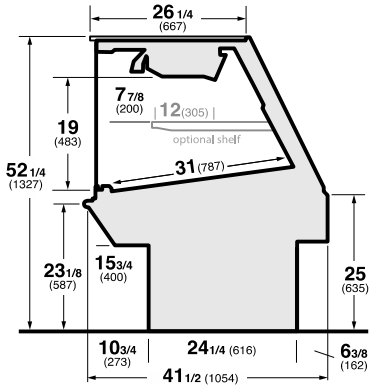

Husmann refrigerated merchandisers configured for sale for use in the United States meet or surpass the requirements of the DOE 2017 energy efficiency standards.

Q3-M/FV-EP Multi-Deck Vertical Glass Service Meat Case



Q3-M/FV-EP

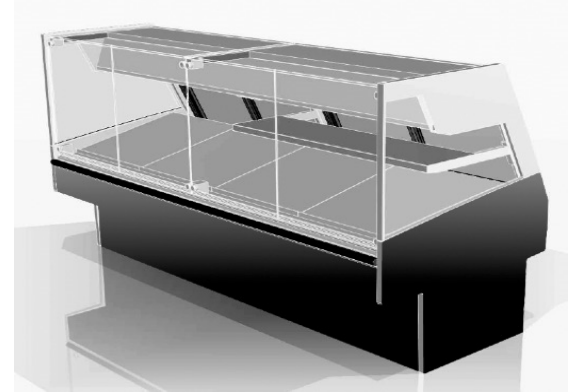
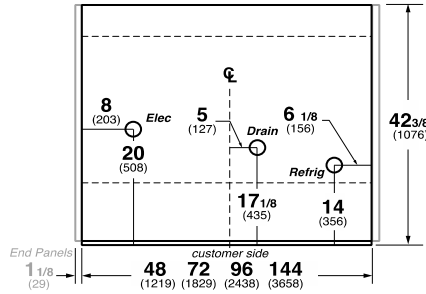

REFRIGERATION DATA:

CASE LENGTHS	CASE USAGE	CAPACITY *** (BTU/HR/FT) (TOTAL FOR WEDGES)		TEMPERATURE (°F)			VELOCITY (FT/MIN)
		RATING CONDITION		EVAPORATOR (°F)		DISCHARGE AIR ** (°F)	
		NSF 7	AHRI 1200	NSF 7	AHRI 1200	NSF 7	
4',6',8',10',12' NO SHELF	MEAT/FISH	275	275	28	28	33~37	50~75
4',6',8',10',12' W/ SHELF	MEAT/FISH	400	400	20	20	24~28	50~75
22.5°O W/O SHELF	MEAT/FISH	1800	1800	20	20	27~30	50~75
45°O W/ SHELF	MEAT/FISH	900	900	20	20	27~30	50~75

CASE LENGTHS	EST. REFG. CHR.G. 404A (LBS)	GLYCOL (18°F INLET, 4° RISE)			
		GRAVITY		SERPENTINE	
		GPM	PSI	GPM	PSI
4'	1.3	0.3	1.3	0.2	0.5
6'	1.8	0.5	3.3	0.3	1.3
8'	2.2	0.7	1.5	0.4	2.3
10'	2.8	0.8	2.4	0.5	3.6
12'	3.5	0.9	1.6	0.6	5.1
22.5°O	1.0	0.2	0.8	0.1	1.3
45°O	1.0	0.3	0.1	0.2	0.0

**FRONT DISCHARGE AIR MEASURED INSIDE AIR CURTAIN HONEYCOMB

***REFRIGERATION NOTES:

- 1) BTU'S INCLUDE CANOPY LIGHTS. ADD 10 BTUS/SHELF/FT FOR EACH SHELF (LIGHT)
- 2) ADJUSTMENTS TO CONTROL SETTINGS SHOULD BE MADE IN 1°F INCREMENTS DEPENDING UPON MEAT DEPT AMBIENT CONDITIONS
- 3) FOR SHELF APPLICATIONS IT MAY BE NECESSARY, TO INCREASE DEFROST TIME APPROXIMATELY 1 MIN PER 1°F BELOW 75°F AMBIENT
- 4) AHRI 1200 RATING POINT FOR ENERGY CONSUMPTION COMPARISON ONLY
- 5) USE DEW POINT FOR HIGH GLIDE REFRIGERANTS. CARE SHOULD BE TAKEN TO USE THE DEW POINT IN P/T TABLES FOR MEASURING AND ADJUSTING SUPERHEAT. ADJUST EVAPORATOR PRESSURE AS NEEDED TO MAINTAIN THE DISCHARGE AIR TEMPERATURE SHOWN.
- 6) THE PRINCIPAL COOLING EFFECT IN FISH CASES IS ACCOMPLISHED WITH A TRADITIONAL ICE BED. THE REFRIGERATION PRESERVES THE ICE AND MAINTAINS A COLD PROTECTIVE LAYER OVER THE PRODUCT.
- 7) RATING CONDITION IS NSF TYPE I, 75°F/55% RH

REFRIGERATION DATA CONTINUED:

ELEC. THERMOSTAT / AIR SENSOR SETTINGS			DEFROST TYPE	TIME (MIN)	DEFROST FREQUENCY (#/DAY)	TERM. TEMP (°F) COIL ONLY	DRIP TIME	DEFROST WATER (LBS/DAY/FT)
LOCATION	CUT IN (°F)	CUT OUT (°F)						
GRAVITY COIL	NO SHELF	35	OFF TIME	50	1	45	N/A	0.9
DECK COIL		30						
GRAVITY COIL	W/ SHELF	27	OFF TIME	65	3	40	N/A	1.3
DECK COIL		32						

END PANEL WIDTH KEY		
# OF END PNLS	END PNL WIDTH	TOTAL ADDED LENGTH (IN.)
1	1.125	1.125
2	1.125	2.25

ELECTRICAL DATA:

STANDARD FANS, HEATERS, LED LIGHTS (115 VOLT)

CASE LENGTH	AIRSWEEP FANS			CANOPY LIGHTS H.O. LED		OPTIONAL H.O. LED SHELF LIGHTS		MAX. LED LOAD (W/ ALL OPTIONS)		AIRSWEEP HEATERS		CONVENIENCE OUTLETS (OPTIONAL)		
	# OF FANS	AMPS	WATTS	AMPS	WATTS	AMPS	WATTS	AMPS	WATTS	AMPS	WATTS	# OUTLETS	VOLTS	AMPS
4'	1	0.04	2	0.26	30	0.22	26	0.49	56	N/A	N/A	1	115	15
6'	2	0.07	4	0.45	52	0.36	41	0.81	93	N/A	N/A	1	115	15
8'	2	0.07	4	0.53	61	0.44	51	0.97	112	N/A	N/A	1	115	15
10'	2	0.07	4	0.36	41	0.49	56	0.85	98	N/A	N/A	1	115	15
12'	3	0.11	5	0.79	91	0.67	77	1.46	168	N/A	N/A	1	115	15
22.5°O	1	0.04	2	0.06	7	0.09	11	0.15	18	N/A	N/A	1	115	15
45°O	1	0.04	2	0.06	7	0.09	11	0.15	18	N/A	N/A	1	115	15