

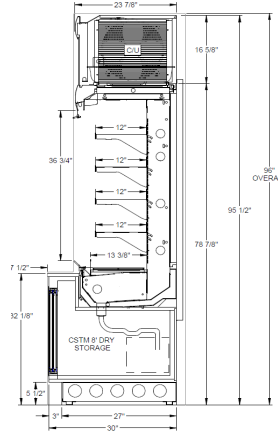

BACK BAR DISPLAY
HUSSMANN - RBB-8-DS-48D-S (CHINO)

REVISION DATE 09/27/23

DOE 2017 Energy Efficiency Compliant
 Hussmann refrigerated merchandisers configured for sale for use in the United States meet or surpass the requirements of the DOE 2017 energy efficiency standards.

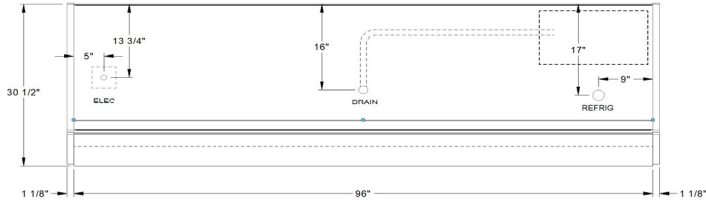

REFRIGERATION DATA:

CASE LENGTHS	CASE USAGE	CAPACITY ** (BTU/HR/FT)		TEMPERATURE (°F)			VELOCITY (FT/MIN)
		RATING CONDITION		EVAPORATOR		DISCHARGE AIR * (°F)	
		NSF 7	AHRI 1200	NSF 7	AHRI 1200	NSF 7	NSF 7
8'	Type 1 Deli	1270	1050	20	20	24~26	250~350

*FRONT DISCHARGE AIR MEASURED INSIDE AIR CURTAIN HONEYCOMB
 **REFRIGERATION NOTES:

- 1) BTU'S INCLUDE CANOPY LIGHTS. ADD 10 BTUS/SHELF/FT FOR EACH SHELF (LIGHT)
- 2) ALL CASES EQUIPPED WITH NIGHT CURTAINS
- 3) FOR AHRI TEST, NIGHT CURTAINS ARE PULLED DOWN FOR 6 HOURS AND ALL LIGHTS ARE TURNED OFF PER AHRI 1200 TEST PROCEDURES
- 4) FOR NSF 7, THE LOAD LISTED IS WITHOUT THE NIGHT CURTAINS PULLED DOWN,
- 5) AHRI 1200 RATING POINT FOR ENERGY CONSUMPTION COMPARISON ONLY
- 6) USE DEW POINT FOR HIGH GLIDE REFRIGERANTS. CARE SHOULD BE TAKEN TO USE THE DEW POINT IN P/T TABLES FOR MEASURING AND ADJUSTING SUPERHEAT. ADJUST EVAPORATOR PRESSURE AS NEEDED TO MAINTAIN THE DISCHARGE AIR TEMPERATURE SHOWN.
- 7) RATING CONDITION IS NSF TYPE I, 75°F/55% RH

REFRIGERATION DATA CONTINUED:

LOCATION	ELEC. THERMOSTAT / AIR SENSOR SETTINGS			DEFROST TYPE	TIME (MIN)	DEFROST FREQUENCY (#/DAY)	TERM. TEMP (°F) COIL ONLY	DRIP TIME	DEFROST WATER (LBS/DAY/FT)
	USAGE	Setpoint (°F)	Differential (°F)						
UPPER SECTION	BACK BAR	24	8	OFF TIME	24	4	45	N/A	7.0

END PANEL WIDTH KEY		
# OF END PNLS	END PNL WIDTH (IN.)	TOTAL ADDED LENGTH (IN.)
1	1.125	1.125

ELECTRICAL DATA:

STANDARD FANS, HEATERS, LED LIGHTS (115 VOLT)

CASE LENGTH	EVAPORATOR FANS - BACK BAR					EVAPORATOR FANS - LOWER REFRIGERATED SECTION (OPTIONAL)				CANOPY LIGHTS LED		OPTIONAL LED SHELF LIGHTS		MAX. LED LOAD (W/ ALL OPTIONS)		ANTI-SWEAT HEATERS		CONVENIENCE OUTLETS (OPTIONAL)		
	# OF EVAP FANS	BLADE DIA. (IN.)	BLADE PITCH (°)	AMPS	WATTS	# OF EVAP FANS ***	AMPS	WATTS	AMPS	WATTS	AMPS	WATTS	AMPS	WATTS	AMPS	WATTS	# OUTLETS	VOLTS	AMPS	
8'	2	8	25	0.6	16	1	0.3	9	0.2	21	0.5	62	0.7	82	N/A	N/A	N/A	N/A	N/A	

OPTIONAL HIGH OUTPUT LED LIGHTS (115 VOLT)

CASE LENGTH	CANOPY LIGHTS H.O. LED		OPTIONAL SHELF		MAX. H.O. LED LOAD	
	AMPS	WATTS	AMPS	WATTS	AMPS	WATTS
8'	0.3	30	0.8	91	1.1	122

CONDENSING UNIT AND EVAPORATIVE PANS

CASE LENGTH	CONDENSING UNIT					EVAPORATIVE PAN			NEMA PLUG	EST. REFG. CHRG.
	NOM. HP	REFRIG.	Hz/Ph	VOLTS	RLA	AMPS	Volts	WATTS		
8'	1-3/4	R448A	60 / 1	240	12.6	6.3	240.0	1500	L14-30P	TBD