

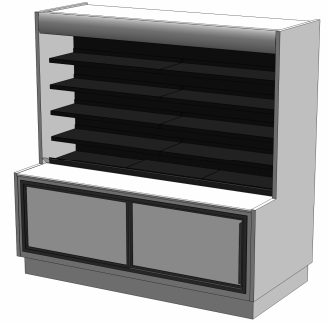

**BACK BAR DISPLAY**  
**HUSSMANN - RBB (CHINO)**

**DOE 2017 Energy Efficiency Compliant** Hussmann refrigerated merchandisers configured for sale for use in the United States meet or surpass the requirements of the DOE 2017 energy efficiency standards.

**RBB**

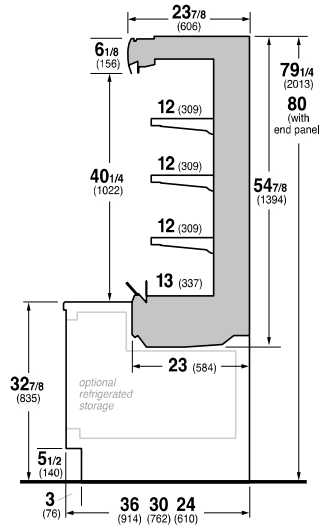
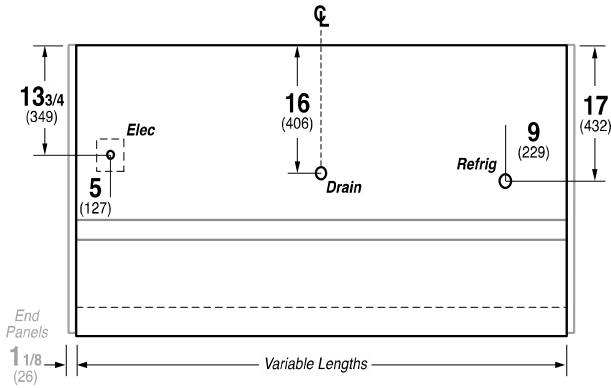

**REFRIGERATION DATA:**

CASE LENGTHS	CASE USAGE	CAPACITY ** (BTU/HR/FT)		TEMPERATURE (°F)			VELOCITY (FT/MIN)
		RATING CONDITION		EVAPORATOR		DISCHARGE AIR * (°F)	
		NSF 7	AHRI 1200	NSF 7	AHRI 1200	NSF 7	
4', 5', 6', 8', 10', 12'	BACK BAR	1270	1050	24	26	30~32	250~350
LOWER STORAGE: 24"	BACK BAR	40	40	28	28	31~33	380~600
LOWER STORAGE: 30"	BACK BAR	75	75	27	27	31~33	380~600
LOWER STORAGE: 36"	BACK BAR	110	110	27	27	32~34	380~600

CASE LENGTHS	EST. REFG. CHR.G. (LBS)	20°F ENTERING GLYCOL 6° RISE TOP			
		TOP		LOWER STORAGE	
		GPM	PSI	GPM	PSI
4'	1.0	1.8	2.3	0.3	0.0
5'	1.2	2.2	3.5	0.4	0.1
6'	1.4	2.6	2.1	0.4	0.2
8'	2.0	3.4	3.3	0.6	0.5
10'	2.5	4.2	4.7	0.8	0.7
12'	2.9	5.0	4.3	0.9	0.9

\*FRONT DISCHARGE AIR MEASURED INSIDE AIR CURTAIN HONEYCOMB

\*\*REFRIGERATION NOTES:

- 1) BTU'S INCLUDE CANOPY LIGHTS. ADD 10 BTUS/SHELF/FT FOR EACH SHELF (LIGHT)
- 2) ALL CASES EQUIPPED WITH NIGHT CURTAINS
- 3) FOR AHRI TEST, NIGHT CURTAINS ARE PULLED DOWN FOR 6 HOURS AND ALL LIGHTS ARE TURNED OFF PER AHRI 1200 TEST PROCEDURES
- 4) FOR NSF 7, THE LOAD LISTED IS WITHOUT THE NIGHT CURTAINS PULLED DOWN,
- 5) AHRI 1200 RATING POINT FOR ENERGY CONSUMPTION COMPARISON ONLY
- 6) USE DEW POINT FOR HIGH GLIDE REFRIGERANTS. CARE SHOULD BE TAKEN TO USE THE DEW POINT IN P/T TABLES FOR MEASURING AND ADJUSTING SUPERHEAT. ADJUST EVAPORATOR PRESSURE AS NEEDED TO MAINTAIN THE DISCHARGE AIR TEMPERATURE SHOWN.
- 7) RATING CONDITION IS NSF TYPE I, 75°F/55% RH

**REFRIGERATION DATA CONTINUED:**

LOCATION	ELEC. THERMOSTAT / AIR SENSOR SETTINGS		DEFROST TYPE	TIME (MIN)	DEFROST FREQUENCY (#/DAY)	TERM. TEMP (°F) COIL ONLY	DRIP TIME	DEFROST WATER (LBS/DAY/FT)
	USAGE	CUT IN (°F)						
UPPER SECTION	BACK BAR	31	28	OFF TIME	24	45	N/A	7.0
LOWER STORAGE	BACK BAR	31	28			48	N/A	0.2

END PANEL WIDTH KEY		
# OF END PNLS	END PNL WIDTH (IN.)	TOTAL ADDED LENGTH (IN.)
1	1.125	1.125
2	1.125	2.25

**ELECTRICAL DATA:**

**STANDARD FANS, HEATERS, LED LIGHTS (115 VOLT)**

CASE LENGTH	EVAPORATOR FANS - BACK BAR					EVAPORATOR FANS - LOWER REFRIGERATED SECTION (OPTIONAL)				CANOPY LIGHTS LED		OPTIONAL LED SHELF LIGHTS		MAX. LED LOAD (W/ ALL OPTIONS)		ANTI-SWEAT HEATERS		CONVENIENCE OUTLETS (OPTIONAL)		
	# OF EVAP FANS	BLADE DIA. (IN.)	BLADE PITCH (°)	AMPS	WATTS	# OF EVAP FANS ***	AMPS	WATTS	AMPS	WATTS	AMPS	WATTS	AMPS	WATTS	AMPS	WATTS	# OUTLETS	VOLTS	AMPS	
4'	1	8	25	0.3	8	1	0.3	9	0.1	10	0.3	31	0.4	41	N/A	N/A	N/A	N/A	N/A	
5'	2	8	25	0.6	16	1	0.3	9	0.1	10	0.3	39	0.4	49	N/A	N/A	N/A	N/A	N/A	
6'	2	8	25	0.6	16	1	0.3	9	0.2	21	0.4	46	0.6	67	N/A	N/A	N/A	N/A	N/A	
8'	2	8	25	0.6	16	1	0.3	9	0.2	21	0.5	62	0.7	82	N/A	N/A	N/A	N/A	N/A	
10'	4	8	25	1.2	32	2	0.6	18	0.2	21	0.7	78	0.9	99	N/A	N/A	N/A	N/A	N/A	
12'	3	8	25	0.9	24	2	0.6	18	0.3	31	0.8	93	1.1	124	N/A	N/A	N/A	N/A	N/A	

\*\*\* 24D and 30D options require one unit

**OPTIONAL HIGH OUTPUT LED LIGHTS (115 VOLT)**

CASE LENGTH	CANOPY LIGHTS H.O. LED		OPTIONAL SHELF		MAX. H.O. LED LOAD	
	AMPS	WATTS	AMPS	WATTS	AMPS	WATTS
4'	0.1	15	0.4	46	0.5	61
5'	N/A	N/A	N/A	N/A	N/A	N/A
6'	0.3	30	0.7	78	0.9	108
8'	0.3	30	0.8	91	1.1	122
10'	N/A	N/A	N/A	N/A	N/A	N/A
12'	0.4	46	1.2	137	1.6	183